

FINAL SURVEY NO.	DATE
EXCISED PLOTTED	BY
NOTE BOOK	
AREAS CHECKED	

ORIGINAL SURVEY NO.	DATE
EXCISED PLOTTED	BY
NOTE BOOK	
AREAS CHECKED	

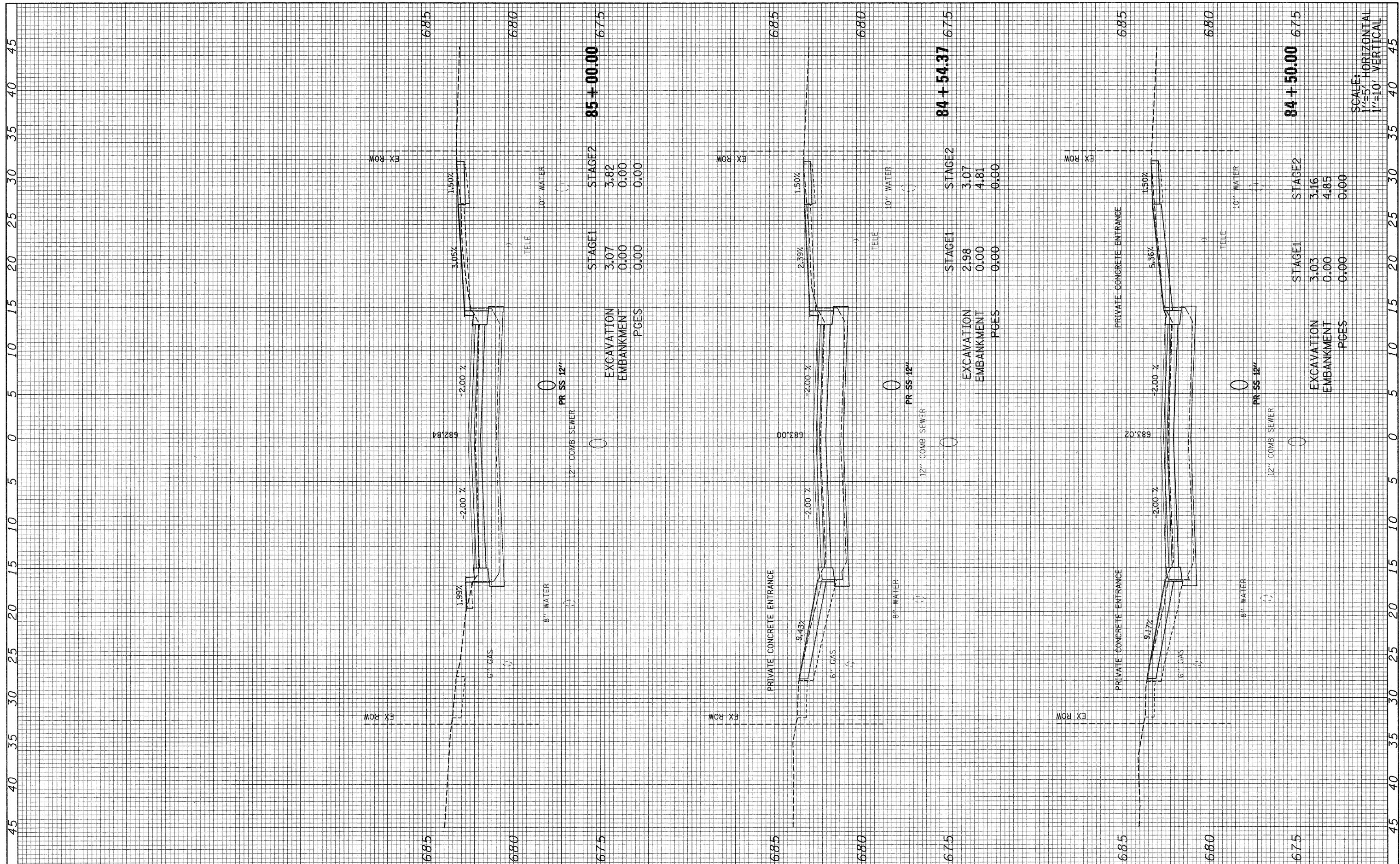

FILE NAME = 092-160.v111a_xa.dgn	USER NAME = #USER#	DESIGNED -	REVISED -	<b>STATE OF ILLINOIS</b> <b>DEPARTMENT OF TRANSPORTATION</b>	<b>S. VILLA AVE - CROSS SECTION</b>	F.A. U. RTE. 2652	SECTION 00-00070-00-PV	COUNTY DuPAGE	TOTAL SHEETS 160	SHEET NO. 122	
PLOT SCALE = 1/8"	PLOT DATE = 6/15/2010	DRAWN -	REVISED -			SCALE: AS NOTED	SHEET NO. 31 OF 69 SHEETS	STA. 84+50.00 TO STA. 85+00.00	CONTRACT NO. 63379		ILLINOIS FED. AID PROJECT
		CHECKED -	REVISED -								
		DATE -	REVISED -								