

**STATE OF ILLINOIS**  
**DEPARTMENT OF TRANSPORTATION**  
**DIVISION OF HIGHWAYS**  
**PLANS FOR PROPOSED**  
**FEDERAL AID HIGHWAY**

FAU RTE	SECTION	COUNTY	TOTAL SHEETS	SHEET NO.
-	10-00018-00-RS	COOK	11	1
F.H.W.A. REG.	ILLINOIS PROJECT	HPP-3461(003)		

CONTRACT NO. 63482

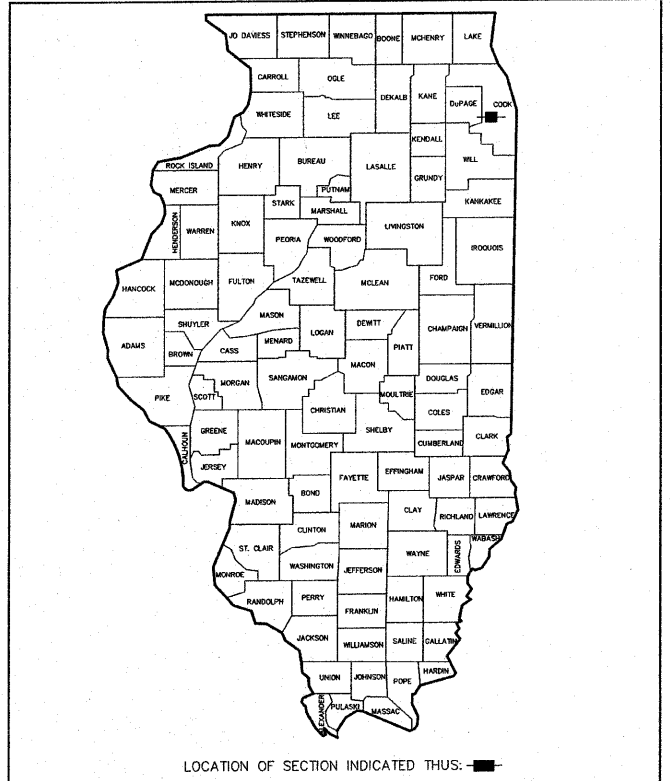

- INDEX OF SHEETS**
- COVER SHEET, INDEX OF SHEETS, LOCATION MAP, INDEX OF HIGHWAY STANDARDS
  - GENERAL NOTES AND SUMMARY OF QUANTITIES
  - TYPICAL CROSS SECTIONS, HOT-MIX ASPHALT MIXTURE REQUIREMENTS
  - PLAN: CATHERINE ANN DRIVE (RESURFACING & PAVEMENT MARKINGS) - EAST AVENUE TO LENZI AVENUE  
 LENZI AVENUE (RESURFACING & PAVEMENT MARKINGS) - CATHERINE ANN DRIVE TO JOLIET ROAD
  - BD-08 DETAILS FOR FRAMES AND LIDS ADJUSTMENTS WITH MILLING
  - BD-22 PAVEMENT PATCHING FOR HMA SURFACED PAVEMENT
  - BD-24 CURB OR CURB AND GUTTER REMOVAL AND REPLACEMENT
  - BD-32 BUTT JOINT AND HMA TAPER DETAILS
  - TC-10 TRAFFIC CONTROL & PROTECTION FOR SIDE ROADS, INTERSECTIONS, & DRIVEWAYS
  - TC-13 DISTRICT ONE TYPICAL PAVEMENT MARKINGS
  - TC-18 SIGNING FOR FLAGGING OPERATIONS AT WORK ZONE OPENINGS

- HIGHWAY STANDARDS**
- 000001-05 STANDARD SYMBOLS, ABBREVIATIONS, AND PATTERNS
  - 424001-05 CURB RAMPS FOR SIDEWALK
  - 442201-03 CLASS C AND D PATCHES
  - 604001-03 FRAME & LIDS, TYPE 1
  - 606001-04 CONCRETE CURB AND COMBINATION CONCRETE CURB & GUTTER
  - 701301-03 LANE CLOSURE, 2L, 2W, SHORT TIME OPERATIONS
  - 701501-05 URBAN LANE CLOSURE, 2 L, 2 W UNDIVIDED
  - 701801-04 LANE CLOSURE MULTILANE 1W OR 2W CROSSWALK OR SIDEWALK CLOSURE
  - 701901-01 TRAFFIC CONTROL DEVICES
  - 780001-02 TYPICAL PAVEMENT MARKINGS

TRAFFIC DATA	DESIGN DESIGNATION
ADT: LENZI AVENUE 400 (2009)	LOCAL
CATHERINE ANN DRIVE 400 (2009)	LOCAL

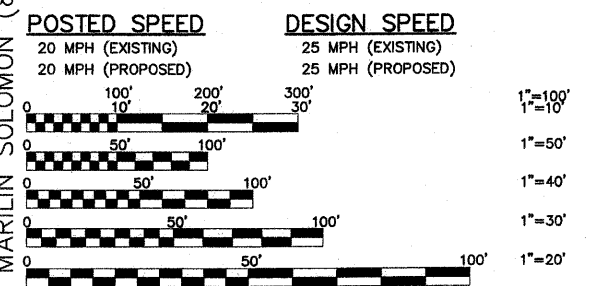

FULL SIZE PLANS HAVE BEEN PREPARED USING STANDARD ENGINEERING SCALES. REDUCED SIZED PLANS WILL NOT CONFORM TO STANDARD SCALES. IN MAKING MEASUREMENTS ON REDUCED PLANS, THE ABOVE SCALES MAY BE USED.

**J.U.I.E.**  
 JOINT UTILITY LOCATION INFORMATION FOR EXCAVATION CALL 811

Know what's below.  
 Call before you dig.

**Frank Novotny & Associates, Inc.**  
 825 Midway Drive • Willowbrook, IL • 60527 • Telephone: (630) 887-8640 • Fax: (630) 887-0132  
 Civil Engineers Municipal Consultants ILLINOIS PROFESSIONAL DESIGN FIRM NO. 184-000283

R E V I S I O N S			
NO.	BY	DATE	DESCRIPTION
1	JLC	4-26-10	PER I.D.O.T. REVIEW
2	JLC	6-16-10	PER I.D.O.T. REVIEW

CONTRACT NO. 63482

CATHERINE ANN DRIVE  
 EAST AVENUE TO LENZI AVENUE  
 LENZI AVENUE  
 CATHERINE ANN DRIVE TO JOLIET ROAD

LAPP RESURFACING  
 PROJECT HPP-3461(003)  
 SECTION 10-00018-00-RS  
 VILLAGE OF HODGKINS  
 COOK COUNTY  
 C-91-359-10  
 PROJECT LOCATION MAP

LENZI AVENUE  
 PROJECT ENDS AT STA. 17+69 (JOLIET ROAD)

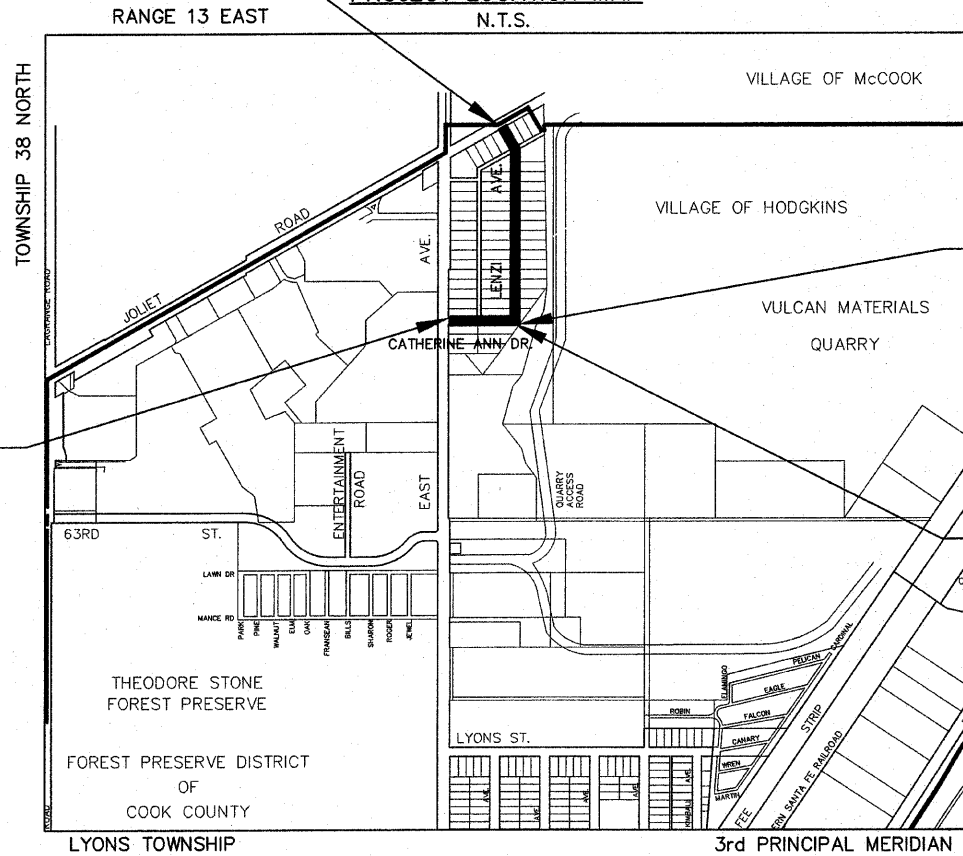

LENZI AVENUE  
 PROJECT BEGINS AT STA. 4+60 (CATHERINE ANN DRIVE)

CATHERINE ANN DRIVE  
 PROJECT ENDS AT STA. 4+60 (LENZI AVENUE)

CATHERINE ANN DRIVE  
 PROJECT BEGINS AT STA. 0+22 (EAST AVENUE)

— DENOTES LOCATION OF IMPROVEMENT

LENGTH OF PROJECT	
CATHERINE ANN DRIVE	438 FEET (0.08 MILES)
LENZI AVENUE	1,309 FEET (0.25 MILES)
<b>GROSS LENGTH OF PROJECT</b>	<b>1,747 FEET (0.33 MILES)</b>
<b>NET LENGTH OF PROJECT</b>	<b>1,747 FEET (0.33 MILES)</b>

STATE OF ILLINOIS  
 DEPARTMENT OF TRANSPORTATION  
 DIVISION OF HIGHWAYS

APPROVED JUNE 16 2010

VILLAGE OF HODGKINS Noel B. Cummings  
 NOEL B. CUMMINGS, VILLAGE PRESIDENT

PASSED July 12 2010  
C. Heit  
 DISTRICT 1 ENGINEER OF LOCAL ROADS & STREETS

RELEASING FOR BID BASED ON LIMITED REVIEW JULY 15 2010  
Dianna M. O'Neil  
 DEPUTY DIRECTOR OF HIGHWAYS, REGION 1 ENGINEER

*JLC*  
 JAMES L. CAINKAR, P.E.  
 IL. P.E. NO. 062-036190  
 EXPIRES 11-30-2011

06-16-10  
 DATE SEAL

**PRINTED BY THE AUTHORITY  
 OF THE STATE OF ILLINOIS**