

STATE OF ILLINOIS
DEPARTMENT OF TRANSPORTATION
DIVISION OF HIGHWAYS

PLANS FOR PROPOSED
FEDERAL AID HIGHWAY

FAI-94 FRONTAGE ROAD (PRINCE DRIVE)
170TH STREET (FAU 1611) TO WOODLAWN EAST AVENUE
LOCAL AGENCY PAVEMENT PRESERVATION, (RESURFACING)
SECTION NO.: 10-00088-00-RS
PROJECT NO.: ARA-9003(668)
VILLAGE of SOUTH HOLLAND
COOK COUNTY
JOB NO. C-91-674-10

F. A. I. REL.	SECTION	COUNTY	TOTAL SHEETS	SHEET NO.
94	10-00088-00-RS	COOK	18	1
STA.		TO STA.		
FED. ROAD DIST. NO.		ILLINOIS	FED. AID PROJECT ARA-9003(668)	

CONTRACT #63495

INDEX OF SHEETS

1. COVER SHEET, INDEX OF SHEETS & STATE STANDARDS
2. SUMMARY OF QUANTITIES & GENERAL NOTES
3. TYPICAL CROSS SECTIONS
- 4.-7. PAVEMENT PLAN
- 8.-11. STRIPING PLAN
- 12.-18. IDOT DISTRICT 1 STANDARD DETAILS

HIGHWAY STANDARDS

- | | |
|-----------|--|
| 000001-05 | STANDARD SYMBOLS, ABBREVIATIONS AND PATTERNS |
| 424001-05 | CURB RAMPS FOR SIDEWALKS |
| 442201-03 | CLASS C AND D PATCHES |
| 606001-04 | CONCRETE CURB TYPE B AND COMBINATION CONCRETE CURB AND GUTTER |
| 701501-04 | URBAN LANE CLOSURE, 2L, 2W, UNDIVIDED |
| 701801-04 | LANE CLOSURE, MULTILANE 1W OR 2W CROSSWALK OR SIDEWALK CLOSURE |
| 701901-01 | TRAFFIC CONTROL DEVICES |
| 780001-02 | TYPICAL PAVEMENT MARKINGS |

PRINCE DRIVE
ADT=3,200 (2009)
=3,200 (2030)
DESIGN SPEED=35 MPH
SPEED LIMIT=30 MPH

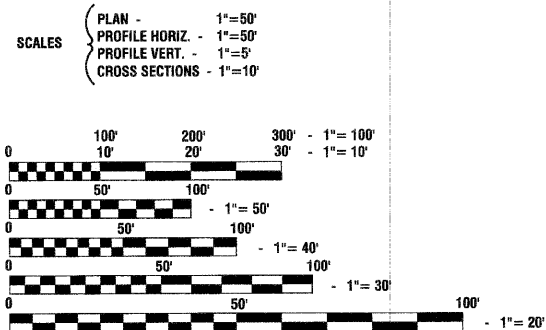

FULL SIZE PLANS HAVE BEEN PREPARED USING STANDARD ENGINEERING SCALES, REDUCED SIZED PLANS WILL NOT CONFORM TO STANDARD SCALES, IN MAKING MEASUREMENTS ON REDUCED PLANS, THE ABOVE SCALES MAY BE USED.

J. U. L. I. E.
JOINT UTILITY LOCATION INFORMATION FOR EXCAVATION
1-800-892-0123 or 811

CONTRACT NO. 63495

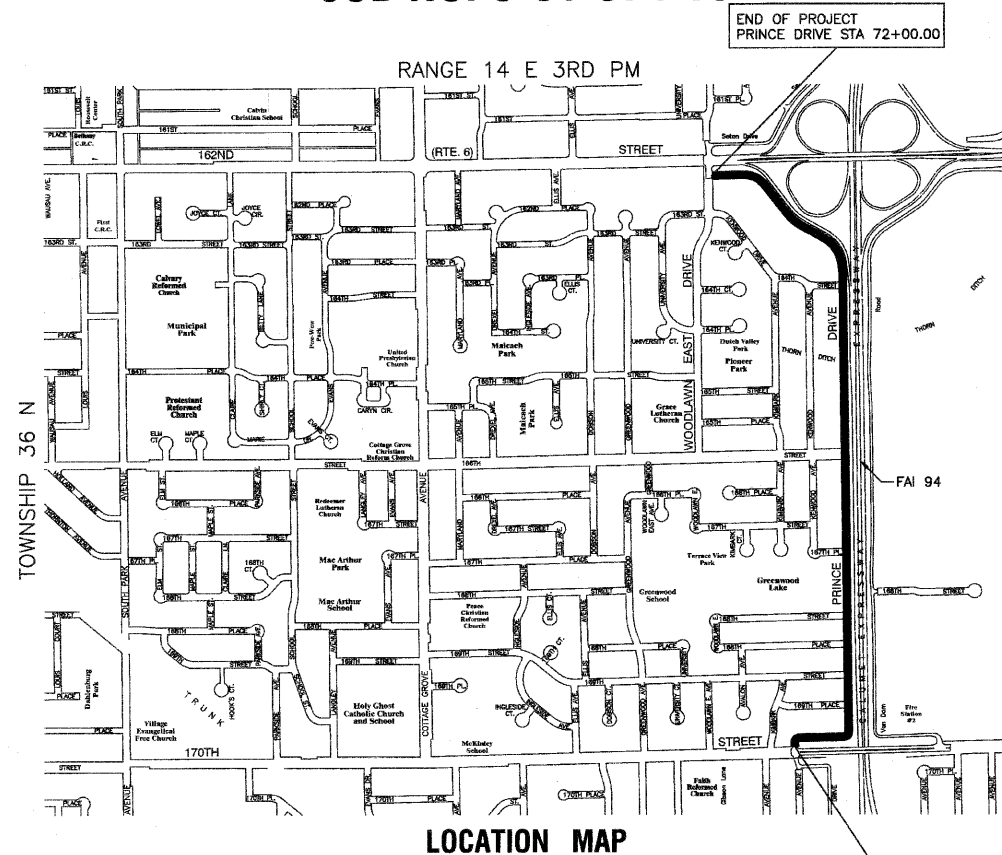
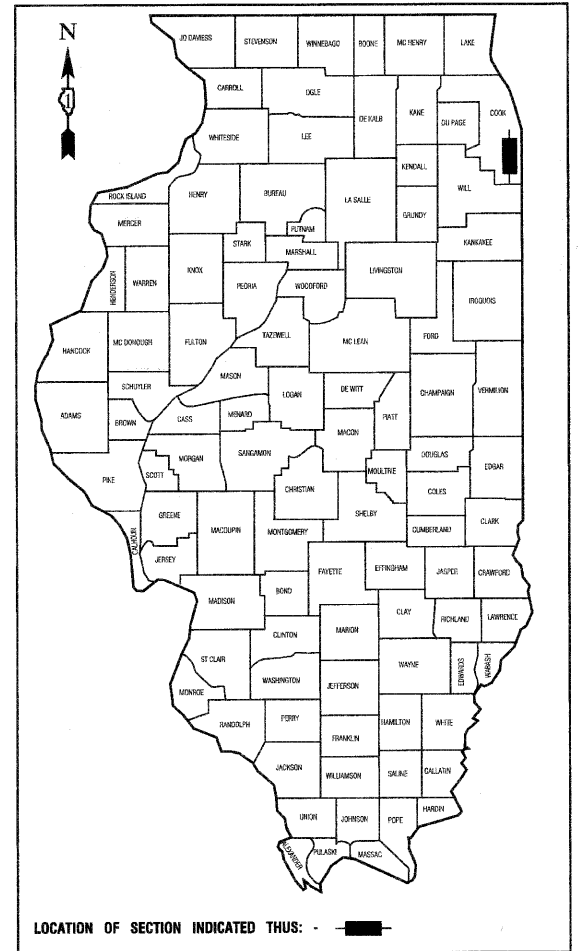

LOCATION MAP

NOT TO SCALE
GROSS LENGTH=6,197 FEET=1.17 MILES
NET LENGTH=6,197 FEET=1.17 MILES

PROJECT LOCATED
IN VILLAGE OF
SOUTH HOLLAND

STATE OF ILLINOIS DEPARTMENT OF TRANSPORTATION
DIVISION OF HIGHWAYS

Approved 6/23/2010
[Signature]
President, Village of South Holland

Passed July 12, 2010
[Signature]
District 1 Engineer of Local Roads & Streets

Released for Bid Based on Limited Review July 15, 2010
[Signature]
Deputy Director of Highways, Region 1 Engineer

PRINTED BY THE AUTHORITY OF
THE STATE OF ILLINOIS

PREPARED BY OR UNDER THE
DIRECT SUPERVISION OF:

[Signature]
6/22/10

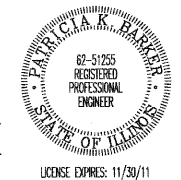

PROGRAM & OFFICE ENGINEER: CHARLES F. RIDDLE P.E. 847-705-4406
CONSULTANTS: ROBINSON ENGINEERING, LTD. 708-331-6700

SUMMARY OF QUANTITIES					PAVEMENT	MARKINGS
S.I.	CODE NO.	PAY ITEM	UNIT	TOTAL QUANTITY	CONSTRUCTION TYPE CODE	
					I000	SFTY-1D
	20101700	SUPPLEMENTAL WATERING	UNIT	1	1	
	25200110	SODDING, SALT TOLERANT	SQ YD	720	720	
	40201000	AGGREGATE FOR TEMPORARY ACCESS	TON	50	50	
	40300100	BITUMINOUS MATERIALS (PRIME COAT)	GALLON	3916	3916	
	40600300	AGGREGATE (PRIME COAT)	TON	49	49	
	X4067112	POLYMERIZED LEVELING BINDER (MACHINE METHOD), IL-4.75, N50	TON	1372	1372	
	40600982	HOT-MIX ASPHALT SURFACE REMOVAL - BUTT JOINT	SQ YD	228	228	
	40603335	HOT-MIX ASPHALT SURFACE COURSE, MIX "D", N50	TON	1727	1727	
	42300300	PORTLAND CEMENT CONCRETE DRIVEWAY PAVEMENT, 7 INCH	SQ YD	50	50	
	42400200	PORTLAND CEMENT CONCRETE SIDEWALK 5 INCH	SQ FT	1914	1914	
	42400800	DETECTABLE WARNINGS	SQ FT	80	80	
	44000158	HOT-MIX ASPHALT SURFACE REMOVAL, 2 1/4"	SQ YD	19576	19576	
	Z0004544	HOT-MIX ASPHALT DRIVEWAY PAVEMENT REMOVAL	SQ YD	128	128	
	44000200	DRIVEWAY PAVEMENT REMOVAL	SQ YD	50	50	
	44000600	SIDEWALK REMOVAL	SQ FT	1914	1914	
	Z0004562	COMBINATION CONCRETE CURB AND GUTTER REMOVAL AND REPLACEMENT	FOOT	455	455	
	44201729	CLASS D PATCHES, TYPE II, 7 INCH	SQ YD	88	88	
	44201733	CLASS D PATCHES, TYPE III, 7 INCH	SQ YD	139	139	
	44201735	CLASS D PATCHES, TYPE IV, 7 INCH	SQ YD	1339	1339	
	48102100	AGGREGATE WEDGE SHOULDER, TYPE B	TON	315	315	
	60300310	FRAMES AND LIDS TO BE ADJUSTED (SPECIAL)	EACH	22	22	
	67100100	MOBILIZATION	L SUM	1	1	
	70102620	TRAFFIC CONTROL AND PROTECTION, STANDARD 701501	L SUM	1	1	
	70102640	TRAFFIC CONTROL AND PROTECTION, STANDARD 701801	L SUM	1	1	
	70300100	SHORT-TERM PAVEMENT MARKING	FOOT	2000	2000	
*	78000200	THERMOPLASTIC PAVEMENT MARKING - LINE 4"	FOOT	17600		17600
*	78000650	THERMOPLASTIC PAVEMENT MARKING - LINE 24"	FOOT	100		100
*	78100100	RAISED REFLECTIVE PAVEMENT MARKER	EACH	36		36
*	78300200	RAISED REFLECTIVE PAVEMENT MARKER REMOVAL	EACH	16		16
	Z0030850	TEMPORARY INFORMATION SIGNING	SQ FT	250	250	
	X0325912	HOT-MIX ASPHALT SHOULDER REMOVAL AND REPLACEMENT, 6"	SQ YD	62	62	
	Z0004518	HOT-MIX ASPHALT DRIVEWAY PAVEMENT, 5"	SQ YD	128	128	

GENERAL NOTES

- BEFORE STARTING ANY EXCAVATION THE CONTRACTOR SHALL CALL "J.U.L.I.E." AT (800) 892-0123 AND (312) 744-7000 FOR FIELD LOCATIONS OF BURIED ELECTRIC, TELEPHONE AND GAS UTILITIES. (48 HOUR NOTIFICATION REQUIRED)
- UTILITIES INDICATED ON THE PLANS ARE PROVIDED FOR THE CONTRACTORS USE AND ARE BASED UPON INFORMATION AVAILABLE AT THE TIME OF THE ADVERTISEMENT FOR BIDS. THE OWNER AND ENGINEER DO NOT GUARANTEE THE ACCURACY OF UTILITY INFORMATION.
- IT SHALL BE THE CONTRACTOR'S RESPONSIBILITY TO VERIFY ALL DIMENSIONS AND CONDITIONS EXISTING IN THE FIELD PRIOR TO CONSTRUCTION AND ORDERING OF MATERIALS.
- SCHEDULES INCLUDED IN THE PLANS HAVE BEEN PREPARED FROM FIELD NOTES. EXACT LOCATIONS FOR PATCHING SHALL BE DETERMINED IN THE FIELD BY THE ENGINEER.
- THE THICKNESS OF HMA MIXTURE STATED IN THE SPECIFICATIONS IS THE NOMINAL THICKNESS. DEVIATIONS FROM THE NOMINAL THICKNESS WILL BE PERMITTED WHEN SUCH DEVIATIONS OCCUR DUE TO IRREGULARITIES IN THE EXISTING SURFACE OR BASE ON WHICH THE HMA SURFACE IS PLACED.
- ACCESS TO DRIVEWAYS SHALL BE MAINTAINED AT ALL TIMES BY LIMITING CURB AND GUTTER REPAIR TO ONE-HALF THE DRIVEWAY WIDTH AT ONE TIME AS WELL AS TEMPORARY AGGREGATE.
- THE REMOVAL AND/OR REPLACEMENT OF ANY DRIVEWAYS, PAVEMENT, CURB, SIDEWALK, ECT. SHALL BE ACCOMPLISHED BY MEANS OF A SAW CUT JOINT, AT THE DIRECTION OF THE ENGINEER. THIS WORK WILL NOT BE PAID FOR SEPARATELY, BUT SHALL BE INCLUDED IN THE UNIT PRICE FOR THE VARIOUS ITEMS.
- ANY LOOSE MATERIAL DEPOSITED IN THE FLOW LINE OF DITCHES, GUTTERS OR OTHER DRAINAGE STRUCTURES SHALL BE REMOVED BY THE END OF EACH DAY BY THE CONTRACTOR AT THEIR EXPENSE.

* - INDICATES SPECIALTY ITEMS

FILE NAME = 00180_01-QUAN-01 - IDOT P01	USER NAME =	DESIGNED -- JPH	REVISIONS	STATE OF ILLINOIS DEPARTMENT OF TRANSPORTATION	PRINCE DRIVE RESURFACING 170TH STREET TO WOODLAWN EAST AVENUE SUMMARY OF QUANTITIES AND GENERAL NOTES			F.A.I. RTE.	SECTION	COUNTY	TOTAL SHEETS	SHEET NO.
		CHECKED -- PKB	REVISED --		94	10-00088-00-RS	COOK	18	2			
	PLOT SCALE =	DRAWN -- RG	REVISED --		CONTRACT NO. 63495							
	PLOT DATE = 06-22-10	CHECKED -- AG	REVISED --		SCALE: NA	SHEET NO. 2 OF 18 SHEETS	STA. TO STA.	FED. ROAD DIST. NO. 1	ILLINOIS	FED. AID PROJECT ARA-9003(668)		

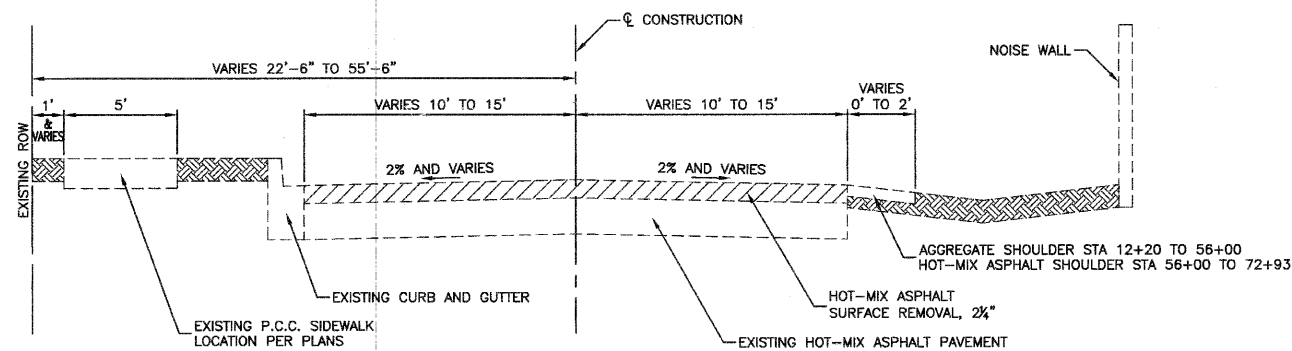

EXISTING TYPICAL SECTION
PRINCE DRIVE

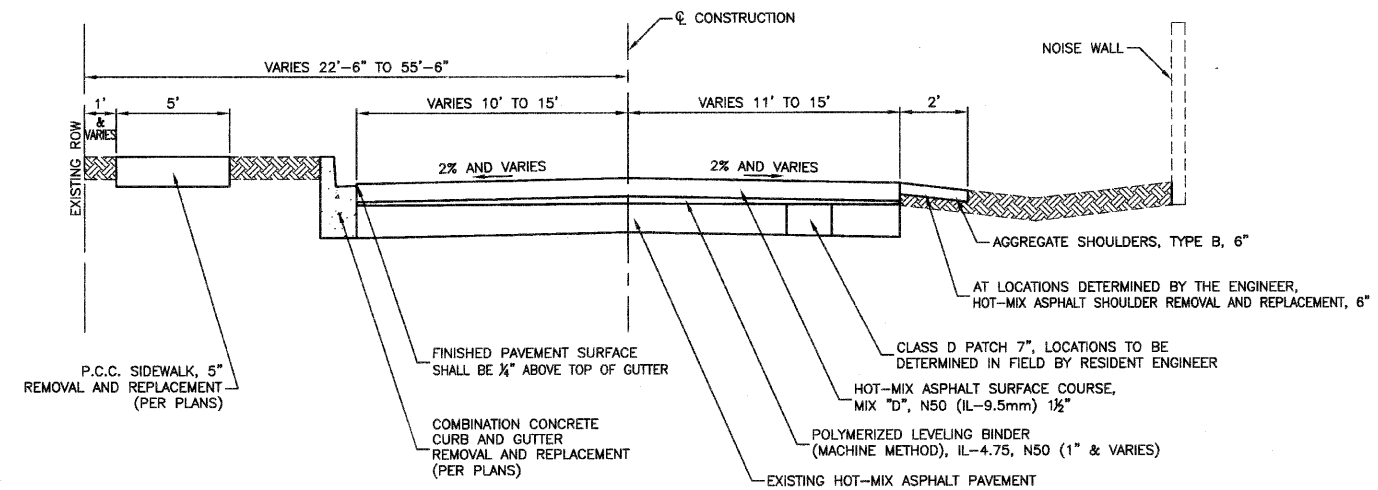

PROPOSED TYPICAL SECTION
PRINCE DRIVE

NOTE: CONTRACTOR SHALL MILL BEFORE PATCHING

HOT-MIX ASPHALT MIXTURE REQUIREMENTS

MIXTURE TYPE	AIR VOIDS
RESURFACING	
HOT MIX ASPHALT SURFACE COURSE, MIX "D", N50(IL-9.5mm); 1 1/2"	4% @ 50 Gyr.
POLYMERIZED LEVELING BINDER (MACHINE METHOD), IL-4.75, N50, (1")	4% @ 50 Gyr.
DRIVEWAYS	
HOT MIX ASPHALT SURFACE COURSE, MIX "C", N50 (IL-9.5mm); 2"	4% @ 50 Gyr.
HOT MIX ASPHALT BASE COURSE, (HMA BINDER IL-19.0mm); 3"	4% @ 50 Gyr.
PATCHING	
CLASS D PATCHES, TYPE I, II, III, IV (HMA BINDER IL-19.0mm), 7"	4% @ 70 Gyr.
HOT MIX ASPHALT SHOULDER REMOVAL AND REPLACEMENT	
HOT MIX ASPHALT SURFACE COURSE, MIX "D", N50 (IL-9.5mm); 2"	4% @ 50 Gyr.
HOT MIX ASPHALT BINDER COURSE, IL-19.0mm, 4"	4% @ 70 Gyr.

- NOTES:
1. THE UNIT WEIGHT USED TO CALCULATE ALL HOT-MIX ASPHALT SURFACE MIXTURE QUANTITIES IS 112 LBS/SY/IN.
 2. THE "AC TYPE" FOR POLYMERIZED HMA MIXES SHALL BE "SBS/SBR PG 70-22" AND FOR NON-POLYMERIZED HMA THE "AC" TYPE SHALL BE "PG 64-22" UNLESS MODIFIED BY DISTRICT ONE SPECIAL PROVISIONS. FOR "PERCENT OF RAP" SEE DISTRICT ONE SPECIAL PROVISIONS.

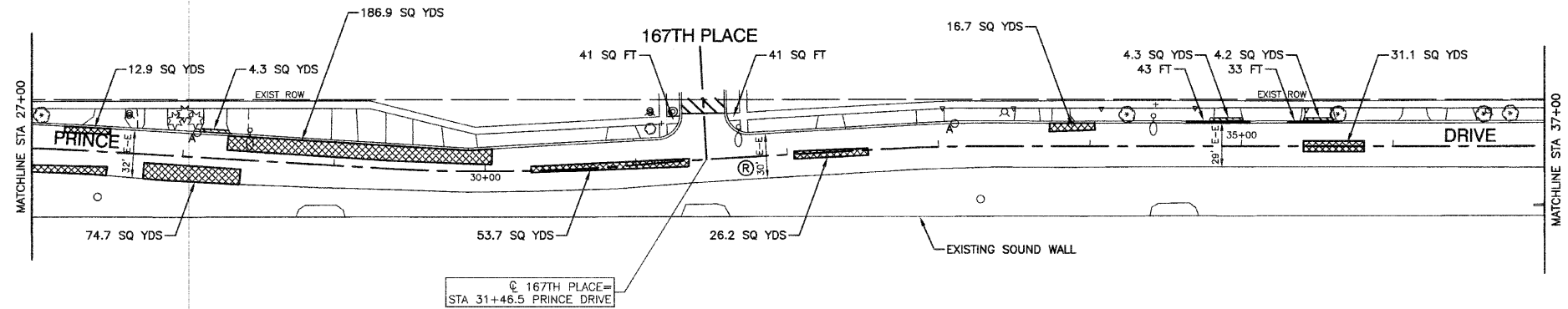
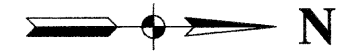

NOTES:

1. DETECTABLE WARNINGS ARE TO BE INSTALLED AT LOCATIONS OF SIDEWALK REMOVAL AND REPLACEMENT. CONTRACTOR TO POSITION AND PLACE DETECTABLE WARNINGS AT THE DIRECTION OF THE ENGINEER.
2. LIMIT OF CONSTRUCTION ON ALL SIDE STREETS IS THE RADIUS RETURN PLUS 10' BUTT JOINT OR ROW AS NOTED.
3. ACCESS TO ALL DRIVEWAYS SHALL BE MAINTAINED UPON COMPLETION OF EACH WORKDAY. RESIDENTS SHALL BE NOTIFIED 24 HOURS IN ADVANCE OF WHEN DRIVEWAY REPLACEMENT WILL TAKE PLACE.

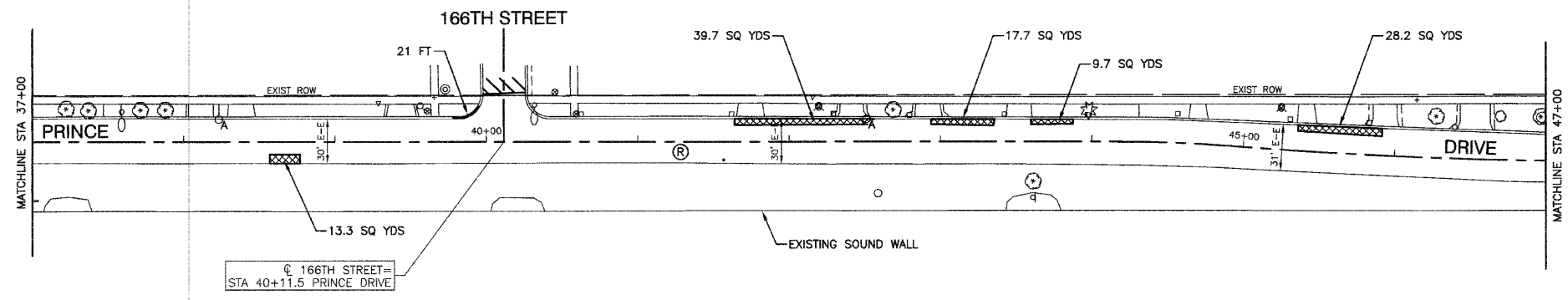

LEGEND

- HOT-MIX ASPHALT PAVEMENT REPAIR
- HOT-MIX ASPHALT SURFACE REMOVAL - BUTT JOINT (10' UNLESS OTHERWISE INDICATED)
- CONCRETE SIDEWALK REMOVAL AND REPLACEMENT (PAID FOR AS PORTLAND CEMENT CONCRETE SIDEWALK, 5" SIDEWALK REMOVAL)
- COMBINATION CONCRETE CURB AND GUTTER REMOVAL AND REPLACEMENT
- HOT-MIX ASPHALT DRIVEWAY REMOVAL AND REPLACEMENT (PAID FOR AS HOT-MIX ASPHALT DRIVEWAY PAVEMENT, 5" HOT-MIX ASPHALT DRIVEWAY PAVEMENT REMOVAL)
- "A" FRAMES AND LIDS TO BE ADJUSTED, SPECIAL
- EXISTING MANHOLE
- EXISTING CATCH BASIN
- HOT-MIX ASPHALT SURFACE REMOVAL, 2 1/4" POLYMERIZED LEVELING BINDER (MACHINE METHOD), N50, 1" HOT-MIX ASPHALT SURFACE COURSE, MIX "D", N50, 1 1/2"

BENCH MARK:

"X" CUT ON NEX CONC BASE OF ALUM LT POLE ON NWX 167TH PL AND PRINCE DRIVE ELEVATION = 600.275

FILE NAME = 08185_01-PLAN-01 - IDOT P02	USER NAME =	DESIGNED -- JPH	REVISED --	STATE OF ILLINOIS DEPARTMENT OF TRANSPORTATION	PRINCE DRIVE RESURFACING 170TH STREET TO WOODLAWN EAST AVENUE PAVEMENT PLAN		F.A.I. RTE.	SECTION	COUNTY	TOTAL SHEETS	SHEET NO.	
		CHECKED -- PKB	REVISED --		94	10-00088-00-RS	COOK	18	5			
PLOT SCALE =	DRAWN -- RG	REVISED --			SCALE: 1"=50'		SHEET NO. 5 OF 18 SHEETS		STA. TO STA.		CONTRACT NO. 63495	
PLOT DATE = 08-22-10	CHECKED -- AG	REVISED --			FED. ROAD DIST. NO. 1		ILLINOIS		FED. AID PROJECT ARA-9003(668)			

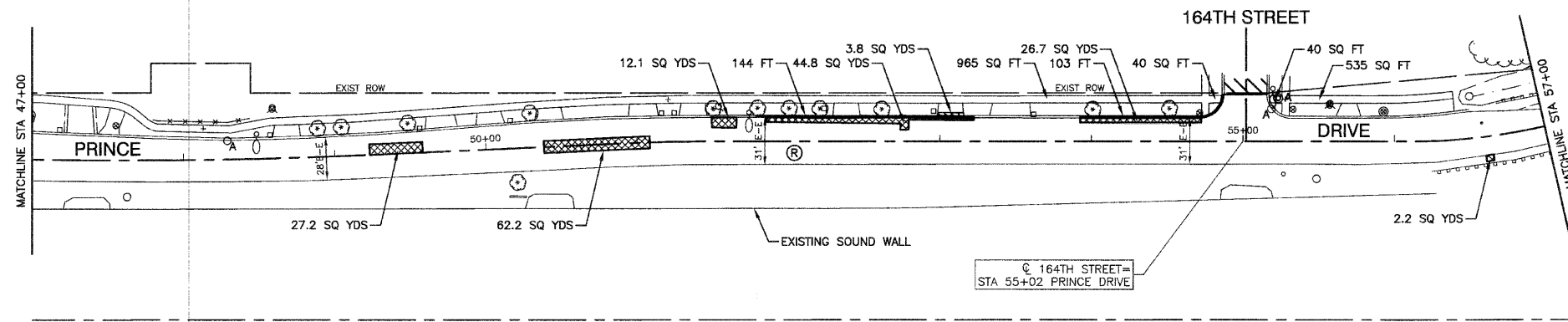

NOTES:

1. DETECTABLE WARNINGS ARE TO BE INSTALLED AT LOCATIONS OF SIDEWALK REMOVAL AND REPLACEMENT. CONTRACTOR TO POSITION AND PLACE DETECTABLE WARNINGS AT THE DIRECTION OF THE ENGINEER.
2. LIMIT OF CONSTRUCTION ON ALL SIDE STREETS IS THE RADIUS RETURN PLUS 10' BUTT JOINT OR ROW AS NOTED.
3. ACCESS TO ALL DRIVEWAYS SHALL BE MAINTAINED UPON COMPLETION OF EACH WORKDAY. RESIDENTS SHALL BE NOTIFIED 24 HOURS IN ADVANCE OF WHEN DRIVEWAY REPLACEMENT WILL TAKE PLACE.

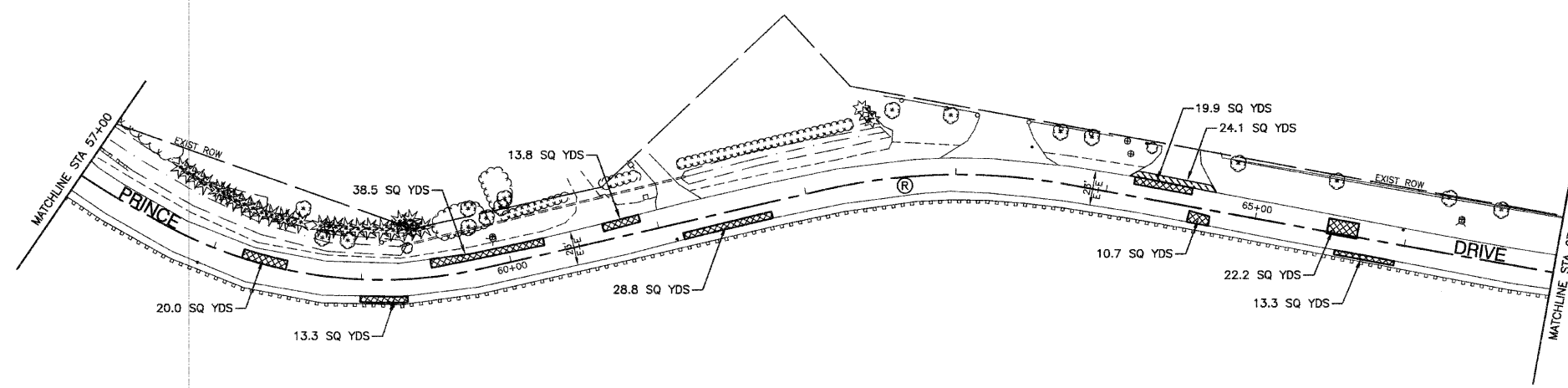
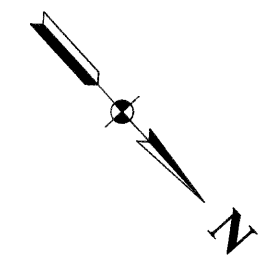

LEGEND

- HOT-MIX ASPHALT PAVEMENT REPAIR
- HOT-MIX ASPHALT SURFACE REMOVAL - BUTT JOINT (10' UNLESS OTHERWISE INDICATED)
- CONCRETE SIDEWALK REMOVAL AND REPLACEMENT (PAID FOR AS PORTLAND CEMENT CONCRETE SIDEWALK, 5" SIDEWALK REMOVAL)
- COMBINATION CONCRETE CURB AND GUTTER REMOVAL AND REPLACEMENT
- HOT-MIX ASPHALT DRIVEWAY REMOVAL AND REPLACEMENT (PAID FOR AS HOT-MIX ASPHALT DRIVEWAY PAVEMENT, 5" HOT-MIX ASPHALT DRIVEWAY PAVEMENT REMOVAL)
- FRAMES AND LIDS TO BE ADJUSTED, SPECIAL
- EXISTING MANHOLE
- EXISTING CATCH BASIN
- HOT-MIX ASPHALT SURFACE REMOVAL, 2 1/4" POLYMERIZED LEVELING BINDER (MACHINE METHOD), N50, 1" HOT-MIX ASPHALT SURFACE COURSE, MIX "D", N50, 1 1/2"

BENCH MARK:

"X" CUT ON NEX CONC BASE OF ALUM LT POLE ON NWX 167TH PL AND PRINCE DRIVE ELEVATION = 600.275

FILE NAME = 06185_01-PLAN-01 - IDOT P03	USER NAME =	DESIGNED -- JPH	REVISED --	STATE OF ILLINOIS DEPARTMENT OF TRANSPORTATION	PRINCE DRIVE RESURFACING 170TH STREET TO WOODLAWN EAST AVENUE PAVEMENT PLAN		F.A.I. RTE.	SECTION	COUNTY	TOTAL SHEETS	SHEET NO.	
		CHECKED -- PKB	REVISED --		94	10-00088-00-RS	COOK	18	6			
	PLOT SCALE =	DRAWN -- RG	REVISED --		SCALE: 1"=50'		SHEET NO. 6 OF 18 SHEETS		STA. TO STA.		CONTRACT NO. 63495	
	PLOT DATE = 08-22-10	CHECKED -- AG	REVISED --		FED. ROAD DIST. NO. 1		ILLINOIS		FED. AID PROJECT ARA-9003(668)			

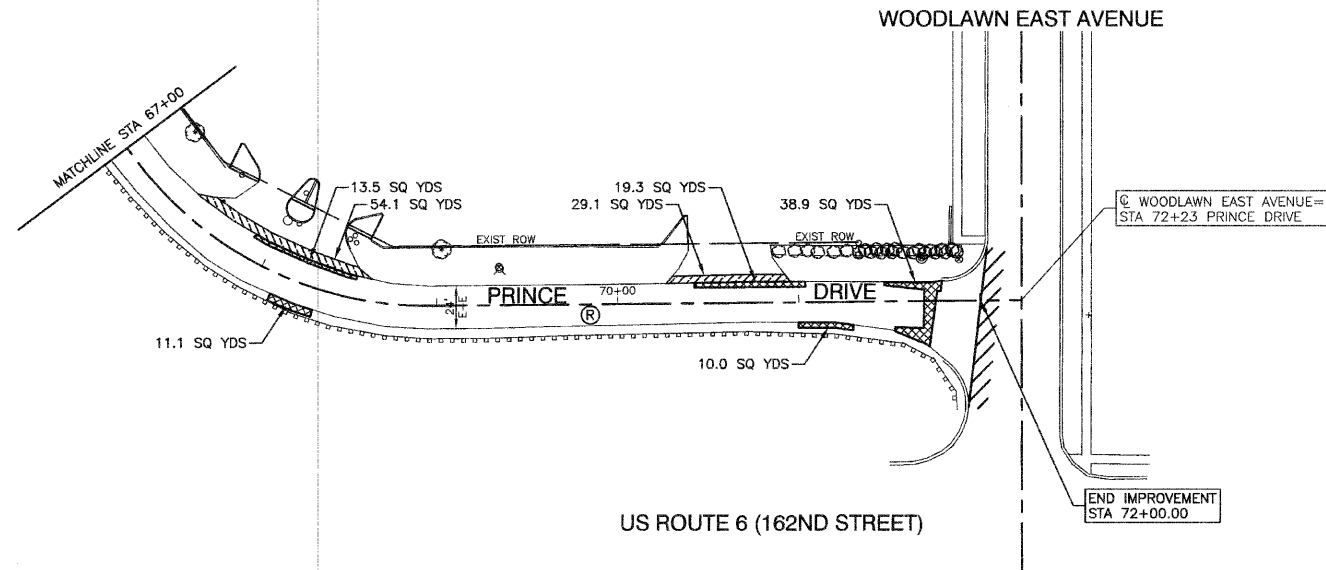

NOTES:

1. DETECTABLE WARNINGS ARE TO BE INSTALLED AT LOCATIONS OF SIDEWALK REMOVAL AND REPLACEMENT. CONTRACTOR TO POSITION AND PLACE DETECTABLE WARNINGS AT THE DIRECTION OF THE ENGINEER.
2. LIMIT OF CONSTRUCTION ON ALL SIDE STREETS IS THE RADIUS RETURN PLUS 10' BUTT JOINT OR ROW AS NOTED.
3. ACCESS TO ALL DRIVEWAYS SHALL BE MAINTAINED UPON COMPLETION OF EACH WORKDAY. RESIDENTS SHALL BE NOTIFIED 24 HOURS IN ADVANCE OF WHEN DRIVEWAY REPLACEMENT WILL TAKE PLACE.

LEGEND

- HOT-MIX ASPHALT PAVEMENT REPAIR
- HOT-MIX ASPHALT SURFACE REMOVAL - BUTT JOINT (10' UNLESS OTHERWISE INDICATED)
- CONCRETE SIDEWALK REMOVAL AND REPLACEMENT (PAID FOR AS PORTLAND CEMENT CONCRETE SIDEWALK, 5" SIDEWALK REMOVAL)
- COMBINATION CONCRETE CURB AND GUTTER REMOVAL AND REPLACEMENT
- HOT-MIX ASPHALT DRIVEWAY REMOVAL AND REPLACEMENT (PAID FOR AS HOT-MIX ASPHALT DRIVEWAY PAVEMENT, 5" HOT-MIX ASPHALT DRIVEWAY PAVEMENT REMOVAL)
- "A" FRAMES AND LIDS TO BE ADJUSTED, SPECIAL
- ⊙ EXISTING MANHOLE
- EXISTING CATCH BASIN
- Ⓡ HOT-MIX ASPHALT SURFACE REMOVAL, 2 1/4" POLYMERIZED LEVELING BINDER (MACHINE METHOD), N50, 1" HOT-MIX ASPHALT SURFACE COURSE, MIX "D", N50, 1 1/2"

BENCH MARK:

"X" CUT ON NEX CONC BASE OF ALUM LT POLE ON NWX 167TH PL AND PRINCE DRIVE ELEVATION = 600.275

FILE NAME = 08185_01-PLAN-01 - IDOT P04	USER NAME =	DESIGNED -- JPH	REVISED --	STATE OF ILLINOIS DEPARTMENT OF TRANSPORTATION	PRINCE DRIVE RESURFACING 170TH STREET TO WOODLAWN EAST AVENUE PAVEMENT PLAN			F.A.I. RTE.	SECTION	COUNTY	TOTAL SHEETS	SHEET NO.
		CHECKED -- PKB	REVISED --		94	10-00088-00-RS	COOK	18	7			
	PLOT SCALE =	DRAWN -- RG	REVISED --		CONTRACT NO. 63495							
	PLOT DATE = 06-22-10	CHECKED -- AG	REVISED --		SCALE: 1"=50'	SHEET NO. 7	OF 18 SHEETS	STA. TO STA.	FED. ROAD DIST. NO. 1	ILLINOIS	FED. AID PROJECT ARA-9003(668)	

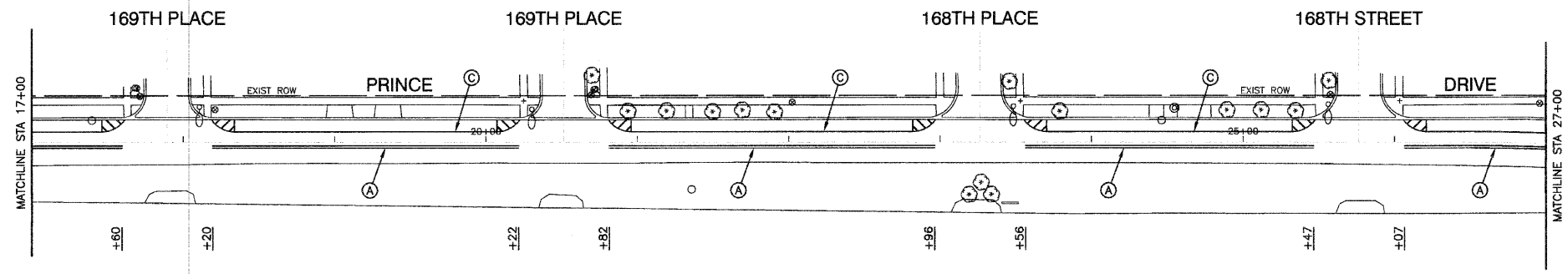
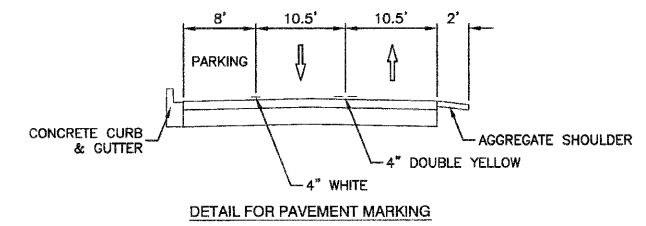
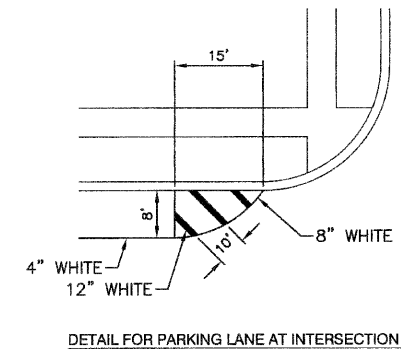
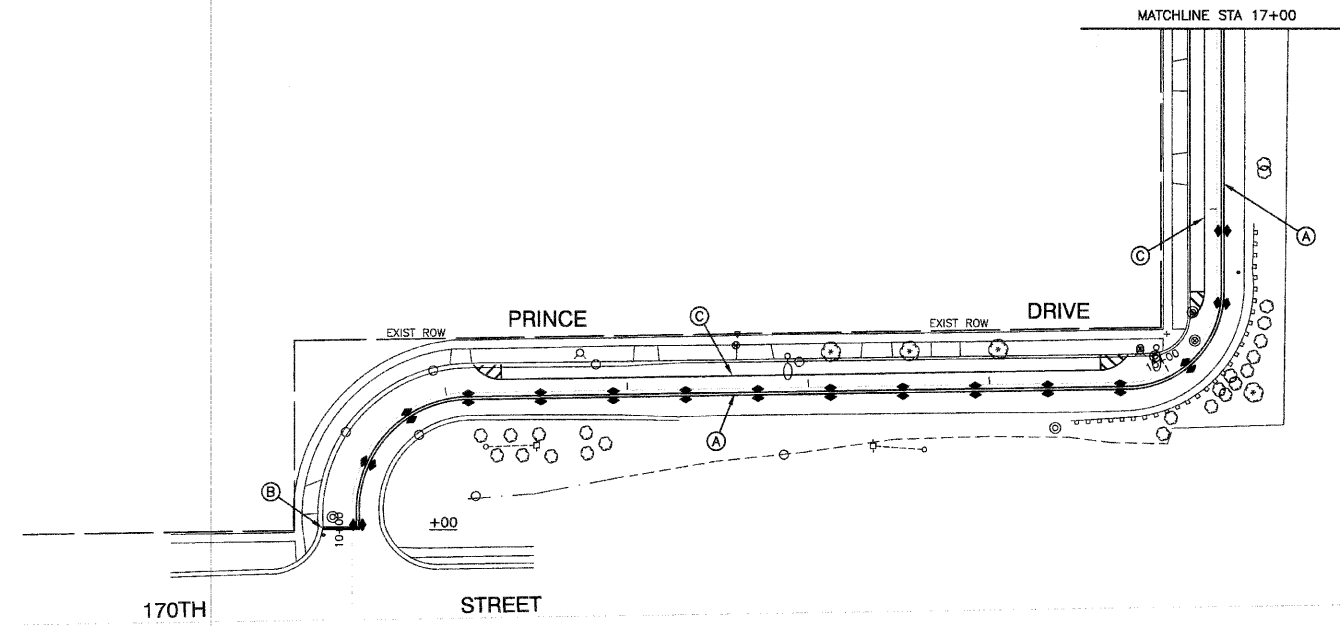

LEGEND

- (A) THERMOPLASTIC PAVEMENT MARKING
YELLOW, DOUBLE LINE, 4"
- (B) THERMOPLASTIC PAVEMENT MARKING
WHITE, 24"
- (C) THERMOPLASTIC PAVEMENT MARKING
WHITE, 4"
- ◆ TWO-WAY AMBER MARKER
40' C/C UNLESS OTHERWISE INDICATED

BENCH MARK:

*"X" CUT ON NEX CONC BASE OF ALUM LT
POLE ON NWX 167TH PL AND PRINCE DRIVE
ELEVATION = 600.275

FILE NAME = 06165_01-PVMK-01 -IDOT P01	USER NAME =	DESIGNED -- JPH	REVISIONS	STATE OF ILLINOIS DEPARTMENT OF TRANSPORTATION	PRINCE DRIVE RESURFACING 170TH STREET TO WOODLAWN EAST AVENUE PAVEMENT MARKING		F.A.I. RTE.	SECTION	COUNTY	TOTAL SHEETS	SHEET NO.
		CHECKED -- PKB	REVISIONS		94	10-00088-00-RS	COOK	18	8		
	PLOT SCALE =	DRAWN -- RG	REVISIONS		CONTRACT NO. 63495						
	PLOT DATE = 06-22-10	CHECKED -- AG	REVISIONS		SCALE: 1"=50'	SHEET NO. 8	OF 18 SHEETS	STA. TO STA.	FED. ROAD DIST. NO. 1	ILLINOIS	FED. AID PROJECT ARA-9003(668)

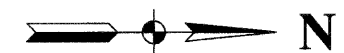
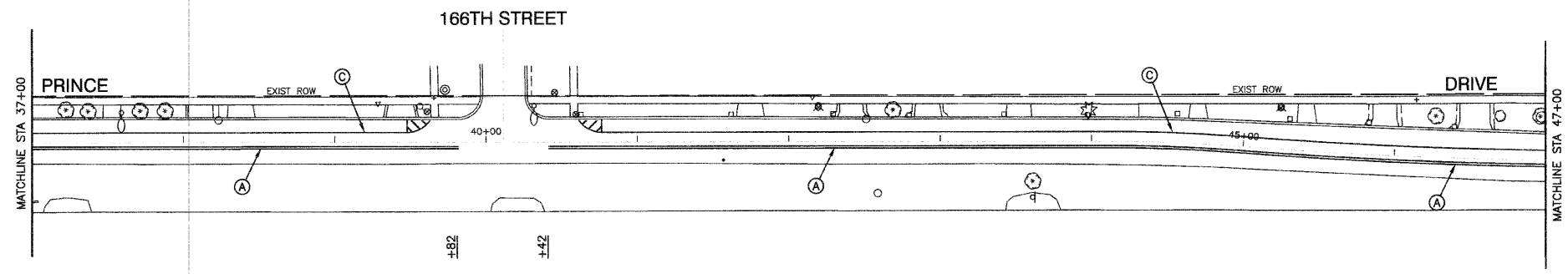
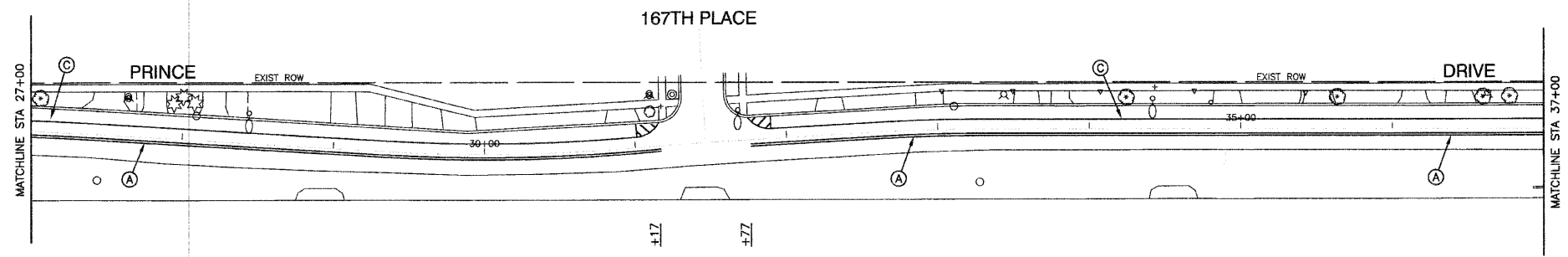
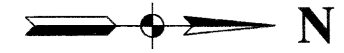

LEGEND

- (A) THERMOPLASTIC PAVEMENT MARKING
YELLOW, DOUBLE LINE, 4"
- (B) THERMOPLASTIC PAVEMENT MARKING
WHITE, 24"
- (C) THERMOPLASTIC PAVEMENT MARKING
WHITE, 4"
- ◆ TWO-WAY AMBER MARKER
40' C/C UNLESS OTHERWISE INDICATED

BENCH MARK:

*" CUT ON NEX CONC BASE OF ALUM LT
POLE ON NWX 167TH PL AND PRINCE DRIVE
ELEVATION = 600.275

FILE NAME = 06185_01_PVMK-01 - IDOT P02	USER NAME =	DESIGNED -- JPH	REVISED --	STATE OF ILLINOIS DEPARTMENT OF TRANSPORTATION	PRINCE DRIVE RESURFACING 170TH STREET TO WOODLAWN EAST AVENUE PAVEMENT MARKING		F.A.I. RTE.	SECTION	COUNTY	TOTAL SHEETS	SHEET NO.
		CHECKED -- PKB	REVISED --		94	10-00088-00-RS	COOK	18	9		
	PLOT SCALE =	DRAWN -- RG	REVISED --		SCALE: 1"=50'			SHEET NO. 9 OF 18 SHEETS		CONTRACT NO. 63495	
	PLOT DATE = 06-22-10	CHECKED -- AG	REVISED --		STA. TO STA.		FED. ROAD DIST. NO. 1 ILLINOIS		FED. AID PROJECT ARA-9003(668)		

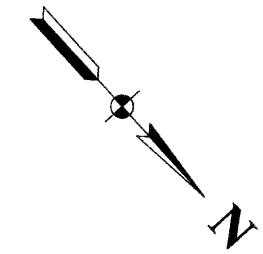
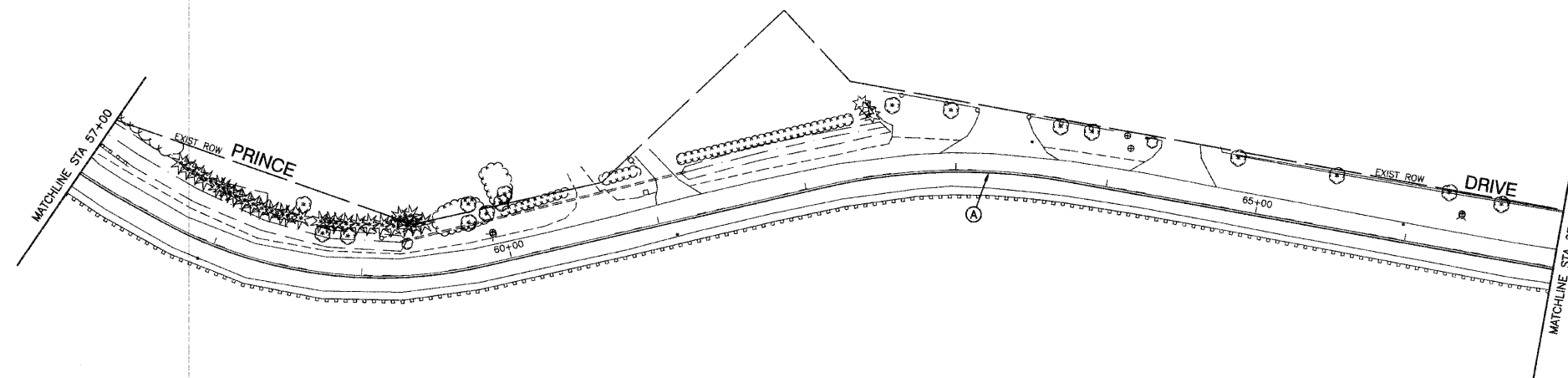
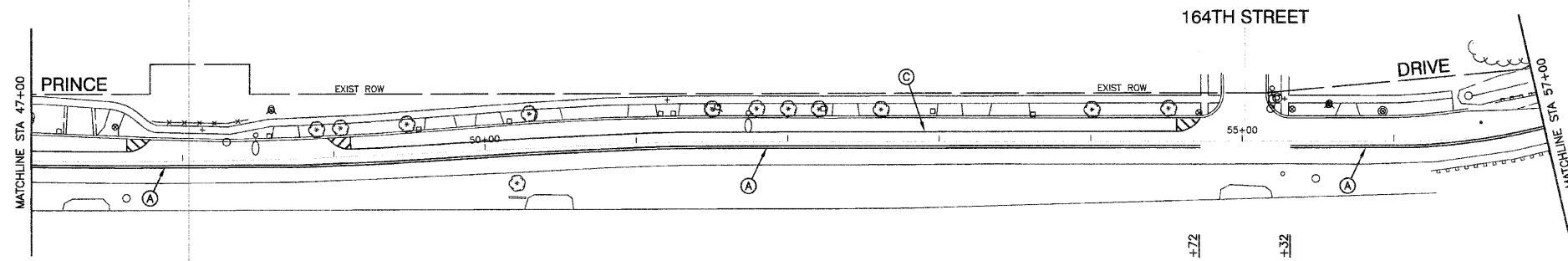

LEGEND

- (A) THERMOPLASTIC PAVEMENT MARKING
YELLOW, DOUBLE LINE, 4"
- (B) THERMOPLASTIC PAVEMENT MARKING
WHITE, 24"
- (C) THERMOPLASTIC PAVEMENT MARKING
WHITE, 4"
- (D) TWO-WAY AMBER MARKER
40' C/C UNLESS OTHERWISE INDICATED

BENCH MARK:

*" CUT ON NEX CONC BASE OF ALUM LT
POLE ON NWX 167TH PL AND PRINCE DRIVE
ELEVATION = 600.275

FILE NAME = 08188_01-PVAK-01 - IDOT P03	USER NAME =	DESIGNED -- JPH	REVISED --	STATE OF ILLINOIS DEPARTMENT OF TRANSPORTATION	PRINCE DRIVE RESURFACING 170TH STREET TO WOODLAWN EAST AVENUE PAVEMENT MARKING			F.A.I. RTE.	SECTION	COUNTY	TOTAL SHEETS	SHEET NO.
	PLOT SCALE =	CHECKED -- PKB	REVISED --		94	10-00088-00-RS	COOK	18	10			
	PLOT DATE = 08-22-10	DRAWN -- RG	REVISED --		CONTRACT NO. 63495							
		CHECKED -- AG	REVISED --		FED. ROAD DIST. NO. 1 ILLINOIS FED. AID PROJECT ARA-9003(668)							
				SCALE: 1"=50'		SHEET NO. 10 OF 18 SHEETS		STA. TO STA.				

SECTION 23, TOWNSHIP 36, RANGE 14

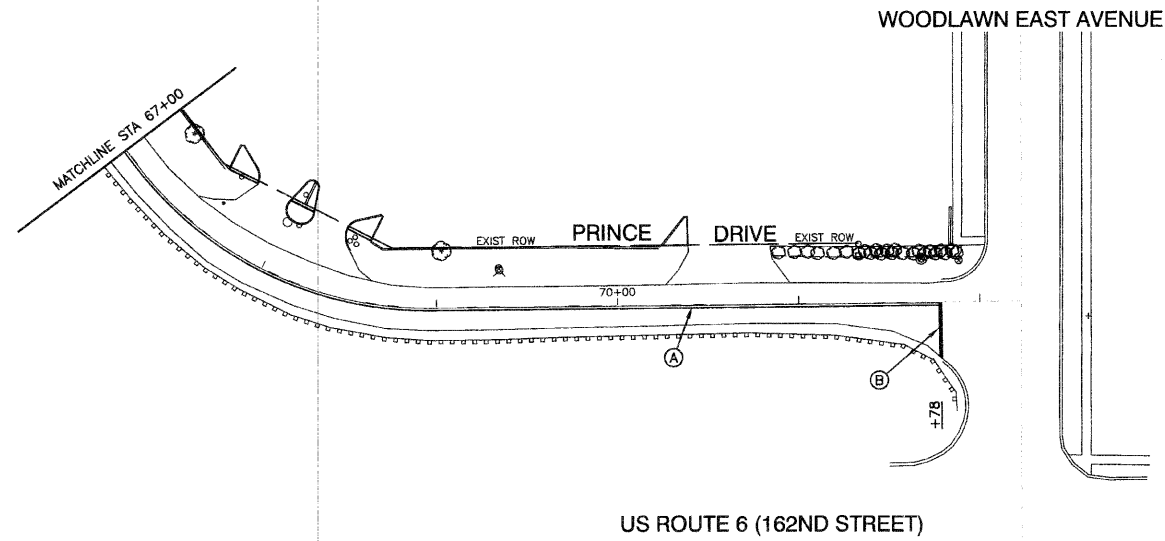

LEGEND

- (A) THERMOPLASTIC PAVEMENT MARKING
YELLOW, DOUBLE LINE, 4"
- (B) THERMOPLASTIC PAVEMENT MARKING
WHITE, 24"
- (C) THERMOPLASTIC PAVEMENT MARKING
WHITE, 4"
- ◆ TWO-WAY AMBER MARKER
40' C/C UNLESS OTHERWISE INDICATED

BENCH MARK:

"X" CUT ON NEX CONC BASE OF ALUM LT
POLE ON NWX 167TH PL AND PRINCE DRIVE
ELEVATION = 600.275

FILE NAME = 06185_01-FVMK-01 - IDOT P&4	USER NAME =	DESIGNED -- JPH	REVISED --
		CHECKED -- PKB	REVISED --
	PLOT SCALE =	DRAWN -- RG	REVISED --
	PLOT DATE = 06-22-10	CHECKED -- AG	REVISED --

STATE OF ILLINOIS
DEPARTMENT OF TRANSPORTATION

PRINCE DRIVE RESURFACING 170TH STREET TO WOODLAWN EAST AVENUE PAVEMENT MARKING		F.A.I. RTE.	SECTION	COUNTY	TOTAL SHEETS	SHEET NO.
SCALE: 1"=50'		94	10-00088-00-RS	COOK	18	11
SHEET NO. 11 OF 18 SHEETS		STA. TO STA.		CONTRACT NO. 63495		
		FED. ROAD DIST. NO. 1		ILLINOIS	FED. AID PROJECT ARA-9003(668)	

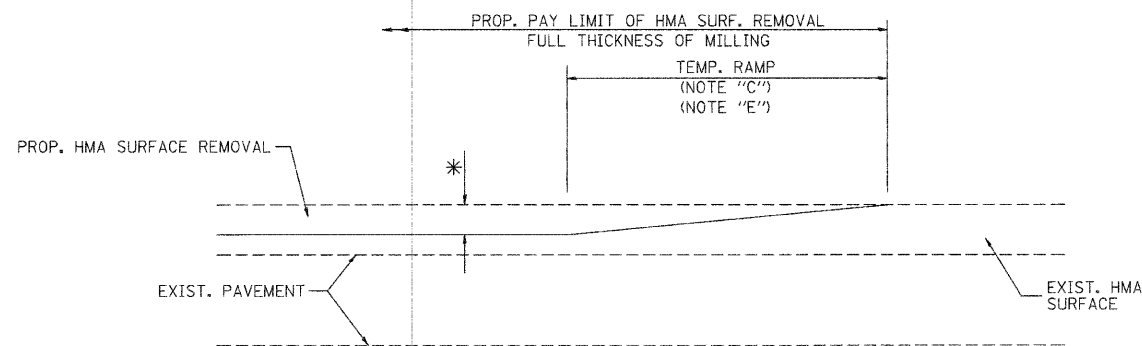

MILLED TEMPORARY RAMP
(FOR BUTT JOINT AND HMA TAPER SEE DETAIL BELOW)

OPTION 1

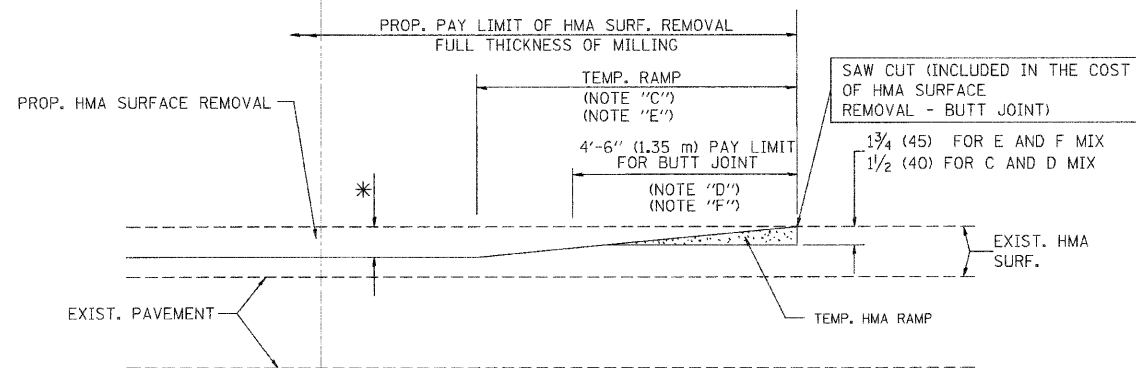

HMA CONSTRUCTED TEMPORARY RAMP
(FOR BUTT JOINT AND HMA TAPER SEE DETAIL BELOW)

OPTION 2

TYPICAL TEMPORARY RAMP

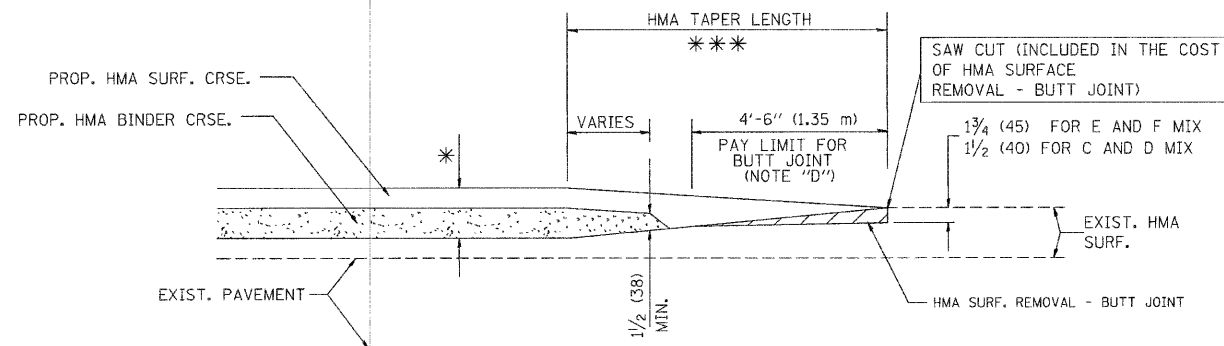

BUTT JOINT AND HMA TAPER

TYPICAL BUTT JOINT AND HMA TAPER
FOR MILLING AND RESURFACING

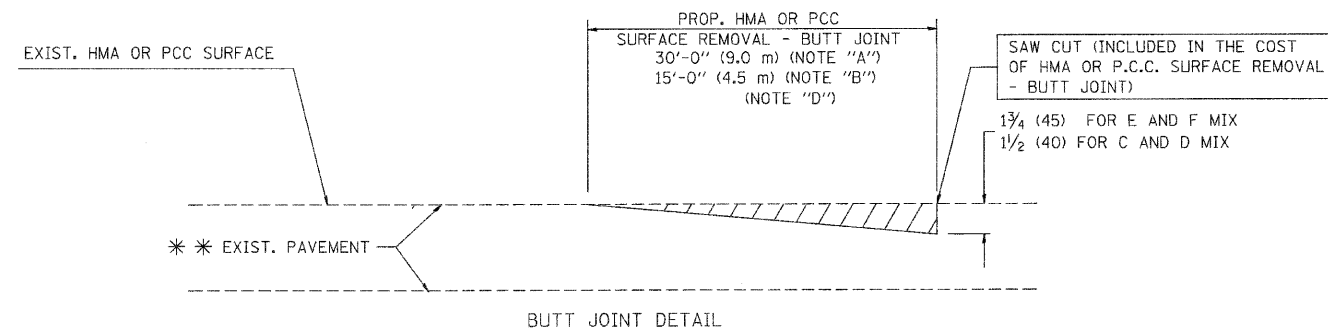

BUTT JOINT DETAIL

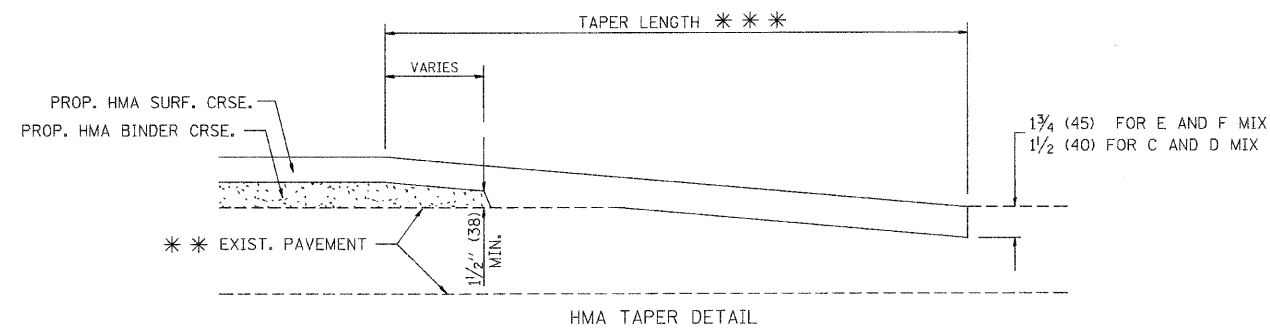

HMA TAPER DETAIL

TYPICAL BUTT JOINT AND HMA TAPER
FOR RESURFACING ONLY

*** PC CONCRETE, HMA OR HMA RESURFACED PAVEMENT.

NOTES

- A: MAINLINE ROADWAYS AND MAJOR SIDE ROADS.
 - B: MINOR SIDE ROADS.
 - C: THE TEMP. RAMP SHALL BE CONSTRUCTED IMMEDIATELY UPON REMOVAL OF THE EXISTING HMA SURFACE.
 - D: THE BUTT JOINT SHALL BE CONSTRUCTED IMMEDIATELY PRIOR TO PLACING THE PROPOSED HMA COURSES.
 - E: TAPER THE TEMP. RAMP AT A RATE OF 3'-0" (900 mm) PER 1 INCH (25 mm) OF MILLING THICKNESS.
 - F: INSTALLATION AND REMOVAL OF THE 4'-6" (1.35 m) TEMP. RAMP IS INCLUDED IN COST OF HMA SURFACE REMOVAL - BUTT JOINT
 - G: SEE ARTICLE 406.08 AND 406.14 OF THE STANDARD SPECIFICATIONS FOR "HMA AND/OR PCC SURFACE REMOVAL, BUTT JOINT".
- * SEE TYPICAL SECTIONS FOR MILLING THICKNESS.
- *** 20'-0" (6.1 m) PER 1 (25) RESURFACING (NOTE "A")
10'-0" (3.0 m) PER 1 (25) RESURFACING (NOTE "B")

BASIS OF PAYMENT:

THE BUTT JOINT WILL BE PAID FOR AT THE CONTRACT UNIT PRICE PER SQUARE YARD (SQUARE METER) FOR "HOT-MIX ASPHALT SURFACE REMOVAL - BUTT JOINT" OR FOR "PORTLAND CEMENT CONCRETE SURFACE REMOVAL - BUTT JOINT".

ALL DIMENSIONS ARE IN INCHES (MILLIMETERS) UNLESS OTHERWISE SHOWN.

FILE NAME = 06185_01-DTL-S-01-BD32 - BD-32

USER NAME = gegltenobt	DESIGNED -- M. DE YONG	REVISED -- R. SHAH 10-25-94
	CHECKED --	REVISED -- A. ABBAS 03-21-97
PLOT SCALE = 5/8" = 1" / IN.	DRAWN --	REVISED -- M. GOMEZ 04-06-01
PLOT DATE = 1/4/2008	CHECKED -- 06-13-90	REVISED -- R. BORO 01-01-07

STATE OF ILLINOIS
DEPARTMENT OF TRANSPORTATION

SCALE:		SHEET NO. 12 OF 18 SHEETS		STA. TO STA.	
BUTT JOINT AND HMA TAPER DETAILS					

F.A.I. RTE.	SECTION	COUNTY	TOTAL SHEETS	SHEET NO.
94	10-00088-00-RS	COOK	18	12
BD400-05 BD32		CONTRACT NO. 63495		
FED. ROAD DIST. NO. 1 ILLINOIS FED. AID PROJECT ARA-9003(668)				

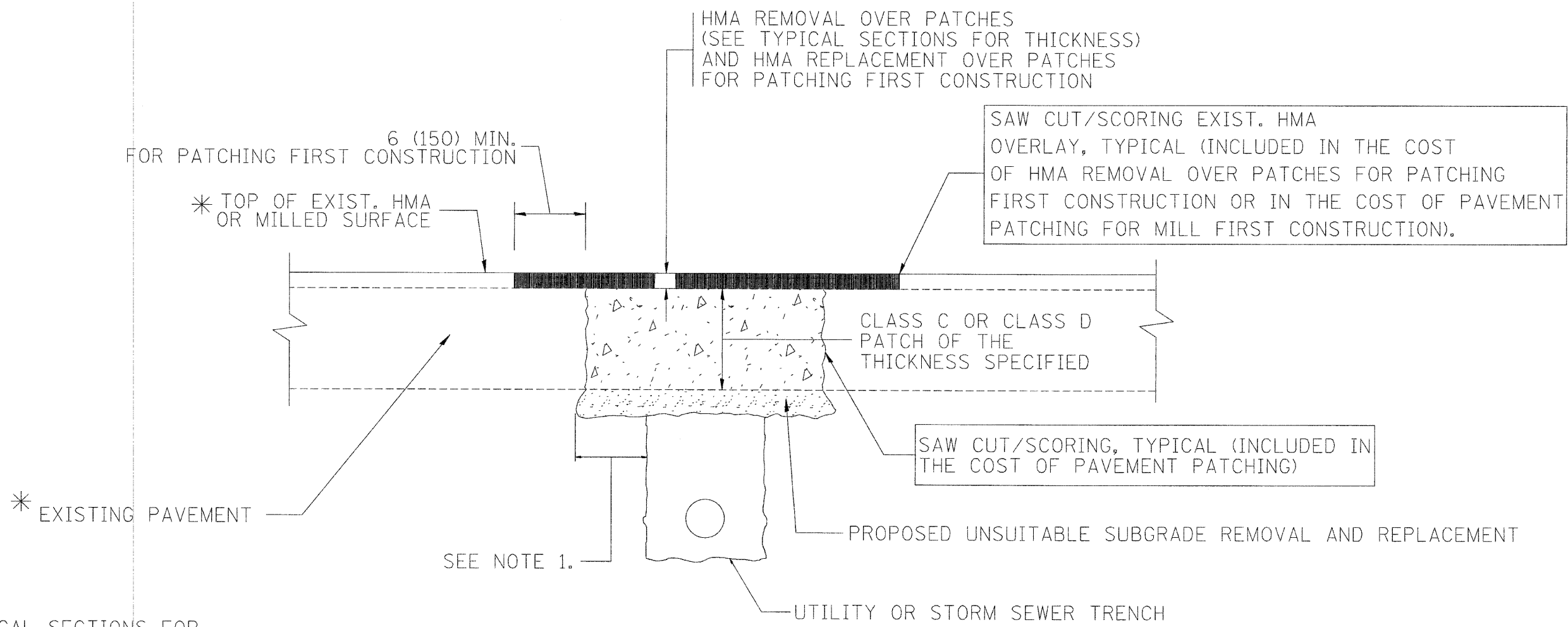

* SEE TYPICAL SECTIONS FOR THICKNESS AND MATERIALS

NOTES:

1. THE WIDTH OF THE FULL DEPTH PATCH OVER A TRENCH SHALL BE 12 (300) WIDER ON EACH SIDE OF THE TRENCH.
2. FOR METHOD OF MEASUREMENT AND BASIS OF PAYMENT, SEE RECURRING SPECIAL PROVISION "PATCHING WITH HOT-MIX ASPHALT OVERLAY REMOVAL".

SEQUENCE OF CONSTRUCTION (PATCHING FIRST)

1. REMOVE THE EXISTING HMA MATERIAL OVER THE AREA TO BE PATCHED.
2. REMOVE AND REPLACE WITH CLASS C OR D PATCH.
3. REPLACE HMA MATERIAL OVER THE AREA TO BE PATCHED.

SEQUENCE OF CONSTRUCTION (MILLING FIRST)

1. MILL HMA FIRST IF THERE IS AT LEAST 4 1/2 INCHES OR MORE OF HMA MATERIAL ON TOP OF THE EXISTING PAVEMENT OR IF THE PAVEMENT IS FULL DEPTH HMA. A MINIMUM OF 2 INCHES OF HMA MATERIAL SHALL BE IN PLACE AFTER MILLING.
2. REMOVE AND REPLACE WITH FULL DEPTH CLASS D PATCHES TO TOP OF MILLED SURFACE.

ALL DIMENSIONS ARE IN INCHES (MILLIMETERS) UNLESS OTHERWISE SHOWN.

FILE NAME = 06165_01-DT15-02-8D22 - BD-22	USER NAME = bauerdl	DESIGNED -- R. SHAH	REVISED -- A. ABBAS 04-27-98	STATE OF ILLINOIS DEPARTMENT OF TRANSPORTATION	PAVEMENT PATCHING FOR HMA SURFACED PAVEMENT	F.A.I. RTE.	SECTION	COUNTY	TOTAL SHEETS	SHEET NO.	
		CHECKED --	REVISED -- R. BORO 01-01-07			94	10-00088-00-RS	COOK	18	13	
		PLOT SCALE = 50.000' / 1" IN.	REVISED -- R. BORO 09-04-07			BD400-04 (BD-22)		CONTRACT NO. 63495			
		PLOT DATE = 10/27/2006	REVISED -- K. ENG 10-27-08			SCALE:	SHEET NO. 13 OF 18 SHEETS	STA.	TO STA.		FED. ROAD DIST. NO. 1 ILLINOIS FED. AID PROJECT ARA-9003(668)

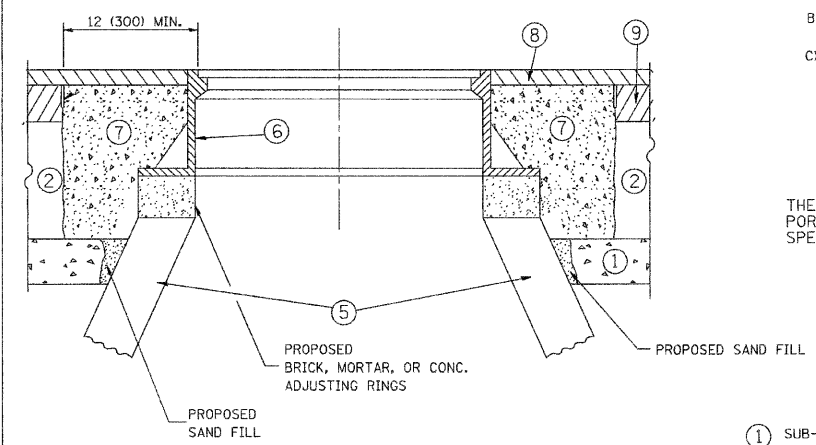
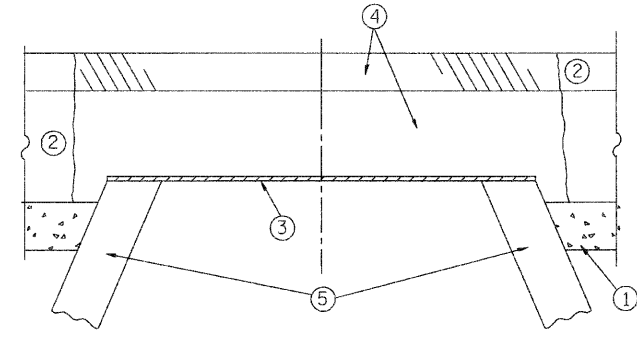

CONSTRUCTION PROCEDURES

STAGE 1 (BEFORE PAVEMENT MILLING)

- A) REMOVE A MINIMUM OF 12 (300) OF THE PAVEMENT FROM AROUND THE STRUCTURE.
- B) REMOVE THE EXISTING FRAME AND LID FROM THE STRUCTURE.
- C) COVER THE STRUCTURE OPENING WITH A 36 (900) DIAMETER METAL PLATE.
- D) BACKFILL WITH CRUSHED STONE AND A MINIMUM 1/2 (40) THICK HMA SURFACE MIX APPROVED BY THE ENGINEER.

STAGE 2 (AFTER PAVEMENT MILLING)

- A) REMOVE THE HMA SURFACE MIX AND CRUSHED STONE.
- B) INSTALL THE FRAME AND LID; ADJUST THE FRAME TO ITS FINAL SURFACE ELEVATION.
- C) THE SURROUNDING SPACE SHALL BE FILLED WITH CLASS SI CONCRETE, OR HMA SURFACE COURSE OR HMA BINDER COURSE TO THE ELEVATION OF THE SURFACE OF THE EXISTING BASE COURSE OR THE BINDER COURSE.

THE PROCEDURE EXPLAINED ABOVE SHALL CONFORM TO THE APPLICABLE PORTIONS OF SECTIONS 353, 406, 602, AND 603 OF THE STANDARD SPECIFICATIONS.

LEGEND

- ① SUB-BASE GRANULAR MATERIAL
- ② EXISTING PAVEMENT
- ③ 36 (900) DIAMETER METAL PLATE
- ④ PROPOSED CRUSHED STONE AND HMA SURFACE MIX
- ⑤ EXISTING STRUCTURE
- ⑥ FRAME AND LID (SEE NOTES)
- ⑦ CLASS SI CONCRETE, HMA SURFACE COURSE OR HMA BINDER COURSE
- ⑧ PROPOSED HMA SURFACE COURSE
- ⑨ PROPOSED HMA BINDER COURSE

NOTES:

EXISTING BROKEN FRAMES AND LIDS SHALL BE REMOVED AND DISPOSED OF BY THE CONTRACTOR AND SHALL BE REPLACED AS DIRECTED BY THE ENGINEER. REPLACEMENT FRAMES AND LIDS WILL BE PAID FOR IN ACCORDANCE WITH ARTICLE 109.04 OF THE STANDARD SPECIFICATIONS UNLESS A SEPARATE PAY ITEM HAS BEEN PROVIDED.

IF THE EXISTING LIDS ARE OPEN, THE FRAME WILL BE ADJUSTED TO THE ELEVATION OF THE MILLED PAVEMENT SURFACE PRIOR TO THE MILLING OPERATION. THE FRAME WILL NOT BE REMOVED AND COVERED BY THE METAL PLATE.

CITY OF CHICAGO CASTINGS ARE THE PROPERTY OF THE CITY AND THE CONTRACTOR SHALL NOTIFY THE CITY FOR REMOVAL AND DISPOSITION OF THE CASTINGS.

THE METAL PLATE USED TO COVER THE STRUCTURE SHALL REMAIN THE PROPERTY OF THE CONTRACTOR.

WHEN STRUCTURES ARE TO BE ADJUSTED OR RECONSTRUCTED, THE LOWERING AND RAISING OF THE FRAMES AND LIDS WILL NOT BE PAID FOR SEPARATELY BUT WILL BE INCLUDED IN THE COST OF THE CORRESPONDING PAY ITEM.

LOCATION OF STRUCTURES:

THE CONTRACTOR WILL BE REQUIRED TO KEEP A RECORD OF THE LOCATIONS OF THE BURIED STRUCTURES ACCORDING TO THE STATION AND DISTANCE LEFT OR RIGHT OF THE CENTERLINE OF PAVEMENT. UPON COMPLETION OF THE WORK, THE CONTRACTOR WILL DELIVER THE RECORD TO THE ENGINEER.

BASIS OF PAYMENT: THIS WORK WILL BE PAID FOR AT THE CONTRACT UNIT PRICE PER EACH FOR "FRAMES AND LIDS TO BE ADJUSTED, SPECIAL"

NEW FRAMES AND LIDS, WHEN SPECIFIED, WILL BE PAID FOR SEPARATELY.

DETAILS FOR FRAMES AND LIDS ADJUSTMENT WITH MILLING

ALL DIMENSIONS ARE IN INCHES (MILLIMETERS) UNLESS OTHERWISE SHOWN

FILE NAME = 06186_01-DTIS-03-BD06 - BD-08	USER NAME = geglianob	DESIGNED -- R. SHAH	REVISED --R. SHAH 03-10-95	STATE OF ILLINOIS DEPARTMENT OF TRANSPORTATION	DETAILS FOR FRAMES AND LIDS ADJUSTMENT WITH MILLING	F.A.I. RTE.	SECTION	COUNTY	TOTAL SHEETS	SHEET NO.	
		CHECKED --	REVISED -- A. ABBAS 03-21-97			94	10-00088-00-RS	COOK	18	14	
		PLOT SCALE = 50.0000 / IN.	REVISED --R. WIEDEMAN 05-14-04			BD600-03 (BD-9)		CONTRACT NO. 63495			
		PLOT DATE = 1/4/2000	CHECKED -- 10-25-94			REVISED -- R. BORO 01-01-07	SCALE:	SHEET NO. 14	OF 18 SHEETS	STA.	TO STA.

VARIABLE - TO MEET EXISTING DIMENSIONS AND FIELD CONDITIONS (SEE NOTE ②)

PROP. CONC. CURB OR CURB AND GUTTER REPLACEMENT IN ACCORDANCE WITH STATE STANDARD 606001. (SEE NOTE ②)

SAW CUT FULL DEPTH - INCLUDED IN THE COST OF SIDEWALK, DRIVEWAY OR MEDIAN SURFACE REMOVAL PAY ITEM.

SEE STATE STANDARD 606001
EXISTING OR PROPOSED HMA SURFACE (IF APPLICABLE)

18" (450) MAX.

1/4" (5) **

EXISTING SIDEWALK, DRIVEWAY, MEDIAN SURFACE, SOD OR GROUND.

PROPOSED SIDEWALK, DRIVEWAY PAVEMENT, MEDIAN SURFACE OR SODDING SALT TOLERANT WITH TOP SOIL, 4" (100) SOD RESTORATION (SEE NOTE ①).

EXISTING CONCRETE PAVEMENT, CONCRETE BASE COURSE OR FLEXIBLE PAVEMENT

SUITABLE BACKFILL MATERIAL (INCLUDED IN THE COST OF CURB OR CURB AND GUTTER REMOVAL AND REPLACEMENT)

3" (75) MIN.

PROPOSED 3/4" (20) PREFORMED EXPANSION JOINT AT CONCRETE SIDEWALKS, DRIVEWAYS, AND MEDIANS. (INCLUDED IN THE COST OF CURB OR CURB AND GUTTER REMOVAL AND REPLACEMENT.)

* 3" (75) MINIMUM FROM TOP AND BOTTOM OF THE CONCRETE PAVEMENT OR BASE COURSE.

** IF THE FINAL SURFACE OF THE PAVEMENT IS CONCRETE, THE GUTTER IS TO BE FLUSH WITH THE PAVEMENT.

UNSUITABLE SUB-BASE MATERIAL TO BE REMOVED, IF DIRECTED BY THE ENGINEER, SHALL BE REPLACED WITH EITHER SUB-BASE GRANULAR MATERIAL, TYPE B OR ADDITIONAL THICKNESS OF CONCRETE.

NOTE: ① SIDEWALK, DRIVEWAY PAVEMENT OR MEDIAN SURFACE SHALL BE SIMILAR TO THE MATERIAL BEING REMOVED AND WILL BE PAID FOR SEPARATELY.

SODDING, SALT TOLERANT AND TOP SOIL, FURNISH AND PLACE 4" WILL BE PAID FOR SEPARATELY.

REMOVAL AND REPLACEMENT 4" (100) OR LESS IS INCLUDED IN THE COST OF CURB OR CURB AND GUTTER REMOVAL AND REPLACEMENT.

② FERTILIZER FOR THE PLACEMENT OF THE SOD IS NOT REQUIRED

③ CURB OR CURB AND GUTTER REPLACEMENT SHALL MATCH THE SHAPE OF THE EXISTING CURB OR CURB AND GUTTER UNLESS OTHERWISE SPECIFIED.

REMOVAL AND REPLACEMENT IN EXCESS OF 4" (100) WILL BE PAID FOR IN ACCORDANCE WITH ARTICLE 109.04 OF THE STANDARD SPECIFICATIONS.

④ FOR CURB OR CURB AND GUTTER REMOVAL AND REPLACEMENT ADJACENT TO FLEXIBLE PAVEMENT DELETE EPOXY COATED TIE BARS.

PROPOSED #6 (20) EPOXY COATED TIE BARS 24" (600) LONG AT 24" (600) CENTERS WILL NOT BE PAID FOR SEPARATELY. DELETE EPOXY COATED TIE BARS IF EXISTING TIE BARS ARE USUABLE AS DETERMINED BY THE ENGINEER. (SEE NOTE ③).

⑤ LONGITUDINAL BARS, IF ENCOUNTERED IN THE EXISTING CURB OR CURB AND GUTTER, ARE NOT TO BE REPLACED. CUTTING AND REMOVING LONGITUDINAL BARS SHALL BE INCLUDED IN THE COST OF CURB OR CURB AND GUTTER REMOVAL AND REPLACEMENT.

⑥ THE COST OF HMA SURFACE REMOVAL IN THE EXISTING GUTTER FLAG SHALL BE INCLUDED IN THE COST OF THE CURB AND GUTTER REMOVAL AND REPLACEMENT.

BASIS OF PAYMENT:

THIS WORK WILL BE PAID FOR AT THE CONTRACT UNIT PRICE PER FOOT (METER) FOR "CURB REMOVAL AND REPLACEMENT" OR "COMBINATION CONCRETE CURB AND GUTTER REMOVAL AND REPLACEMENT".

⑦ THE REMOVAL AND REPLACEMENT OF THE EXISTING CURB OR CURB AND GUTTER SHALL BE DONE IN ACCORDANCE WITH THE APPLICABLE PORTIONS OF SECTION 440 AND 606 OF THE STANDARD SPECIFICATIONS.

⑧ THE LOCATIONS OF REMOVAL AND REPLACEMENT OF EXISTING CURB OR CURB AND GUTTER SHALL BE DETERMINED BY THE RESIDENT ENGINEER AT THE TIME OF CONSTRUCTION.

CURB OR CURB AND GUTTER REMOVAL AND REPLACEMENT

ALL DIMENSIONS ARE IN INCHES (MILLIMETERS) UNLESS OTHERWISE SHOWN.

FILE NAME = 06185_01-DTLS-04-BD24 - BD-24	USER NAME = drvakoesgn	DESIGNED -- A. HOUSEH	REVISED -- R. SHAH 10-03-96	STATE OF ILLINOIS DEPARTMENT OF TRANSPORTATION	CURB OR CURB AND GUTTER REMOVAL AND REPLACEMENT	F.A.I. RTE.	SECTION	COUNTY	TOTAL SHEETS	SHEET NO.
	CHECKED --	REVISED -- A. ABBAS 03-21-97	94			10-0088-00-RS	COOK	18	15	
	PLOT SCALE = 50.000' / IN.	DRAWN --	REVISED -- M. GOMEZ 01-22-01			BD600-06 (BD-24)		CONTRACT NO. 63495		
	PLOT DATE = 12/15/2009	CHECKED -- 03-11-94	REVISED -- R. BORO 12-15-09			SCALE:	SHEET NO. 15 OF 18 SHEETS	STA.	TO STA.	FED. ROAD DIST. NO. 1 ILLINOIS FED. AID PROJECT ARA-9003(688)

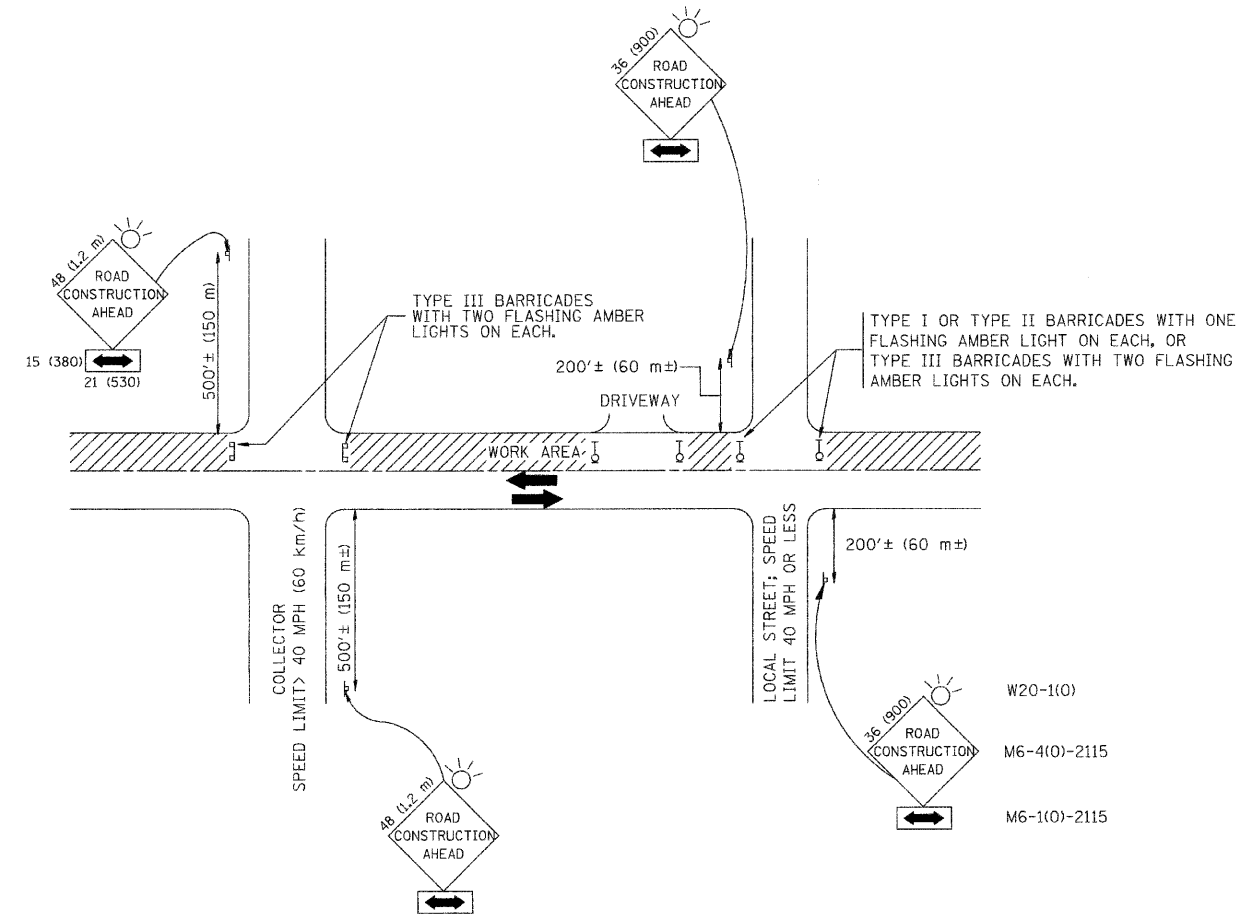

TRAFFIC CONTROL AND PROTECTION FOR SIDE ROADS, INTERSECTIONS, AND DRIVEWAYS

NOTES:

- A. FOR NO LANE RESTRICTION ON THE SIDE ROAD OR DRIVEWAYS
 1. SIDE ROAD WITH A SPEED LIMIT OF 40 MPH (60 km/h) OR LESS AS SHOWN ON THE DRAWING AND AS DIRECTED BY THE ENGINEER:
 - a) ONE ROAD CONSTRUCTION AHEAD SIGN 36 x 36 (900x900) WITH A FLASHER AND FLAG MOUNTED ON IT APPROXIMATELY 200' (60 m) IN ADVANCE OF THE MAIN ROUTE.
 - b) THE CLOSED PORTION OF THE MAIN ROUTE SHALL BE PROTECTED BY BLOCKING WITH TYPE I, TYPE II OR TYPE III BARRICADES, 1/3 OF THE CROSS SECTION OF THE CLOSED PORTION.
 2. SIDE ROAD WITH A SPEED LIMIT GREATER THAN 40 MPH (60 km/h) AS SHOWN ON THE DRAWING AND AS DIRECTED BY THE ENGINEER:
 - a) ONE ROAD CONSTRUCTION AHEAD SIGN 48 x 48 (1.2 m x 1.2 m) WITH A FLASHER MOUNTED ON IT APPROXIMATELY 500' (150 m) IN ADVANCE OF THE MAIN ROUTE.
 - b) THE CLOSED PORTION OF THE MAIN ROUTE SHALL BE PROTECTED BY BLOCKING WITH TYPE III BARRICADES, 1/2 OF THE CROSS SECTION OF THE CLOSED PORTION.
- 3. WHEN THE SIDE ROAD LIES BETWEEN THE BEGINNING OF THE MAINLINE SIGNING AND THE WORK ZONE, A SINGLE HEADED ARROW (M6-1) SHALL BE USED IN LIEU OF THE DOUBLE HEADED ARROW (M6-4).
- B. FOR A LANE CLOSURE ON A SIDE ROAD OR DRIVEWAY:

USE APPLICABLE PORTIONS OF THE TYPICAL APPLICATION OF TRAFFIC CONTROL DEVICES (STD. 701501, STD. 701606 OR THE APPROPRIATE STANDARD). THE SPACING OF SIGNS AND BARRICADES SHALL BE ADJUSTED FOR FIELD CONDITIONS AS DIRECTED BY THE ENGINEER. THE DIRECTIONAL ARROW SHALL BE COVERED OR REMOVED WHEN NO LONGER CONSISTENT WITH THE SIDE ROAD LANE CLOSURE.
- C. ADVANCE WARNING SIGNS ARE TO BE OMITTED ON DRIVEWAY UNLESS OTHERWISE NOTED.
- D. THE TRAFFIC CONTROL AND PROTECTION FOR SIDE ROADS, INTERSECTIONS, AND DRIVEWAYS SHALL BE INCIDENTAL TO THE COST OF SPECIFIED TRAFFIC CONTROL STANDARDS OR ITEMS.

All dimensions are in millimeters (inches) unless otherwise shown.

FILE NAME = 06185_01-DTLS 05 TC10 - TC-10	USER NAME = gegl1amobt	DESIGNED -- LHA	REVISED -- J. OBERLE 10-18-95	STATE OF ILLINOIS DEPARTMENT OF TRANSPORTATION	TRAFFIC CONTROL AND PROTECTION FOR SIDE ROADS, INTERSECTIONS, AND DRIVEWAYS	F.A.I. RTE.	SECTION	COUNTY	TOTAL SHEETS	SHEET NO.	
		CHECKED --	REVISED -- A. HOUSEH 03-06-96			94	10-00088-00-RS	COOK	18	18	
		PLOT SCALE = 50.000' / IN.	REVISED -- A. HOUSEH 10-15-96			TC-10		CONTRACT NO. 63495			
		PLOT DATE = 1/4/2008	CHECKED -- 06-89			REVISED -- T. RAMMACHER 01-06-00	SCALE:	SHEET NO. 16 OF 18 SHEETS	STA.	TO STA.	
						FED. ROAD DIST. NO. 1 ILLINOIS FED. AID PROJECT ARA-9003(668)					

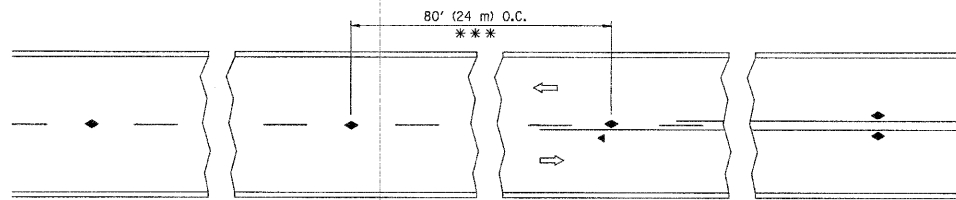

*** REDUCE TO 40' (12 m) O.C. ON CURVES WITH POSTED OR ADVISORY SPEED 45 M.P.H. (70 km/h) OR LESS.

TWO-LANE/TWO-WAY

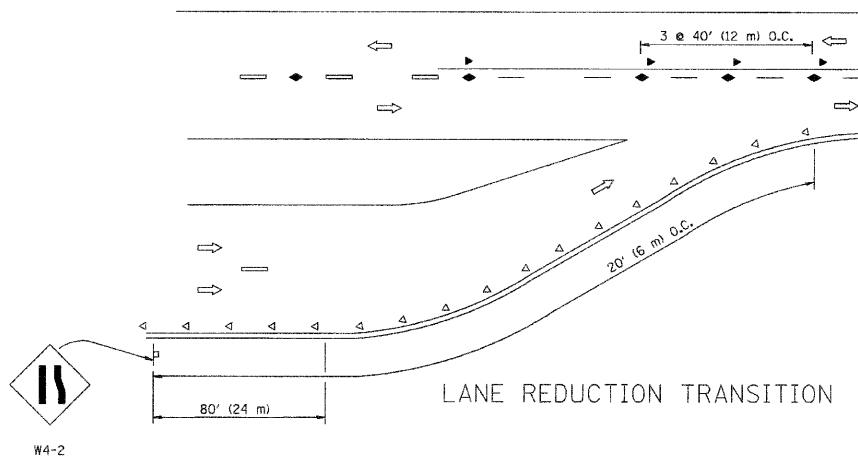

LANE REDUCTION TRANSITION

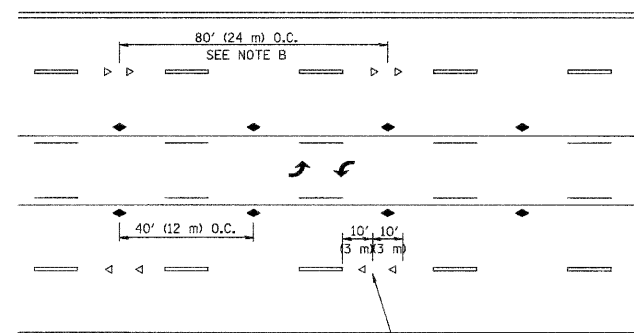

TWO-WAY LEFT TURN

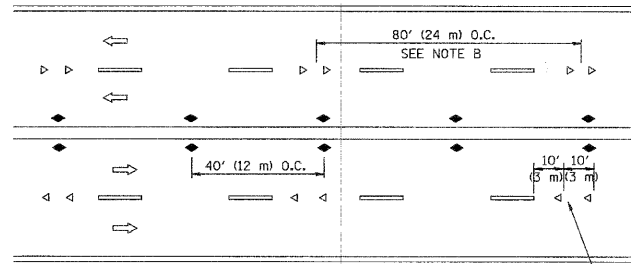

MULTI-LANE/UNDIVIDED

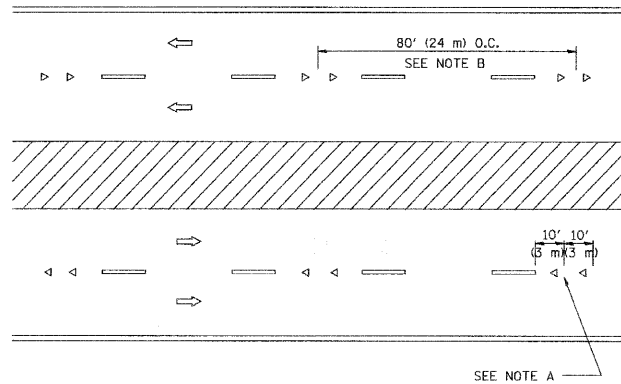

MULTI-LANE/DIVIDED

GENERAL NOTES

1. MARKERS USED WITH DASHED LINES SHALL BE CENTERED IN THE GAP BETWEEN SEGMENTS.
2. MARKERS USED ADJACENT TO SOLID LINES SHALL BE OFFSET 2 TO 3 (50 TO 75) TOWARD TRAFFIC AS SHOWN.
3. MARKERS THROUGH TANGENTS LESS THAN 500' (150 m) IN LENGTH BETWEEN CURVES SHALL BE INSTALLED AT THE LESSER OF THE TWO CURVE SPACINGS.

SYMBOLS

- YELLOW STRIPE
- WHITE STRIPE
- ◀ ONE-WAY AMBER MARKER
- ◁ ONE-WAY CRYSTAL MARKER (W/O)
- ◆ TWO-WAY AMBER MARKER

LANE MARKER NOTES

- A. USE DOUBLE LANE LINE MARKERS SPACED AS SHOWN.
- B. REDUCE TO 40' (12 m) O.C. ON CURVES WHERE ADVISORY SPEEDS ARE 10 M.P.H (20 km/h) LOWER THAN POSTED SPEEDS.

DESIGN NOTES

1. DOUBLE LANE LINE MARKERS SHALL BE USED UNLESS SPECIFIED OTHERWISE.
2. EXCEPT AS SHOWN ON THE LANE REDUCTION TRANSITION AND FREEWAY EXIT RAMP DETAIL, MARKERS ARE NOT TO BE SPECIFIED ON RIGHT EDGE LINES.
3. THE EXACT MARKER LIMITS, SPACING, AND COLOR SHOULD BE INCLUDED IN THE PLANS.
4. MARKERS SHOULD NOT BE USED ALONGSIDE CURBS EXCEPT FOR EXTREMELY SHORT SECTIONS OF CURBS WHERE NOT MORE THAN TWO MARKERS WOULD BE INVOLVED.

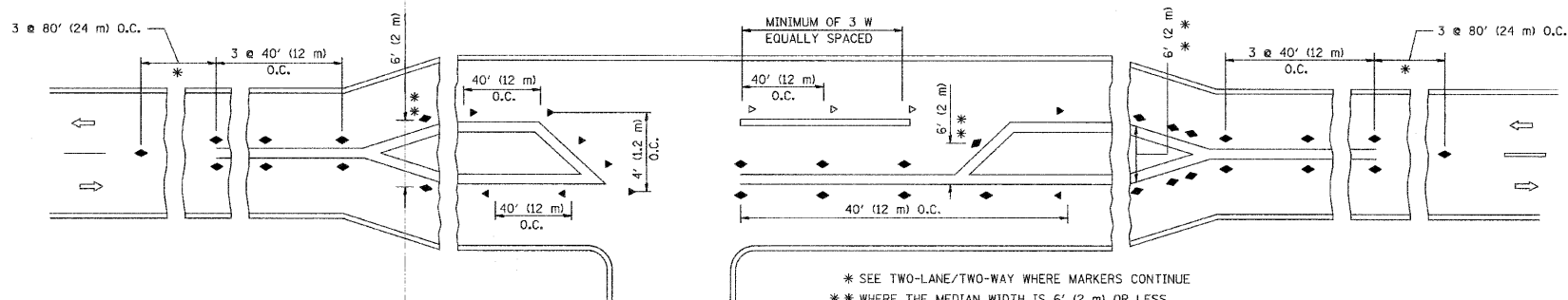

LEFT TURN

* SEE TWO-LANE/TWO-WAY WHERE MARKERS CONTINUE
 ** WHERE THE MEDIAN WIDTH IS 6' (2 m) OR LESS USE TWO-WAY MARKERS.

All dimensions are in inches (millimeters) unless otherwise shown.

FILE NAME = 08185_01-DTLS-07-TC11 -TC-11

USER NAME = drvakasgn
 PLOT SCALE = 50,000' / IN.
 PLOT DATE = 9/9/2009

DESIGNED —
 CHECKED —
 DRAWN —
 CHECKED —

REVISED —T. RAMMACHER 09-19-94
 REVISED —T. RAMMACHER 03-12-99
 REVISED —T. RAMMACHER 01-06-00
 REVISED —C. JUICIUS 09-09-09

STATE OF ILLINOIS
 DEPARTMENT OF TRANSPORTATION

TYPICAL APPLICATIONS
 RAISED REFLECTIVE PAVEMENT MARKERS (SNOW-PLOW RESISTANT)

SCALE: SHEET NO. 17 OF 18 SHEETS STA. TO STA.

F.A.I. RTE.	SECTION	COUNTY	TOTAL SHEETS	SHEET NO.
94	10-00088-00-RS	COOK	18	17
TC-11		CONTRACT NO. 63495		
FED. ROAD DIST. NO. 1		ILLINOIS FED. AID PROJECT ARA-8003(688)		

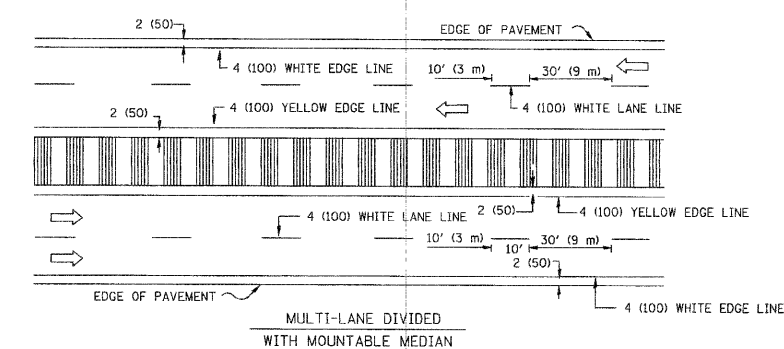
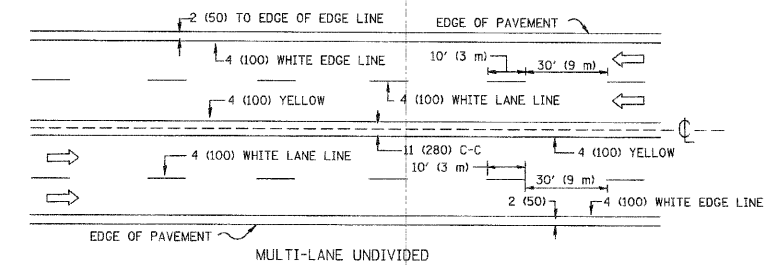
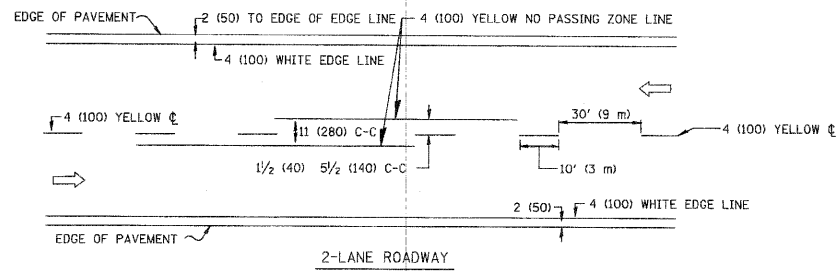

TYPICAL LANE AND EDGE LINE MARKING

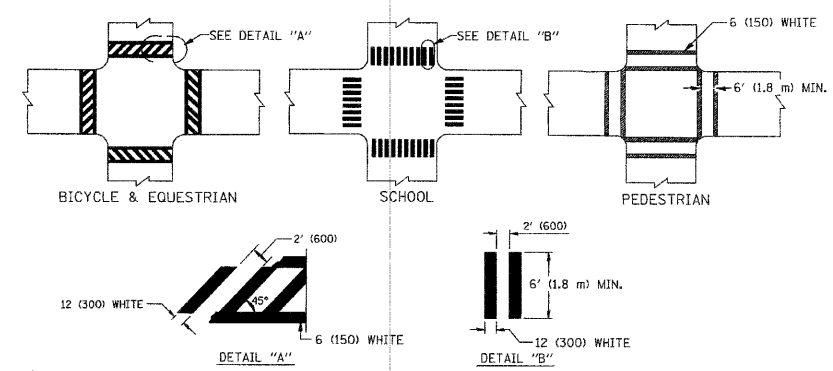

TYPICAL CROSSWALK MARKING

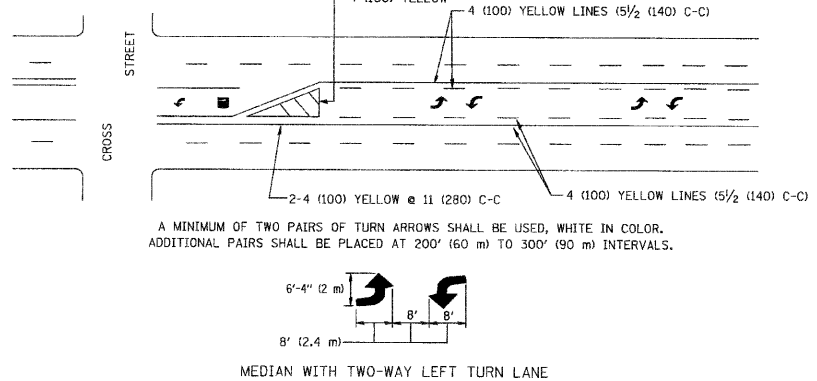
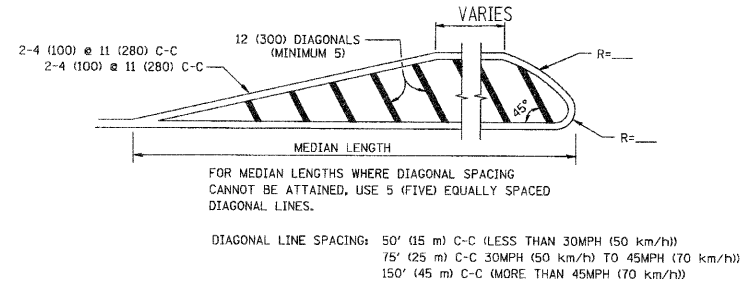
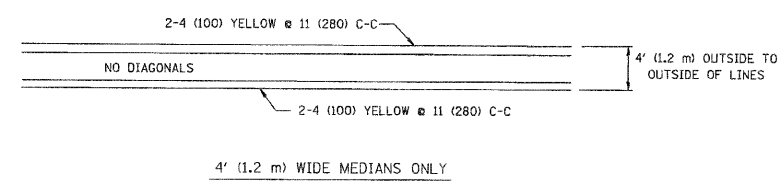

TYPICAL PAINTED MEDIAN MARKING

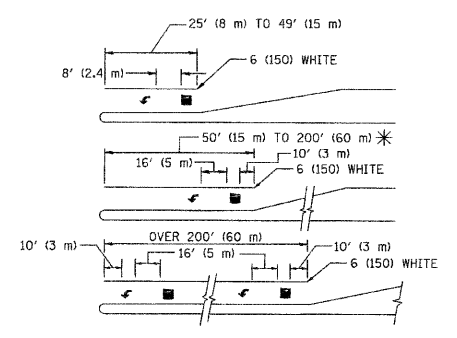

TYPICAL LEFT (OR RIGHT) TURN LANE

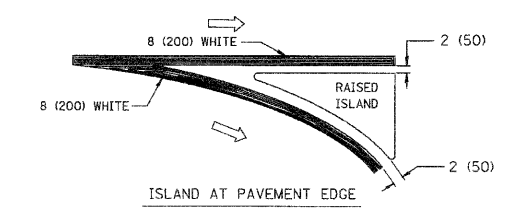
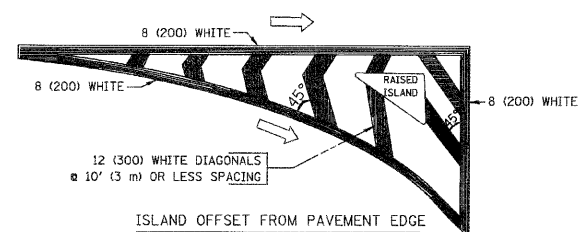

TYPICAL ISLAND MARKING

TYPE OF MARKING	WIDTH OF LINE	PATTERN	COLOR	SPACING / REMARKS
CENTERLINE ON 2 LANE PAVEMENT	4 (100)	SKIP-DASH	YELLOW	10' (3 m) LINE WITH 30' (9 m) SPACE
CENTERLINE ON MULTI-LANE UNDIVIDED PAVEMENT	2 @ 4 (100)	SOLID	YELLOW	11 (280) C-C
NO PASSING ZONE LINES FOR ONE DIRECTION	4 (100)	SOLID	YELLOW	5/2 (140) C-C FROM SKIP-DASH CENTERLINE
NO PASSING ZONE LINES FOR BOTH DIRECTIONS	2 @ 4 (100)	SOLID	YELLOW	11 (280) C-C OMIT SKIP-DASH CENTERLINE BETWEEN
LANE LINES	4 (100)	SKIP-DASH	WHITE	10' (3 m) LINE WITH 30' (9 m) SPACE
DOTTED LINES (EXTENSIONS OF CENTER, LANE OR TURN LANE MARKINGS)	5 (125) ON FREEWAYS	SKIP-DASH	WHITE	SAME AS LINE BEING EXTENDED
EDGE LINES	4 (100)	SOLID	YELLOW-LEFT WHITE-RIGHT	OUTLINE MOUNTABLE MEDIANS IN YELLOW; EDGE LINES ARE NOT USED NEXT TO BARRIER CURB
TURN LANE MARKINGS	6 (150) LINE; FULL SIZE LETTERS & SYMBOLS (8' (2.4m))	SOLID	WHITE	SEE TYPICAL TURN LANE MARKING DETAIL
TWO WAY LEFT TURN MARKING	2 @ 4 (100) EACH DIRECTION	SKIP-DASH AND SOLID	YELLOW	10' (3 m) LINE WITH 30' (9 m) SPACE FOR SKIP-DASH; 5/2 (140) C-C BETWEEN SOLID LINE AND SKIP-DASH LINE
	8' (2.4m) LEFT ARROW	IN PAIRS	WHITE	SEE TYPICAL TWO-WAY LEFT TURN MARKING DETAIL
CROSSWALK LINES (PEDESTRIAN) A. DIAGONALS (BIKE & EQUESTRIAN) B. LONGITUDINAL BARS (SCHOOL)	2 @ 6 (150) 12 (300) @ 45° 12 (300) @ 90°	SOLID SOLID SOLID	WHITE WHITE WHITE	NOT LESS THAN 6' (1.8 m) APART 2' (600) APART 2' (600) APART SEE TYPICAL CROSSWALK MARKING DETAILS.
STOP LINES	24 (600)	SOLID	WHITE	PLACE 4' (1.2 m) IN ADVANCE OF AND PARALLEL TO CROSSWALK; IF PRESENT, OTHERWISE, PLACE AT DESIRED STOPPING POINT, PARALLEL TO CROSSROAD CENTERLINE, WHERE POSSIBLE
PAINTED MEDIANS	2 @ 4 (100) WITH 12 (300) DIAGONALS @ 45° NO DIAGONALS USED FOR 4' (1.2 m) WIDE MEDIANS	SOLID	YELLOW; TWO WAY TRAFFIC WHITE; ONE WAY TRAFFIC	11 (280) C-C FOR THE DOUBLE LINE SEE TYPICAL PAINTED MEDIAN MARKING.
GORE MARKING AND CHANNELIZING LINES	8 (200) WITH 12 (300) DIAGONALS @ 45°	SOLID	WHITE	DIAGONALS: 15' (4.5 m) C-C (LESS THAN 30MPH (50 km/h)) 20' (6 m) C-C 30MPH (50 km/h) TO 45MPH (70 km/h) 30' (9 m) C-C (OVER 45MPH (70 km/h))
RAILROAD CROSSING	24 (600) TRANSVERSE LINES; "RR" IS 6' (1.8 m) LETTERS; 16 (400) LINE FOR "X"	SOLID	WHITE	SEE STATE STANDARD 780001 AREA OF: "R"=3.6 SQ. FT. (0.33 m ²) EACH "X"=54.0 SQ. FT. (5.0 m ²)
SHOULDER DIAGONALS	12 (300) @ 45°	SOLID	WHITE - RIGHT YELLOW - LEFT	50' (15 m) C-C (LESS THAN 30MPH (50 km/h)) 75' (25 m) C-C (30 MPH (50 km/h) TO 45MPH (70 km/h)) 150' (45 m) C-C (OVER 45MPH (70 km/h))

FOR FURTHER DETAILS ON PAVEMENT MARKING REFER TO STANDARD SPECIFICATIONS FOR ROAD AND BRIDGE CONSTRUCTION AND STATE STANDARD 780001.

All dimensions are in inches (millimeters) unless otherwise shown.

FILE NAME = 06185_01-DTLS-067C13 - TC-13	USER NAME = drlvakosgr	DESIGNED — EVERS	REVISED — T. RAMMACHER 10-27-94
		CHECKED —	REVISED — C. JUCIUS 09-09-0
	PLOT SCALE = 50,000' / IN.	DRAWN —	REVISED —
	PLOT DATE = 9/9/2009	CHECKED — 03-19-90	REVISED —

STATE OF ILLINOIS
DEPARTMENT OF TRANSPORTATION

DISTRICT ONE
TYPICAL PAVEMENT MARKINGS
SCALE: SHEET NO. 18 OF 18 SHEETS STA. TO STA.

F.A.I. RTE.	SECTION	COUNTY	TOTAL SHEETS	SHEET NO.
94	10-00088-00-RS	COOK	18	18
TC-13		CONTRACT NO. 63495		
FED. ROAD DIST. NO. 1		ILLINOIS FED. AID PROJECT ARA-9003(668)		