

STORM STRUCTURES						
NO.	STATION	OFFSET	TYPE	FRAME	RIM / EP	INVERT
S-14	63+85	25' RT	MANHOLE, TYPE A, 6' DIA	TY 1 CLID	769.92 RIM	763.95 36" N & S, 766.67 12" W
S-14A	63+85	18' RT	INLET, TYPE A	TY 11	770.73 EOP	768.05 12" W, 767.27 12" E
S-14B	63+85	18' LT	INLET, TYPE A	TY 11	770.73 EOP	768.23 12" E
S-15	65+10	25' RT	MANHOLE, TYPE A, 6' DIA	TY 1 CLID	771.27 RIM	763.72 36" N & S, 768.02 12" W
S-15A	65+10	18' RT	CATCH BASIN, TYPE A, 4' DIA	TY 11	772.08 EOP	768.83 12" W, 768.26 12" E
S-15B	65+10	18' LT	INLET, TYPE A	TY 11	772.08 EOP	769.58 12" E
S-16	66+52	25' RT	MANHOLE, TYPE A 6' DIA	TY 1 CL	773.40 RIM	763.47 36" N & S, 769.00 12" W
S-16A (EX)	66+52	18' RT	EX CATCH BASIN	---	---	769.03 12" E, 769.03 12" W (EX)
S-17 (EX)	67+61	21' RT	EX MANHOLE	---	---	763.28 36" S, 763.28 36" N (EX)

PIPES					
NO.	TYPE	LENGTH (LF)	DIA (IN)	SLOPE	TBF (CY)
P-13	SEE SHT. NO.19	---	---	---	---
P-14	STORM SEWERS, CLASS A, TYPE 2	125	36	0.18%	146
P-14A	STORM SEWER, (WATER MAIN REQUIREMENTS)	6	12	10.0%	2
P-14B	STORM SEWER, (WATER MAIN REQUIREMENTS)	36	12	0.50%	6
P-15	STORM SEWERS, CLASS A, TYPE 2	142	36	0.18%	36
P-15A	STORM SEWERS, CLASS A, TYPE 1	6	12	4.00%	2
P-15B	STORM SEWERS, RUBBER GASKET, CLASS A, TYPE 1	36	12	2.08%	9
P-16	STORM SEWERS, CLASS A, TYPE 2	109	36	0.17%	200
P-16A	STORM SEWERS, CLASS A, TYPE 2	6	12	0.50%	4

•• CONTROLLED LOW-STRENGTH BEDDING MATERIAL - SEE DETAIL

ATKINSON ROAD

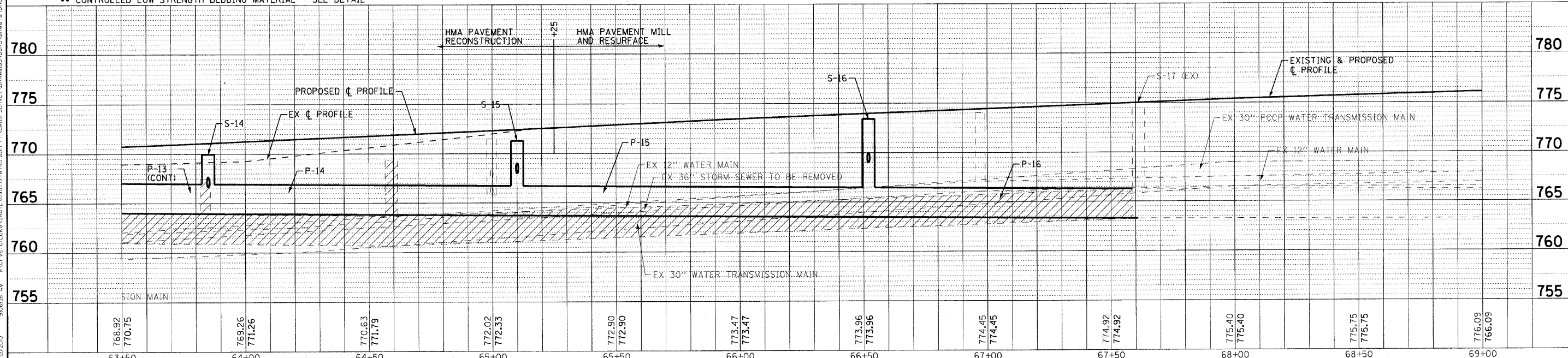

DESIGNED - DJS	REVISED - 7-12-10 IDOT REVIEW
DRAWN - LKB	REVISED -
CHECKED - RWL	REVISED -
DATE - 4-27-10	FILE - 090772-A+tkn-DU2.dgn

VILLAGE OF GRAYSLAKE, ILLINOIS ATKINSON ROAD RESURFACING AND RECONSTRUCTION IMPROVEMENTS

DRAINAGE AND UTILITY ATKINSON ROAD

SCALE: H: 1"=20' V: 1"=5'	STA. 63+50 TO STA. 69+00	F.A.U. RTE. 0198	SECTION 09-00058-00-RS	COUNTY LAKE	TOTAL SHEETS 46	SHEET NO. 20
CONTRACT NO. 63498			FED. ROAD DIST. NO. 1 ILLINOIS FED. AID PROJECT: W-9003 (485)			

COPYRIGHT © 2009 BY BAXTER & WOODMAN, INC.
 ALL RIGHTS RESERVED. THIS DRAWING IS THE PROPERTY OF BAXTER & WOODMAN, INC. AND IS NOT TO BE REPRODUCED OR TRANSMITTED IN ANY FORM OR BY ANY MEANS, ELECTRONIC OR MECHANICAL, WITHOUT PERMISSION IN WRITING FROM BAXTER & WOODMAN, INC.
 PROJECT: VILLAGE OF GRAYSLAKE, ILLINOIS, ATKINSON ROAD RESURFACING AND RECONSTRUCTION IMPROVEMENTS
 DRAWING NO.: 090772-A+tkn-DU2.dgn
 DATE: 4/27/10
 DRAWN BY: LKB
 CHECKED BY: RWL
 DESIGNED BY: DJS
 FILE: 090772-A+tkn-DU2.dgn