

FOR INDEX OF SHEETS, SEE SHEET NO.2

STATE OF ILLINOIS DEPARTMENT OF TRANSPORTATION DIVISION OF HIGHWAYS PLANS FOR PROPOSED FEDERAL AID PROJECT

F.A.U. RTE.	SECTION	COUNTY	TOTAL SHEETS	SHEET NO.
3898	10-00024-00-RS	KANE	13	1
FED. ROAD DIST. NO.	ILLINOIS	FED. AID PROJECT - LAPP		
CONTRACT NO. 63499				

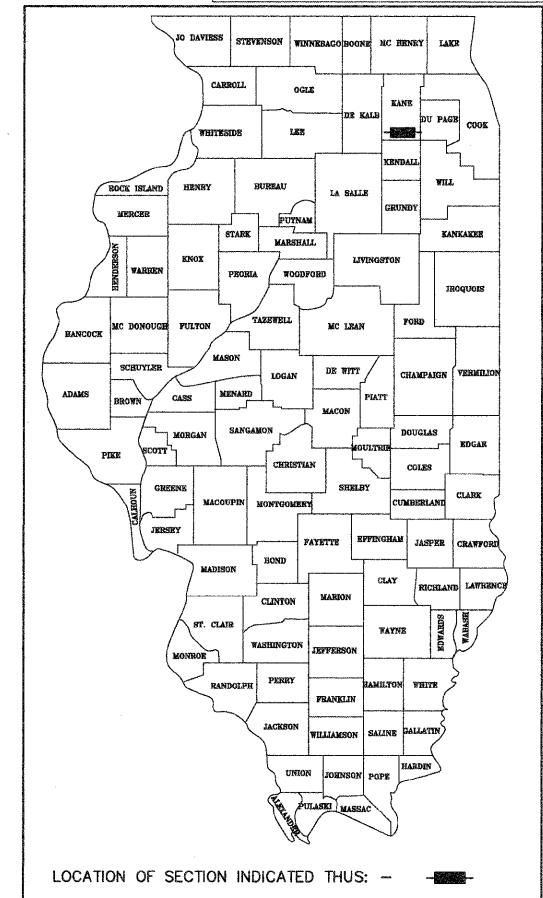

**FAU 3898 (GRANART ROAD)
FROM WHILDIN ROAD
TO FAU 2312 (DUGAN ROAD)
LAPP RESURFACING
PROJECT NO. ARA-9003 (666)
SECTION NO. 10-00024-00-RS
VILLAGE OF SUGAR GROVE
KANE COUNTY
JOB NO. C-91-672-10**

PROJECT LOCATED IN THE VILLAGE OF SUGAR GROVE

DESIGN DESIGNATION

GRANART ROAD: COLLECTOR (URBAN)
DESIGN SPEED = 45 M.P.H.
POSTED SPEED = 45 M.P.H.
ADT = 3300 VPD (2006)

FIELD ENGINEER: MARILYN SOLOMON (847) 705-4407
CONSULTING ENGINEER: ENGINEERING ENTERPRISES, INC.
CONTACT: TIMOTHY V. WEIDNER (630)-466-6700

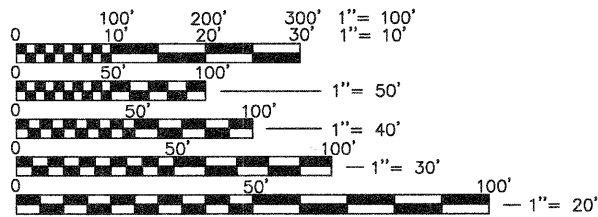

FULL SIZE PLANS HAVE BEEN PREPARED USING STANDARD ENGINEERING SCALES, REDUCED SIZED PLANS WILL NOT CONFORM TO STANDARD SCALES, IN MAKING MEASUREMENTS ON REDUCED PLANS, THE ABOVE SCALES MAY BE USED.

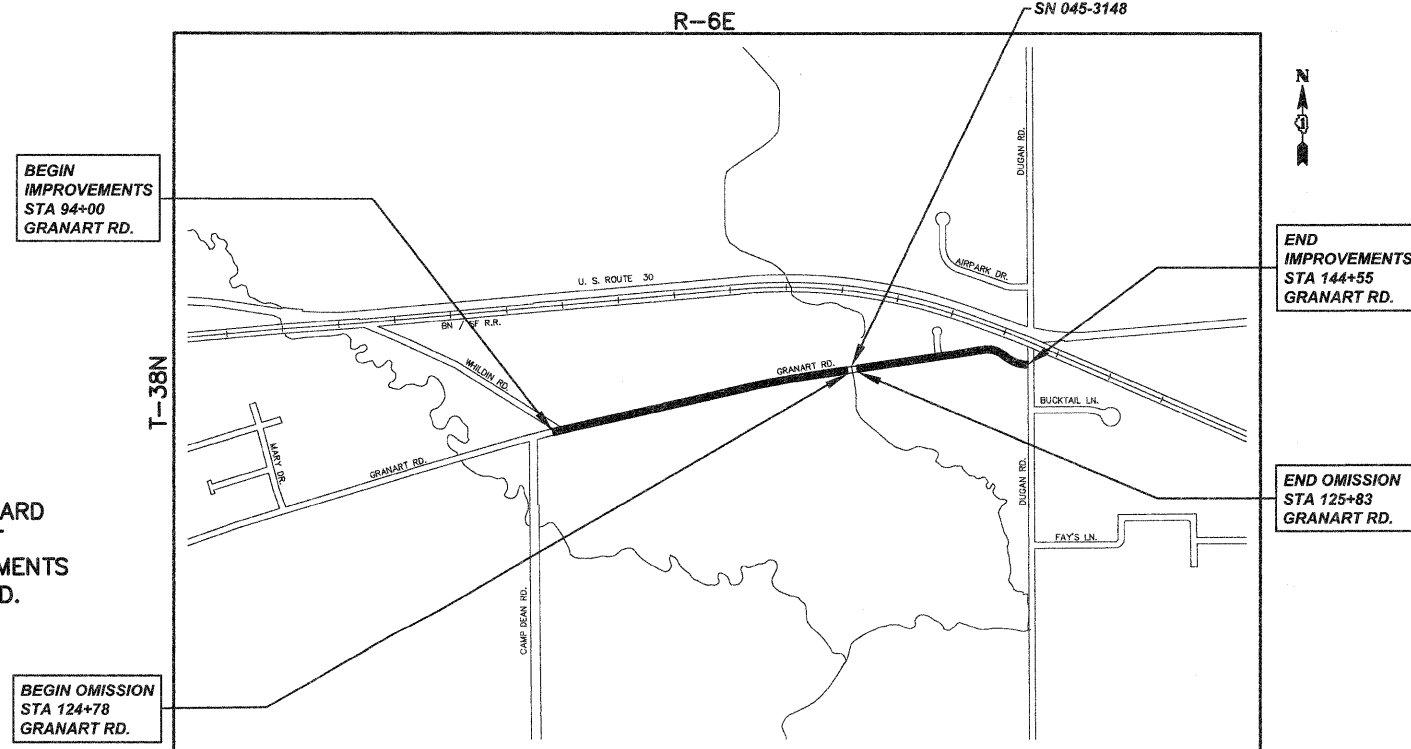

NW & NE 1/4 SEC. 24, T-38N, R-6E, 3RD PM, BIG ROCK TOWNSHIP

**LOCATION MAP
N.T.S.**

GROSS LENGTH OF PROJECT = 5,055 FEET (0.96 MILES)
NET LENGTH OF PROJECT = 4,950 FEET (0.94 MILES)

JULIE JOINT UTILITY
LOCATION INFORMATION FOR EXCAVATION
CALL 811

Know what's below.
Call before you dig.

CONTRACT 63499

STATE OF ILLINOIS DEPARTMENT OF TRANSPORTATION DIVISION OF HIGHWAYS	
APPROVED	June 9, 2010 <i>Quincy Saville</i> DIRECTOR OF PUBLIC WORKS, VILLAGE OF SUGAR GROVE
PASSED	July 12, 2010 <i>C. H. O'Keefe</i> DISTRICT 1 ENGINEER OF LOCAL ROADS & STREETS
RELEASING FOR BID BASED ON LIMITED REVIEW	July 17, 2010 <i>Diane M. O'Keefe</i> DEPUTY DIRECTOR OF HIGHWAYS, REGION 1 ENGINEER

DATE: June 9, 2010
BY: *Timothy V. Weidner*
TIMOTHY V. WEIDNER
LICENSE EXPIRES: NOVEMBER 30, 2011

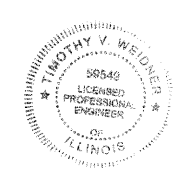

Engineering Enterprises, Inc.
CONSULTING ENGINEERS
52 Wheeler Road
Sugar Grove, Illinois 60554
P: 630.466.6700 — W: www.eeiweb.com

PRINTED BY THE AUTHORITY OF THE STATE OF ILLINOIS