

|                |  |
|----------------|--|
| DATE           |  |
| BY             |  |
| SURVEYED       |  |
| PLOTTED        |  |
| CHECKED        |  |
| NOTE BOOK NO.  |  |
| CADD FILE NAME |  |

|                         |  |
|-------------------------|--|
| DATE                    |  |
| BY                      |  |
| SURVEYED                |  |
| PLOTTED                 |  |
| CHECKED                 |  |
| NOTE BOOK NO.           |  |
| STRUCTURE NOTATION CHKO |  |

- 1 STA. 14+40.05, 38.5' RT  
REMOVING CB  
TO MAINTAIN FLOW  
INV = 711.13 (EX 12" NW)
- 2 STA. 14+42.42, 44.0' RT  
CB T-A, 4" DIA  
TYPE 24 F & G  
RIM = 715.46  
INV = 711.40 (12" NW)  
INV = 711.40 (4" SE)
- 3 STA. 15+90.63, 37.0' RT  
REMOVING CB  
TO MAINTAIN FLOW  
INV = 714.90 (EX 12" NW)
- 4 STA. 15+95.93, 47.3' RT  
CB T-A, 4" DIA  
TYPE 24 F & G  
RIM = 718.94  
INV = 715.29 (12" NW)
- 1 9' - 12" S.S., CL. A, T-2 @ 3.0%  
T.B.F. = 2.4 CU. YD.
- 2 14' - 12" S.S., CL. A, T-2 @ 2.8%  
T.B.F. = 3.2 CU. YD.
- 1A 25' - PIPE UNDERDRAIN, FABRIC  
LINED TRENCH 4"

**LEGEND**

- REMOVAL HATCH
- CLASS B PATCH, 10"
- WETLAND AREA

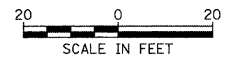
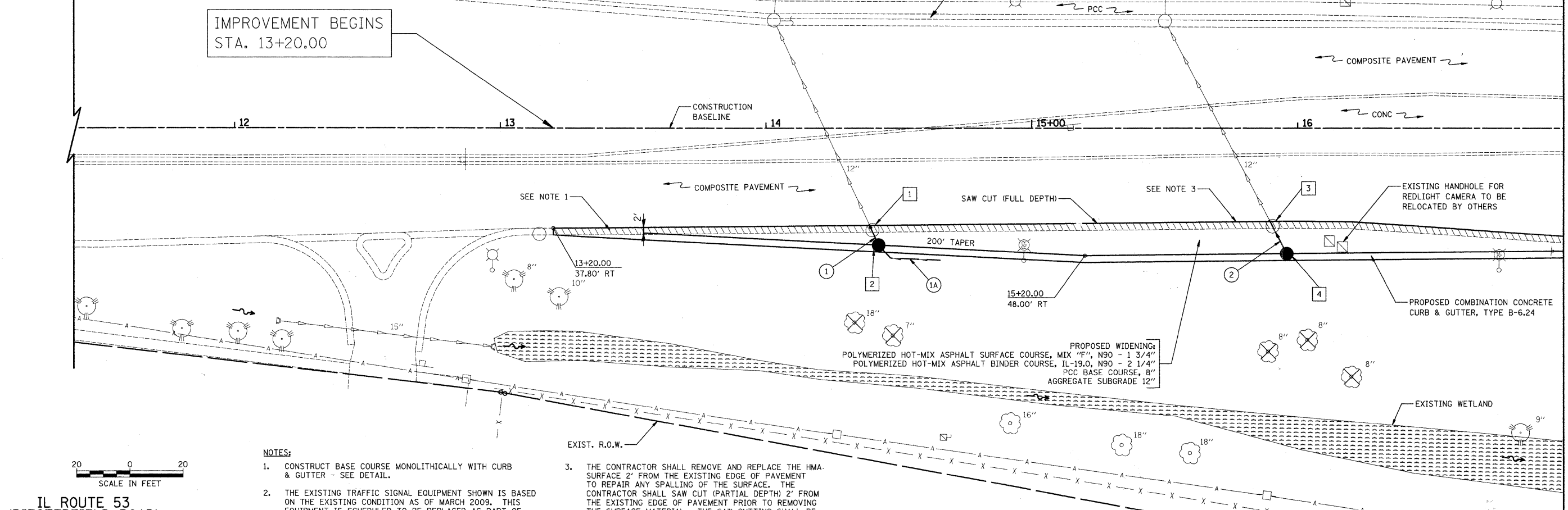

IL ROUTE 53  
(BIESTERFIELD ROAD)

- NOTES:**
- CONSTRUCT BASE COURSE MONOLITHICALLY WITH CURB & GUTTER - SEE DETAIL.
  - THE EXISTING TRAFFIC SIGNAL EQUIPMENT SHOWN IS BASED ON THE EXISTING CONDITION AS OF MARCH 2009. THIS EQUIPMENT IS SCHEDULED TO BE REPLACED AS PART OF IDOT'S CONTRACT NO. 60J32.
  - THE CONTRACTOR SHALL REMOVE AND REPLACE THE HMA SURFACE 2' FROM THE EXISTING EDGE OF PAVEMENT TO REPAIR ANY SPALLING OF THE SURFACE. THE CONTRACTOR SHALL SAW CUT (PARTIAL DEPTH) 2' FROM THE EXISTING EDGE OF PAVEMENT PRIOR TO REMOVING THE SURFACE MATERIAL. THE SAW CUTTING SHALL BE INCLUDED IN THE COST OF "HMA SURFACE REMOVAL, 1 3/4".

MATCH LINE STA. 17+00  
(SEE SHEET NO. 13)

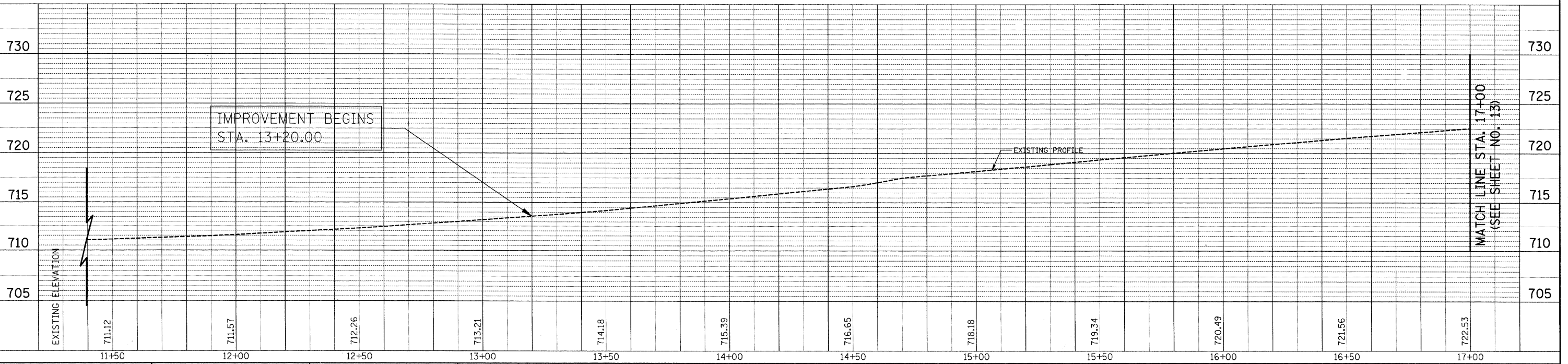

MATCH LINE STA. 17+00  
(SEE SHEET NO. 13)

|   |                             |                 |           |   |   |                         |                              |   |                           |                |                       |                    |
|---|-----------------------------|-----------------|-----------|---|---|-------------------------|------------------------------|---|---------------------------|----------------|-----------------------|--------------------|
| FILE NAME =<br>... \2349\road\sheet\2349.D&U 01.dgn | USER NAME = djk             | DESIGNED - BLG  | REVISED - | <b>STATE OF ILLINOIS<br/>DEPARTMENT OF TRANSPORTATION</b> | <b>IL ROUTE 53 (BIESTERFIELD ROAD) @ I-290<br/>PLAN AND PROFILE</b> |                         |                              | F.A.I.<br>RTE.<br>1339  | SECTION<br>09-00054-00-CH | COUNTY<br>COOK | TOTAL<br>SHEETS<br>88 | SHEET<br>NO.<br>12 |
|   | PLOT SCALE = 20,0000' / IN. | DRAWN - BLG     | REVISED - |   | SCALE: 1" = 20'   | SHEET NO. 1 OF 6 SHEETS | STA. 13+20.0 TO STA. 17+00.0 | FED. ROAD DIST. NO. 1   ILLINOIS   FED. AID PROJECT ARA-M-9003(569) |                           |                |                       |                    |
|   | PLOT DATE = 7/7/2010        | CHECKED - DJK   | REVISED - |   | <b>CONTRACT NO. 63505</b>   |                         |                              |   |                           |                |                       |                    |
|   |                             | DATE - 07-07-10 | REVISED - |   |   |                         |                              |   |                           |                |                       |                    |