

DATE	
BY	
FINAL SURVEY	
PLOTTED	
NOTE BOOK	
AREAS CHECKED	

DATE	
BY	
ORIGINAL SURVEY	
PLOTTED	
NOTE BOOK	
AREAS CHECKED	

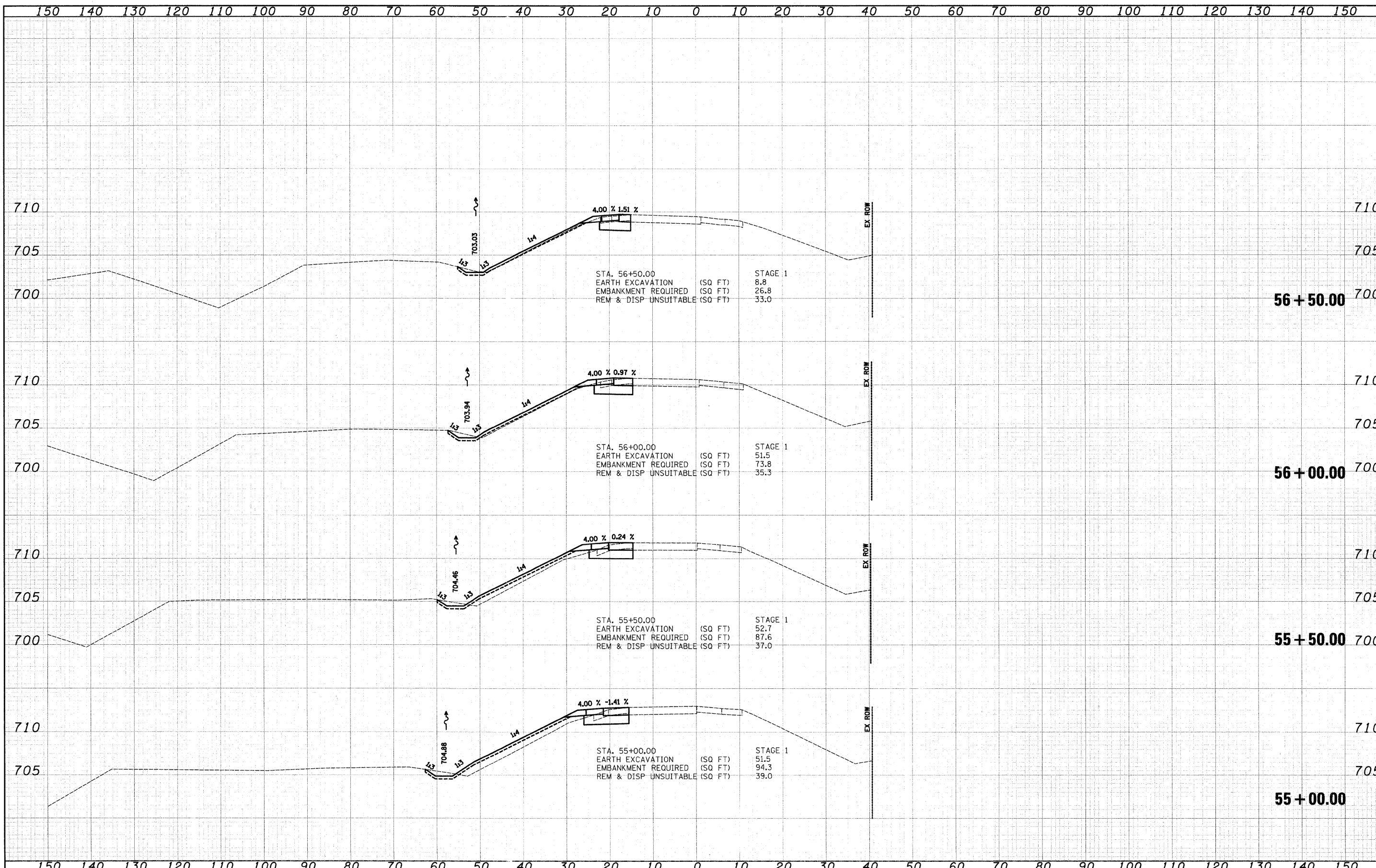

FILE NAME =	USER NAME = djk	DESIGNED -	BLG	REVISED -		STATE OF ILLINOIS DEPARTMENT OF TRANSPORTATION	EASTBOUND ENTRANCE RAMP CROSS SECTIONS	F.A.U. RTE.	SECTION	COUNTY	TOTAL SHEETS	SHEET NO.
...2349\oad\sheet\2349_X_Sec.dgn	PLOT SCALE = 18.4798' / IN.	DRAWN -	BLG	REVISED -				1339	09-00054-00-CH	COOK	88	87
PLOT DATE = 7/7/2010	DATE - 07-07-10	CHECKED -	DJK	REVISED -				CONTRACT NO. 63505		FED. ROAD DIST. NO. 1 ILLINOIS FED. AID PROJECT ARA-M-9003569		
		REVIS						SCALE: H: 1"=10'	SHEET NO. 15 OF 16 SHEETS	STA. 55+00.00	TO STA. 56+50.00	