

MATCH LINE STA. 123 + 00

MATCH LINE STA. 138 + 00

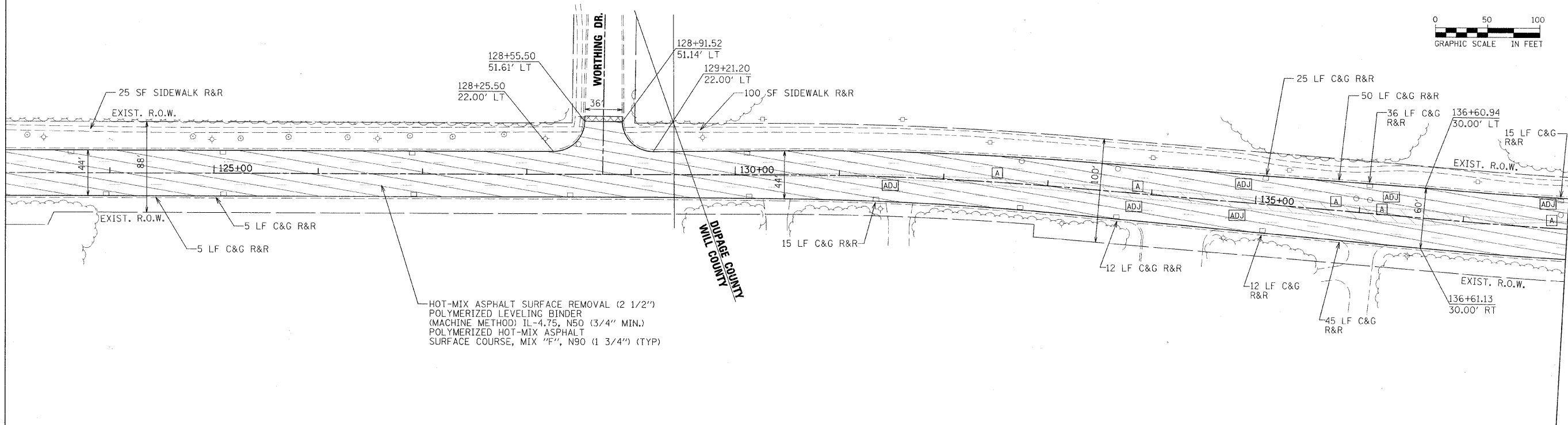

HOT-MIX ASPHALT SURFACE REMOVAL (2 1/2")  
 POLYMERIZED LEVELING BINDER  
 (MACHINE METHOD) IL-4.75, N50 (3/4" MIN.)  
 POLYMERIZED HOT-MIX ASPHALT  
 SURFACE COURSE, MIX "F", N90 (1 3/4") (TYP)

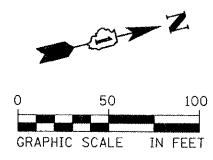

MATCH LINE STA. 138 + 00

MATCH LINE STA. 152 + 50

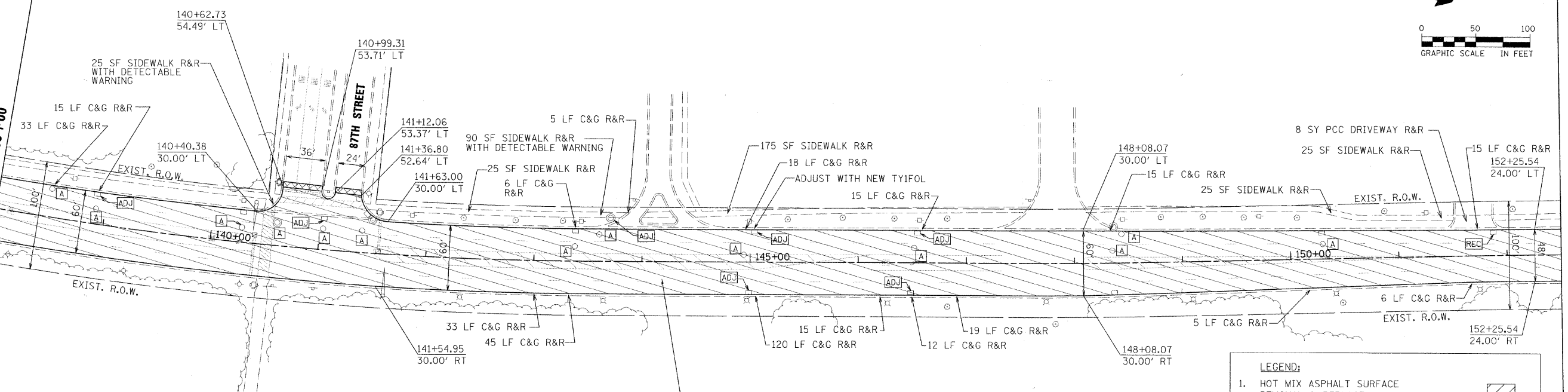

HOT-MIX ASPHALT SURFACE REMOVAL (2 1/2")  
 POLYMERIZED LEVELING BINDER  
 (MACHINE METHOD) IL-4.75, N50 (3/4" MIN.)  
 POLYMERIZED HOT-MIX ASPHALT  
 SURFACE COURSE, MIX "F", N90 (1 3/4") (TYP)

**LEGEND:**

- HOT MIX ASPHALT SURFACE REMOVAL & REPLACE..... [Hatched Box]
- DRAINAGE STRUCTURES TO BE ADJUSTED..... [ADJ]
- FRAMES AND LIDS TO BE ADJUSTED SPECIAL. [A]
- BUTT JOINT..... [Cross-hatched Box]



USER NAME = #USER#	DESIGNED - Y00	REVISED -
PLOT SCALE = #SCALE#	DRAWN - Y00	REVISED -
PLOT DATE = #DATE#	CHECKED - DDL	REVISED -
	DATE - 7/6/2010	REVISED -

STATE OF ILLINOIS  
 DEPARTMENT OF TRANSPORTATION

PROPOSED ROADWAY PLAN

SCALE: 1" = 50 ft SHEET NO. 2 OF 4 SHEETS STA. 123+00 TO STA. 152+50

F.A.U. RTE. 2552	SECTION 10-00148-00-RS	COUNTY DUPAGE	TOTAL SHEETS 24	SHEET NO. 6
CONTRACT NO. 63506				
FED. ROAD DIST. NO. 1 [ILLINOIS] FED. AID PROJECT				