



Illinois Department of Transportation

2300 South Dirksen Parkway / Springfield, Illinois / 62764

September 9, 2010

SUBJECT: FAI Route 80 (I-80)
Project ACIM-HPP-080-4 (189) 115
Section (32, 47-4) HBK-4 & (G)N
Grundy County
Contract No. 66408
Item No. 81, September 17, 2010 Letting
Addendum B

NOTICE TO PROSPECTIVE BIDDERS:

Attached is an addendum to the plans or proposal. This addendum involves revised and/or added material.

1. Revised page iv of the Table of Contents to the Special Provisions.
2. Added pages 203 - 216 to the Special Provisions.

Prime contractors must utilize the enclosed material when preparing their bid and must include any Schedule of Prices changes in their bidding proposal.

Bidders using computer-generated bids are cautioned to reflect any and all Schedule of Prices changes, if involved, into their computer programs.

Very truly yours,

Scott E. Stitt, P.E.
Acting Engineer of Design and Environment

A handwritten signature in black ink, appearing to read "Ted B. Walschleger" followed by a small "P.E." to the right.

By: Ted B. Walschleger, P. E.
Engineer of Project Management

cc: George F. Ryan, Region 2, District 3; Mike Renner; R. E. Anderson;
Estimates

TBW:MS:jc

REFLECTIVE SHEETING ON CHANNELIZING DEVICES (BDE) 131

REINFORCEMENT BARS - STORAGE AND PROTECTION (BDE)..... 131

SEEDING (BDE) 132

SELF-CONSOLIDATING CONCRETE FOR CAST-IN-PLACE CONSTRUCTION (BDE)..... 134

SELF-CONSOLIDATING CONCRETE FOR PRECAST PRODUCTS (BDE)..... 138

SUBCONTRACTOR MOBILIZATION PAYMENTS (BDE) 140

SURFACE TESTING OF PAVEMENTS (BDE) 140

TEMPORARY EROSION CONTROL (BDE) 146

TRAFFIC BARRIER TERMINAL, TYPE 6 (BDE) 148

TRAINING SPECIAL PROVISIONS 148

TRUCK MOUNTED/TRAILER MOUNTED ATTENUATORS (BDE) 150

WORKING DAYS (BDE) 151

BITUMINOUS MATERIALS COST ADJUSTMENTS (BDE) (RETURN FORM WITH BID) 151

FUEL COST ADJUSTMENT (BDE) (RETURN FORM WITH BID) 154

STEEL COST ADJUSTMENT (BDE) (RETURN FORM WITH BID) 158

PROJECT LABOR AGREEMENT 162

OUTFALL STRUCTURES AND ASSOCIATED INTAKE STRUCTURES (CORPS OF ENGINEERS NWP # 7) 176

STORM WATER POLLUTION PREVENTION PLAN..... 177

IN-STREAM WORK PERMIT FOR SN 032-0117 & 032-0118..... 185

BUILDING REMOVAL - CASE I (NON-FRIABLE AND FRIABLE ASBESTOS ABATEMENT) (BDE) 185

BUILDING REMOVAL - CASE II (NON-FRIABLE ASBESTOS ABATEMENT) (BDE) 195

BUILDING REMOVAL - CASE IV (NO ASBESTOS) (BDE)..... 200

APPENDIX FOR BUILDING REMOVAL..... 203

Revised 09/09/2010

APPENDIX FOR BUILDING REMOVAL

APPENDIX

- ACM Location Drawings
- ACM Survey Results
Material Description and Quantities Table
- Shipping Manifest

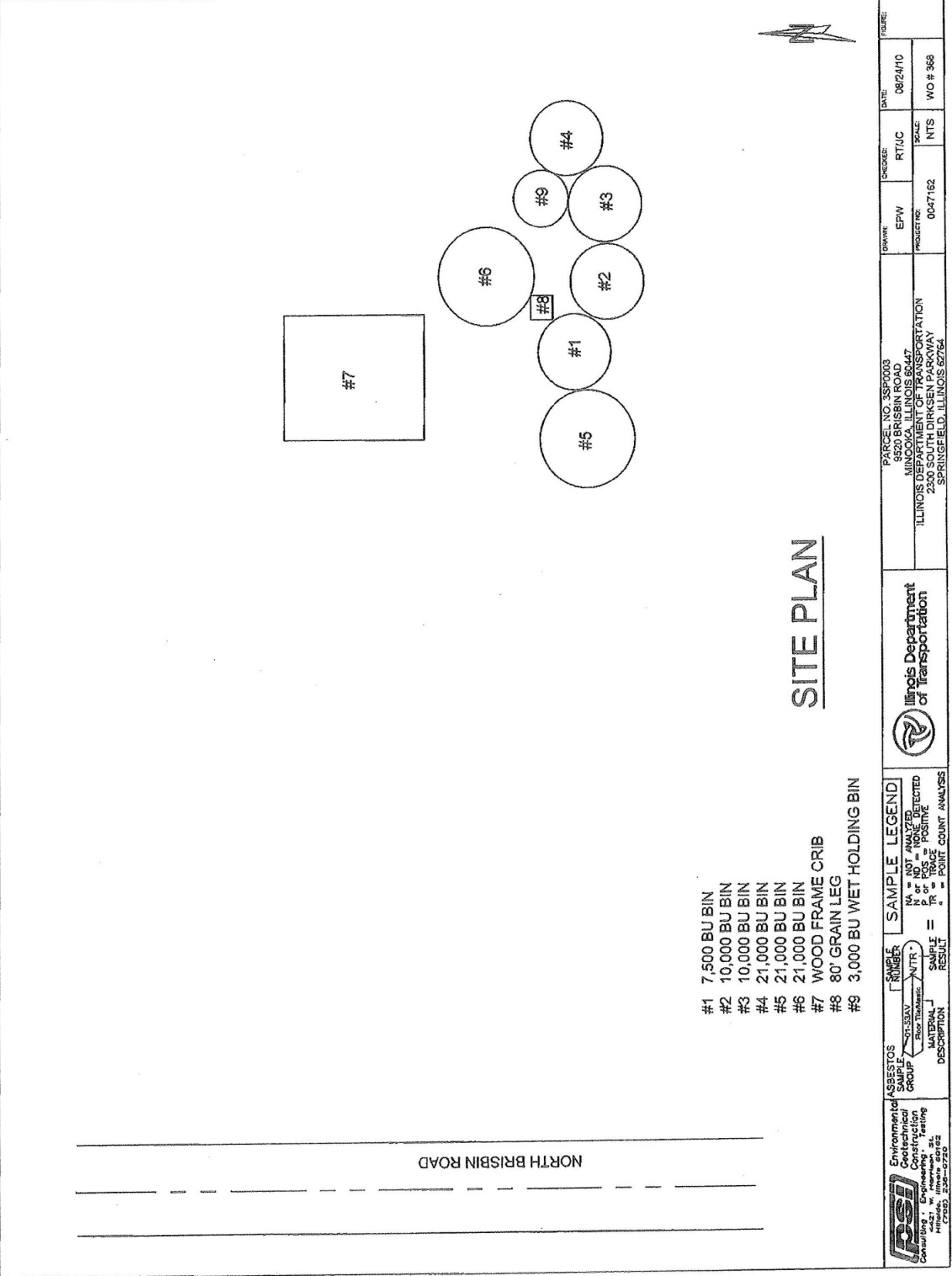

 Environmental Engineering & Testing 4427 W. Interstate 245 (720) 338-0720	ASBESTOS SAMPLE GROUP 91-534V Floor Tiles MATERIAL J DESCRIPTION	SAMPLE NUMBER WTR	SAMPLE RESULT NA = NOT ANALYZED P = POSITIVE TR = TRACE - = POINT COUNT ANALYSIS	 Illinois Department of Transportation PARCEL NO. 3SP0003 9520 BRISBIN ROAD MINOOKA, ILLINOIS 60447 ILLINOIS DEPARTMENT OF TRANSPORTATION 2300 SOUTH DIRKSEN PARKWAY SPRINGFIELD, ILLINOIS 62764	DRAWN EPW	CHECKED RT/JC	DATE 08/24/10
	PRODUCT NO. 0047162	SCALE NTS	WO # 368				

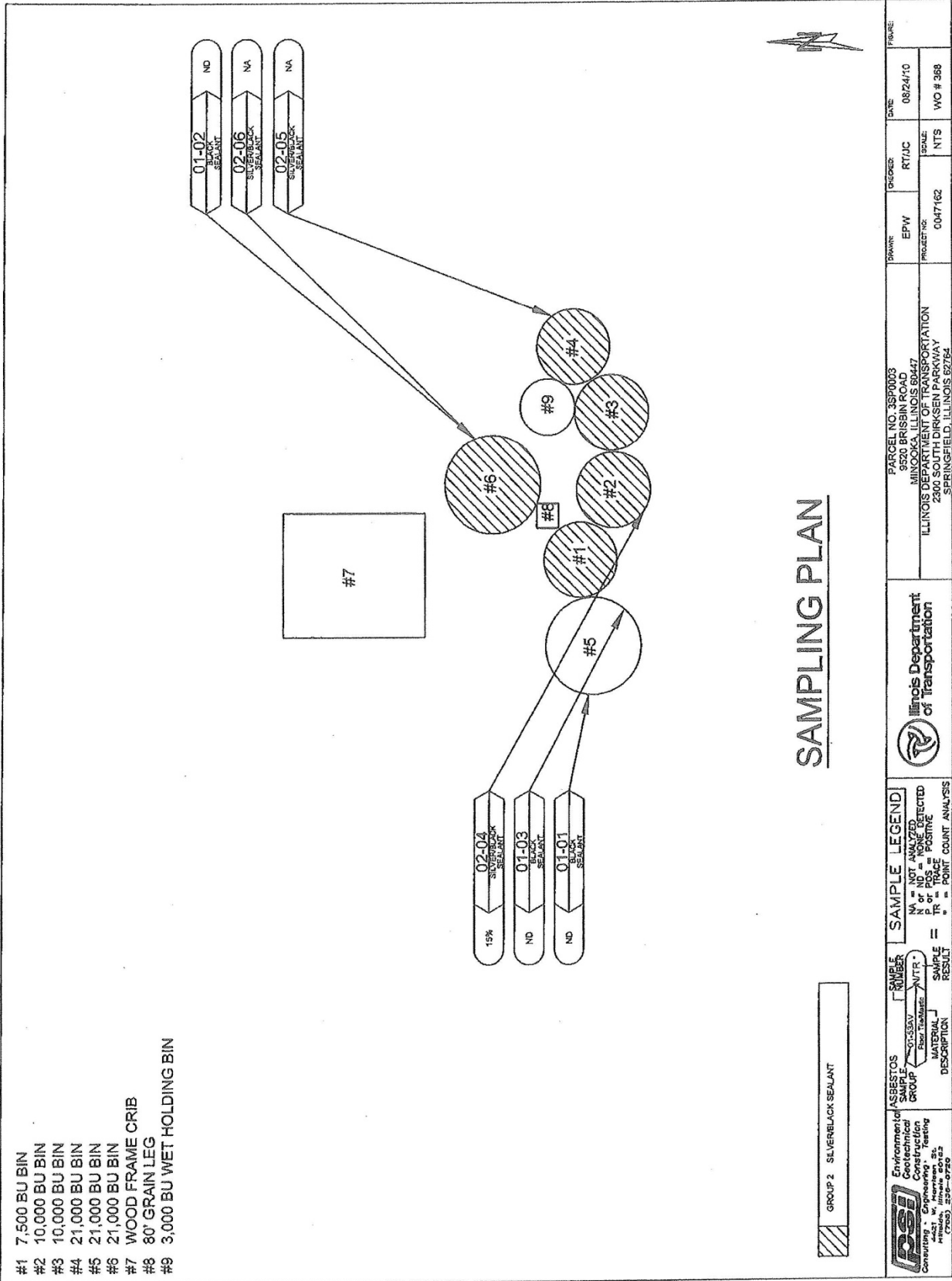

- #1 7,500 BU BIN
- #2 10,000 BU BIN
- #3 10,000 BU BIN
- #4 21,000 BU BIN
- #5 21,000 BU BIN
- #6 21,000 BU BIN
- #7 WOOD FRAME CRIB
- #8 80' GRAIN LEG
- #9 3,000 BU WET HOLDING BIN

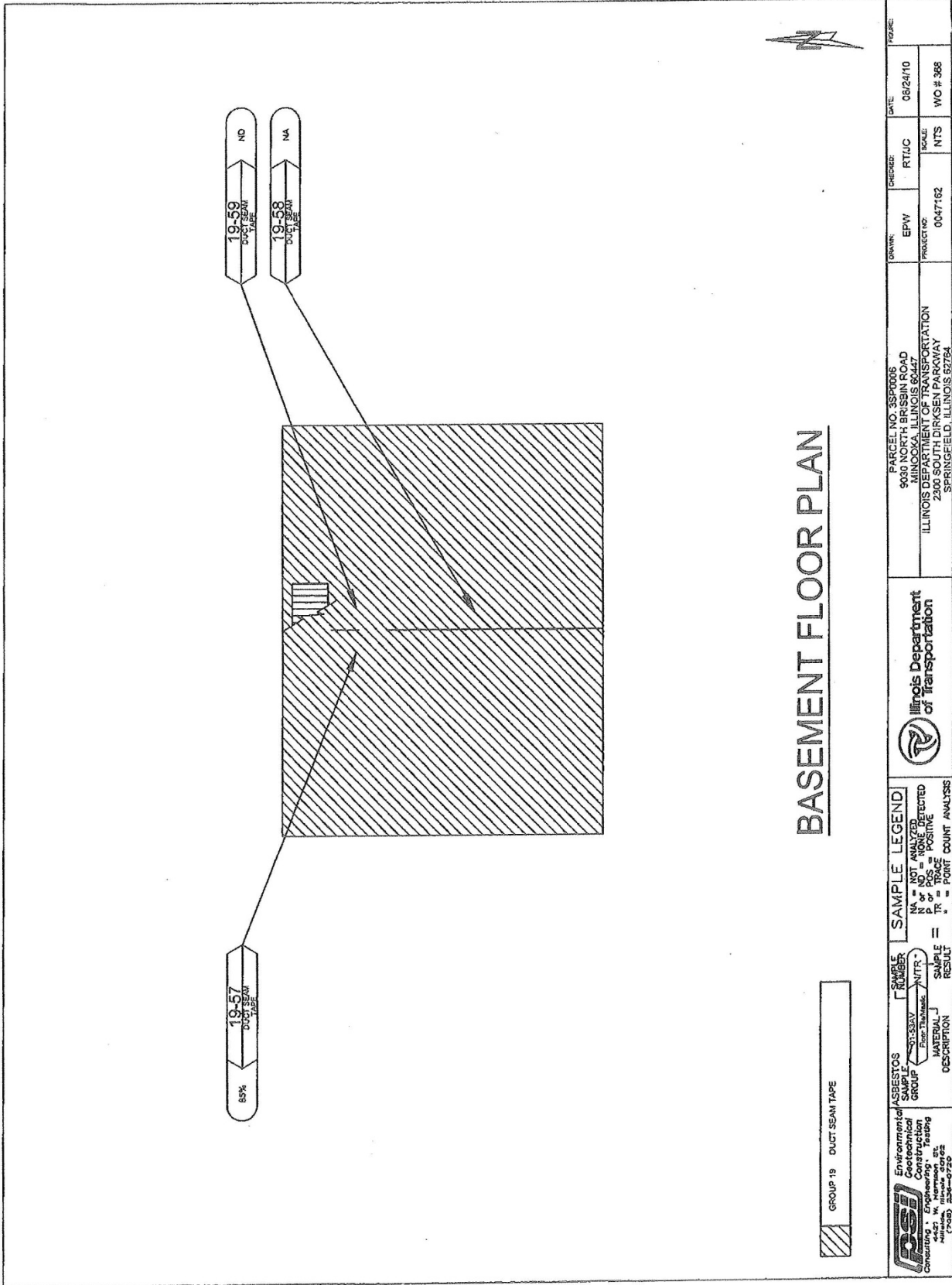

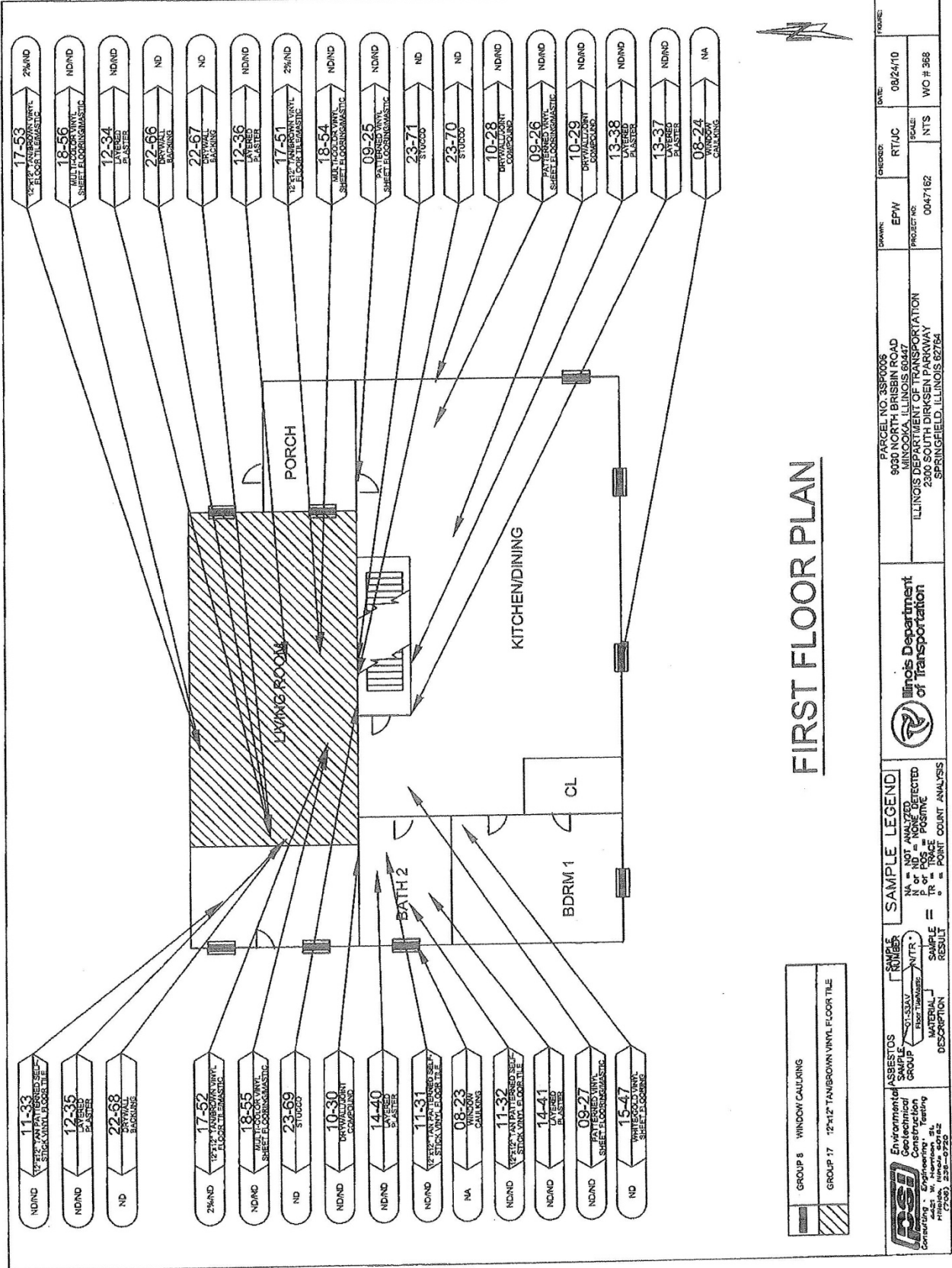

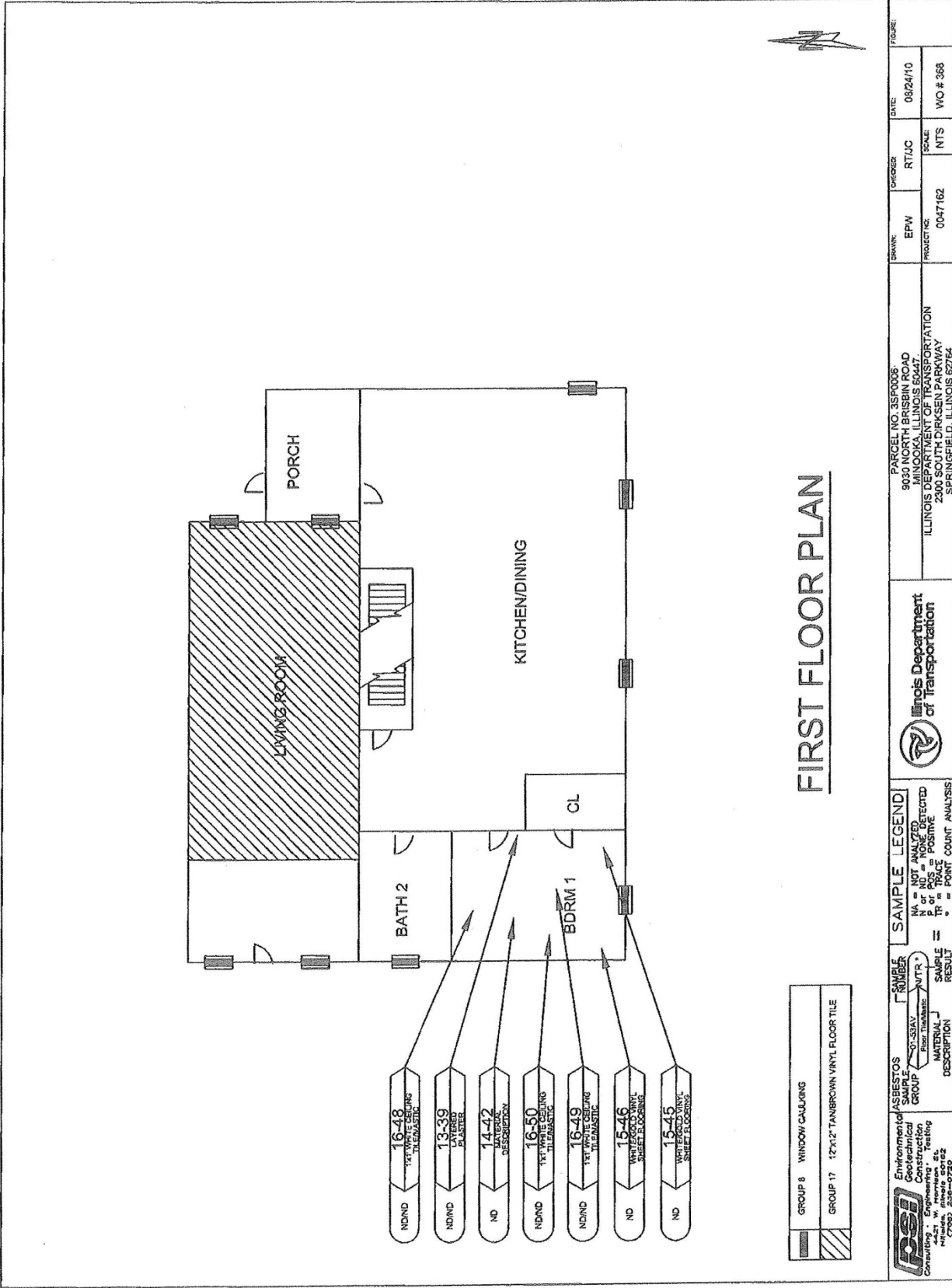

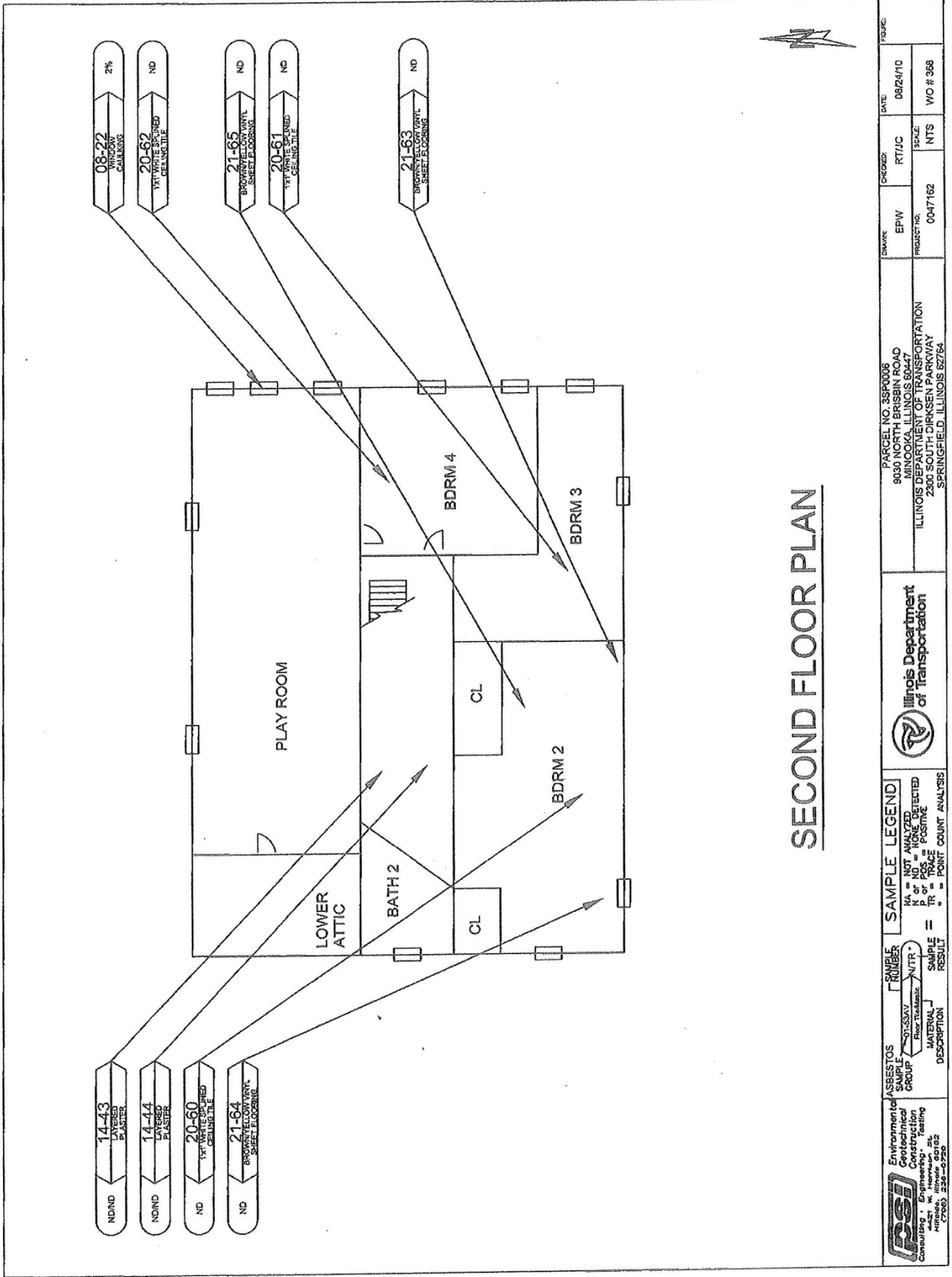

	ASBESTOS GROUP DESCRIPTION	NUMBER (e.g., 14-43)	SAMPLE LEGEND NA = NOT ANALYZED N or ND = NONE DETECTED TR = TRACE POS = POSITIVE FC = POINT COUNT ANALYSIS		PARCEL NO. 35P0006 9030 NORTH BRISBEN ROAD MINOOKA, ILLINOIS 60447 ILLINOIS DEPARTMENT OF TRANSPORTATION 2300 SOUTH DIRKSEN PARKWAY SPRINGFIELD, ILLINOIS 62764	DRAWN: EPW PROJECT NO.: 0047162 SCALE: NTS DATE: 08/24/10 RT/JC WO # 368
	14-43 LAYERED PLASTER	14-44 LAYERED PLASTER	20-60 1/2" WHITE SCURED GELNESTLE	21-64 BROWN/TELOV WYAL SHEET FLOORING	08-22 BROWN/TELOV WYAL SHEET FLOORING	20-62 1/2" WHITE SCURED GELNESTLE

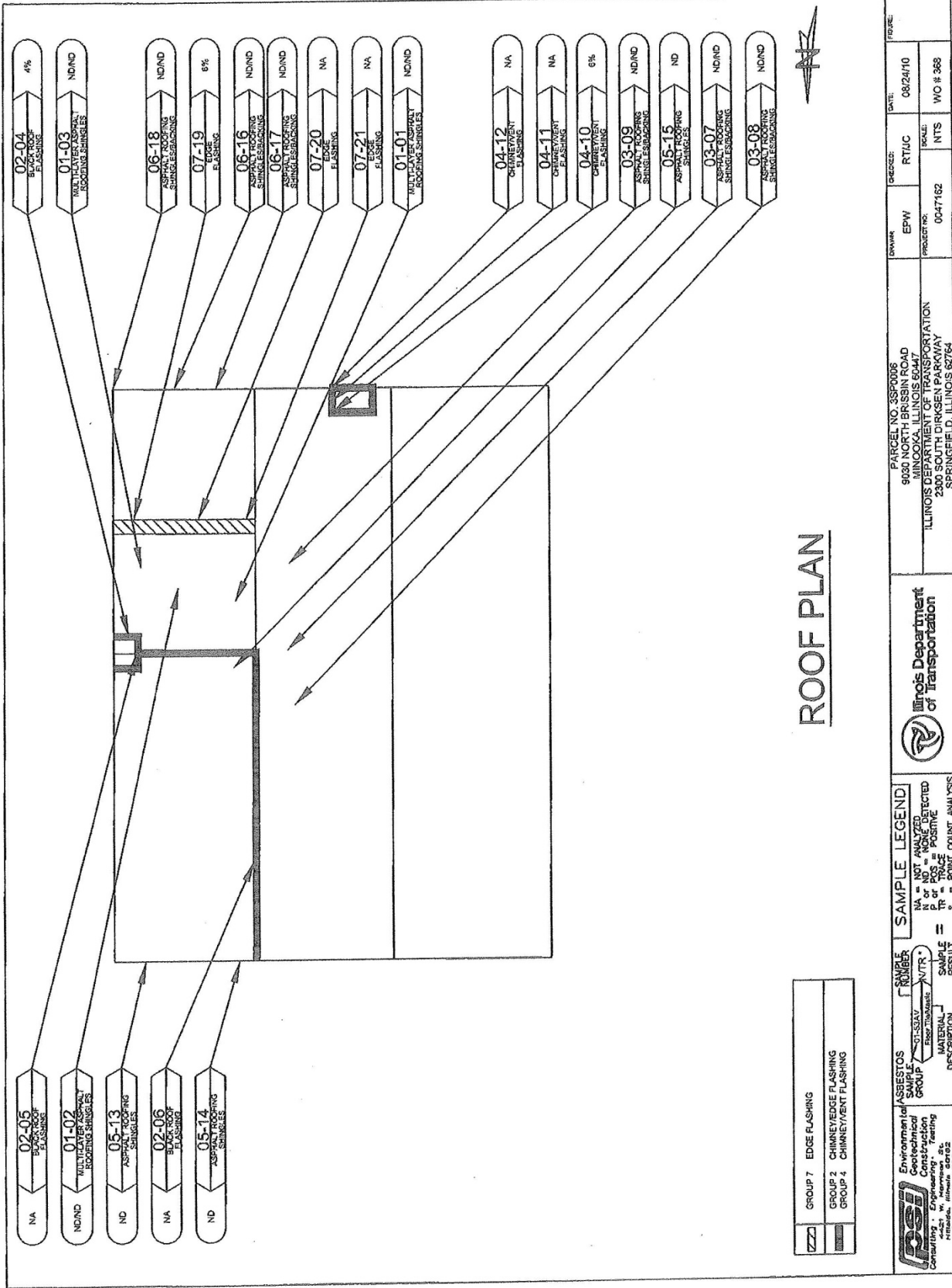

ROOF PLAN

GROUP 7	EDGE FLASHING
GROUP 2	CHIMNEY/EDGE FLASHING
GROUP 4	CHIMNEY/VENT FLASHING

PSI
 Environmental
 Construction
 Consulting, Engineering, Testing
 Peoria, Illinois 61625
 (708) 255-0726

ASBESTOS
 SAMPLE GROUP
 01-SS-01
 MATERIAL IDENTIFICATION
 SAMPLE RESULT

SAMPLE LEGEND
 NA = NOT ANALYZED
 P = POSITIVE
 PR = PARTIAL COUNT ANALYSIS

Illinois Department of Transportation

PARCEL NO. 33P0006
 9630 NORTH BRISLIN ROAD
 BIRMINGHAM, ILLINOIS 62421
 ILLINOIS DEPARTMENT OF TRANSPORTATION
 2300 SOUTH DIRKSEN PARKWAY
 SPRINGFIELD, ILLINOIS 62764

DRAWER	EPW	DESIGNED BY	RTJC	DATE	08/24/10
PROJECT NO.	00AT162	SCALE	NTS	WO #	368

SECTION 1
1.2 Survey Summary & Results

ACM SURVEY RESULTS - Parcel No. 3SP0003
Grain Storage Bins
9520 North Brisbin Road
Minooka, Illinois 60447

The following homogeneous building material types were sampled as part of this survey and their results are summarized in the table below:

MYL #	MATERIAL DESCRIPTION	LOCATION	F/NF ¹	COND. ²	% ACM ³	# SAMPLES	QUANTITY (ENG/MET)
01	Black sealant	Storage bins, 3,5,and 6	NF	Good	ND	3	310 lf 94.5 im
02	Silver/black sealant	Storage bins, 1,2,3,4 and 6	NF	Good	15%	3	400 lf 121.9im
TOTAL QUANTITY OF ACM							400 lf
ESTIMATED ABATEMENT COST							\$2,000.00

¹ F = Friable; NF = Nonfriable Friability is further defined in section 4.
² Cond. = Condition Of Materials Either good, fair or poor.
³ ND = None Detected
 * Point Count Analysis

SECTION 1
1.2 Survey Summary & Results

ACM SURVEY RESULTS - Parcel No. 3SP0006
Single Family Residence
9030 North Brisbin Road
Minooka, Illinois 60447

The following homogeneous building material types were sampled as part of this survey and their results are summarized in the table below:

MTL #	MATERIAL DESCRIPTION	LOCATION	F/NF ¹	COND. ²	% ACM ³	# SAMPLES	QUANTITY (ENG/MET)
01	Multi-layer asphalt roofing shingles	East roof, south section	NF	Fair	ND/ND	3	230 sf 21.4 sm
02	Chimney and edge flashing	East roof	NF	Good	4%	3	40 lf 12.2 lm
03	Asphalt roofing shingles/felt backing	West roof	NF	Good	ND/ND	3	1,060 sf 98.5 sm
04	Chimney and vent flashing	West roof	NF	Good	6%	3	10 lf 3.0 lm
05	Asphalt roofing shingles	East roof, north section	NF	Good	ND	3	380 sf 35.3 sm
06	Asphalt roofing shingles/backing	Porch roof	NF	Good	ND/ND	3	240 sf 22.3 sm
07	Edge flashing	Porch roof	NF	Good	6%	3	27 lf 8.2 lm
08	Window caulking	House windows	NF	Good	2%	3	305 lf 93.0 sm
09	Square and flower pattern vinyl sheet flooring/mastic	Kitchen	NF	Good	ND/ND	3	200 sf 18.6 sm
10	Drywall/joint compound	Kitchen, dining room and restroom 1	F	Fair	ND/ND	3	1,200 sf 111.5 sm
11	12" x 12" tan, diamond and square pattern vinyl floor tile/self slick mastic	Restroom 1 and mud room	NF	Good	ND/ND	3	145 sf 13.5 sm
12	Layered plaster (dark gray)	Living room and play room	NF	Poor	ND/ND	3	950 sf 88.3 sm
13	Layered Plaster (light gray base coat)	Kitchen, bedroom 1	NF	Poor	ND/ND	3	850 sf 79.0 sm
14	Layered plaster (tan base coat)	Throughout	NF	Poor	ND/ND	5	3,000 sf 278.7 sm

¹ F = Friable; NF = Nonfriable Friability is further defined in section 4.
² Cond. = Condition Of Materials Either good, fair or poor.
³ ND = None Detected
 * Point Count Analysis

SECTION 1
1.2 Survey Summary & Results

ACM SURVEY RESULTS - Parcel No. 3SP0006
Single Family Residence
9030 North Brisbin Road
Minooka, Illinois 60447

The following homogeneous building material types were sampled as part of this survey and their results are summarized in the table below:

MTL #	MATERIAL DESCRIPTION	LOCATION	F/NF ¹	COND. ²	% ACM ³	# SAMPLES	QUANTITY (ENG/MET)
15	White with gold specks vinyl sheet flooring	Bedroom 1	NF	Good	ND	3	120 sf 11.1 sm
16	1' x 1' white ceiling tile/mastic	Bedroom 1	NF	Good	ND/ND	3	120 sf 11.1 sm
17	12" x 12" tan with brown and white streaks vinyl floor tile/mastic	Living room	NF	Good	Tile 2% Mastic ND	3	290 sf 26.9 sm
18	Multi-color vinyl sheet flooring/mastic	Living room, sub layer	NF	Good	ND/ND	3	290 sf 26.9 sm
19	Duct seam tape	Basement HVAC duct	NF	Good	85%	3	30 sf 2.8 sm
20	1' x 1' splined ceiling tile	Second floor	F	Good	ND	3	600 sf 55.7 sm
21	Brown and yellow splotted vinyl sheet flooring	Bedroom 2	NF	Good	ND	3	225 sf 23.7 sm
22	Drywall backing	Living room	F	Good	ND	3	135 sf 12.5 sm
23	Stucco	Stairs to basement	NF	Good	ND	3	30 sf 2.8 sm
TOTAL QUANTITY OF ACM							382 sf 320 sf
ESTIMATED ABATEMENT COST							\$5,422.50

¹ F = Friable; NF = Nonfriable Friability is further defined in section 4.
² Cond. = Condition Of Materials Either good, fair or poor.
³ ND = None Detected
 * Point Count Analysis

APPENDIX D

SHIPPING MANIFEST

Generator

1. Work Site Name and Mailing Address	Owner's Name	Owner's Telephone No.	
2. Operator's Name and Address			Operator's Telephone No
3. Waste Disposal Site (WDS) Name Mailing Address, and Physical Site Location			WDS Telephone No.
4. Name and Address of Responsible Agency			
5. Description of Materials			
6. Containers	No.	Type	
7. Total Quantity	M ³	(Yd ³)	
8. Special Handling Instructions and Additional Information			
9. OPERATOR'S CERTIFICATION: I hereby declare that the contents of this consignment are fully and accurately described above by proper shipping name and are classified, packed, marked, and labeled, and are in all respects in proper condition for transport by highway according to applicable international and government regulations.			
Printed/Typed Name & Title		Signature	Month Day Year

Transporter

10. Transporter 1 (Acknowledgement of Receipt of Materials)		
Printed/Typed Name & Title	Signature	Month Day Year
Address and Telephone No.		
11. Transporter 2 (Acknowledgement of Receipt of Materials)		
Printed/Typed Name & Title	Signature	Month Day Year
Address and Telephone No.		

Disposal Site

12. Discrepancy Indication Space		
13. Waste Disposal Site Owner or Operator: Certification of Receipt of Asbestos Materials Covered By This Manifest Except As Noted in Item 12		
Printed/Typed Name & Title	Signature	Month Day Year

APPENDIX D

INSTRUCTIONS

Waste Generator Section (Items 1-9)

1. Enter the name of the facility at which asbestos waste is generated and the address where the facility is located. In the appropriate spaces, also enter the name of the owner of the facility and the owner's phone number.
2. If a demolition or renovation, enter the name and address of the Company and authorized agent responsible for performing the asbestos removal. In the appropriate spaces, also enter the phone number of the operator.
3. Enter the name, address, and physical site location of the waste disposal site (WDS) that will be receiving the asbestos materials. In the appropriate spaces, also enter the phone number of the WDS. Enter "on-site" if the waste will be disposed of on the generator's property.
4. Provide the name and address of the local, State, or EPA Regional Office responsible for administering the asbestos NESHAP program.
5. Indicate the types of asbestos waste materials generated. If from a demolition or renovation, indicate the amount of asbestos that is
 - Friable asbestos material
 - Nonfriable asbestos material
6. Enter the number of containers used to transport the asbestos materials listed in Item 5. Also enter one of the following container codes used in transporting each type of asbestos material (specify any other type of container used if not listed below):
 - DM - Metal drums, barrels
 - DP - Plastic drums, barrels
 - BA - 6 mil plastic bags or wrapping
7. Enter the quantities of each type of asbestos material removed in units of cubic meters (cubic yards).
8. Use this space to indicate special transportation, treatment, storage or disposal or Bill of Lading information. If an alternate waste disposal site is designated, note it here. Emergency response telephone numbers or similar information may be included here.
9. The authorized agent of the waste generator shall read and then sign and date this certification. The date is the date of receipt by transporter.

NOTE: The waste generator shall retain a copy of this form.

APPENDIX D

INSTRUCTIONS

Transporter Section (Items 10 & 11)

10. & 11. Enter name, address, and telephone number of each transporter used, if applicable. Print or type the full name and title of person accepting responsibility and acknowledging receipt of materials as listed on this waste shipment record for transport.

NOTE: The transporter shall retain a copy of this form.

Disposal Site Section (Items 12 & 13)

12. The authorized representative of the WDS shall note in this space any discrepancy between waste described on this manifest and waste actually received as well as any improperly enclosed or contained waste. Any rejected materials should be listed and destination of those materials provided. A site that converts asbestos-containing waste material to nonasbestos material is considered a WDS.
13. The signature (by hand) of the authorized WDS agent indicates acceptance and agreement with statements on this manifest except as noted in Item 12. The date is the date of signature and receipt of shipment.

NOTE: The WDS shall retain a completed copy of this form. The WDS shall also send a completed copy to the operator listed in Item 2.