

- LEGEND**
- WORK ZONE
 - DIRECTION OF TRAFFIC
 - DRUMS WITH MONO-DIRECTIONAL STEADY BURNING LIGHTS @ 50' CENTERS, 25' CENTERS ALONG TAPERS
 - IMPACT ATTENUATOR, TEMPORARY (NON-REDIRECTIVE)
 - TEMPORARY CONCRETE BARRIER

TEMPORARY CONCRETE BARRIER	
NORMAL POSTED SPEED	TAPER RATIO
40 MPH & ABOVE	12:1
BELOW & 40 MPH	8:1

END WORK ZONE SPEED LIMIT
G20-I103(O)-3660
STA 1345+00

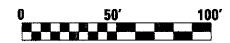
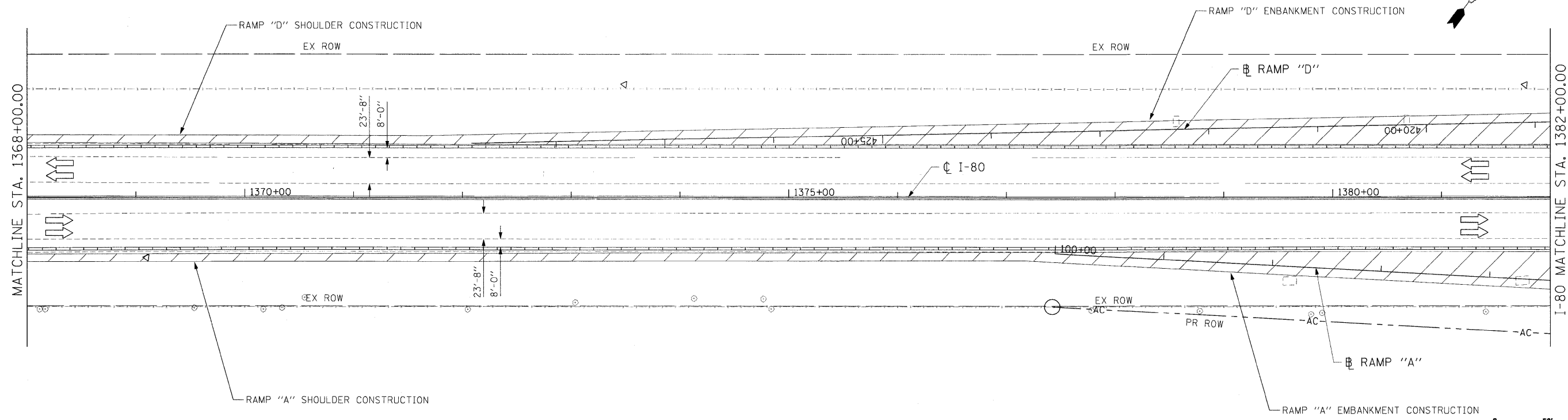
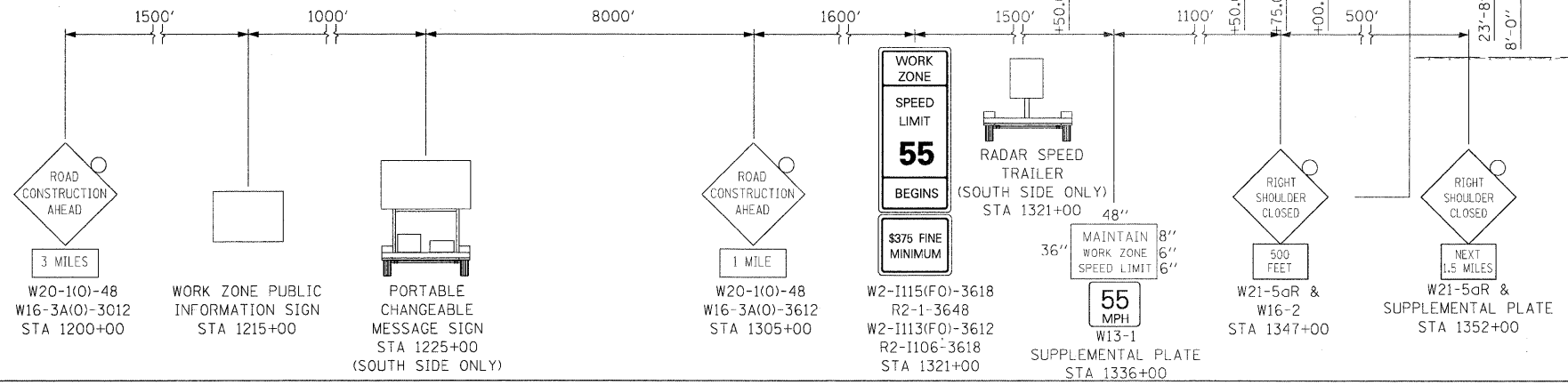

FILE NAME =	USER NAME = .USER.	DESIGNED - JPW	REVISED -
t:\1812\CAD\Sheets\0366408-shr-staging.dgn		DRAWN - ECS	REVISED -
PLOT SCALE = #SCALE#		CHECKED - AKK	REVISED -
PLOT DATE = 5/20/2010		DATE - 5/20/2010	REVISED -

**STATE OF ILLINOIS
DEPARTMENT OF TRANSPORTATION**

**MAINTENANCE OF TRAFFIC
I-80 STAGE 1**

SCALE: 1"=50' SHEET NO. 74 OF 351 SHEETS STA. 1358+00.00 TO STA. 1382+00.00

• FAI 80 & FAS 297 / FAU 392				
F.A.U. RTE.	SECTION	COUNTY	TOTAL SHEETS	SHEET NO.
	(32,47-4) HBK-4 & G(N)	GRUNDY	351	74
			CONTRACT NO. 66408	
ILLINOIS FED. AID PROJECT				