

EDGE OF PAVEMENT ELEVATIONS

ALIGNMENT	STATION	OFFSET TO EOP	EOP ELEV	REMARK	
1	BRISBIN ROAD	117+22.49	37.00 FT LT	568.35	END TAPER
2	BRISBIN ROAD	117+47.47	37.85 FT LT	567.98	
3	BRISBIN ROAD	117+72.46	38.70 FT LT	567.57	
4	BRISBIN ROAD	117+97.45	39.55 FT LT	567.13	
5	BRISBIN ROAD	118+22.43	40.40 FT LT	566.64	
6	BRISBIN ROAD	118+47.42	41.26 FT LT	566.12	
7	BRISBIN ROAD	118+72.40	42.11 FT LT	565.57	
8	BRISBIN ROAD	118+98.62	43.00 FT LT	564.96	PT
9	RAMP D	401+02.95	46.81 FT LT	563.97	
10	RAMP D	401+22.54	31.33 FT LT	562.98	
11	RAMP D	401+45.67	21.82 FT LT	561.99	
12	RAMP D	401+68.01	19.00 FT LT	561.10	PC

EDGE OF PAVEMENT ELEVATIONS

ALIGNMENT	STATION	OFFSET TO EOP	EOP ELEV	REMARK	
13	RAMP D	401+71.58	0.00 FT RT	560.65	PT
14	RAMP D	401+43.86	0.96 FT RT	561.18	
15	RAMP D	401+18.72	3.51 FT RT	561.58	
16	RAMP D	400+93.79	7.64 FT RT	561.96	
17	RAMP D	400+69.16	13.33 FT RT	562.26	PCC
18	RAMP D	400+43.03	24.43 FT RT	562.40	
19	BRISBIN ROAD	120+23.85	40.23 FT LT	562.06	
20	BRISBIN ROAD	120+49.29	37.00 FT LT	561.69	PC

DETAIL "A"  
SCALE 1" = 20'

DETAIL "B"  
SCALE 1" = 20'

DETAIL "C"  
SCALE 1" = 20'

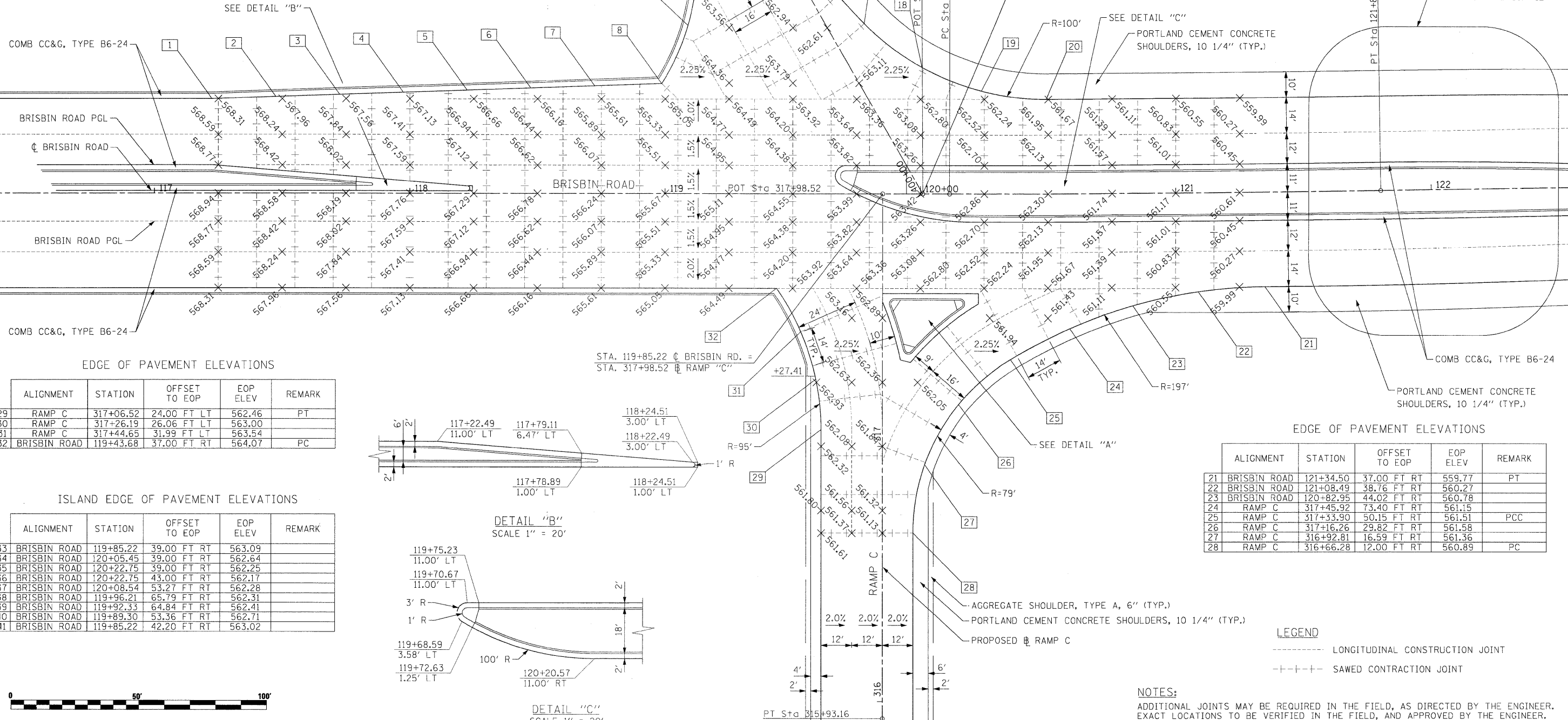

EDGE OF PAVEMENT ELEVATIONS

ALIGNMENT	STATION	OFFSET TO EOP	EOP ELEV	REMARK	
29	RAMP C	317+06.52	24.00 FT LT	562.46	PT
30	RAMP C	317+26.19	26.06 FT LT	563.00	
31	RAMP C	317+44.65	31.99 FT LT	563.54	
32	BRISBIN ROAD	119+43.68	37.00 FT RT	564.07	PC

ISLAND EDGE OF PAVEMENT ELEVATIONS

ALIGNMENT	STATION	OFFSET TO EOP	EOP ELEV	REMARK	
33	BRISBIN ROAD	119+85.22	39.00 FT RT	563.09	
34	BRISBIN ROAD	120+05.45	39.00 FT RT	562.64	
35	BRISBIN ROAD	120+22.75	39.00 FT RT	562.25	
36	BRISBIN ROAD	120+22.75	43.00 FT RT	562.17	
37	BRISBIN ROAD	120+08.54	53.27 FT RT	562.28	
38	BRISBIN ROAD	119+96.21	65.79 FT RT	562.31	
39	BRISBIN ROAD	119+92.33	64.84 FT RT	562.41	
40	BRISBIN ROAD	119+89.30	53.36 FT RT	562.71	
41	BRISBIN ROAD	119+85.22	42.20 FT RT	563.02	

EDGE OF PAVEMENT ELEVATIONS

ALIGNMENT	STATION	OFFSET TO EOP	EOP ELEV	REMARK	
21	BRISBIN ROAD	121+34.50	37.00 FT RT	559.77	PT
22	BRISBIN ROAD	121+08.49	38.76 FT RT	560.27	
23	BRISBIN ROAD	120+82.95	44.02 FT RT	560.78	
24	RAMP C	317+45.92	73.40 FT RT	561.15	
25	RAMP C	317+33.90	50.15 FT RT	561.51	PCC
26	RAMP C	317+16.26	29.82 FT RT	561.58	
27	RAMP C	316+92.81	16.59 FT RT	561.36	
28	RAMP C	316+66.28	12.00 FT RT	560.89	PC

LEGEND  
 - - - - - LONGITUDINAL CONSTRUCTION JOINT  
 + - - - - SAWED CONTRACTION JOINT

NOTES:  
 ADDITIONAL JOINTS MAY BE REQUIRED IN THE FIELD, AS DIRECTED BY THE ENGINEER.  
 EXACT LOCATIONS TO BE VERIFIED IN THE FIELD, AND APPROVED BY THE ENGINEER.

