

**TRAFFIC SIGNAL LEGEND**

	PROPOSED	EXISTING
CONTROLLER		
SERVICE INSTALLATION		
SIGNAL HEAD		
SIGNAL HEAD WITH BACKPLATE		
PEDESTRIAN SIGNAL HEAD		
SIGNAL POST		
MAST ARM ASSEMBLY AND POLE, STEEL		
MAST ARM ASSEMBLY AND POLE, ALUMINUM		
MAST ARM ASSEMBLY AND POLE, STEEL WITH LUMINAIRE		
UNIT DUCT		
COMMON TRENCH		
HANDHOLE		
HEAVY DUTY HANDHOLE		
DOUBLE HANDHOLE		
G.S. CONDUIT IN TRENCH (T) OR PUSHED (P)		
CAST IRON JUNCTION BOX		
EMERGENCY VEHICLE LIGHT DETECTOR		
CONFIRMATION BEACON		
SIGNAL HEAD OPTICALLY PROGRAMMED		
CONDUIT SPLICE		
WOOD POLE		
RACEWAY FOR MAGNETIC DETECTOR, TYPE I OR TYPE II		
VEHICLE DETECTOR, NON COMPENSATED MAGNETIC TYPE		
RAILROAD CONTROL CABINET		
STREET LIGHT		
VIDEO DETECTION CAMERA		
VIDEO DETECTION ZONE		

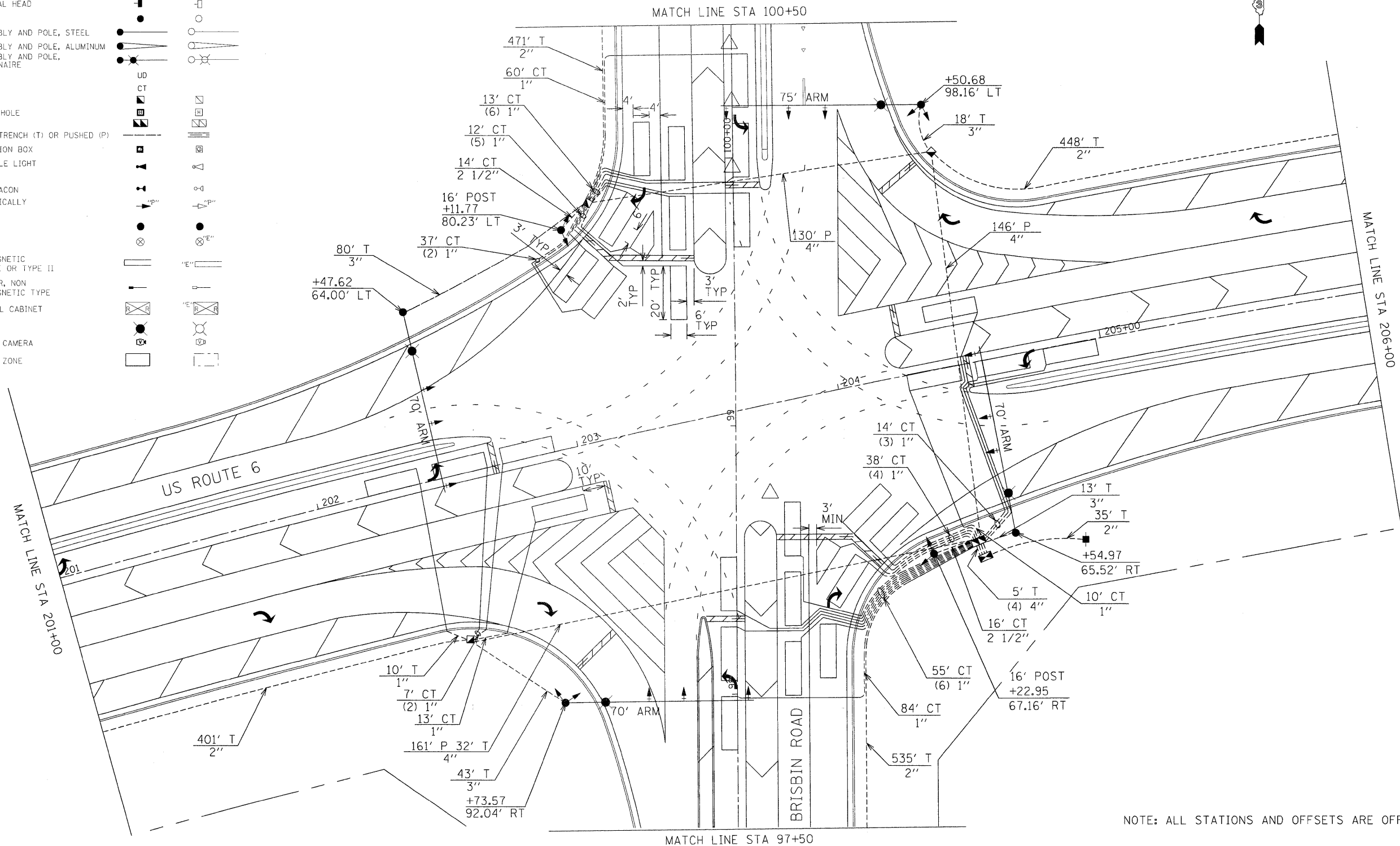

FILE NAME = t:\1812\cadd\sheet\0366408-sht-ts.dgn	USER NAME = _USER_	DESIGNED - JFW	REVISED -	<b>STATE OF ILLINOIS DEPARTMENT OF TRANSPORTATION</b>	<b>BRISBIN RD &amp; US-6 TRAFFIC SIGNAL PLAN</b>	F.A.U. RTE.	SECTION	COUNTY	TOTAL SHEETS	SHEET NO.
PLOT SCALE = #SCALE#	CHECKED - JFW	DRAWN - LG	REVISED -			(32,47-4) HBK-4 & G(N)	GRUNDY	351	142	
PLOT DATE = 5/19/2010	DATE - 5/19/2010	REVISOR -	REVISED -			CONTRACT NO. 66408		ILLINOIS FED. AID PROJECT		
SCALE: 1"=20'		SHEET NO. 142 OF 351 SHEETS				STA. TO STA.				