

**BENCH MARK DESCRIPTIONS**

BRASS DISK IN IL 164 BRIDGE OVER HENDERSON CREEK NW CORN.  
 CHISLED "C" ON CONC. @ NW CORN. OF RESTROOMS  
 CHISLED "C" ON I-BEAM NE CORNER BRIDGE  
 CHISLED "C" ON CONC. FOR PICNIC TABLES PERGOLA SE CORN.

DATE	
BY	
REVISIONS	
PLANNED	
ALIGNED	
CHECKED	
FILED	
NO.	
PLAN	
NOTE BOOK	
NO.	

EXISTING CONTOURS ———  
 PROPOSED CONTOURS - - - - -

CP #4  
 LOCATED IN ENTRANCE ISLAND

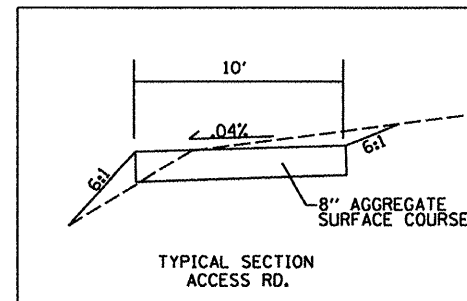

**PARKING STALL DETAIL**

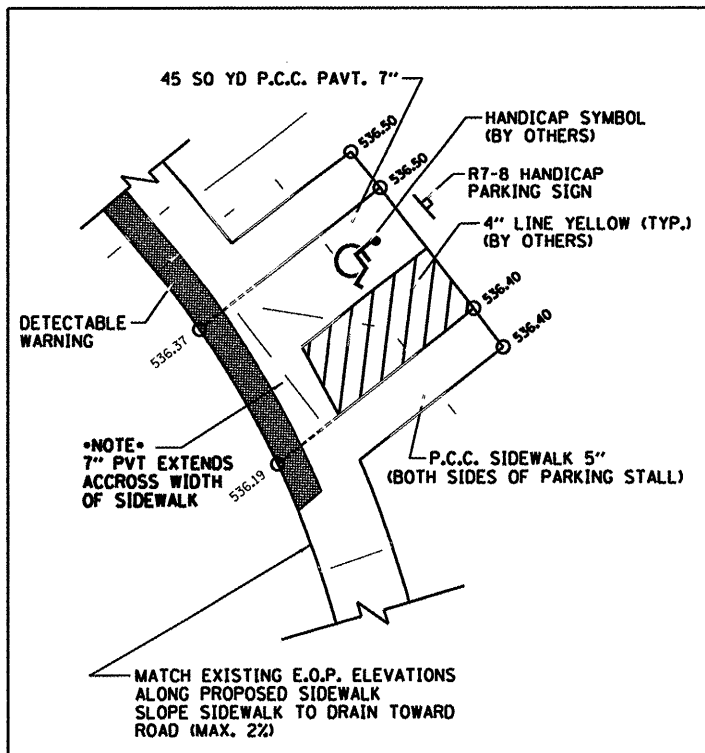

DATE	
BY	
REVISIONS	
PLANNED	
ALIGNED	
CHECKED	
FILED	
NO.	
PROFILE	
NOTE BOOK	
NO.	

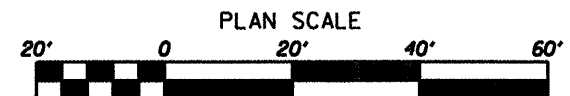
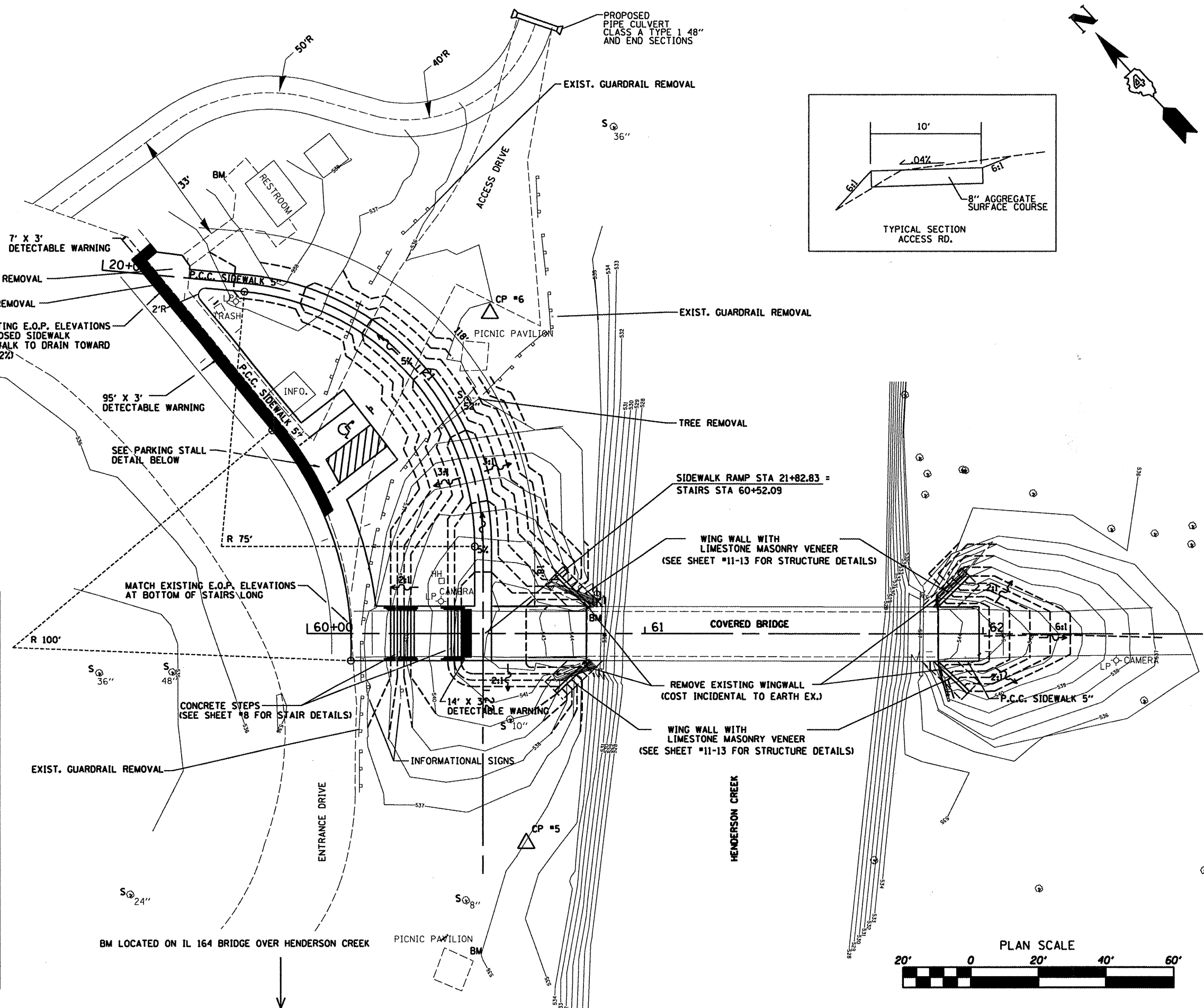

**WILLET, HOFMANN & ASSOCIATES, INC.**  
 CONSULTING ENGINEERS  
 809 East Second Street Dixon, IL 61021  
 Phone 815.284.3381 Fax 815.284.3385  
 Design Firm # 184-00918  
 www.willettthofmann.com

USER NAME		DESIGNED	-	REVISED	-
		DRAWN	-	REVISED	-
PLOT SCALE		CHECKED	-	REVISED	-
PLOT DATE		DATE	-	REVISED	-

**Illinois Department of Transportation**  
 Route FAP 657 (IL 164)  
 Oquawka Wagon Covered Bridge

**PLAN VIEW**

F.A. RTE.	SECTION	COUNTY	TOTAL SHEETS	SHEET NO.
	D-94-070-08	HENDERSON	21	4
STA.	TO STA.	CONTRACT NO.		
FED. ROAD DIST. NO.	ILLINOIS FED. AID PROJECT			