

F.A.I. 72, F.A.P. 6T, F.A.P. 75 & F.A.P. 668
 ** D-6 SPFLD-CLRLAKE DIRKSEN 2002

F.A. RTE.	SECTION	COUNTY	TOTAL SHEETS	SHEET NO.
*	**	SANGAMON	363	97A
STA. TO STA.				
FED. ROAD DIST. NO. ILLINOIS FED. AID PROJECT				
CONTRACT NO. 72088				

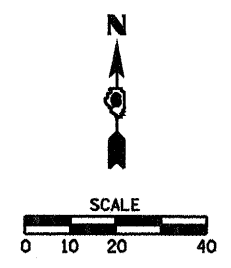
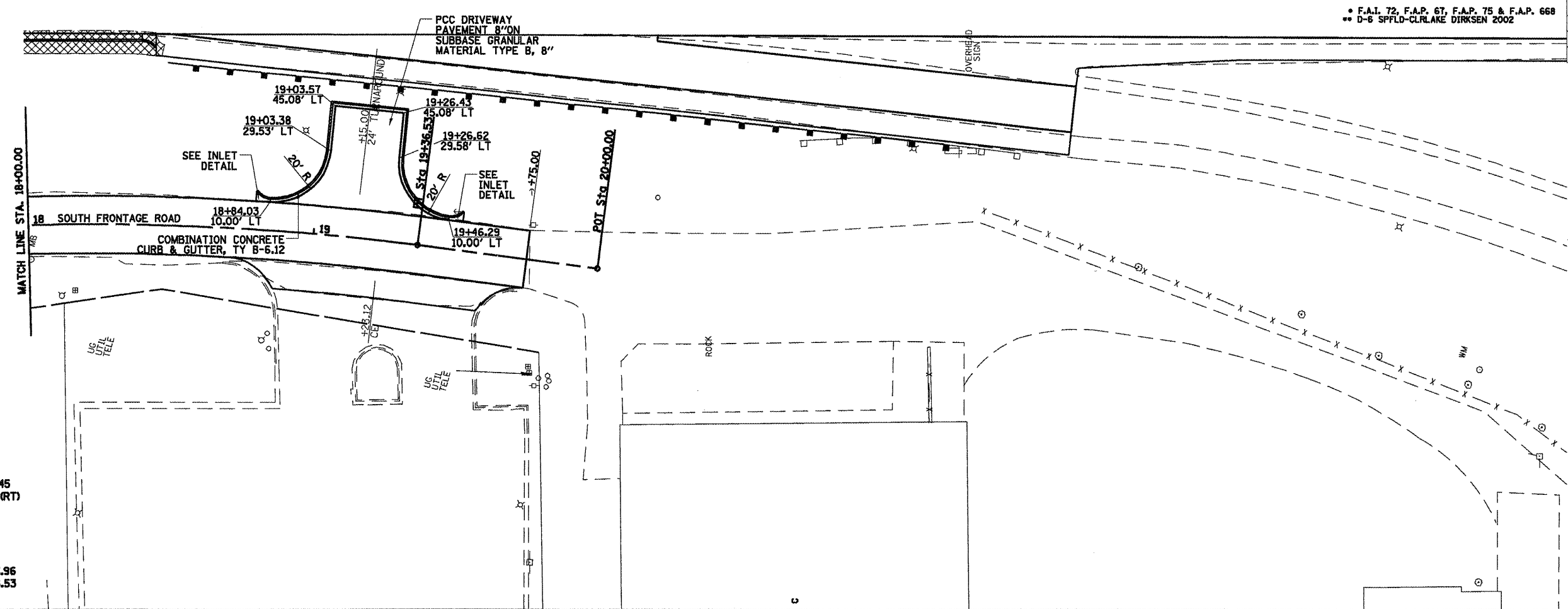

LEGEND

- MEDIAN & C&G REMOVAL
- PAVEMENT REMOVAL
- DRIVEWAY PAVEMENT REMOVAL
- PARKING LOT REMOVAL
- CONSTRUCTION LIMITS

PROP. CURVE C12
 PI STA. = 18+57.45
 $\Delta = 10^\circ 05' 42''$ (RT)
 D = 6° 21' 58"
 R = 900.00'
 T = 79.49'
 L = 158.57'
 E = 3.50'
 P.C. STA = 17+77.96
 P.T. STA = 19+36.53

PLAN	SURVEYED	DATE
	PLOTTED	BY
	INSTRUMENTED	
	REVISIONS	
	NO. _____	DATE _____
	BY _____	
	DATE _____	

PROFILE	SURVEYED	DATE
	PLOTTED	BY
	INSTRUMENTED	
	REVISIONS	
	NO. _____	DATE _____
	BY _____	
	DATE _____	

