

F.A. RTE.	SECTION	COUNTY	TOTAL SHEETS	SHEET NO.
	..	SANGAMON	363	109
STA. 124+95.41		TO STA. 130+00.00		
FED. ROAD DIST. NO.		ILLINOIS FED. AID PROJECT		
CONTRACT NO. 72088				
* F.A.P. 72, F.A.P. 67, F.A.P. 75 & F.A.P. 668				
** D-6 SPFLD-CLRLAKE DIRKSEN 2002				

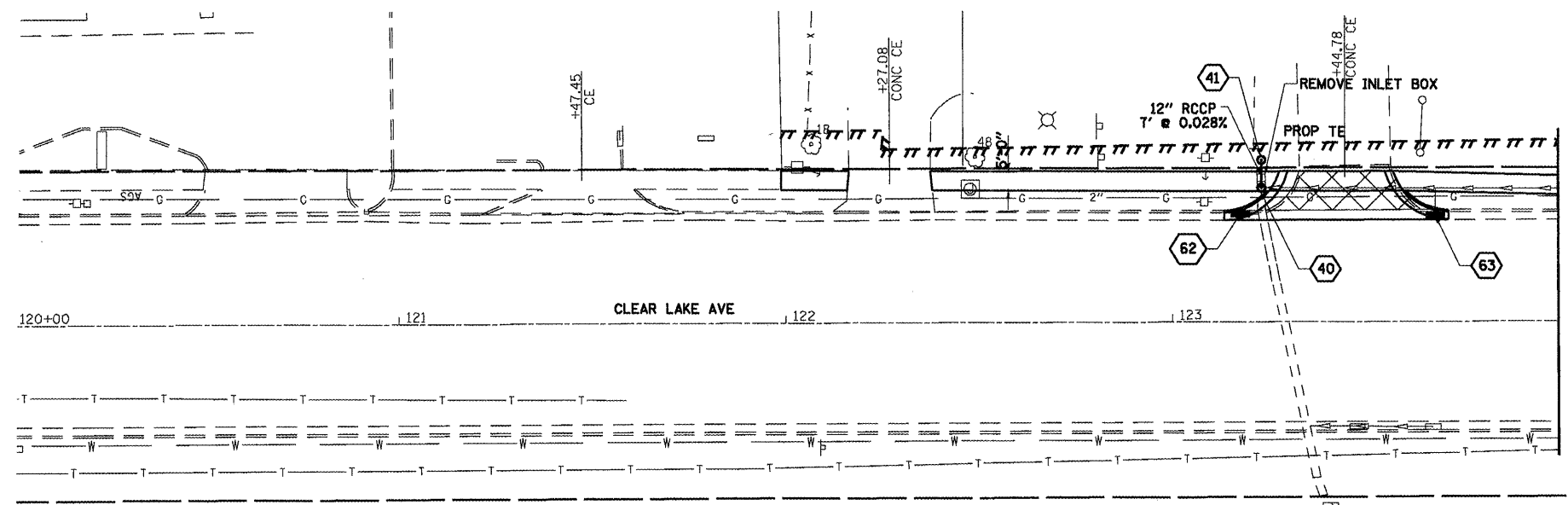

- 62 STA. 123+17.70, 28.09' LT
ADJ INLET
TY 3, F&G
EOP EL=586.94
- 63 STA. 123+68.13, 27.50' LT
ADJ INLET
TY 3, F&G
EOP EL=586.55
- 40 STA. 123+23.18, 34.83' LT
PR MH, TY A, 5'
TY 1, F&CLID
RIM EL=587.05
INV EL=583.19 (S)
INV EL=583.30 (N)
- 41 STA. 123+23.18, 42.00' LT
PR INLET, TYPE A
TY 8 GRATE
RIM EL=586.40
INV EL=583.50 (S)
INV EL=585.10 (N)
INV EL=585.15 (W)
- 44 STA. 127+80.34, 35.55' LT
ADJ MH
TY 1, F&CLID
RIM EL=590.29
- 42 STA. 125+25, 44.00' LT
PR INLET, TYPE A
TY 8 GRATE
RIM EL=586.60
INV EL=585.15
(SEE NOTE 1)
- 43 STA. 125+25, 34' LT
RC PIPE TEE 15P 12R
INV EL=585.10
(SEE NOTE 1 & 2)

NOTES:
 1.) FIELD VERIFY ELEVATION OF EXISTING 15" STORM SEWER BEFORE SETTING STR. NO. 42 OR 43.
 2.) RC PIPE TEE TO BE CUT INTO EXISTING 15" STORM SEWER. CONNECT TO EXISTING STORM SEWER USING CONCRETE COLLARS.

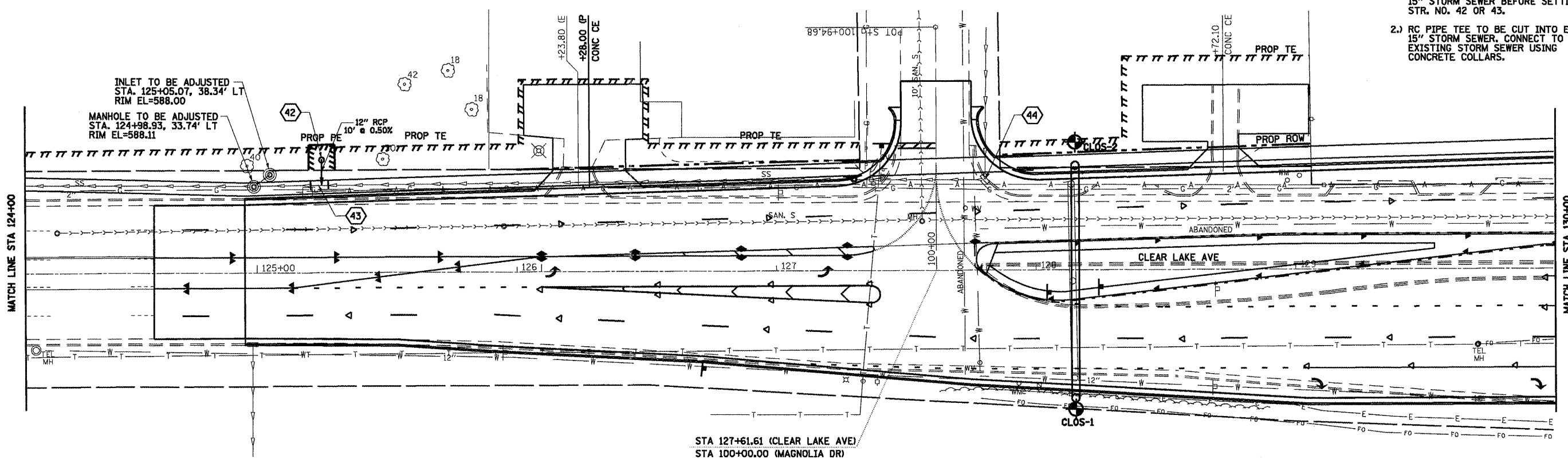

LEGEND
 BORING LOCATION
 SEE SHEET 215A - 215D