

F.A.I. 72, F.A.P. 67, F.A.P. 75 & F.A.P. 668
 ** D-6 SPFLD-CLRLAKE DIRKSEN 2002

F.A. RTE.	SECTION	COUNTY	TOTAL SHEETS	SHEET NO.
	**	SAGAMON	363	121
STA. 156+00.00		TO STA. 162+00.00		
FED. ROAD DIST. NO.		ILLINOIS	FED. AID PROJECT	
CONTRACT NO. 72088				

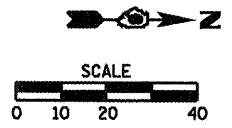

61 STA. 157+50.29, 38.32' LT
 INLET TO BE ADJUSTED
 TY 3, F&G
 EDP EL=583.51

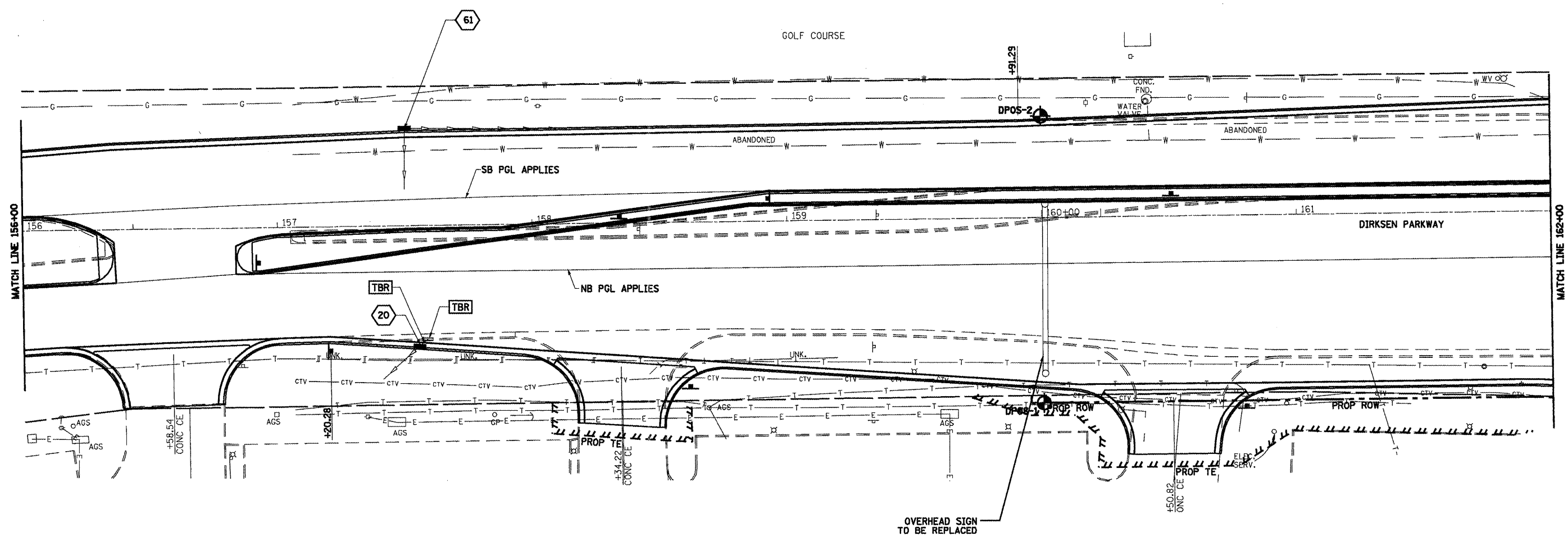

LEGEND
 [TBR] TO BE REMOVED (SEE SCHEDULE)
 [TBF] TO BE FILLED (SEE SCHEDULE)
 [Symbol] BORING LOCATION
 SEE SHEET 215A - 215D

20 STA. 157+55.24, 47.45' RT
 PR INLET, TYPE A
 TY 3, F&G
 EDP EL=583.77
 INV EL=579.50