

PLAN	SURVEYED	DATE
	PLOTTED	BY
	NOTED	
	REVISIONS	
	NO. OF WAY CHECKED	
	FILE NAME	

PROFILE	SURVEYED	DATE
	PLOTTED	BY
	NOTED	
	REVISIONS	
	NO. OF WAY CHECKED	
	FILE NAME	

F.A. RTE.	SECTION	COUNTY	TOTAL SHEETS	SHEET NO.
• F.A. 72, F.A.P. 67, F.A.P. 75 & F.A.P. 668	••	SANGAMON	363	132
•• D-6 SPFLD-CLRLAKE DIRKSEN 2002				
STA. 10+00.00		TO STA. 13+50.00		
FED. ROAD DIST. NO.	ILLINOIS	FED. AID PROJECT		
CONTRACT NO. 72088				

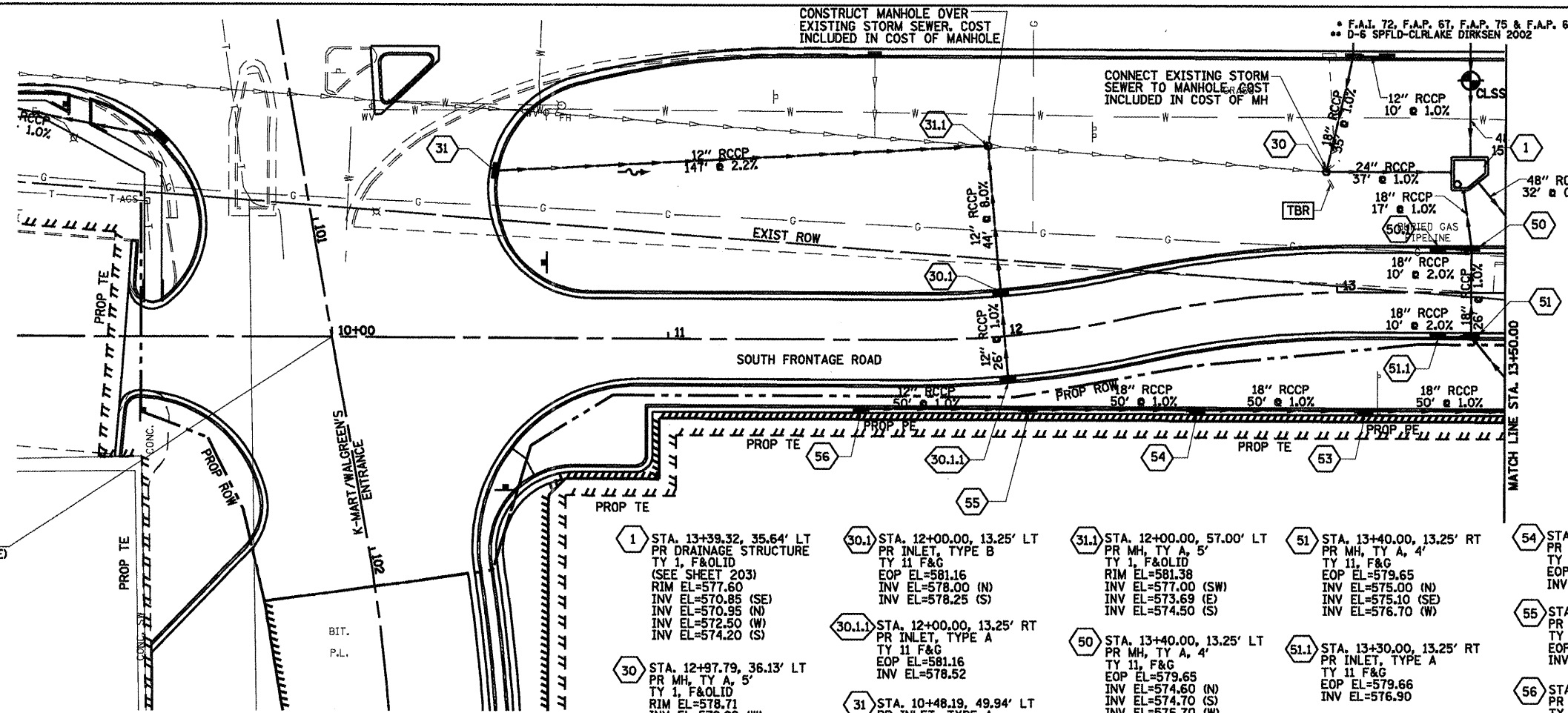
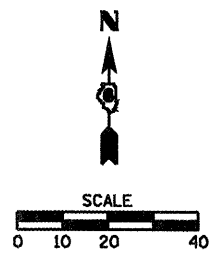

STA. 10+00.00 (SOUTH FRONTRAGE ROAD) =
STA. 101+35.54 (K-MART/WALGREEN'S ENTRANCE)

LEGEND
TBR TO BE REMOVED (SEE SCHEDULE)
TBF TO BE FILLED (SEE SCHEDULE)

- 1 STA. 13+39.32, 35.64' LT
PR DRAINAGE STRUCTURE
TY 1, F&OLID
(SEE SHEET 203)
RIM EL=577.60
INV EL=570.85 (SE)
INV EL=570.95 (N)
INV EL=572.50 (W)
INV EL=574.20 (S)
- 30 STA. 12+97.79, 36.13' LT
PR MH, TY A, 5'
TY 1, F&OLID
RIM EL=578.71
INV EL=572.99 (W)
INV EL=572.89 (E)
INV EL=573.00 (N)
- 30.1 STA. 12+00.00, 13.25' LT
PR INLET, TYPE B
TY 11 F&G
EOP EL=581.16
INV EL=578.00 (N)
INV EL=578.25 (S)
- 30.1.1 STA. 12+00.00, 13.25' RT
PR INLET, TYPE A
TY 11 F&G
EOP EL=581.16
INV EL=578.52
- 31 STA. 10+48.19, 49.94' LT
PR INLET, TYPE A
TY 3, F&G
EOP EL=582.81
INV EL=580.28
- 31.1 STA. 12+00.00, 57.00' LT
PR MH, TY A, 5'
TY 1, F&OLID
RIM EL=581.38
INV EL=577.00 (SW)
INV EL=573.69 (E)
INV EL=574.50 (S)
- 50 STA. 13+40.00, 13.25' LT
PR MH, TY A, 4'
TY 11, F&G
EOP EL=579.65
INV EL=574.60 (N)
INV EL=574.70 (S)
INV EL=576.70 (W)
- 50.1 STA. 13+30.00, 13.25' LT
PR INLET, TYPE A
TY 11 F&G
EOP EL=579.66
INV EL=576.90
- 50.1.1 STA. 13+00.00, 13.25' RT
PR MH, TY A, 4'
TY 11, F&G
EOP EL=579.65
INV EL=575.00 (N)
INV EL=575.10 (SE)
INV EL=576.70 (W)
- 51 STA. 13+40.00, 13.25' RT
PR MH, TY A, 4'
TY 11, F&G
EOP EL=579.65
INV EL=575.00 (N)
INV EL=575.10 (SE)
INV EL=576.70 (W)
- 51.1 STA. 13+30.00, 13.25' RT
PR INLET, TYPE A
TY 11 F&G
EOP EL=579.66
INV EL=576.90
- 53 STA. 13+08.58, 35.75' RT
PR INLET, TYPE B
TY 11 F&G
EOP EL=580.40
INV EL=575.85
- 54 STA. 12+52.61, 31.31' RT
PR INLET, TYPE B
TY 11 F&G
EOP EL=580.78
INV EL=576.35
- 55 STA. 12+05.08, 22.62' RT
PR INLET, TYPE B
TY 11 F&G
EOP EL=581.27
INV EL=576.85
- 56 STA. 11+57.46, 20.75' RT
PR INLET, TYPE A
TY 11 F&G
EOP EL=581.81
INV EL=577.35

