

TYPICAL PAVEMENT MARKING LEGEND

- 1 5" SKIP-DASH YELLOW
- 2 5" SOLID YELLOW
- 3 12" DIAGONAL YELLOW
- 4 5" DOUBLE YELLOW NARROW
- 5 5" DOUBLE YELLOW WIDE
- 6 5" SKIP-DASH WHITE
- 7 6" SKIP-DASH WHITE
- 8 5" SOLID WHITE
- 9 6" SOLID WHITE
- 10 8" SOLID WHITE
- 11 24" STOP BAR WHITE
- 12 12" DIAGONAL WHITE

- U - URETHANE
- PP - PREFORMED PLASTIC, TYPE B
- T - THERMOPLASTIC
- P - PAINT
- ALL TRAFFIC ARROWS ARE "PP"

SEE STANDARDS 780001 & 781001 AND DISTRICT PAVEMENT MARKING DETAILS FOR ADDITIONAL DETAILS FOR PAVEMENT MARKING AND RAISED REFLECTIVE PAVEMENT MARKERS.

F.A.P. 72, F.A.P. 67, F.A.P. 75 & F.A.P. 668
D-6 SPFLD-CLRLAKE DIRKSEN 2002

| | | | | |
|---------------------|----------|------------------|--------------|-----------|
| F.A.P. RTE. | SECTION | COUNTY | TOTAL SHEETS | SHEET NO. |
| | | SANGAMON | 363 | 153 |
| STA. 62+00.00 | | TO STA. 74+00.00 | | |
| FED. ROAD DIST. NO. | ILLINOIS | FED. AID PROJECT | | |
| CONTRACT NO. 72088 | | | | |

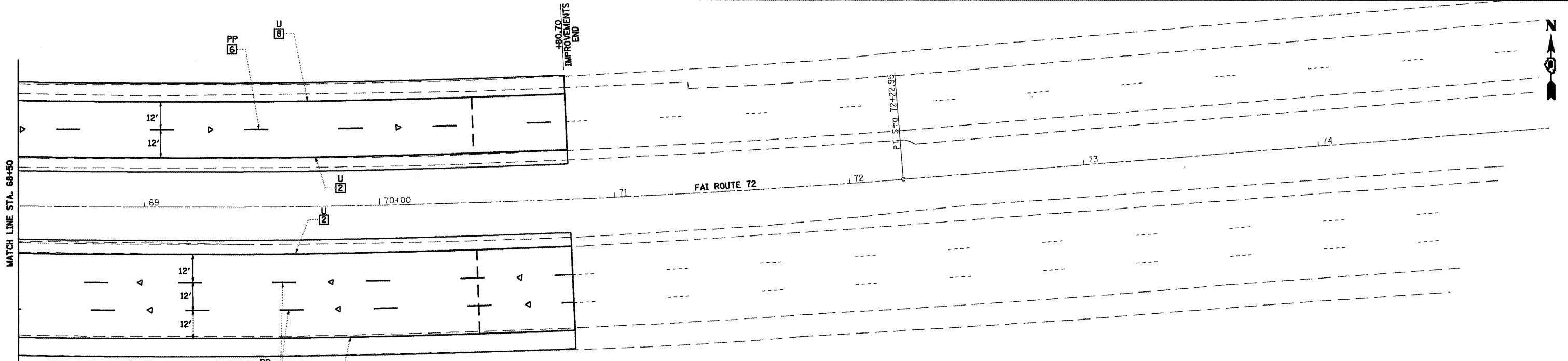
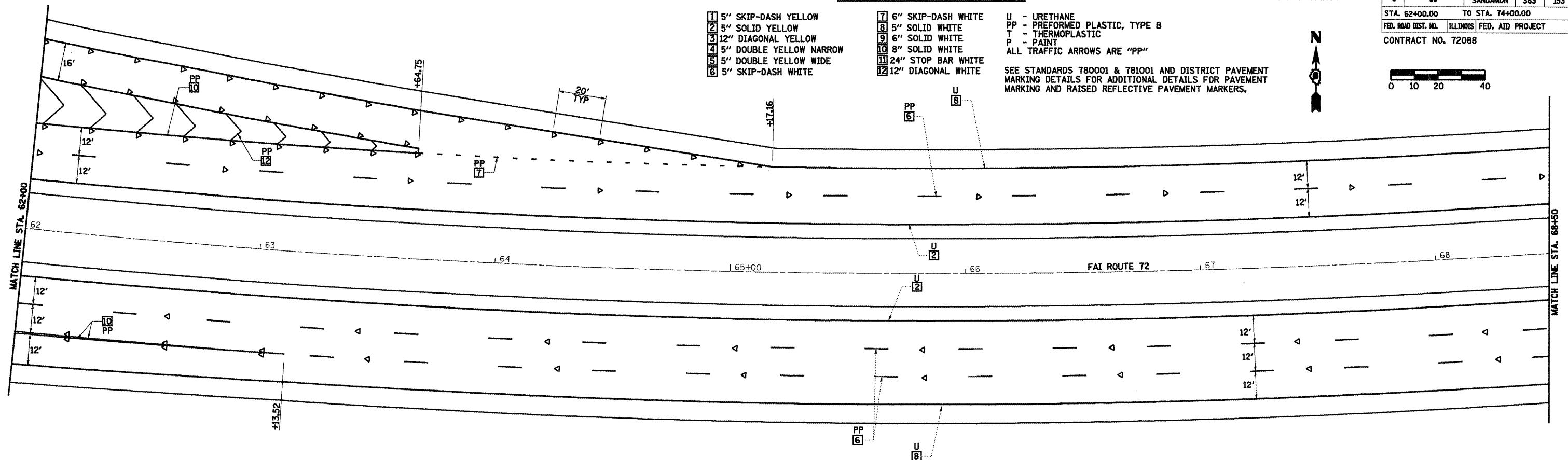
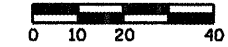

LEGEND

- RAISED REFL PAVT MKR AMBER BIDIRECTIONAL
- RAISED REFL PAVT MKR AMBER MONODIRECTIONAL
- RAISED REFL PAVT MKR CRYSTAL MONODIRECTIONAL
- PRISMATIC CURB REFLECTOR AMBER BIDIRECTIONAL
- PRISMATIC CURB REFLECTOR AMBER MONODIRECTIONAL
- PRISMATIC CURB REFLECTOR CRYSTAL MONODIRECTIONAL
- EXISTING PAVEMENT MARKING

- ITEM 4 DOUBLE YELLOW (NARROW)
- ITEM 5 DOUBLE YELLOW (WIDE)

| REVISIONS | |
|-----------|------|
| NAME | DATE |
| | |
| | |
| | |
| | |
| | |
| | |
| | |
| | |
| | |
| | |

ILLINOIS DEPARTMENT OF TRANSPORTATION
**PAVEMENT MARKING PLAN
CLEAR LAKE AVENUE**
SCALE: VERT. _____
 HORIZ. _____
DATE 08/05
DRAWN BY MLO
CHECKED BY SJK