

F.A.P. 72, F.A.P. 67, F.A.P. 75 & F.A.P. 668
 D-6 SPFLD-CLRLAKE DIRKSEN 2002

F.A.P. SHEETS	SECTION	COUNTY	TOTAL SHEETS	SHEET NO.
•	••	SANGAMON	363	154
STA. 149+00.00		TO STA. 162+00.00		
FED. ROAD DIST. NO.	ILLINOIS	FED. AID PROJECT		
CONTRACT NO. 72088				

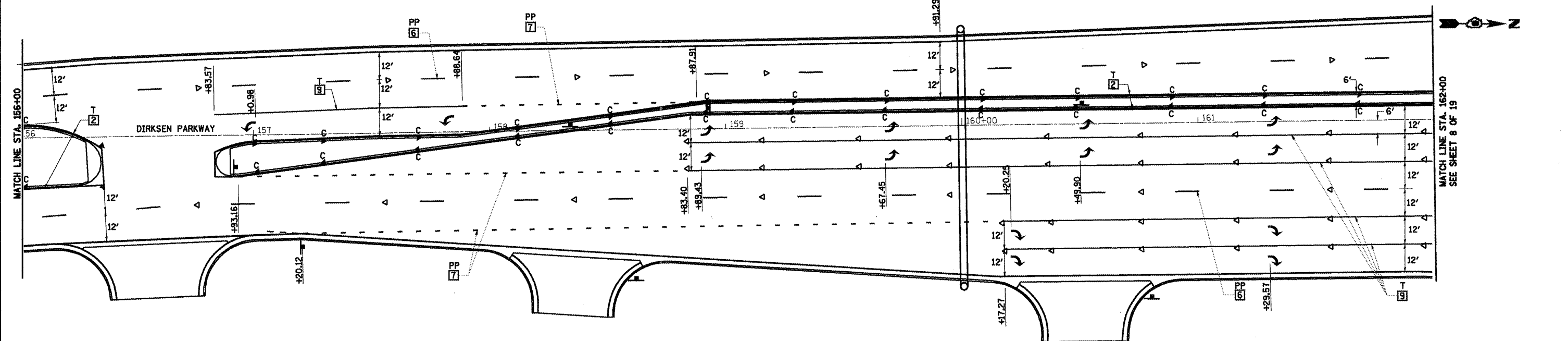
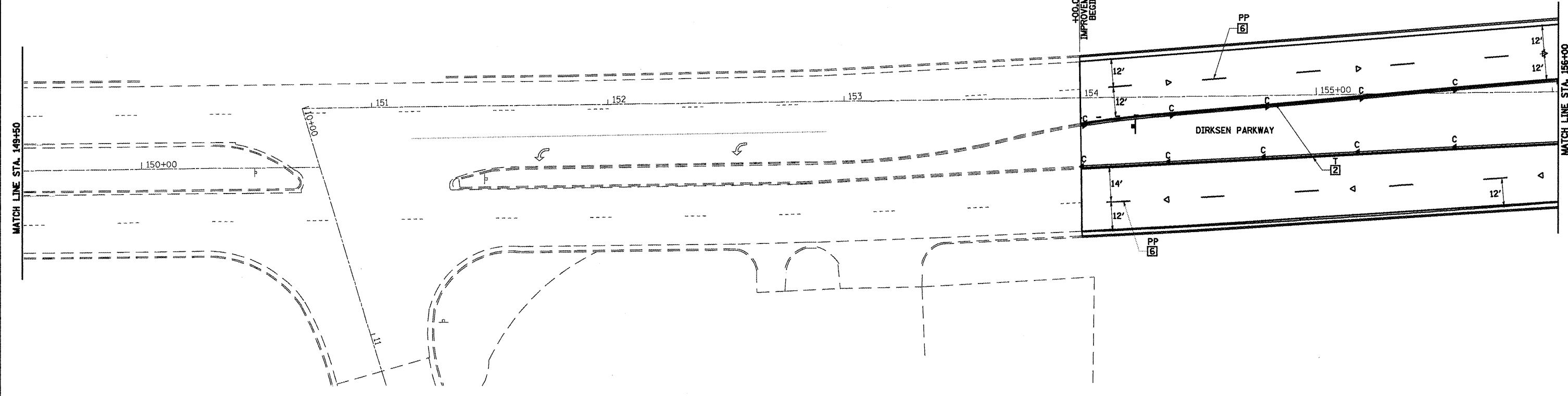
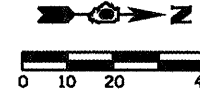

TYPICAL PAVEMENT MARKING LEGEND

- | | | |
|---------------------------|-----------------------|--------------------------------|
| 1 5" SKIP-DASH YELLOW | 7 6" SKIP-DASH WHITE | U - URETHANE |
| 2 5" SOLID YELLOW | 8 5" SOLID WHITE | PP - PREFORMED PLASTIC, TYPE B |
| 3 12" DIAGONAL YELLOW | 9 6" SOLID WHITE | T - THERMOPLASTIC |
| 4 5" DOUBLE YELLOW NARROW | 10 8" SOLID WHITE | P - PAINT |
| 5 5" DOUBLE YELLOW WIDE | 11 24" STOP BAR WHITE | ALL TRAFFIC ARROWS ARE "PP" |
| 6 5" SKIP-DASH WHITE | 12 12" DIAGONAL WHITE | |

LEGEND

- | | | |
|--|--|-------------------------------|
| RAISED REFL PAVT MKR AMBER BIDIRECTIONAL | PRISMATIC CURB REFLECTOR AMBER BIDIRECTIONAL | ITEM 4 DOUBLE YELLOW (NARROW) |
| RAISED REFL PAVT MKR AMBER MONODIRECTIONAL | PRISMATIC CURB REFLECTOR AMBER MONODIRECTIONAL | ITEM 5 DOUBLE YELLOW (WIDE) |
| RAISED REFL PAVT MKR CRYSTAL MONODIRECTIONAL | PRISMATIC CURB REFLECTOR CRYSTAL MONODIRECTIONAL | 6" TYP |
| EXISTING PAVEMENT MARKING | 2" TYP | 10" TYP |
| | 30" TYP | 10" TYP |

SEE STANDARDS 780001 & 781001 AND DISTRICT PAVEMENT MARKING DETAILS FOR ADDITIONAL DETAILS FOR PAVEMENT MARKING AND RAISED REFLECTIVE PAVEMENT MARKERS.

REVISIONS	
NAME	DATE

ILLINOIS DEPARTMENT OF TRANSPORTATION

**PAVEMENT MARKING PLAN
DIRKSEN PARKWAY**

SCALE: VERT. DATE 08/06

DRAWN BY MLO
CHECKED BY SJK

SHEET 13 OF 19