

F.A.P. 72, F.A.P. 67, F.A.P. 75 & F.A.P. 668
 D-6 SPFLD-CLRLAKE DIRKSEN 2002

F.A.P. SECTION	COUNTY	TOTAL SHEETS	SHEET NO.
..	SANGAMON	363	155
STA. 166+00.00 TO STA. 178+00.00			
FED. ROAD DIST. NO. ILLINOIS		FED. AID PROJECT	
CONTRACT NO. 72088			

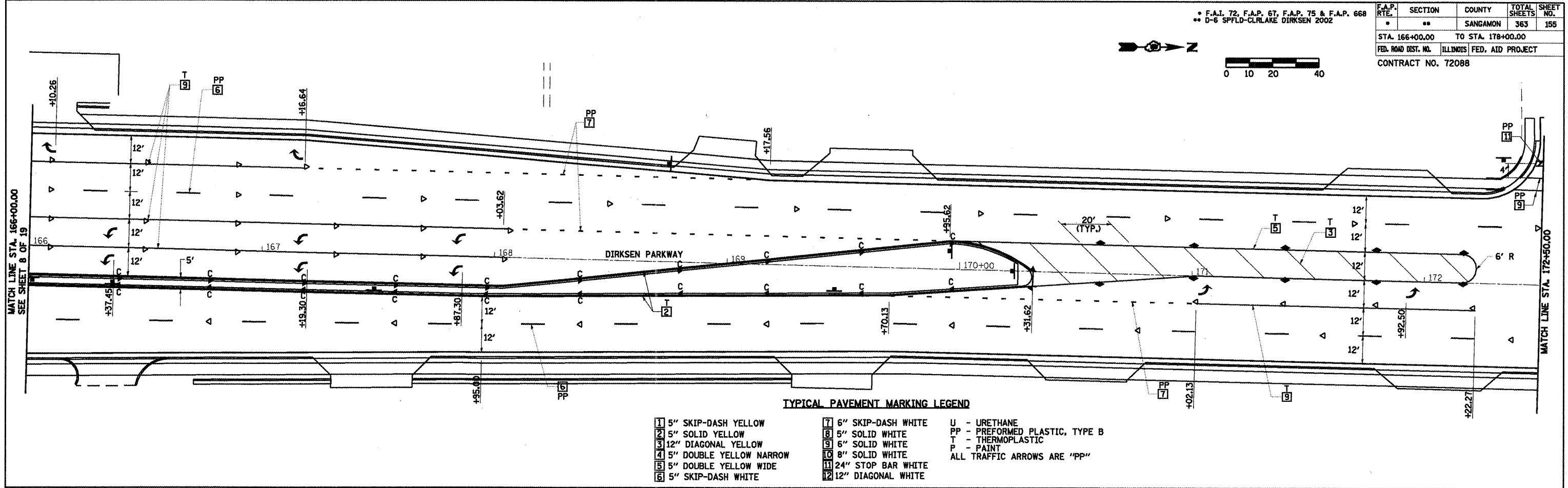
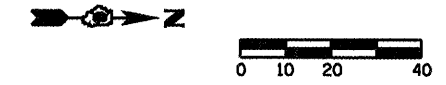

TYPICAL PAVEMENT MARKING LEGEND

- | | | |
|---------------------------|-----------------------|--------------------------------|
| 1 5" SKIP-DASH YELLOW | 7 5" SKIP-DASH WHITE | U - URETHANE |
| 2 5" SOLID YELLOW | 8 5" SOLID WHITE | PP - PREFORMED PLASTIC, TYPE B |
| 3 12" DIAGONAL YELLOW | 9 6" SOLID WHITE | T - THERMOPLASTIC |
| 4 5" DOUBLE YELLOW NARROW | 10 8" SOLID WHITE | P - PAINT |
| 5 5" DOUBLE YELLOW WIDE | 11 24" STOP BAR WHITE | ALL TRAFFIC ARROWS ARE "PP" |
| 6 5" SKIP-DASH WHITE | 12 12" DIAGONAL WHITE | |

SEE STANDARDS 780001 & 781001 AND DISTRICT PAVEMENT MARKING DETAILS FOR ADDITIONAL DETAILS FOR PAVEMENT MARKING AND RAISED REFLECTIVE PAVEMENT MARKERS.

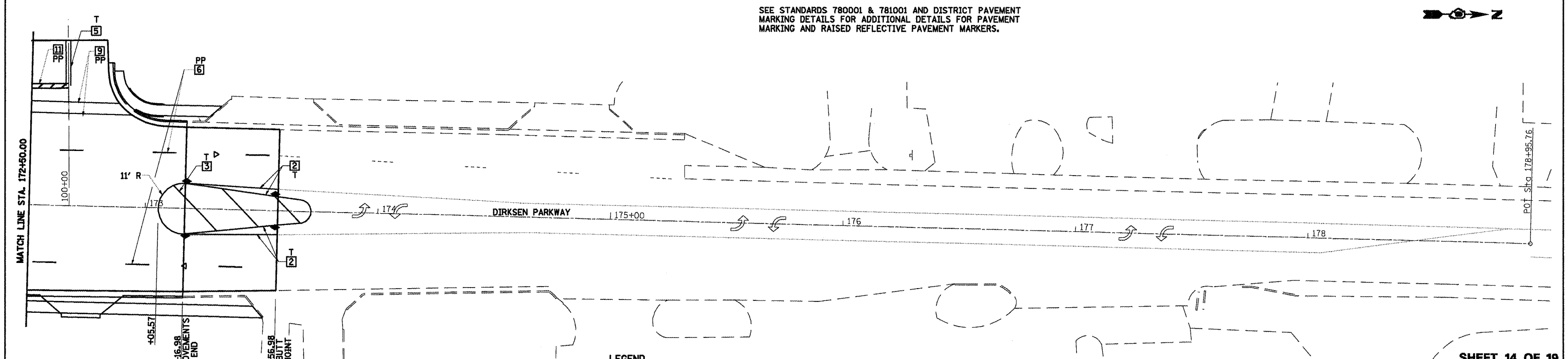

LEGEND

- | | |
|--|--|
| RAISED REFL PAVT MKR AMBER BIDIRECTIONAL | PRISMATIC CURB REFLECTOR AMBER BIDIRECTIONAL |
| RAISED REFL PAVT MKR AMBER MONODIRECTIONAL | PRISMATIC CURB REFLECTOR AMBER MONODIRECTIONAL |
| RAISED REFL PAVT MKR CRYSTAL MONODIRECTIONAL | PRISMATIC CURB REFLECTOR CRYSTAL MONODIRECTIONAL |
| EXISTING PAVEMENT MARKING | |

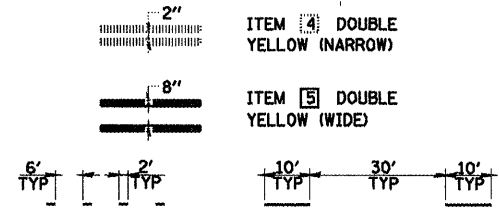

REVISIONS	
NAME	DATE

SHEET 14 OF 19
 ILLINOIS DEPARTMENT OF TRANSPORTATION
PAVEMENT MARKING PLAN
DIRKSEN PARKWAY
 SCALE: VERT. _____
 DATE 08/05
 DRAWN BY MLO
 CHECKED BY SJK