

F.A.P. 72, F.A.P. 67, F.A.P. 75 & F.A.P. 668
 D-6 SPFLD-CLRLAKE DIRKSEN 2002

F.A.P. RTE.	SECTION	COUNTY	TOTAL SHEETS	SHEET NO.
	..	SANGAMON	363	159
STA. TO STA.				
FED. ROAD DIST. NO. ILLINOIS FED. AID PROJECT				
CONTRACT NO. 72088				

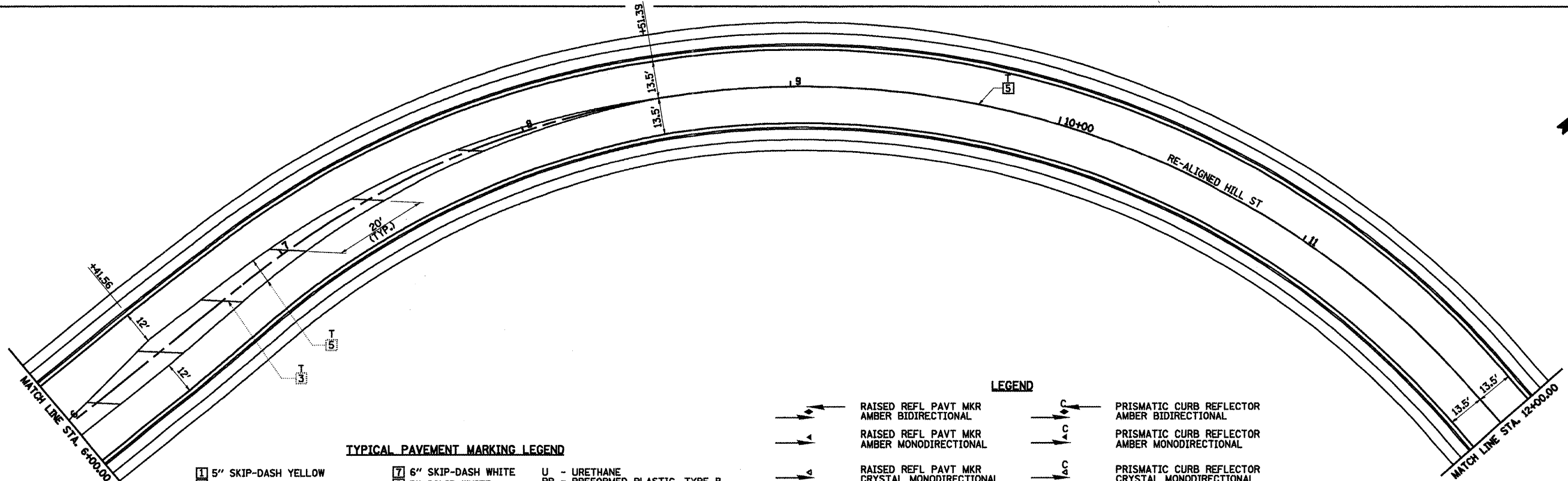
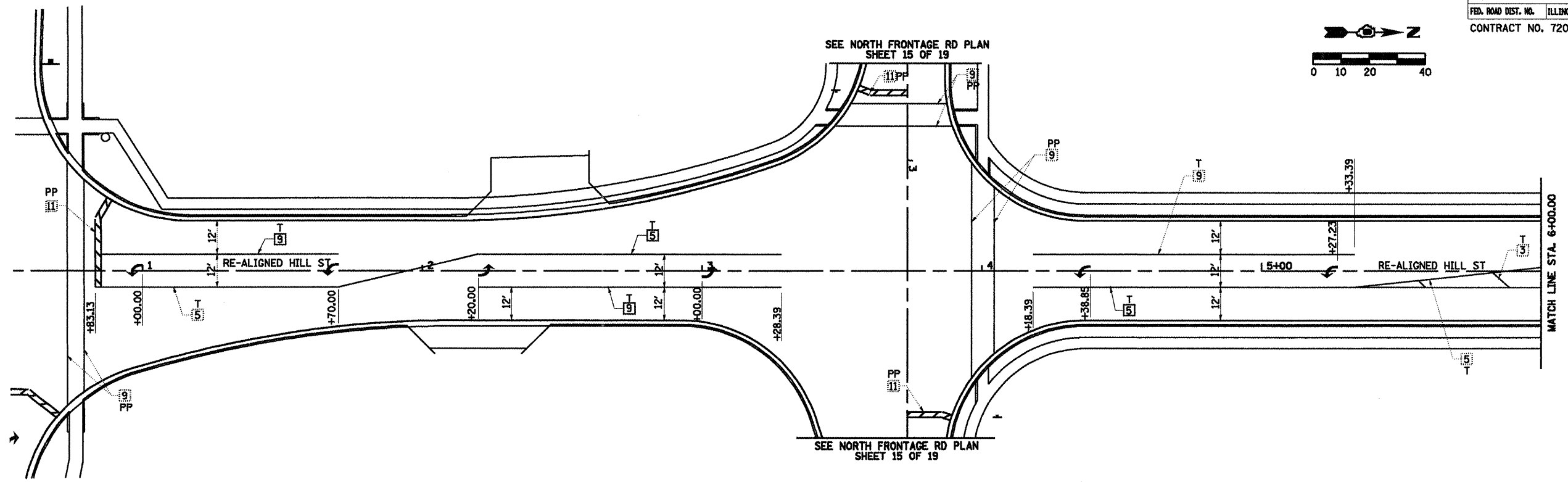
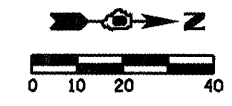

TYPICAL PAVEMENT MARKING LEGEND

1 5" SKIP-DASH YELLOW	7 6" SKIP-DASH WHITE	U - URETHANE
2 5" SOLID YELLOW	8 5" SOLID WHITE	PP - PREFORMED PLASTIC, TYPE B
3 12" DIAGONAL YELLOW	9 6" SOLID WHITE	T - THERMOPLASTIC
4 5" DOUBLE YELLOW NARROW	10 8" SOLID WHITE	P - PAINT
5 5" DOUBLE YELLOW WIDE	11 24" STOP BAR WHITE	ALL TRAFFIC ARROWS ARE "PP"
6 5" SKIP-DASH WHITE	12 12" DIAGONAL WHITE	

LEGEND

	RAISED REFL PAVT MKR AMBER BIDIRECTIONAL		PRISMATIC CURB REFLECTOR AMBER BIDIRECTIONAL
	RAISED REFL PAVT MKR AMBER MONODIRECTIONAL		PRISMATIC CURB REFLECTOR AMBER MONODIRECTIONAL
	RAISED REFL PAVT MKR CRYSTAL MONODIRECTIONAL		PRISMATIC CURB REFLECTOR CRYSTAL MONODIRECTIONAL
	EXISTING PAVEMENT MARKING		
	ITEM 4 DOUBLE YELLOW (NARROW)		ITEM 5 DOUBLE YELLOW (WIDE)

SEE STANDARDS 780001 & 781001 AND DISTRICT PAVEMENT MARKING DETAILS FOR ADDITIONAL DETAILS FOR PAVEMENT MARKING AND RAISED REFLECTIVE PAVEMENT MARKERS.

REVISIONS

NAME	DATE

SHEET 18 OF 19

ILLINOIS DEPARTMENT OF TRANSPORTATION

**PAVEMENT MARKING PLAN
HILL STREET**

SCALE: VERT. _____
 HORIZ. _____
 DATE 08/05

DRAWN BY MLO
 CHECKED BY S.K.