

F.A.P. 72, F.A.P. 67, F.A.P. 75 & F.A.P. 668  
 \*\* D-6 SPFLD-CLRLAKE DIRKSEN 2002

F.A.P. RTE.	SECTION	COUNTY	TOTAL SHEETS	SHEET NO.
	**	SANGAMON	363	171
STA. TO STA.				
FED. ROAD DIST. NO. ILLINOIS FED. AID PROJECT				
CONTRACT NO. 72088				

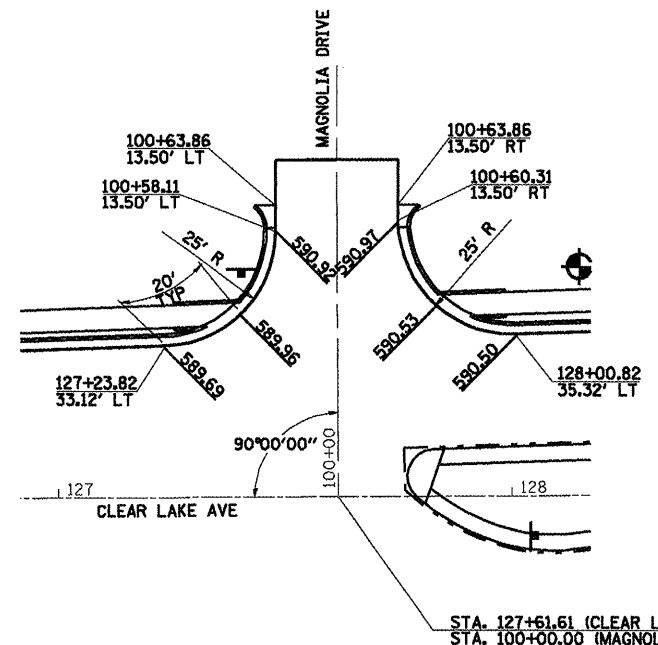

**CLEAR LAKE - MAGNOLIA DR**

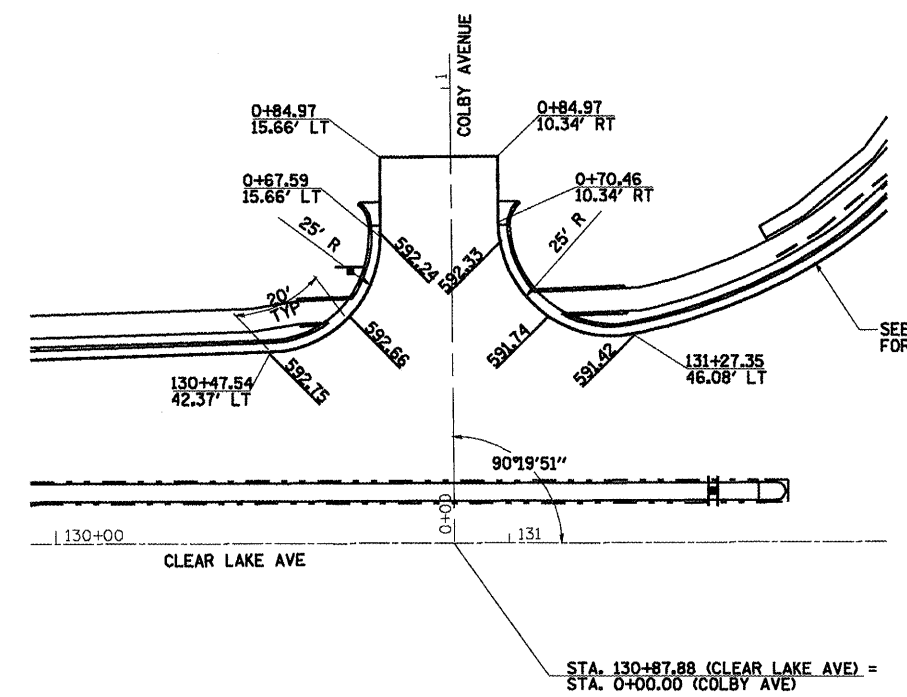

**CLEAR LAKE - COLBY AVE**

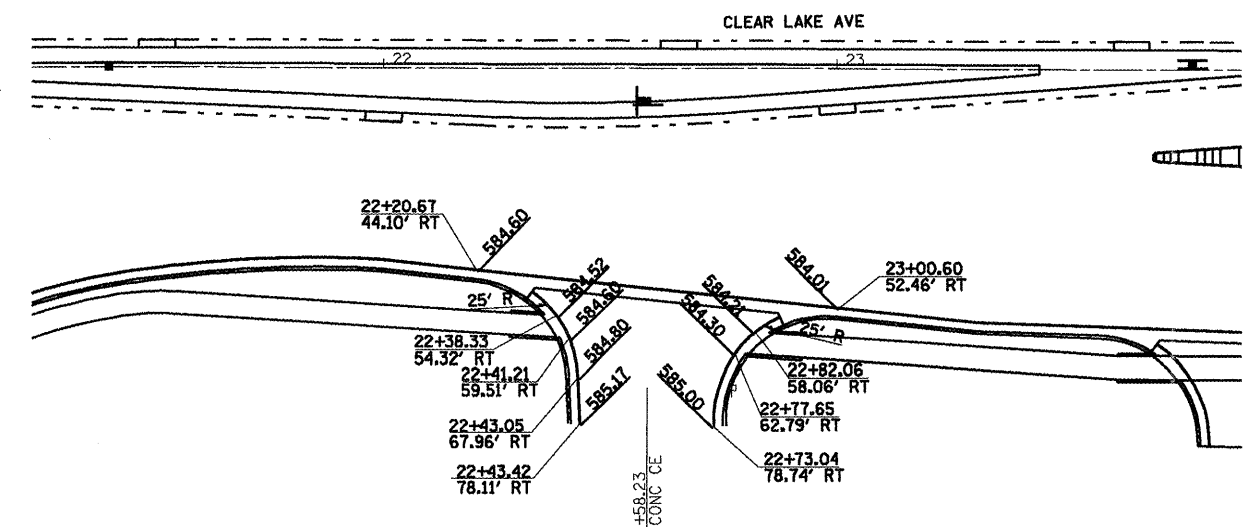

**CLEAR LAKE - MCDONALD'S ENTRANCE**

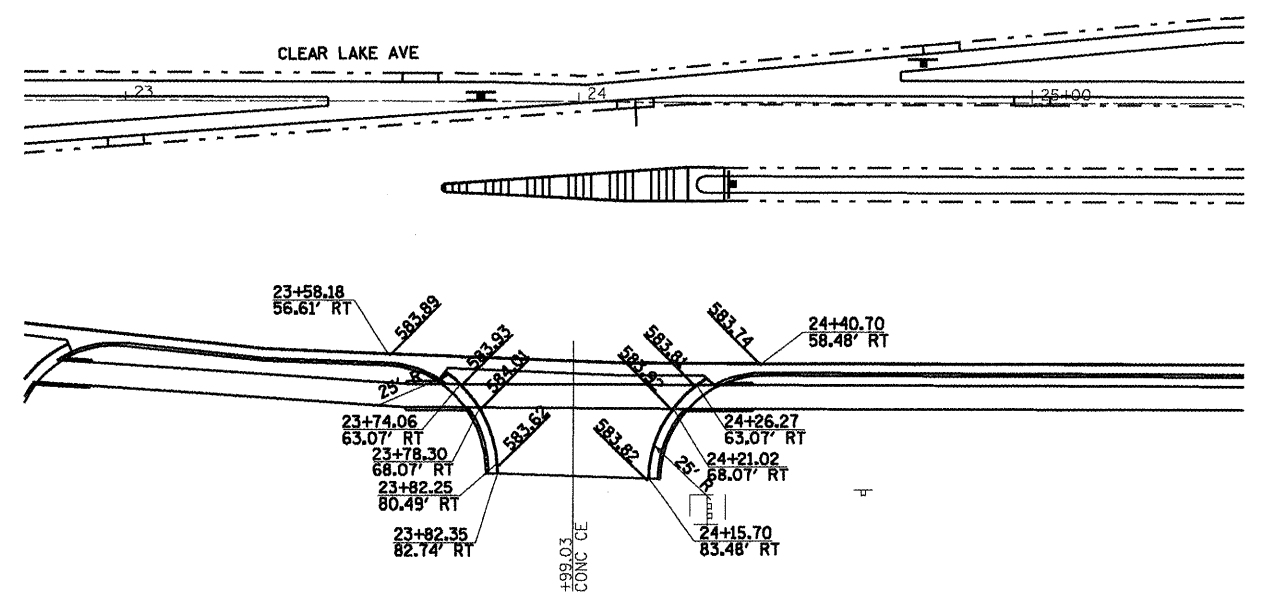

**CLEAR LAKE - MCDONALD'S / WALGREENS ENTRANCE**

SHEET 5 OF 9

**LEGEND**  
 XXXXX PROPOSED FINISHED ELEVATION

REVISIONS	
NAME	DATE

ILLINOIS DEPARTMENT OF TRANSPORTATION  
**INTERSECTION GEOMETRICS**  
 SCALE: 1"=20'  
 DATE 7/13/05  
 DRAWN BY NJV  
 CHECKED BY RMD