

STATE OF ILLINOIS
DEPARTMENT OF TRANSPORTATION

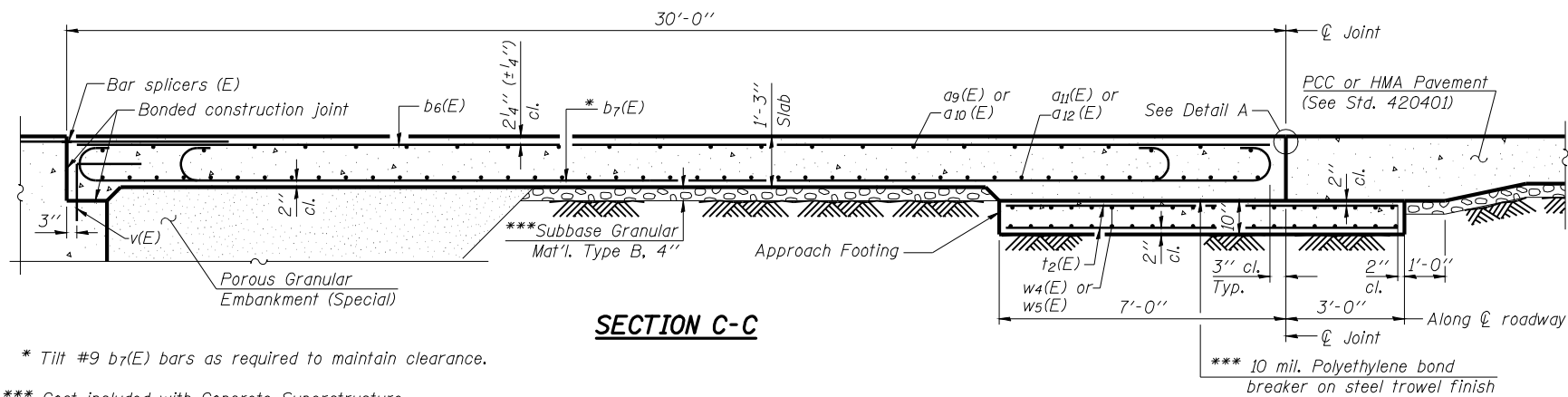

* Tilt #9 b7(E) bars as required to maintain clearance.

*** Cost included with Concrete Superstructure.

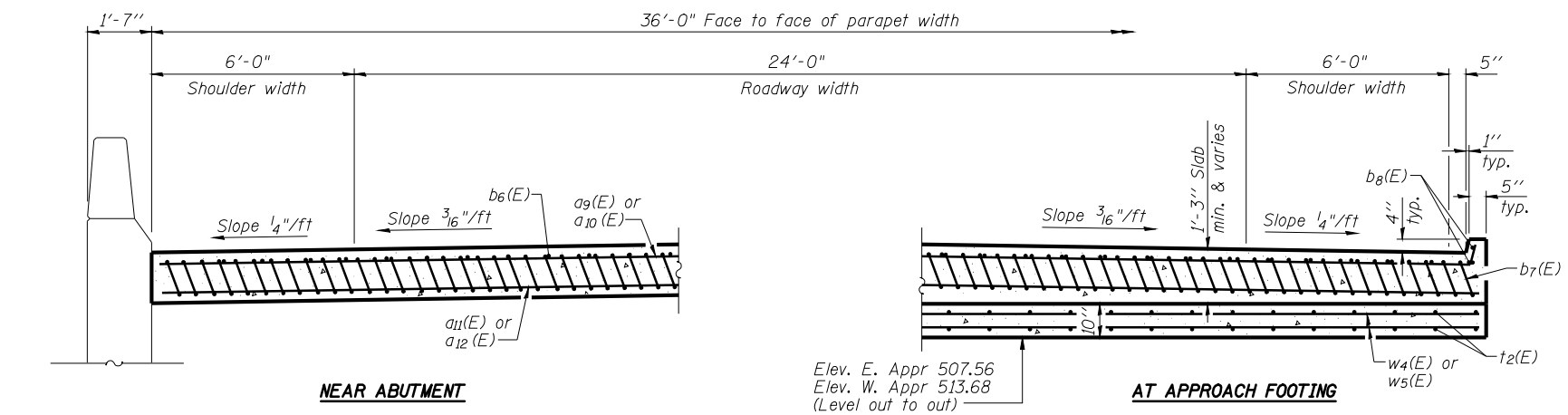

NEAR ABUTMENT

AT APPROACH FOOTING

SECTION D-D

(See Plan for dimensions not shown)

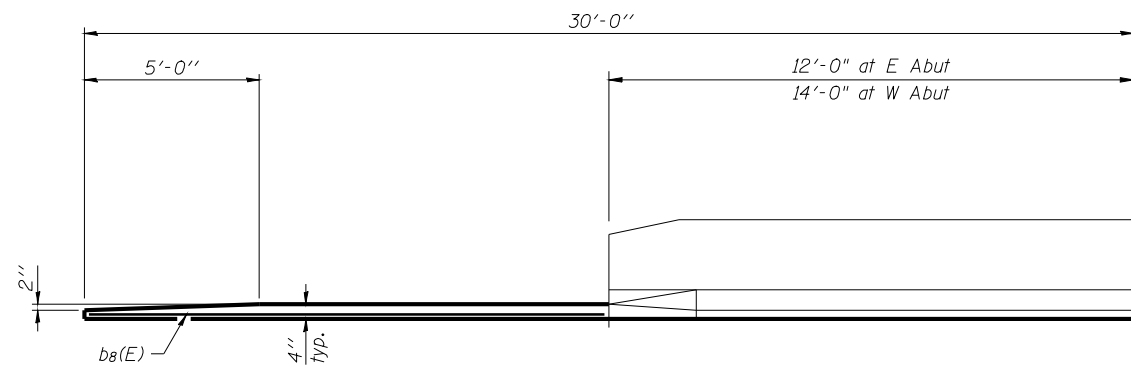

VIEW E-E

Notes:

See sheet 16 of 51 for Detail A and View B-B.
Approach slab concrete shall be paid for as Concrete Superstructure.
Approach footing concrete shall be paid for as Concrete Structures.
Reinforcement shall be paid for as Reinforcement Bars, Epoxy Coated.
For v(E) bar details, see sheet 32 and 34 of 51.
The approach footing maximum applied service bearing pressure (Qmax) = 2.0 ksf.
For bar splicer details, see sheet 45 of 51.
Cost of excavation for approach footing included with Concrete Structures.
For Porous Granular Embankment (Special) and drainage treatment details, see sheet 2 of 51.

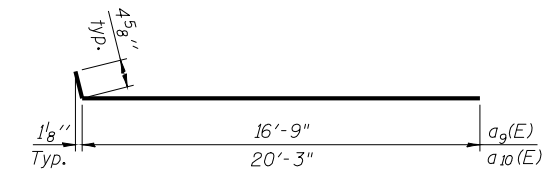

BARS a9(E) & a10(E)

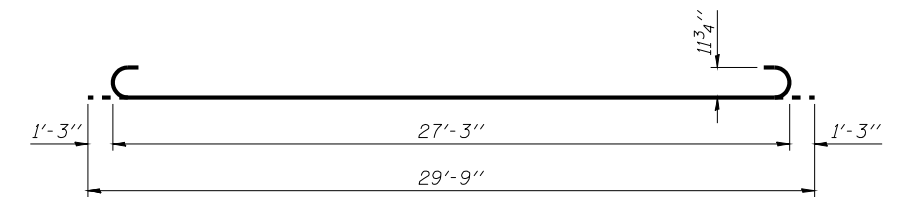

BAR b7(E)

TWO APPROACHES
BILL OF MATERIAL

Bar	No.	Size	Length	Shape
a9(E)	50	#4	17'-2"	—
a10(E)	50	#4	20'-8"	—
a11(E)	92	#5	16'-9"	—
a12(E)	92	#5	20'-3"	—
b6(E)	60	#4	29'-8"	—
b7(E)	172	#9	29'-9"	—
b8(E)	8	#4	17'-8"	—
t2(E)	156	#4	9'-8"	—
w4(E)	80	#5	16'-11"	—
w5(E)	80	#5	20'-5"	—
Concrete Superstructure		Cu. Yd.	102.9	
Concrete Structures		Cu. Yd.	23.4	
Reinforcement Bars, Epoxy Coated		Pound	27,620	
Bridge Deck Grooving		Sq. Yd.	226	
Protective Coat		Sq. Yd.	252	
Bar Splicers		Each	222	

(Sheet 2 of 2)

BRIDGE APPROACH SLAB DETAILS
STRUCTURE NUMBER 059-0510

DESIGNED -	J.M.B.
CHECKED -	T.E.S.
DRAWN -	R KING
CHECKED -	J.M.B.

HOMER L.
CHASTAIN
& ASSOCIATES, LLP
CONSULTING ENGINEERS

DECATUR (217) 422-8544
CHICAGO (773) 714-0050
ROCKFORD (815) 489-0050

184-001397

BA-0

11-1-09

SHEET NO. 17 OF 51 SHEETS	F.A.P. RTE.	SECTION	COUNTY	TOTAL SHEETS	SHEET NO.
	761	107B-2	MACOUPIN	98	47
FAP ROUTE 761 (IL RT 108)			CONTRACT NO. 72A94		
FED. ROAD DIST. NO.		ILLINOIS FED. AID PROJECT			