

STATE OF ILLINOIS
DEPARTMENT OF TRANSPORTATION

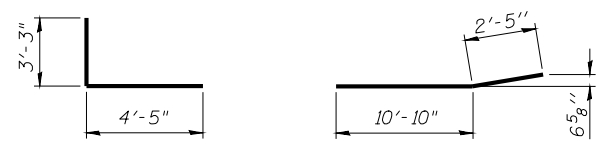

BAR h4(E)

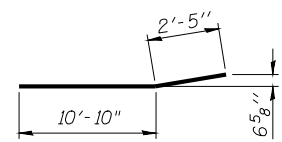

BAR h6(E)

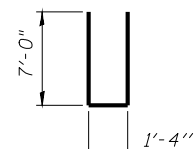

BAR n(E)

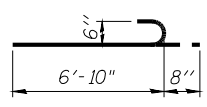

BAR n1(E)

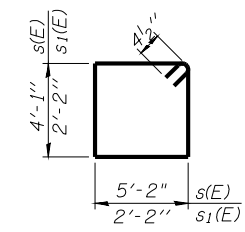

BARS s(E) & s1(E)

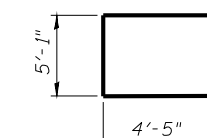

BAR u(E)

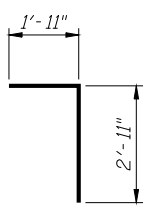

BAR v(E)

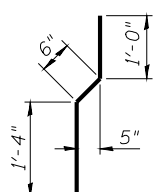

BAR v1(E)

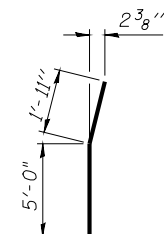

BAR v5(E)

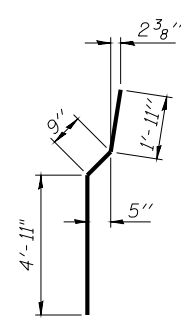

BAR v6(E)

PILE DATA

Type: Steel HP12x53
Nominal Required Bearing: 290 kips
Factored Resistance Available: 145 kips
Est. Length: 72'
No. Req'd: 16
Test Pile: 1

HOMER L. CHASTAIN & ASSOCIATES, LLP
CONSULTING ENGINEERS

DECATUR (217) 422-8544
CHICAGO (773) 714-0050
ROCKFORD (815) 489-0050

184-001397

DESIGNED -	J.M.B.
CHECKED -	T.E.S.
DRAWN -	R KING
CHECKED -	J.M.B.

A-1

10-1-08

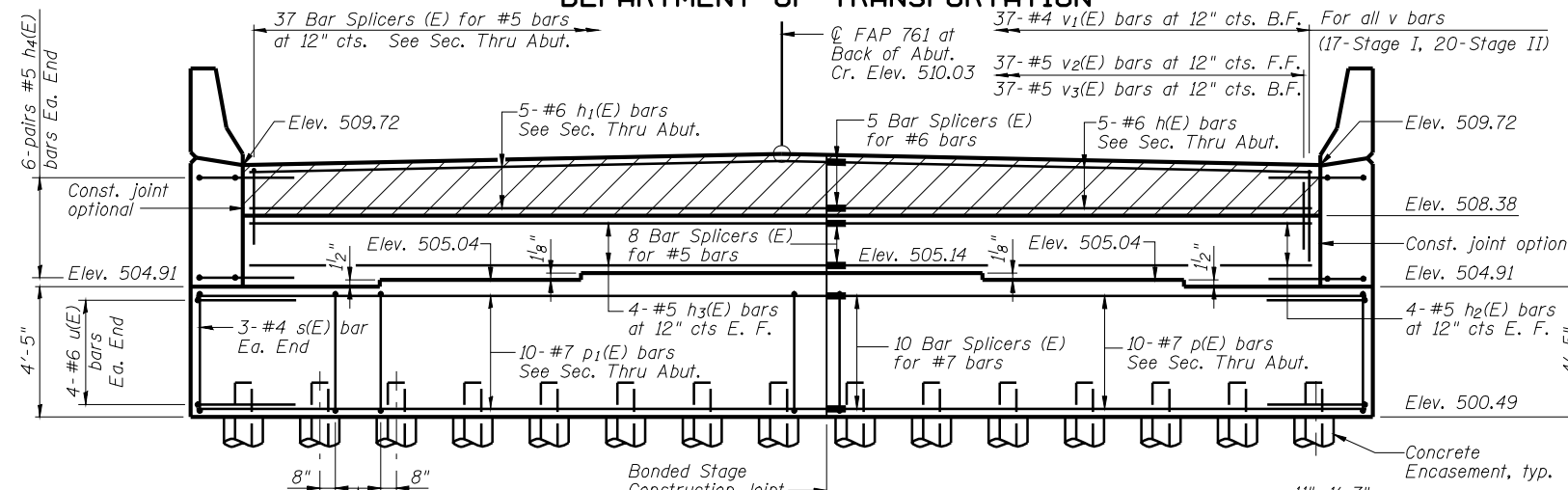

ELEVATION
(Looking East)

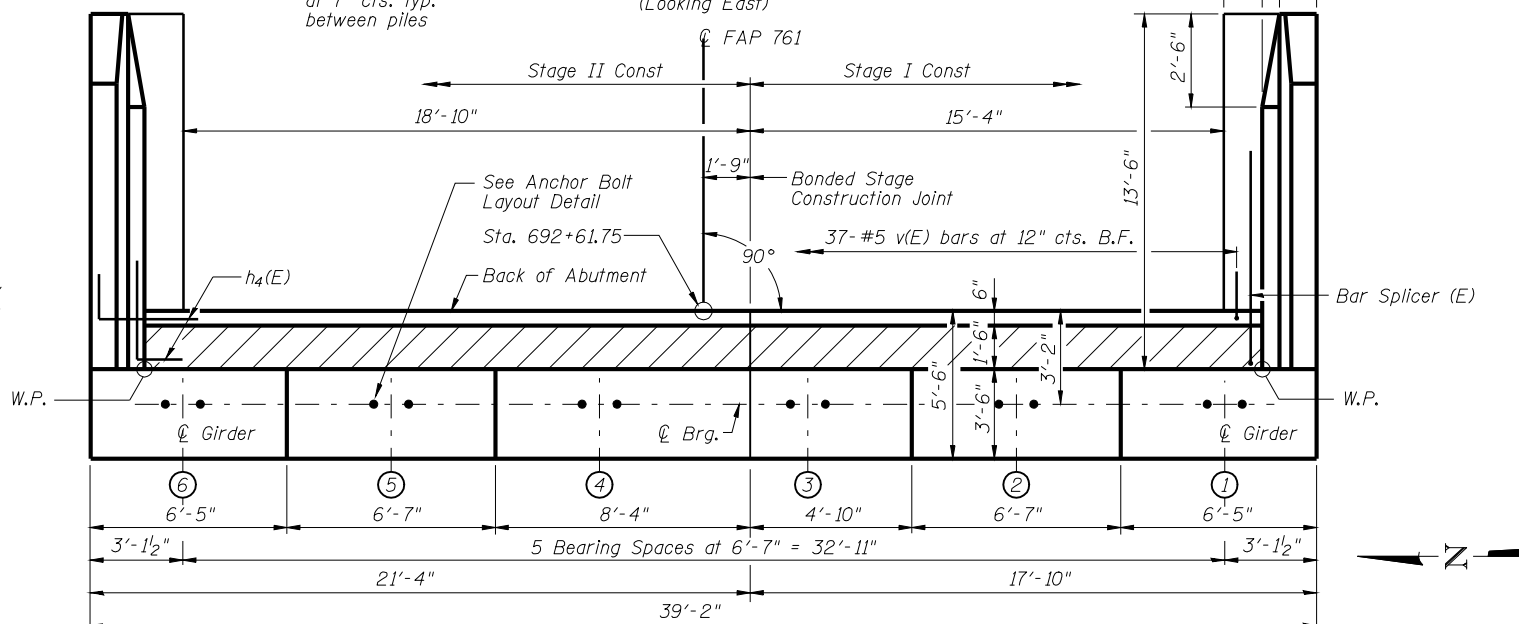

TOP VIEW

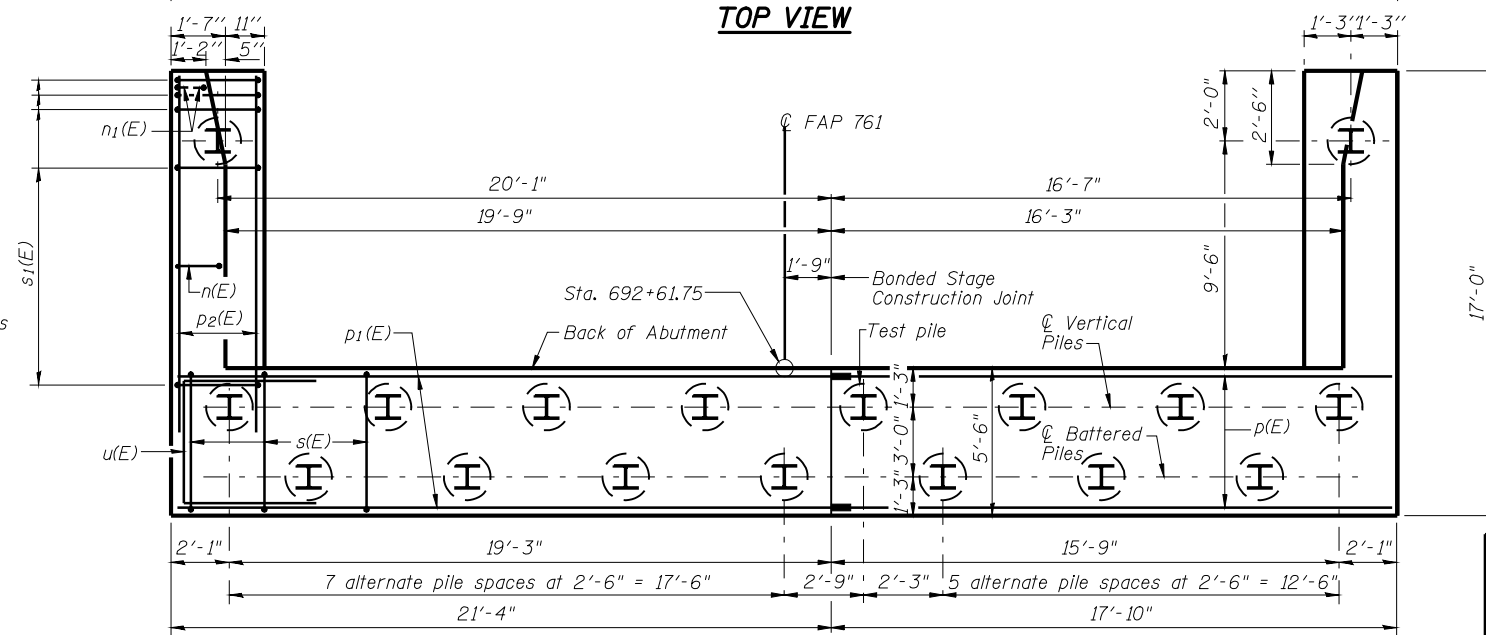

PLAN-PILE CAP

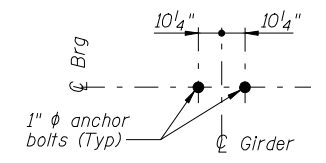

ANCHOR BOLT LAYOUT DETAIL

ABUTMENT BILL OF MATERIAL

Bar	No.	Size	Length	Shape
h(E)	5	#6	16'-0"	—
h1(E)	5	#6	19'-6"	—
h2(E)	8	#5	16'-0"	—
h3(E)	8	#5	19'-6"	—
h4(E)	24	#5	7'-8"	—
h5(E)	22	#4	13'-3"	—
h6(E)	14	#4	13'-3"	—
n(E)	22	#6	15'-4"	—
n1(E)	12	#6	7'-6"	—
p(E)	10	#7	17'-7"	—
p1(E)	10	#7	21'-1"	—
p2(E)	12	#7	14'-6"	—
s(E)	48	#4	19'-3"	—
s1(E)	30	#4	9'-5"	—
u(E)	8	#6	13'-11"	—
v(E)	37	#5	4'-10"	—
v1(E)	37	#4	2'-10"	—
v2(E)	37	#5	6'-10"	—
v3(E)	37	#5	5'-9"	—
v4(E)	28	#6	7'-4"	—
v5(E)	6	#6	6'-11"	—
v6(E)	22	#6	7'-7"	—
Structure Excavation			Cu. Yd.	258
Concrete Structures			Cu. Yd.	59.6
Reinforcement Bars, Epoxy Coated			Pound	5200
Furnishing Steel Piles HP12x53			Foot	1152
Driving Piles			Foot	1152
Test Pile Steel HP12x53			Each	1
Concrete Encasement			Cu. Yd.	6.0
Concrete Sealer			Sq. Ft.	453
Bar Splicers			Each	60

Note:
For details of Bar Splicers, see sheet 45 of 51.

For details of piles and Concrete Encasement, see sheet 44 of 51.

B.F.= Back Face, F.F.= Front Face, E.F.= Each Face

**EAST ABUTMENT DETAILS
STRUCTURE NUMBER 059-0510**

SHEET NO. 32 OF 51 SHEETS	F.A.P. RTE. 761	SECTION 107B-2	COUNTY MACOUPIN	TOTAL SHEETS 98	SHEET NO. 62
	FAP ROUTE 761 (IL RT 108)		CONTRACT NO. 72A94		
FED. ROAD DIST. NO.		ILLINOIS FED. AID PROJECT			