

F.A.P. RTE.	SECTION	COUNTY	TOTAL SHEETS	SHEET NO.
554	(18G) CR	PIKE	4	1
FED. ROAD DIST. NO.	ILLINOIS	CONTRACT NO. 72D79		

STATE OF ILLINOIS  
DEPARTMENT OF TRANSPORTATION  
DIVISION OF HIGHWAYS

# PROPOSED CONTRACT MAINTENANCE

FOR INDEX OF SHEETS, SEE SHEET NO. 2

FAP 554 ( IL 107)  
SECTION (18G) I

PIKE COUNTY

D-96-014-10

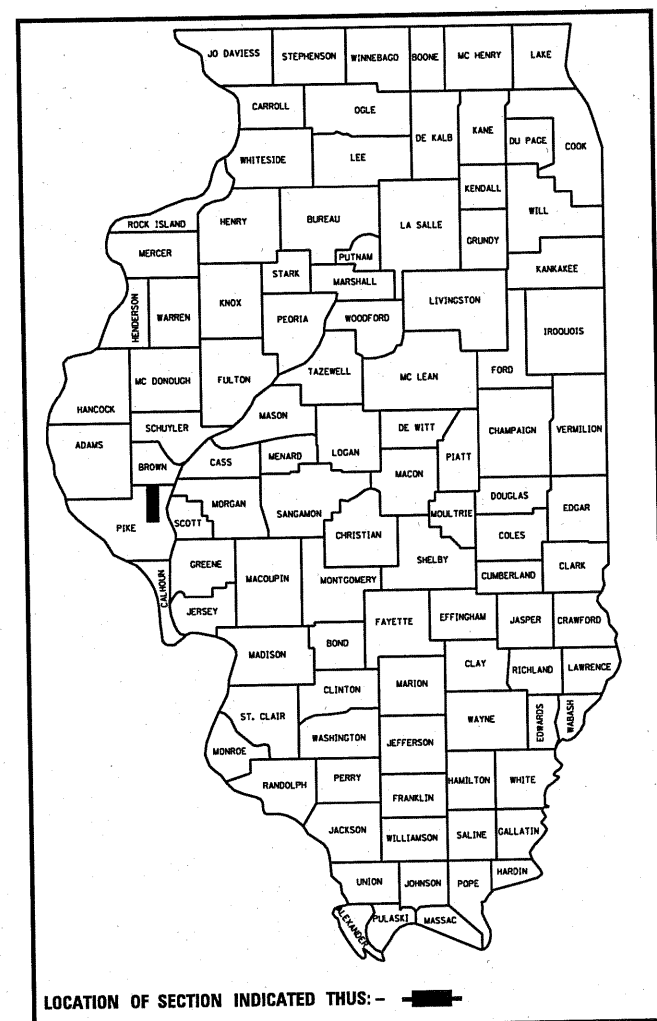

C-96-014-10

R 3 W

BEGIN PROJECT  
STA. 539 + 10

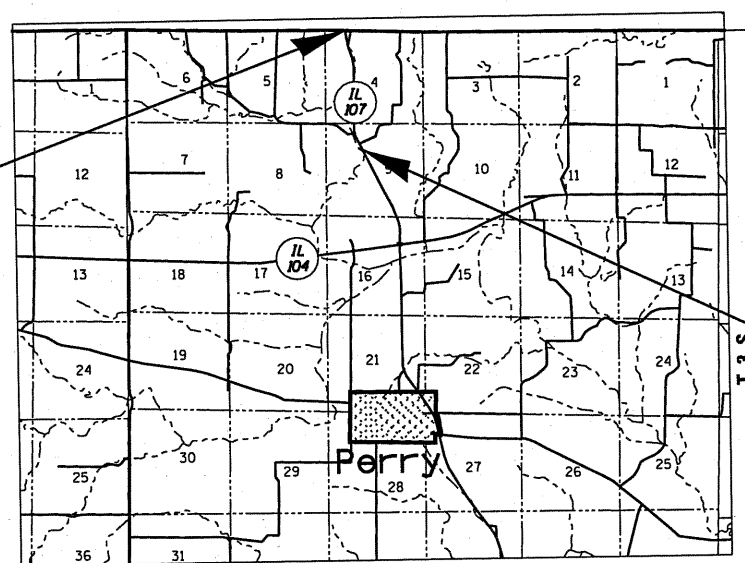

END PROJECT  
STA. 600 + 90

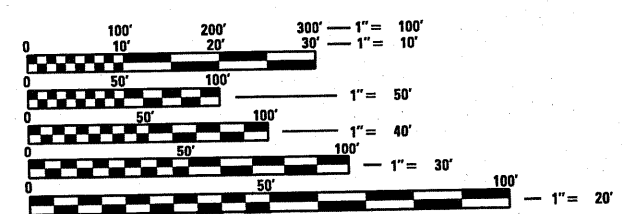

FULL SIZE PLANS HAVE BEEN PREPARED USING STANDARD ENGINEERING SCALES. REDUCED SIZED PLANS WILL NOT CONFORM TO STANDARD SCALES. IN MAKING MEASUREMENTS ON REDUCED PLANS, THE ABOVE SCALES MAY BE USED.

J.U.L.I.E.  
JOINT UTILITY LOCATION INFORMATION FOR EXCAVATION  
1-800-892-0123  
OR 811

PLAN AND CONTRACT TECHNICIAN  
TIMOTHY SHARP (217)782-7743

CONTRACT NO. 72D79

GROSS LENGTH = 6,180.00 FT. = 1.170 MILE

STATE OF ILLINOIS  
DEPARTMENT OF TRANSPORTATION  
DIVISION OF HIGHWAYS

SUBMITTED July 1 20 10  
Reg. 2 Smith  
DEPUTY DIRECTOR OF HIGHWAYS, REGION ENGINEER

Aug 13 20 10  
Scott E. Still P.E. IBC  
ACTING ENGINEER OF DESIGN AND ENVIRONMENT

Aug 13 20 10  
Christine M. Reed  
DIRECTOR OF HIGHWAYS, CHIEF ENGINEER

PRINTED BY THE AUTHORITY  
OF THE STATE OF ILLINOIS