

DATE	
BY	
REVISIONS	
1. PLOTTED	
2. ALIGNED, CHECKED	
3. NOTE BOOK	
4. CAD FILE NAME	
5. NO.	
PLAN	

DATE	
BY	
REVISIONS	
1. GRADES CHECKED	
2. BLK. NOTED	
3. STRUCTURE NOTATIONS OK'D	
4. NO.	
PROFILE	

PROP. FAYETTE RAMP A
CURVE C54
PI STA. = 18+64.45
Δ = 48° 09' 41" (LT)
D = 16° 22' 13"
R = 350.00'
T = 156.42'
L = 294.20'
E = 33.36'
e = 7.90%
T.R. = 39'
S.E. RUN = 205'
P.C. STA. = 17+08.03
P.T. STA. = 20+02.23

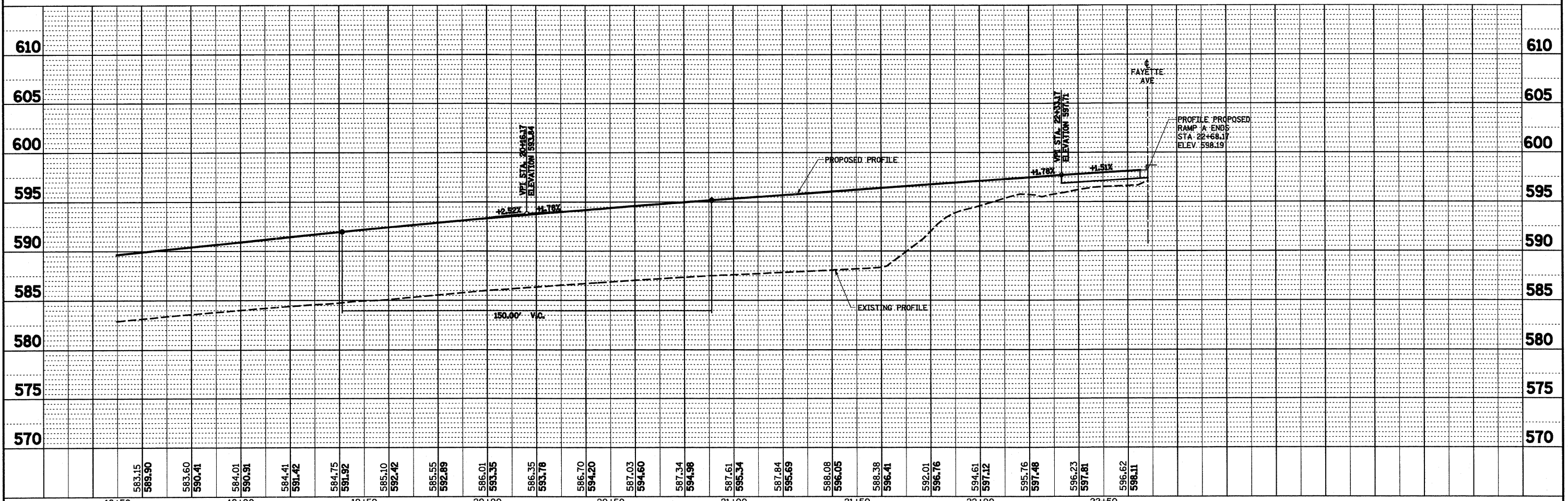
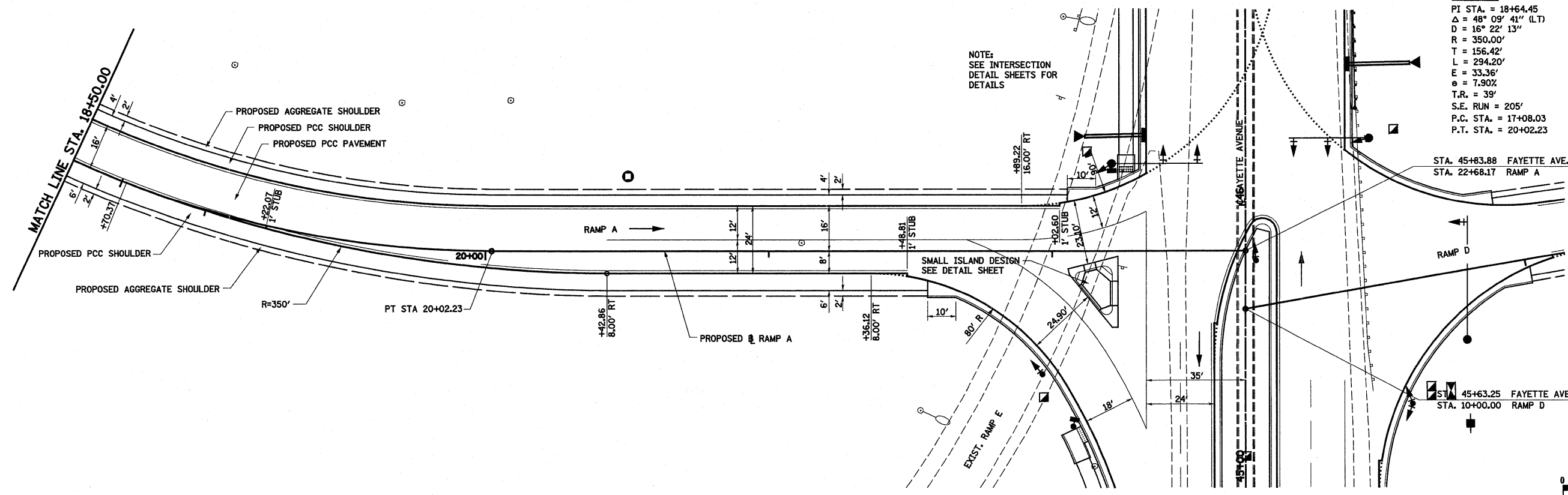

FILE NAME =	USER NAME = paul	DESIGNED - JWS	REVISED -	STATE OF ILLINOIS DEPARTMENT OF TRANSPORTATION	PLAN AND PROFILE, RAMP A, FAYETTE AVENUE	F.A.I. RTE.	SECTION	COUNTY	TOTAL SHEETS	SHEET NO.	
S:\Projects\403-00072-57-10\dgn\Fayette\top_20_Ramps.dwg		DRAWN - PDB	REVISED -			57/70	(25-3)I-6	EFFINGHAM	839	61	
PLOT SCALE = 40.0000' / IN.		CHECKED - BRM	REVISED -			SCALE: 1"=20'		SHEET NO. 4 OF 12 SHEETS		STA. 18+50.00 TO STA. 22+68.17	
PLOT DATE = 6/24/2018		DATE - 11-16-07	REVISED -			CONTRACT NO. 74293		FED. ROAD DIST. NO. ILLINOIS FED. AID PROJECT			