

PROP. CURVE BIKE3-8  
 PI STA = 47+70.63  
 $\Delta = 26^\circ 20' 03''$  (RT)  
 $D = 57' 17' 45''$   
 $R = 100.00'$   
 $T = 23.39'$   
 $L = 45.36'$   
 $E = 2.70'$   
 P.C. STA = 47+47.23  
 P.T. STA = 47+93.20

PROP. CURVE BIKE3-9  
 PI STA = 48+85.49  
 $\Delta = 26^\circ 04' 21''$  (LT)  
 $D = 57' 17' 45''$   
 $R = 100.00'$   
 $T = 23.15'$   
 $L = 45.51'$   
 $E = 2.65'$   
 P.C. STA = 48+62.34  
 P.T. STA = 49+07.84

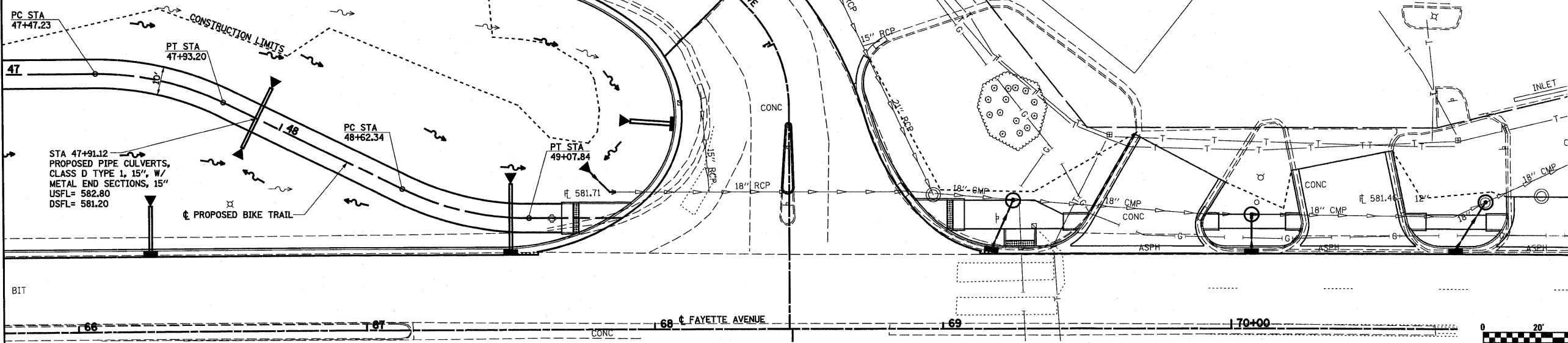

MATCH LINE STA 47+00.00



PLAN	REVISIONS	BY	DATE
NO.	NO.		
NO.	NO.		
NO.	NO.		
NO.	NO.		
NO.	NO.		
NO.	NO.		
NO.	NO.		

PROFILE	REVISIONS	BY	DATE
NO.	NO.		
NO.	NO.		
NO.	NO.		
NO.	NO.		
NO.	NO.		
NO.	NO.		
NO.	NO.		

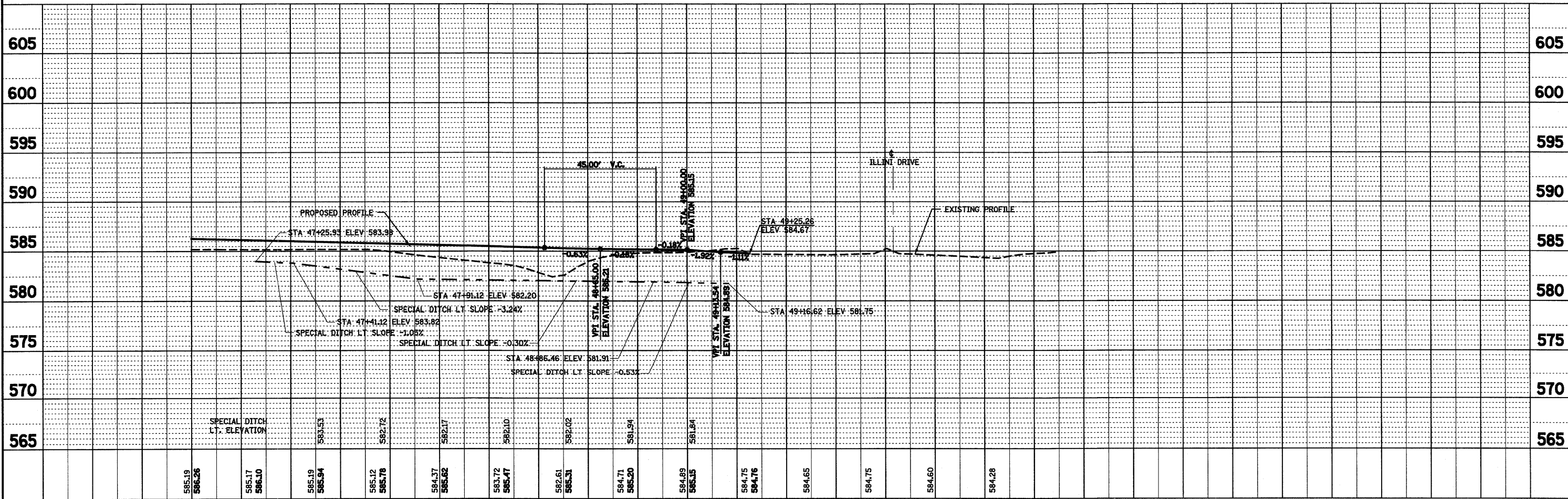

FILE NAME =	USER NAME = paul	DESIGNED - JWS	REVISED -	<b>STATE OF ILLINOIS</b> <b>DEPARTMENT OF TRANSPORTATION</b>	<b>PLAN AND PROFILE, BIKE TRAIL</b>	F.A.T. RTE.	SECTION	COUNTY	TOTAL SHEETS	SHEET NO.
S:\Projects\403-00072-57-70\dgn\FayetteVp_20_Bike Trail.dgn		DRAWN - PDB	REVISED -			57/70	(25-3)I-6	EFFINGHAM	839	74
PLOT SCALE = 48.0000" / IN.		CHECKED - BRM	REVISED -			CONTRACT NO. 74293				
PLOT DATE = 6/24/2010		DATE - 11-25-09	REVISED -			SCALE: 1"=20'	SHEET NO. 4 OF 4 SHEETS	STA. 47+00.00 TO STA. 49+40.20	FED. ROAD DIST. NO.	ILLINOIS FED. AID PROJECT