

**TEMPORARY RAMP C CONNECTOR**

DESCRIPTION	COORDINATE	
	NORTHING	EASTING
POT STA 29+15.70	892629.17	917322.64
POT STA 31+00.00	892805.55	917376.09
PC STA 31+00.01	892805.55	917376.09
PI STA 32+97.87	892987.59	917453.61
PT STA 34+88.19	893113.68	917606.09
POT STA 35+33.55	893142.59	917641.04

PROP. CURVE  
TEMPORARY PAVEMENT  
RAMP C  
PI STA. = 32+97.87  
Δ = 27° 20' 38" (RT)  
D = 7° 02' 39"  
R = 813.39'  
T = 197.86'  
L = 388.18'  
E = 23.72'  
P.C. STA = 31+00.01  
P.T. STA = 34+88.19

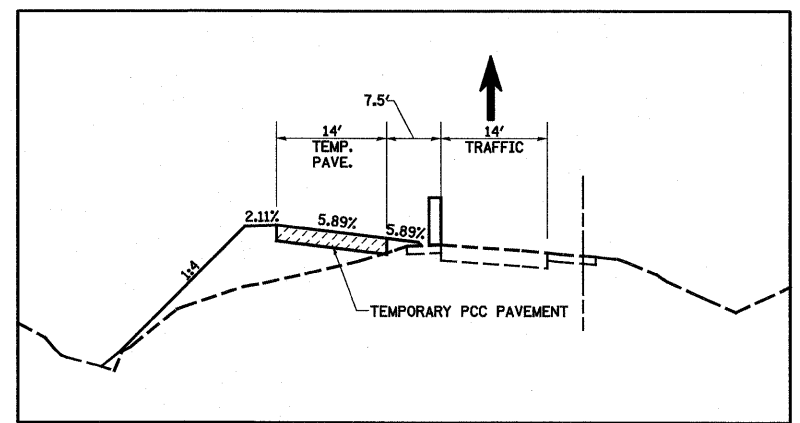

SECTION E-E

**NOTES: PRE-STAGE 1**

1. MAINTAIN TRAFFIC ON EXISTING RAMP C
2. CONSTRUCT TEMPORARY PAVEMENT ALONG THE WEST SIDE OF EXISTING RAMP C FROM STATION 9+20.00 TO 14+79.71 AND FROM STATION 18+00.00 TO 19+50.00

**LEGEND**

	WORK AREA THIS STAGE		DIRECTION OF TRAFFIC
	TEMPORARY PCC PAVEMENT		TYPE II BARRICADES OR DRUMS WITH MONO-DIRECTIONAL STEADY BURNING LIGHTS UNLESS OTHERWISE NOTED
	TEMPORARY HOT-MIX ASPHALT RAMP		VERTICAL PANEL
	SIGN		TYPE III BARRICADES

