

TYPICAL APPLICATION  
STAGE 1  
STA 37+85.10 TO STA 73+81.75

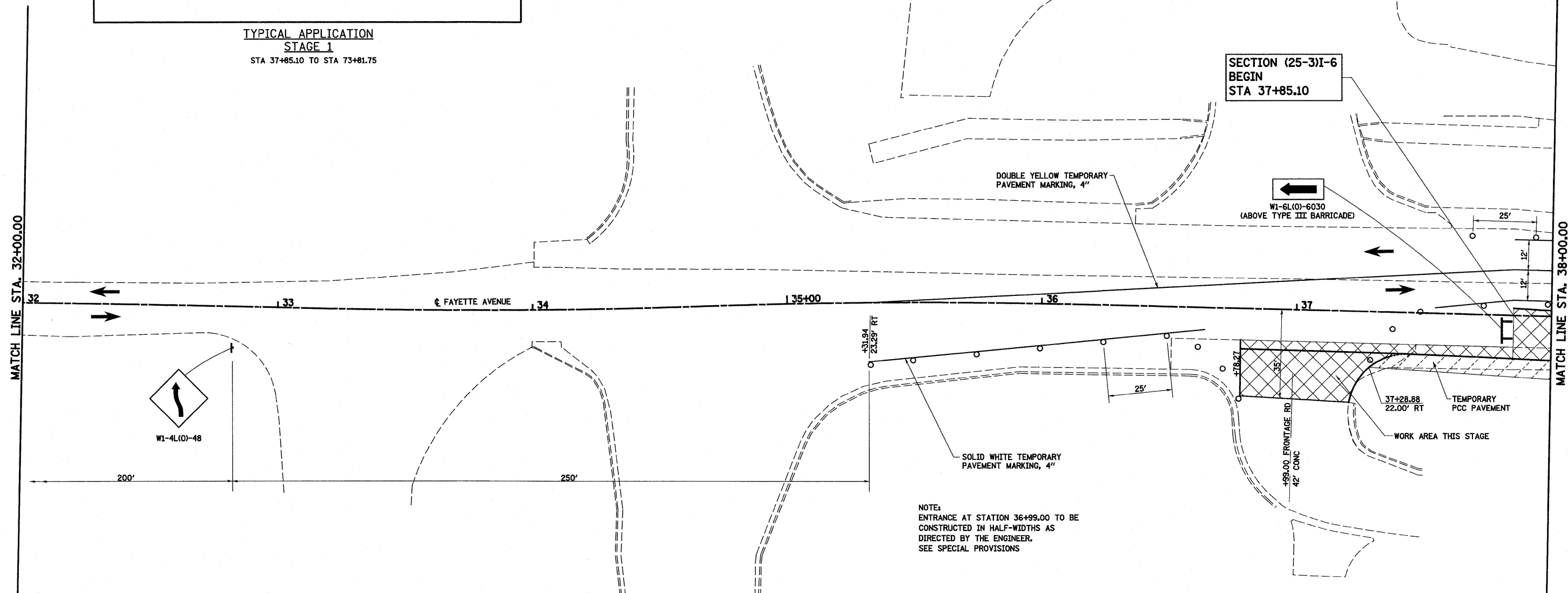

NOTE:  
ENTRANCE AT STATION 36+99.00 TO BE  
CONSTRUCTED IN HALF-WIDTHS AS  
DIRECTED BY THE ENGINEER.  
SEE SPECIAL PROVISIONS

LEGEND

- STAGE 1 POST I-57/70 CLOSURE
- WORK AREA THIS STAGE
- TEMPORARY PCC PAVEMENT
- TEMPORARY HOT-MIX ASPHALT RAMP
- SIGN
- DIRECTION OF TRAFFIC
- TYPE II BARRICADES OR DRUMS WITH MONO-DIRECTIONAL STEADY BURNING LIGHTS UNLESS OTHERWISE NOTED
- VERTICAL PANEL
- TYPE III BARRICADES

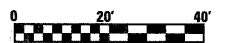

FILE NAME =	USER NAME = paul	DESIGNED - JWS	REVISED -	<b>STATE OF ILLINOIS DEPARTMENT OF TRANSPORTATION</b>	<b>MAINTENANCE OF TRAFFIC, STAGE 1, FAYETTE AVENUE</b>	F.A.I. RTE.	SECTION	COUNTY	TOTAL SHEETS	SHEET NO.		
S:\Projects\1403-00072-57-70\Drawn\Fayette\Main\Fay_S1.dwg						57/70	(25-3)I-6	EFFINGHAM	839	93		
PLOT SCALE = 40,0000' / IN.						CONTRACT NO. 74293						
PLOT DATE = 6/28/2018						DATE - 11-16-07				ILLINOIS FED. AID PROJECT		
				SCALE: 1"=20'		SHEET NO. 3 OF 21 SHEETS		STA. 32+00.00 TO STA. 38+00.00				