

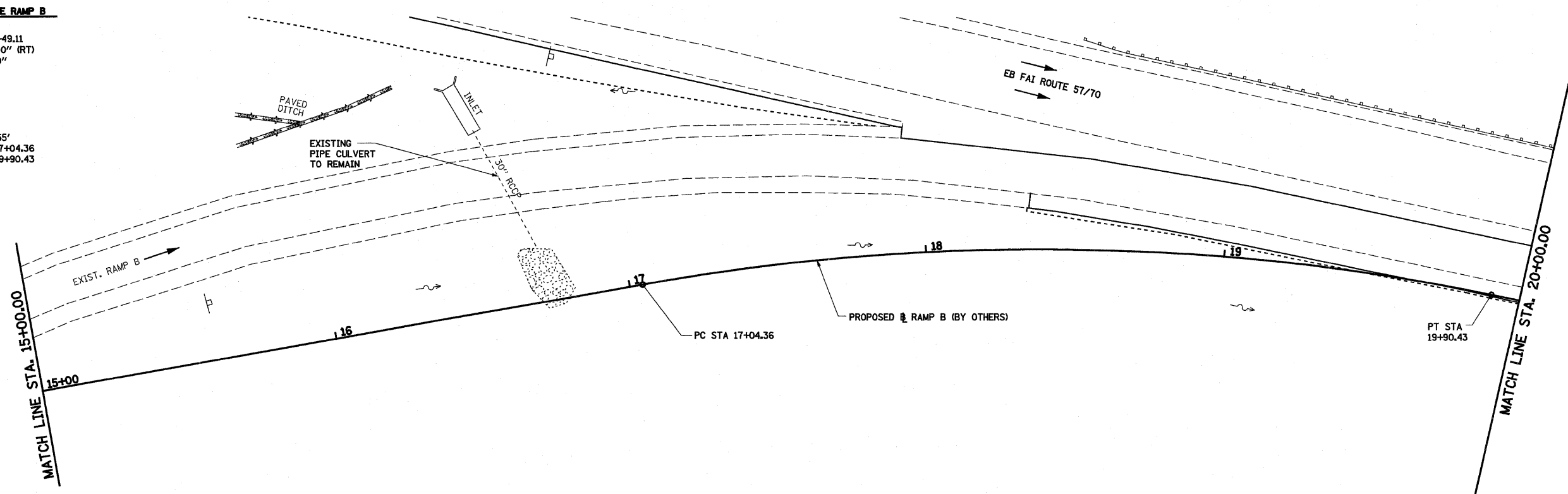

**PROP. FAYETTE RAMP B  
CURVE E**  
 PI STA. = 18+49.11  
 $\Delta = 21^\circ 34' 00''$  (RT)  
 $D = 7^\circ 32' 20''$   
 $R = 760.00'$   
 $T = 144.75'$   
 $L = 286.07'$   
 $E = 13.66'$   
 $e = 8.00\%$   
 $T.R. = 48'$   
 $S.E. RUN = 255'$   
 $P.C. STA. = 17+04.36$   
 $P.T. STA. = 19+90.43$



PLAN	SURVEYED	DATE
	NOTED	
	PLOTTED	
	CHECKED	
	BY	
	NO.	
	FILE NAME	

**FOR INFORMATION ONLY**

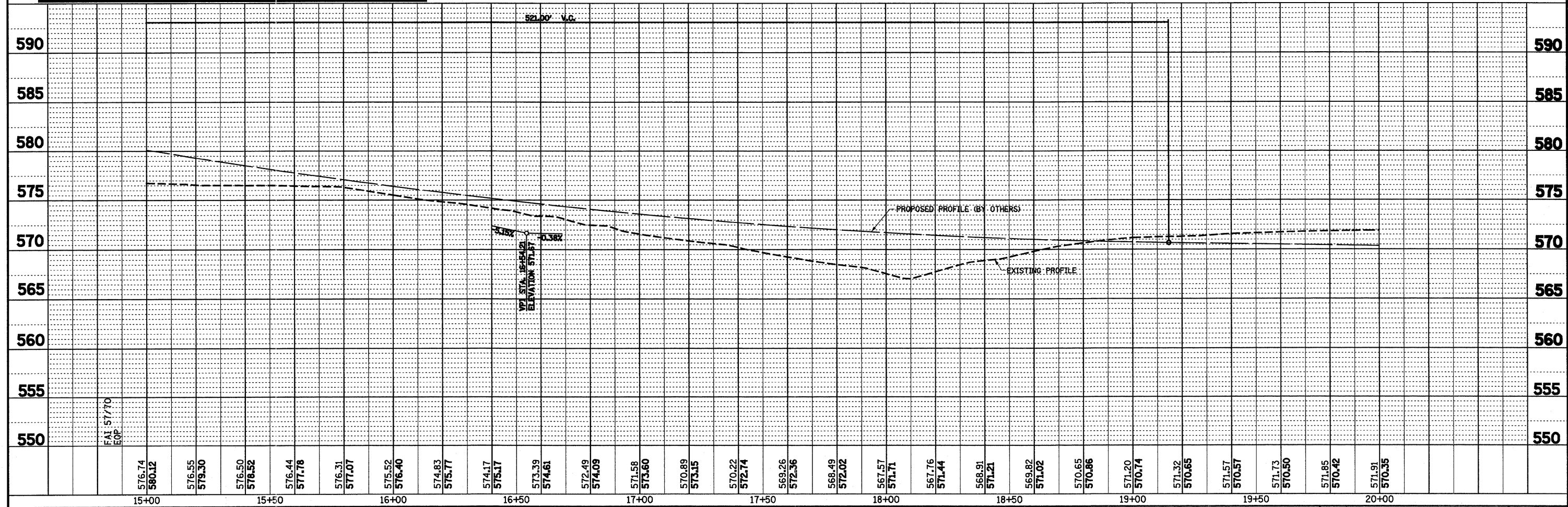
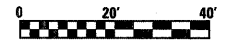

PROFILE	SURVEYED	DATE
	NOTED	
	PLOTTED	
	CHECKED	
	BY	
	NO.	
	FILE NAME	

FILE NAME =	USER NAME = paul	DESIGNED - JWS	REVISED -	<b>STATE OF ILLINOIS DEPARTMENT OF TRANSPORTATION</b>	<b>DRAINAGE PLAN AND PROFILE, RAMP B, FAYETTE AVENUE</b>			F.A.I. RTE. 57/70	SECTION (25-3)I-6	COUNTY EFFINGHAM	TOTAL SHEETS 839	SHEET NO. 175
Plot Scale = 40,000 / IN.	Plot Date = 6/24/2010	DRAWN - PDB	REVISED -		SCALE: 1"=20'	SHEET NO. 6 OF 12 SHEETS	STA. 15+00.00 TO STA. 20+00.00	CONTRACT NO. 74293				
		CHECKED - BRM	REVISED -		FED. ROAD DIST. NO. ILLINOIS FED. AID PROJECT							
		DATE - 11-16-07	REVISED -									