

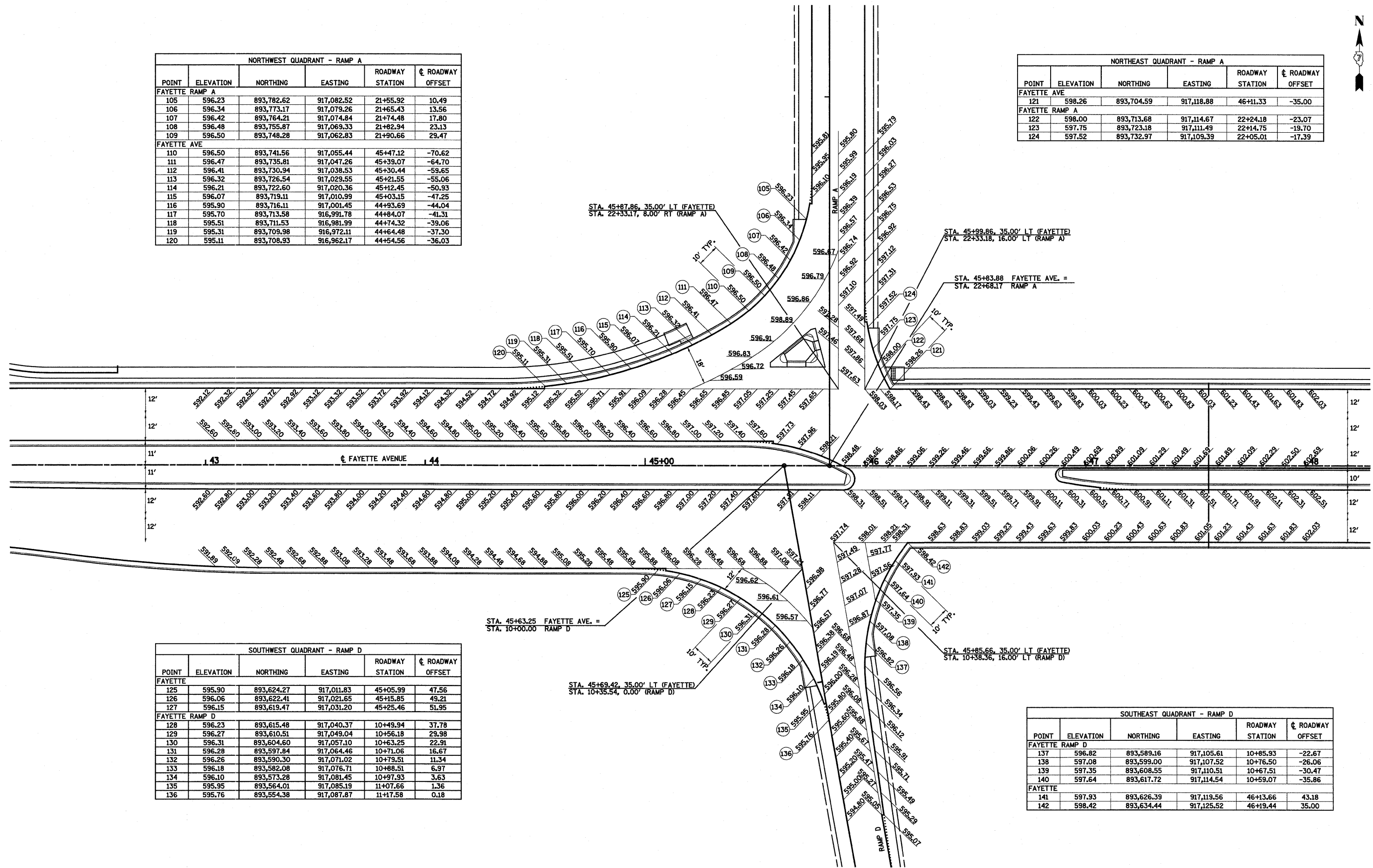

NORTHWEST QUADRANT - RAMP A					
POINT	ELEVATION	NORTHING	EASTING	ROADWAY STATION	☐ ROADWAY OFFSET
FAYETTE RAMP A					
105	596.23	893,782.62	917,082.52	21+55.92	10.49
106	596.34	893,773.17	917,079.26	21+65.43	13.56
107	596.42	893,764.21	917,074.84	21+74.48	17.80
108	596.48	893,755.87	917,069.33	21+82.94	23.13
109	596.50	893,748.28	917,062.83	21+90.66	29.47
FAYETTE AVE					
110	596.50	893,741.56	917,055.44	45+47.12	-70.62
111	596.47	893,735.81	917,047.26	45+39.07	-64.70
112	596.41	893,730.94	917,038.53	45+30.44	-59.65
113	596.32	893,726.54	917,029.55	45+21.55	-55.06
114	596.21	893,722.60	917,020.36	45+12.45	-50.93
115	596.07	893,719.11	917,010.99	45+03.15	-47.25
116	595.90	893,716.11	917,001.45	44+93.69	-44.04
117	595.70	893,713.58	916,991.78	44+84.07	-41.31
118	595.51	893,711.53	916,981.99	44+74.32	-39.06
119	595.31	893,709.98	916,972.11	44+64.48	-37.30
120	595.11	893,708.93	916,962.17	44+54.56	-36.03

NORTHEAST QUADRANT - RAMP A					
POINT	ELEVATION	NORTHING	EASTING	ROADWAY STATION	☐ ROADWAY OFFSET
FAYETTE AVE					
121	598.26	893,704.59	917,118.88	46+11.33	-35.00
FAYETTE RAMP A					
122	598.00	893,713.68	917,114.67	22+24.18	-23.07
123	597.75	893,723.18	917,111.49	22+14.75	-19.70
124	597.52	893,732.97	917,109.39	22+05.01	-17.39



SOUTHWEST QUADRANT - RAMP D					
POINT	ELEVATION	NORTHING	EASTING	ROADWAY STATION	☐ ROADWAY OFFSET
FAYETTE					
125	595.90	893,624.27	917,011.83	45+05.99	47.56
126	596.06	893,622.41	917,021.65	45+15.85	49.21
127	596.15	893,619.47	917,031.20	45+25.46	51.95
FAYETTE RAMP D					
128	596.23	893,615.48	917,040.37	10+49.94	37.78
129	596.27	893,610.51	917,049.04	10+56.18	29.98
130	596.31	893,604.60	917,057.10	10+63.25	22.91
131	596.28	893,597.84	917,064.46	10+71.06	16.67
132	596.26	893,590.30	917,071.02	10+79.51	11.34
133	596.18	893,582.08	917,076.71	10+88.51	6.97
134	596.10	893,573.28	917,081.45	10+97.93	3.63
135	595.95	893,564.01	917,085.19	11+07.66	1.36
136	595.76	893,554.38	917,087.87	11+17.58	0.18

SOUTHEAST QUADRANT - RAMP D					
POINT	ELEVATION	NORTHING	EASTING	ROADWAY STATION	☐ ROADWAY OFFSET
FAYETTE RAMP D					
137	596.82	893,589.16	917,105.61	10+85.93	-22.67
138	597.08	893,599.00	917,107.52	10+76.50	-26.06
139	597.35	893,608.55	917,110.51	10+67.51	-30.47
140	597.64	893,617.72	917,114.54	10+59.07	-35.86
FAYETTE					
141	597.93	893,626.39	917,119.56	46+13.66	43.18
142	598.42	893,634.44	917,125.52	46+19.44	35.00

FILE NAME = S:\Projects\403-00072-57-70\pav\pav\pav\pav.dgn

USER NAME = paul  
 PLOT SCALE = 40.0000' / IN.  
 PLOT DATE = 6/24/2010

DESIGNED - JWS  
 DRAWN - PDB  
 CHECKED - BRM  
 DATE - 11-05-08

REVISED -  
 REVISED -  
 REVISED -  
 REVISED -

**STATE OF ILLINOIS  
 DEPARTMENT OF TRANSPORTATION**

**PAVEMENT ELEVATION DETAIL, RAMPS A AND D, FAYETTE AVENUE**

SCALE: 1"=20'      SHEET NO. 1 OF 3 SHEETS      STA. 43+00.00 TO STA. 48+00.00

F.A.I. RTE.	SECTION	COUNTY	TOTAL SHEETS	SHEET NO.
57/70	(25-3)I-6	EFFINGHAM	839	190
CONTRACT NO. 74293				
FED. ROAD DIST. NO.    ILLINOIS FED. AID PROJECT				