

See Sheet 2 of 3-Fayette Avenue Interchange-Ramps B & C Signal Layout

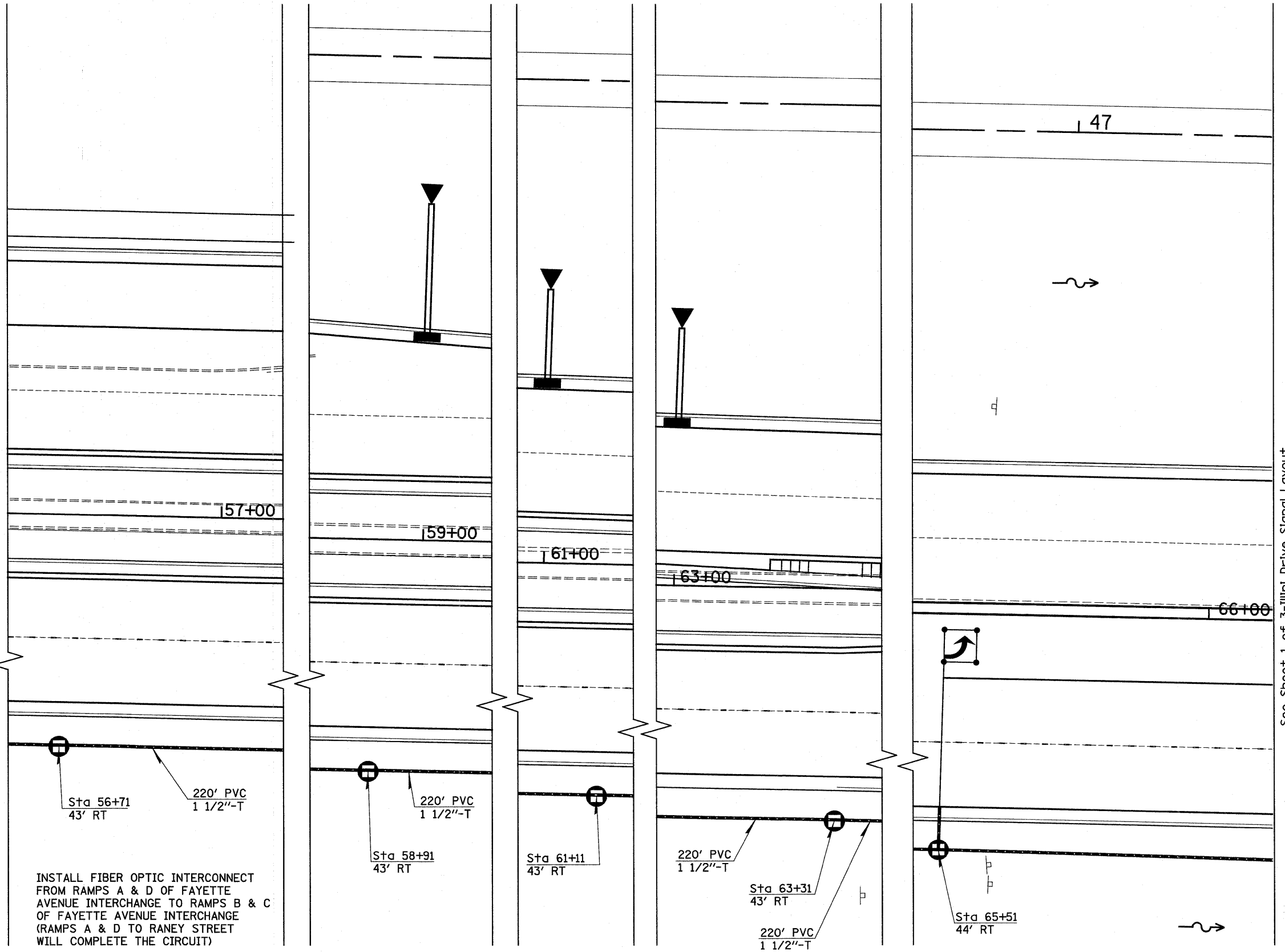
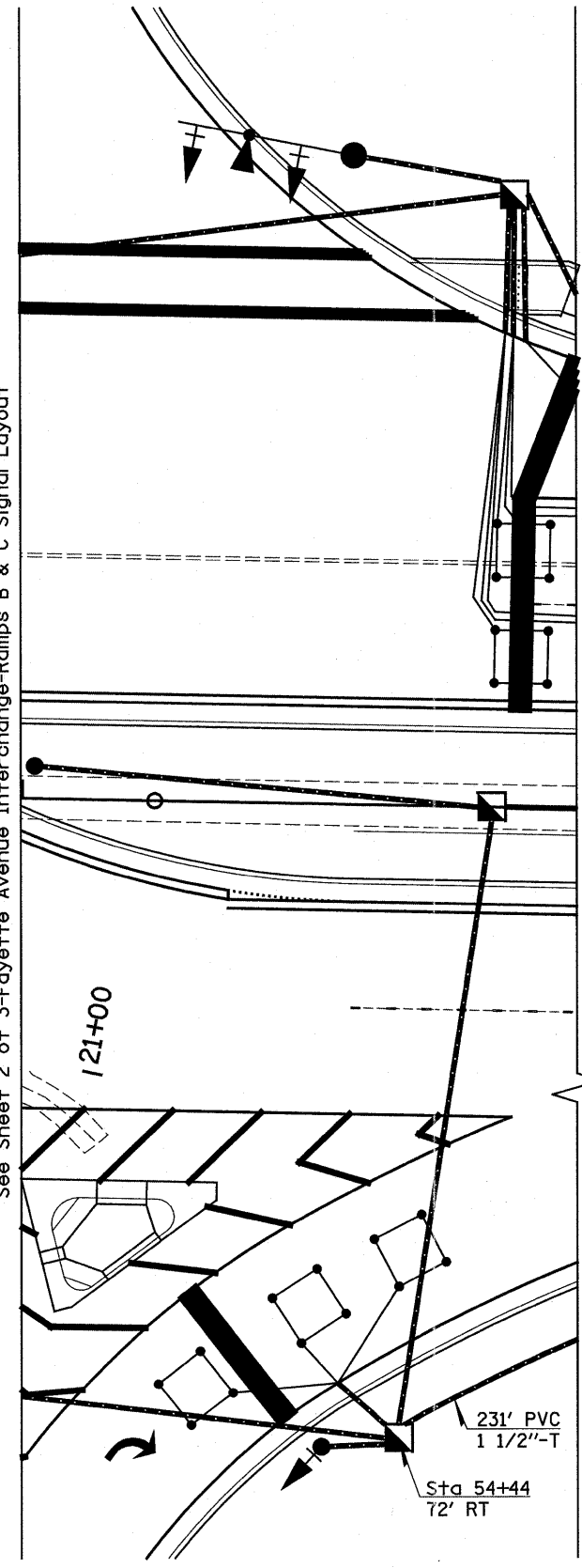

INSTALL FIBER OPTIC INTERCONNECT FROM RAMPS A & D OF FAYETTE AVENUE INTERCHANGE TO RAMPS B & C OF FAYETTE AVENUE INTERCHANGE (RAMPS A & D TO RANEY STREET WILL COMPLETE THE CIRCUIT)

See Sheet 1 of 3-Illini Drive Signal Layout

FILE NAME = #FILE#	USER NAME = paul	DESIGNED -	REVISED -	STATE OF ILLINOIS DEPARTMENT OF TRANSPORTATION	RAMPS B & C TO ILLINI DRIVE FIBER OPTICS INTERCONNECT			F.A.I. RTE.	SECTION	COUNTY	TOTAL SHEETS	SHEET NO.
	PLOT SCALE = 200.0000' / IN.	DRAWN -	REVISED -					70	(25-3)I-6 & (25-3)B-2)B	EFFINGHAM	839	260
	PLOT DATE = 6/24/2010	CHECKED -	REVISED -		SCALE:	SHEET NO. OF SHEETS	STA.	TO STA.	CONTRACT NO. 74293			
		DATE -	REVISED -						ILLINOIS FED. AID PROJECT			