

STATE OF ILLINOIS
DEPARTMENT OF TRANSPORTATION

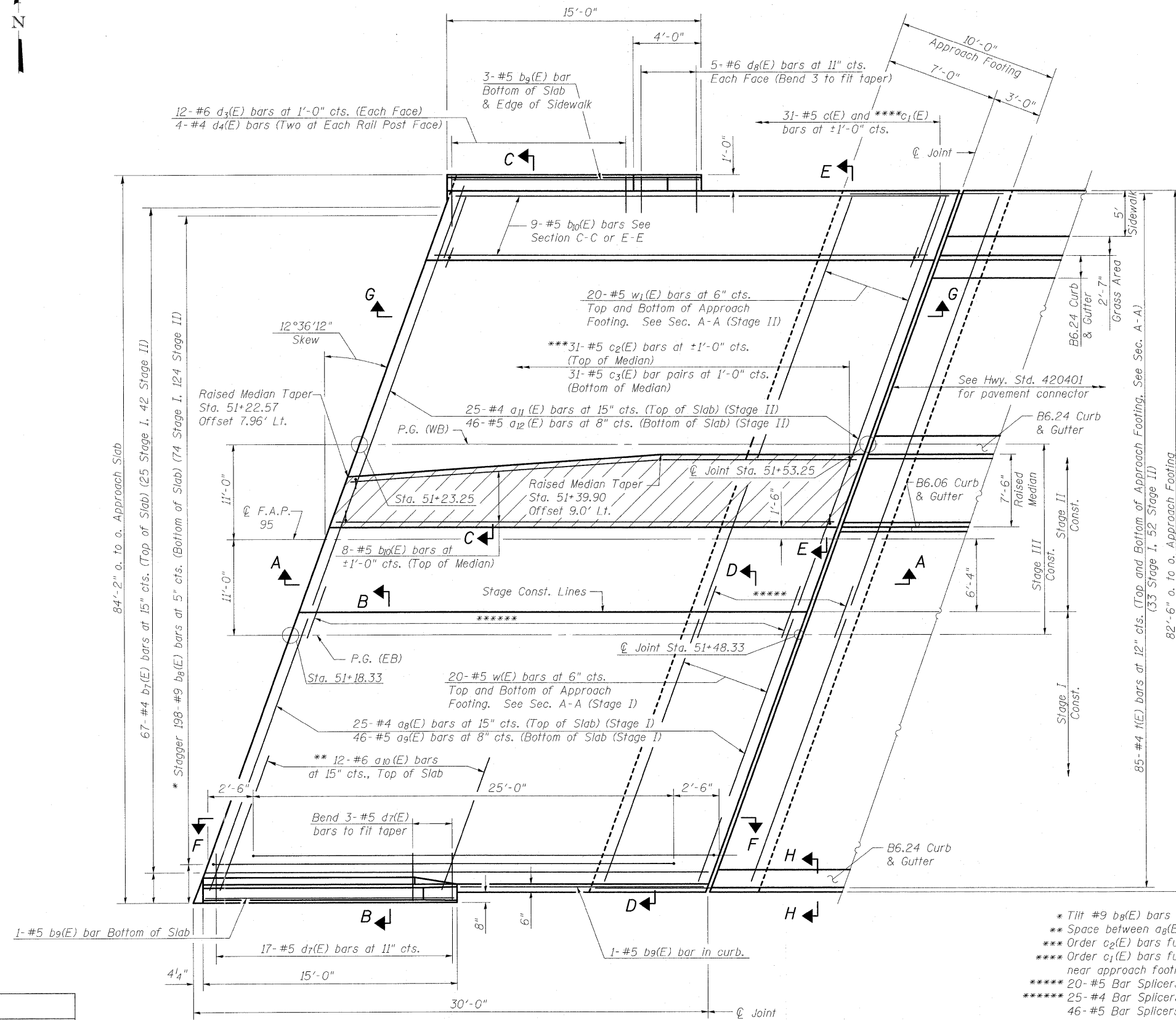

Notes:
See sheet 25 of 38 for Sections A-A, B-B, C-C, D-D and E-E, and Views F-F and G-G.
 $a_8(E)$, $a_9(E)$, $a_{11}(E)$ and $a_{12}(E)$ bar spacings measured along C Rdwy.
Bend $b_{10}(E)$ bars in field to fit median taper.
See sheet 23 of 38 for View H-H.
Stage III Construction shall consist of installation of the Superimposed Median.

Indicates Superimposed Raised Median
See sheet 16 of 38 for Raised Median reinforcement.

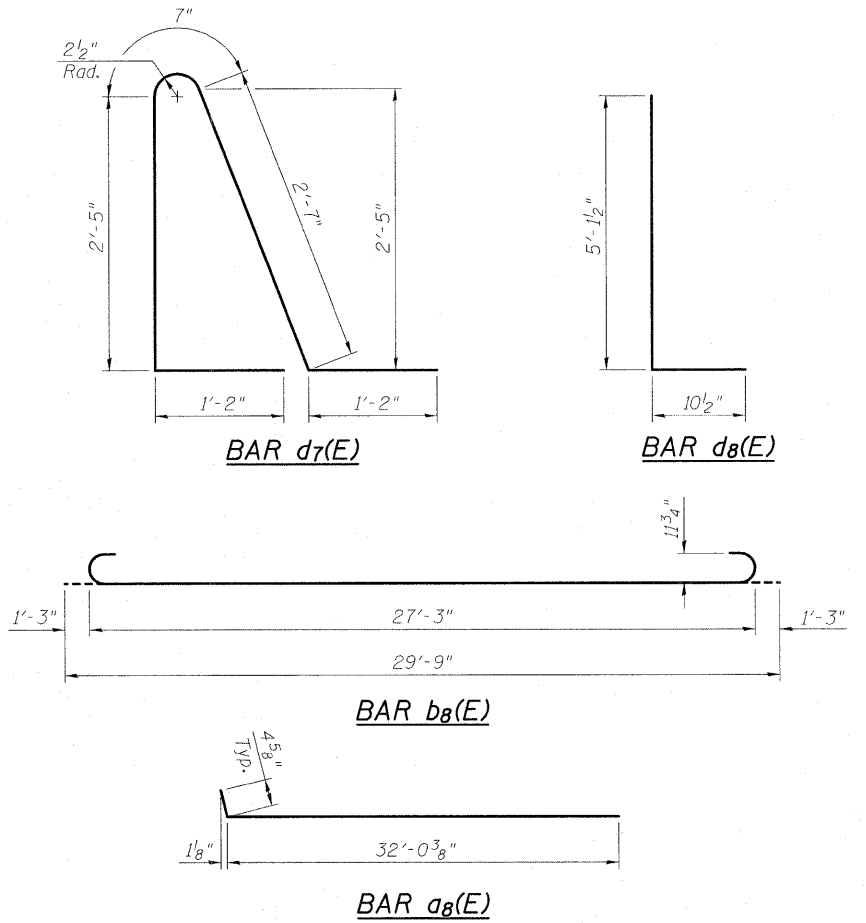

- * Tilt #9 $b_8(E)$ bars as required to maintain clearance.
- ** Space between $a_8(E)$ bars.
- *** Order $c_2(E)$ bars full length. Cut to fit in median.
- **** Order $c_1(E)$ bars full length. Cut to fit in sidewalk near approach footing.
- ***** 20-#5 Bar Splicers for $w(E)$ bars Top & Bottom
- ***** 25-#4 Bar Splicers for $a_8(E)$ bars Top of Slab and 46-#5 Bar Splicers for $a_9(E)$ bars Bottom of Slab

DESIGNED	A.C.S.
CHECKED	B.B.
DRAWN	W.J.S.
CHECKED	C.J.F.

PLAN EAST APPROACH



BERNARDIN
LOCHMUELLER &
ASSOCIATES, INC.

3 Oak Drive
Maryville, IL 62902-9688
Local (618) 288-4666
Fax 618-288-4666

SHEET NO. 24 38 SHEETS	F.A.I. RTE. 57/70	SECTION (25-3HB-2)B	COUNTY EFFINGHAM	TOTAL SHEETS 839	SHEET NO. 353
	SN 025-0106		CONTRACT NO. 74293		
FED. ROAD DIST. NO. 7 ILLINOIS FED. AID PROJECT					

EAST BRIDGE APPROACH
SLAB DETAILS
STRUCTURE NO. 025-0106