

DATE _____
 BY _____
 SURVEYED _____
 PLOTTED _____
 NOTE BOOK _____
 AREAS CHECKED _____

DATE _____
 BY _____
 SURVEYED _____
 PLOTTED _____
 NOTE BOOK _____
 AREAS CHECKED _____

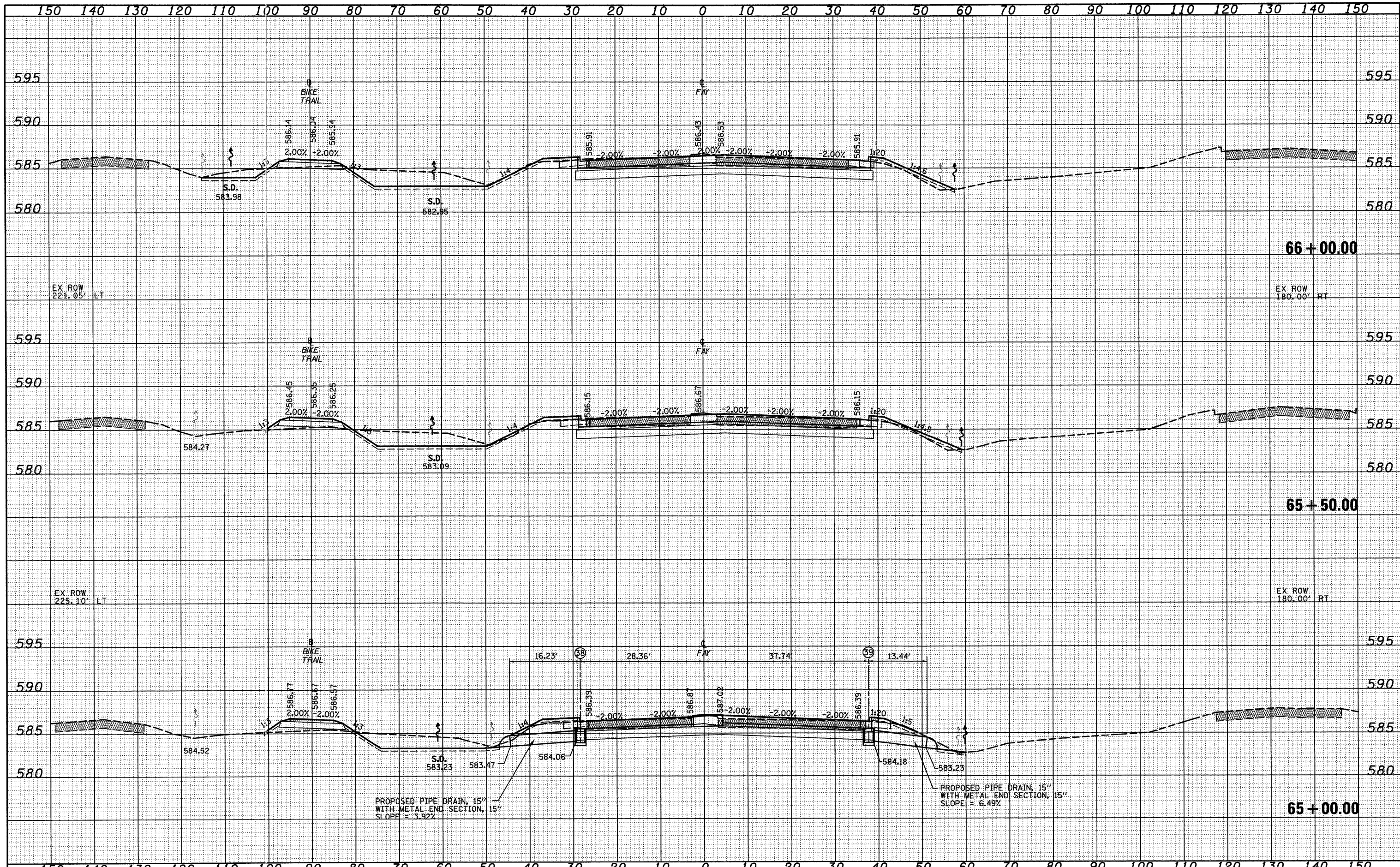

FILE NAME =	USER NAME = lnda	DESIGNED - JWS	REVISED -	STATE OF ILLINOIS DEPARTMENT OF TRANSPORTATION	CROSS SECTIONS, FAYETTE AVE.	SCALE: 1"=10' SHEET NO. 33 OF 43 SHEETS STA. 65+00.00 TO STA. 66+00.00	SECTION (25-3)I-6	COUNTY EFFINGHAM	TOTAL SHEETS 839	SHEET NO. 402
50\proj\65\11072-53-70.dgn\11072-53-70.dgn	PLOT SCALE = 20,0000' / IN.	DRAWN - LEC	REVISED -							
	PLOT DATE = 6/24/2010	CHECKED - BRM	REVISED -							
	DATE - 11-05-07	DATE - 11-05-07	REVISED -							
						FED. ROAD DIST. NO. ILLINOIS FED. AID PROJECT		CONTRACT NO. 74293		