

DATE	
BY	
FINAL SURVEY	SURVEY
NOTE BOOK	NOTE BOOK
NO.	
TEMPLATE	TEMPLATE
AREAS CHECKED	AREAS CHECKED

DATE	
BY	
ORIGINAL SURVEY	SURVEY
NOTE BOOK	NOTE BOOK
NO.	
TEMPLATE	TEMPLATE
AREAS CHECKED	AREAS CHECKED

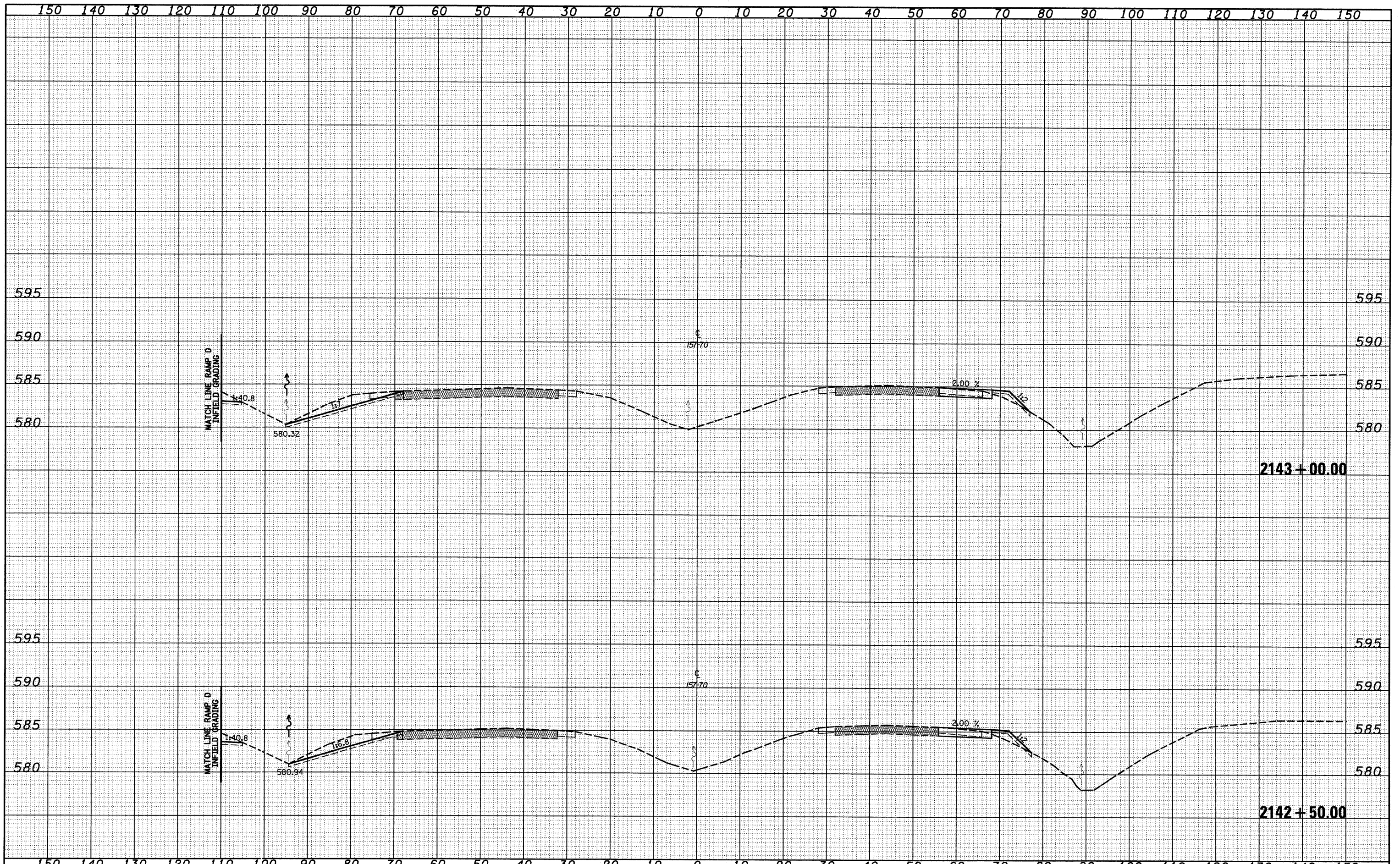

FILE NAME =	USER NAME = lmdc	DESIGNED - JWS	REVISED -	STATE OF ILLINOIS DEPARTMENT OF TRANSPORTATION	CROSS SECTIONS, FAYETTE AVE. - 157/70	F.A. RTE.	SECTION	COUNTY	TOTAL SHEETS	SHEET NO.	
57/70	(25-3)I-6	EFFINGHAM	839			421					
SCALE: 1"=10'						SHEET NO. 9 OF 33 SHEETS	STA. 2142+50.00 TO STA. 2143+00.00	FED. ROAD DIST. NO.	ILLINOIS FED. AID PROJECT	CONTRACT NO. 74293	
PLOT SCALE = 20,0000' / IN.		CHECKED - BRM	REVISED -								
PLOT DATE = 6/25/2010		DATE - 11-05-07	REVISED -								