

EXISTING STRUCTURE: S.N. 060-0195, originally constructed in 1973 as F.A.I. Route 55 Section 60-3HB at Station 410+18.00, using 48" welded plate girders with 7 1/2" concrete deck, 3 spans, 342'-8" back-back approach bents, 32'-0" out-out width, vaulted abutments on concrete piles, multi-column piers with footings on timber piles.

A traffic detour will be used (staged construction is not required).

No Salvage.

STATE OF ILLINOIS
DEPARTMENT OF TRANSPORTATION

INDEX OF SHEETS

- 1 Gen Plan, Gen Notes, Bill of Mat'l
- 2 Deck Repairs
- 3 Parapet Extension
- 4-5 Expansion Joint Repairs
- 6 Preformed Joint Strip Seal
- 7-8 Bearings
- 9-10 Abutments

GENERAL NOTES

Fasteners shall be AASHTO M164 Type 1, mechanically galvanized bolts. Bolts 7/8 in. ϕ , holes 15/16 in. ϕ , unless otherwise noted.
No field welding is permitted except as specified in the contract documents.
Reinforcement bars shall conform to the requirements of ASTM A 706 Gr 60. See Special Provisions.
Reinforcement bars designated (E) shall be epoxy coated.
Existing reinforcement bars extending into the removal area shall be cleaned, straightened and incorporated into the new construction. Any reinforcement bars that are damaged during concrete removal shall be replaced with an approved bar splicer or anchorage system. Cost included with Concrete Removal.
Where shown on the plans, reinforcement bars shall be epoxy grouted into existing concrete according to Section 584 of the Standard Specifications. Cost included with Reinforcement Bars, Epoxy Coated.
Prior to pouring the new concrete deck, all heavy or loose rust, loose mill scale, and other loose or potentially detrimental foreign material shall be removed from the surfaces in contact with concrete. Tightly adhered paint may remain unless otherwise noted. Removal shall be accomplished by methods that will not damage the steel and the cost will be included in the pay item covering removal of the existing concrete.
The existing structural steel coating contains lead. The Contractor shall take appropriate precautions to deal with the presence of lead on this project.
Existing structural steel that will be in contact with new structural steel shall be cleaned and painted prior to erection as required by the Special Provision "Cleaning and Painting Contact Surface Areas of Existing Steel Structures".
Protective Shield shall be provided for the full width of the bridge deck over the roadway below from edge of shoulder to edge of shoulder.
Protective Coat shall be applied to the surfaces of the deck and parapets, including the wings.
Joint openings shall be adjusted according to Article 520.04 of the Standard Specifications when the deck is poured at an ambient temperature other than 50° F.
Plan dimensions and details relative to existing plans are subject to routine variations. The Contractor shall field verify existing dimensions and details affecting new construction and make necessary approved adjustments prior to construction or ordering of materials. Such variations shall not be cause for additional compensation for a change in scope of the work, however, the Contractor will be paid for the quantity actually furnished based upon the unit price bid for the work.

TOTAL BILL OF MATERIAL

ITEM	UNIT	SUPER	SUB	TOTAL
Concrete Removal	Cu Yd	7.0	--	7.0
Bridge Rail Removal	Foot	675	--	675
Protective Shield	Sq Yd	426	--	426
Concrete Structures	Cu Yd	--	3.8	3.8
Concrete Superstructure	Cu Yd	23.9	--	23.9
Bridge Deck Grooving	Sq Yd	1006	--	1006
Protective Coat	Sq Yd	1399	--	1399
Furnishing And Erecting Structural Steel	Pound	--	1490	1490
Jack And Remove Existing Bearings	Each	--	10	10
Cleaning And Painting Steel Bridge No. 1	L Sum	1	--	1
Cont. & Disp. of Lead Paint Clean. Resid. No.1	L Sum	1	--	1
Reinforcement Bars, Epoxy Coated	Pound	4850	1100	5950
Preformed Joint Strip Seal	Foot	62	--	62
Elastomeric Bearing Assembly, Type I	Each	--	5	5
Elastomeric Bearing Assembly, Type II	Each	--	5	5
Anchor Bolts, 1"	Each	--	20	20
Concrete Sealer	Sq Ft	--	150	150
Structural Repair Of Concrete (Depth = < 5")	Sq Ft	--	95	95
Bridge Deck Microsilica Concrete Overlay 2 1/4"	Sq Yd	1062	--	1062
Bridge Deck Hydro-Scarification 1/2"	Sq Yd	1062	--	1062
Deck Slab Repair (Full Depth, Type II)	Sq Yd	14	--	14

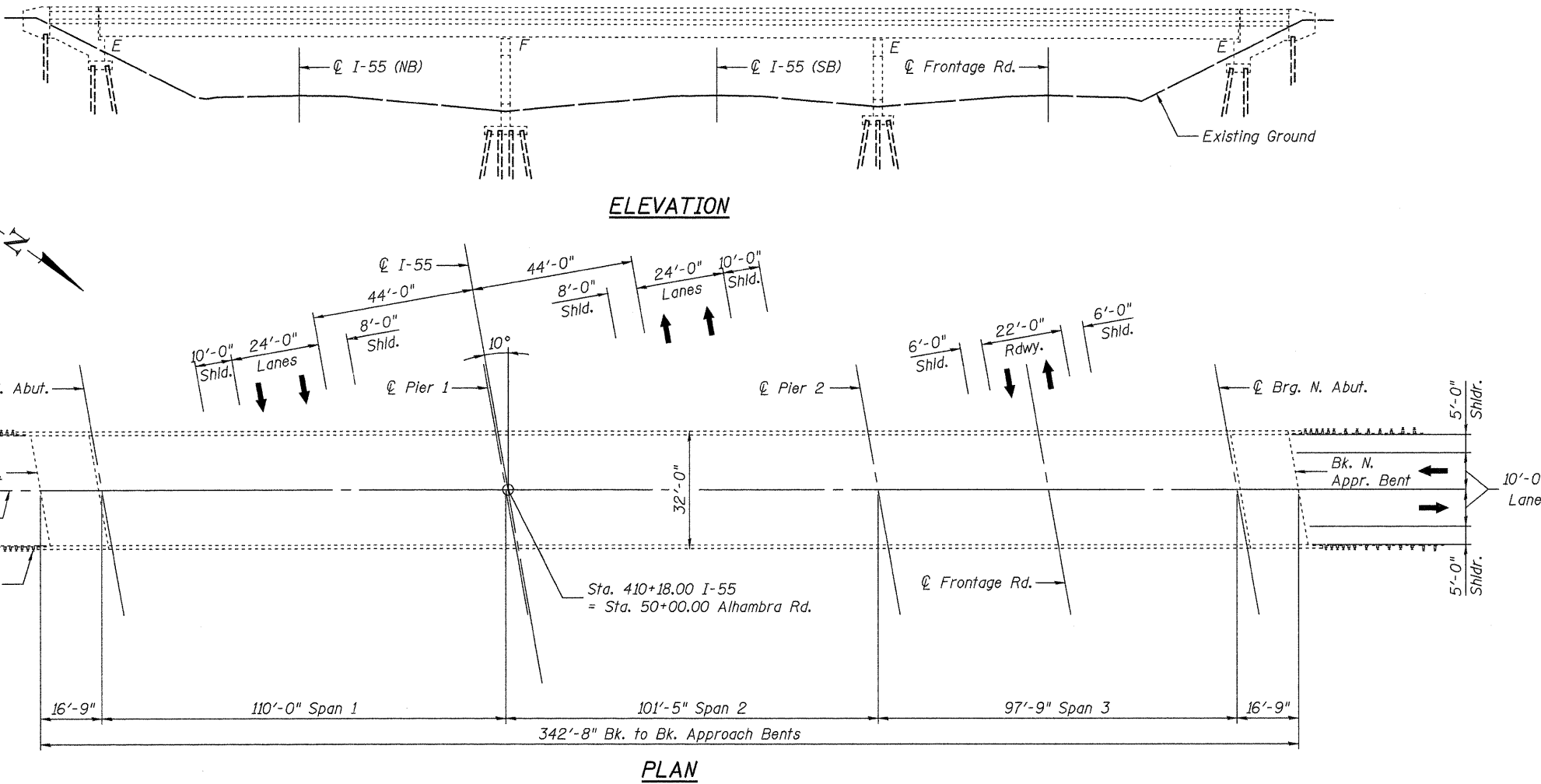

GENERAL PLAN & ELEVATION
ALHAMBRA ROAD OVER I-55
F.A.I. RTE. 55 SECTION 60-3HB
MADISON COUNTY
STATION 410+18.00
STRUCTURE NO. 060-0195

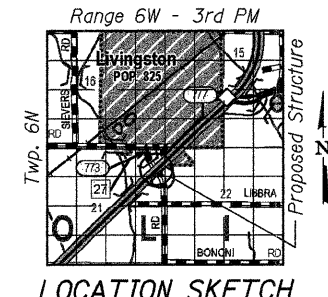

JD Johnson, Depp & Quisenberry
CONSULTING ENGINEERS
Springfield, Illinois

DESIGNED: CMV DRAWN: P. Ray
CHECKED: DCD CHECKED: CMV/DCD

DAVID C. DEPP
CONSULTING ENGINEER
061-006117
LICENSED PROFESSIONAL ENGINEER

Signed: *David Depp*
Date: *6-22-2010*
Lic. Expires: 11-30-2010

SHEET 1 OF 10	F.A.I. RTE.	SECTION	COUNTY	TOTAL SHEETS	SHEET NO.
	55	60-3RS-1, 60-3HB,3HB-1/I	MADISON	123	83
	STA. 410+18.00		CONTRACT NO. 76601		
FED. ROAD DIST. NO.		ILLINOIS FED. AID PROJECT			

FILE: J:\JDC\10195 IL-08V\99 +55 Madison BrIdge Repairs\3-Alhambra Rd\060195-76601-001-gplan.dgn
 USER: DCD
 PRINT DATE: 06/22/2010 22:06:54
 SAVE DATE: 6/22/2010