

STATE OF ILLINOIS  
DEPARTMENT OF TRANSPORTATION

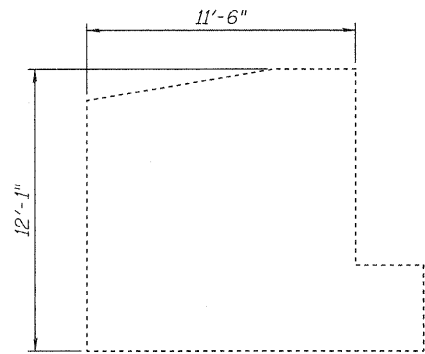

ELEVATION - WEST WING

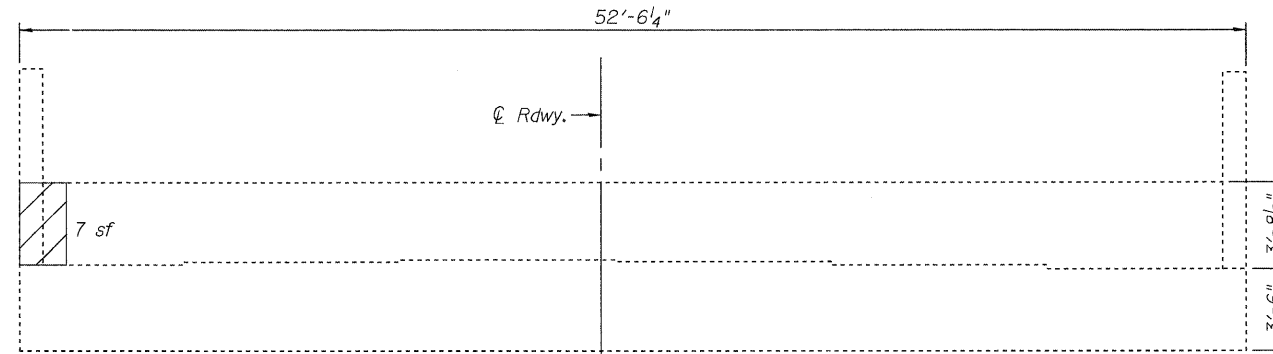

ELEVATION - NORTH ABUT. (NB)

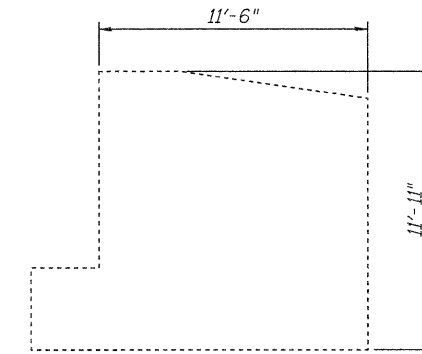

ELEVATION - EAST WING

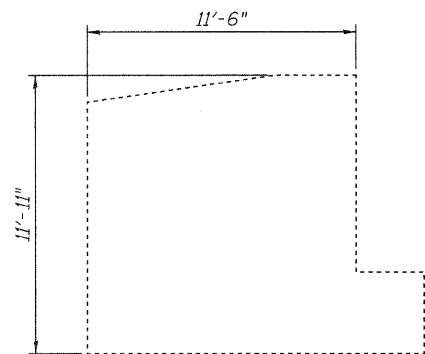

ELEVATION - EAST WING

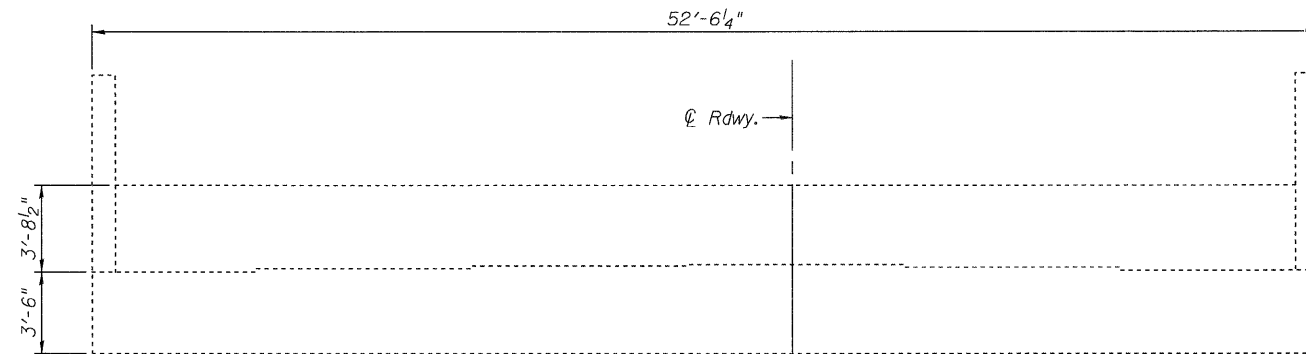

ELEVATION - SOUTH ABUT. (NB)

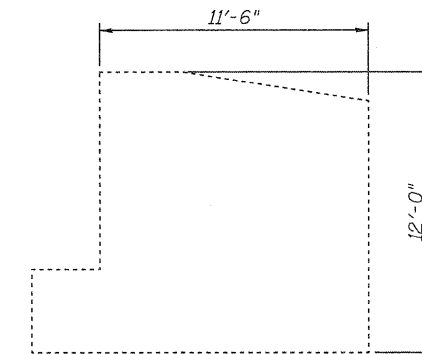

ELEVATION - WEST WING

LEGEND

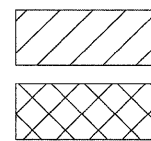

Spalled, Hollow or Unsound Concrete

Spalled Concrete with Exposed Reinf.

Notes:  
Abutment Condition Survey performed 4/15/2010.

Plan quantities assume that all marked areas will be repaired.

Repair areas are estimated, the Engineer shall determine actual repair locations and record them on the As-Built plans.

BILL OF MATERIAL

Item	Unit	Total
Structural Repair of Concrete (Depth = < 5")	Sq. Ft.	7
Concrete Sealer	Sq. Ft.	307

Apply Concrete Sealer to existing beam seat areas (full length of cap).

**JD** Johnson, Depp & Quisenberry  
CONSULTING ENGINEERS  
Springfield, Illinois

DESIGNED: CMV	DRAWN: SJS
CHECKED: DCD	CHECKED: CMV/DCD

ABUTMENTS (NB)  
STRUCTURE NO. 060-0196(SB) & 0197(NB)

F.A.I. RTE.	SECTION	COUNTY	TOTAL SHEETS	SHEET NO.
55	60-3RS-1, 60-(3HB,3HB-1)I	MADISON	123	112
STA. 318+48.55		CONTRACT NO.	76601	
FED. ROAD DIST. NO.		ILLINOIS FED. AID PROJECT		

SHEET 9  
OF 14