

DO NOT DISTURB EXISTING SHOULDER INLETS

PROPOSED GUARDRAIL (MEDIAN)
 STA. 1003+95.00 TO STA. 1004+38.15 (T.B.T. TYPE 6)
 STA. 1004+38.15 TO STA. 1006+88.15 (SPBGR. TYPE A)
 STA. 1006+88.15 TO STA. 1007+38.15 (T.B.T. TYPE 1 SPL. TANG.)

PROPOSED GUARDRAIL
 STA. 1003+47.00 TO STA. 1003+90.15 (T.B.T. TYPE 6)
 STA. 1003+90.15 TO STA. 1012+90.15 (SPBGR. TYPE A)
 STA. 1012+90.15 TO STA. 1013+40.15 (T.B.T. TYPE 1 SPL. TANG.)

RUBBLIZE THE EXISTING P.C.C. PAVEMENT (USING METHOD 1)

REMOVE EXISTING CABLE BARRIER AND 2' OF HMA MOW STRIP.
 PROPOSED HIGH TENSION CABLE MEDIAN BARRIER SYSTEM.
 10' (MIN.) FROM CENTERLINE FAI RTE. 55
 (SEE TYPICAL SECTION)

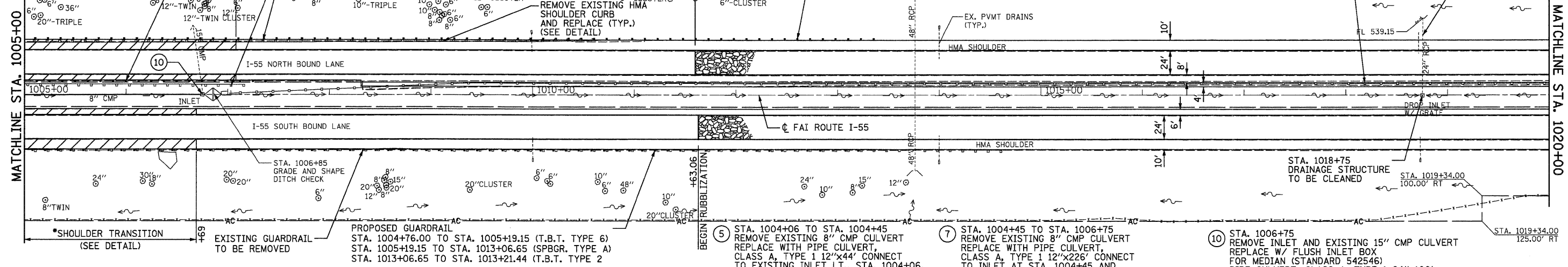

PROPOSED N.B. PROFILE CORRECTION (ELEVATIONS)

760.00' V.C. PROPOSED PROFILE										
571.79	571.55	571.21	570.78	570.24	569.61	568.87	568.04	567.11	566.07	564.94

- 5 STA. 1004+06 TO STA. 1004+45
REMOVE EXISTING 8" CMP CULVERT
REPLACE WITH PIPE CULVERT,
CLASS A, TYPE 1 12"x44' CONNECT
TO EXISTING INLET L., STA. 1004+06,
W/ 1 COLLAR TO INLET AT STA. 1004+45
- 6 STA. 1004+45
REMOVE EXISTING 8" CMP CULVERT
REPLACE WITH PIPE CULVERT,
CLASS A, TYPE 1 12"x14' CONNECT
TO EXISTING INLET W/ 1 COLLAR
AND INLET AT STA. 1004+45
- 7 STA. 1004+45 TO STA. 1006+75
REMOVE EXISTING 8" CMP CULVERT
REPLACE WITH PIPE CULVERT,
CLASS A, TYPE 1 12"x226' CONNECT
TO INLET AT STA. 1004+45 AND
INLET AT STA. 1006+75
- 8 RT., STA. 1004+85
REMOVE EXISTING 15" CMP CULVERT
REPLACE WITH PIPE DRAINS 12" (SPECIAL) x 74'
W/ 1 COLLAR W/ CONCRETE HEADWALL FOR
PIPE DRAINS
(SEE PIPE SECTION)
- 9 STA. 1004+45
CONSTRUCT INLET, TYPE B
TYPE 1 FRAME, CLOSED LID
(SEE PIPE SECTION)
- 10 STA. 1006+75
REMOVE INLET AND EXISTING 15" CMP CULVERT
REPLACE W/ FLUSH INLET BOX
FOR MEDIAN (STANDARD 542546)
PIPE CULVERT, CLASS A, TYPE 1 24"x106',
W/ 2 CONCRETE ELBOWS 24"
(SEE PIPE SECTION)

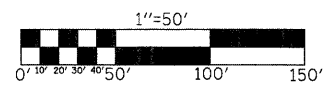

PROPOSED PROFILE CORRECTION (ELEVATIONS)

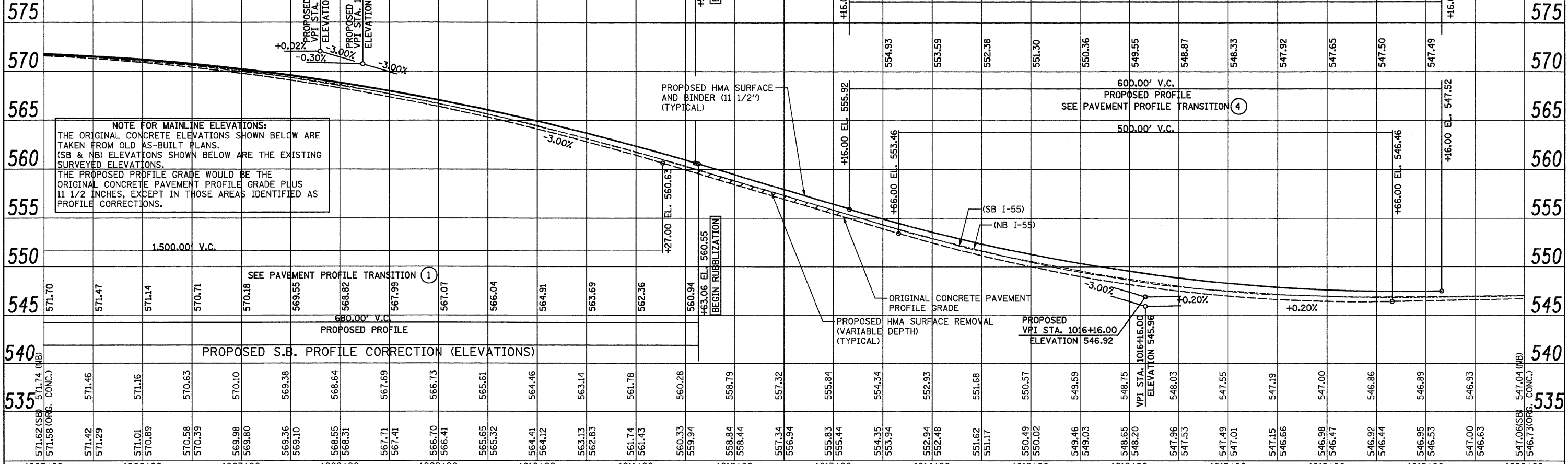

NOTE FOR MAINLINE ELEVATIONS:
 THE ORIGINAL CONCRETE ELEVATIONS SHOWN BELOW ARE
 TAKEN FROM OLD AS-BUILT PLANS.
 (SB & NB) ELEVATIONS SHOWN BELOW ARE THE EXISTING
 SURVEYED ELEVATIONS.
 THE PROPOSED PROFILE GRADE WOULD BE THE
 ORIGINAL CONCRETE PAVEMENT PROFILE GRADE PLUS
 1 1/2 INCHES, EXCEPT IN THOSE AREAS IDENTIFIED AS
 PROFILE CORRECTIONS.

PROPOSED S.B. PROFILE CORRECTION (ELEVATIONS)

PROPOSED S.B. PROFILE CORRECTION (ELEVATIONS)										
571.62	571.42	571.01	570.58	569.98	569.36	568.55	567.71	566.70	565.65	564.41

PLAN	SURVEYED	DATE
NOTE BOOK	ALIGNED	
NO.	CHECKED	
	RT. OF WAY	
	CHECKED	
	NO.	
	FILE NAME	

PROFILE	SURVEYED	DATE
NOTE BOOK	GRADES	
NO.	CHECKED	
	STRUCTURE	
	NOTATIONS	
	CHKD	