 - RUBBLIZE THE EXISTING P.C.C. PAVEMENT (USING METHOD 1)

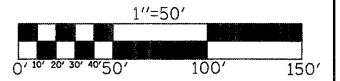

REMOVE EXISTING CABLE BARRIER AND 2' OF HMA MOW STRIP.  
PROPOSED HIGH TENSION CABLE MEDIAN BARRIER SYSTEM.  
10' (MIN.) FROM CENTERLINE FAI RTE. 55  
(SEE TYPICAL SECTION)

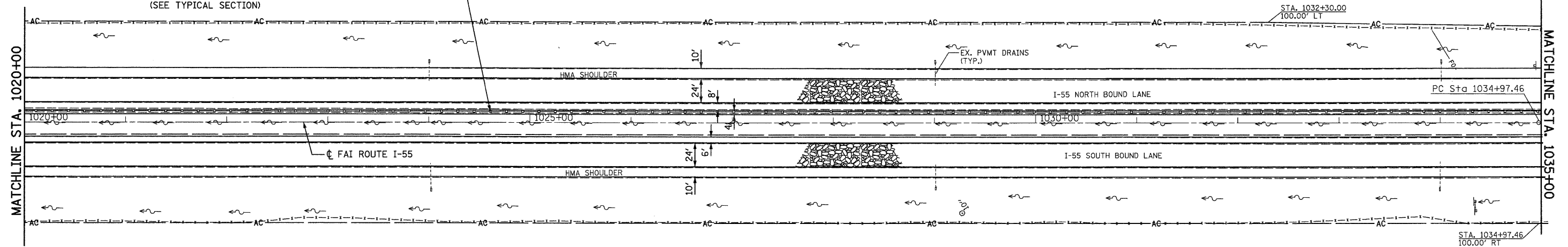

PLAN	SURVEYED	DATE
	RT. OF WAY CHECKED	
	ALIGNMENT CHECKED	
	BY	
	NO. _____	
	FILE NAME	

PROFILE	SURVEYED	DATE
	GRADES CHECKED	
	BY	
	NO. _____	
	STRUCTURE NOTATIONS CHFD	

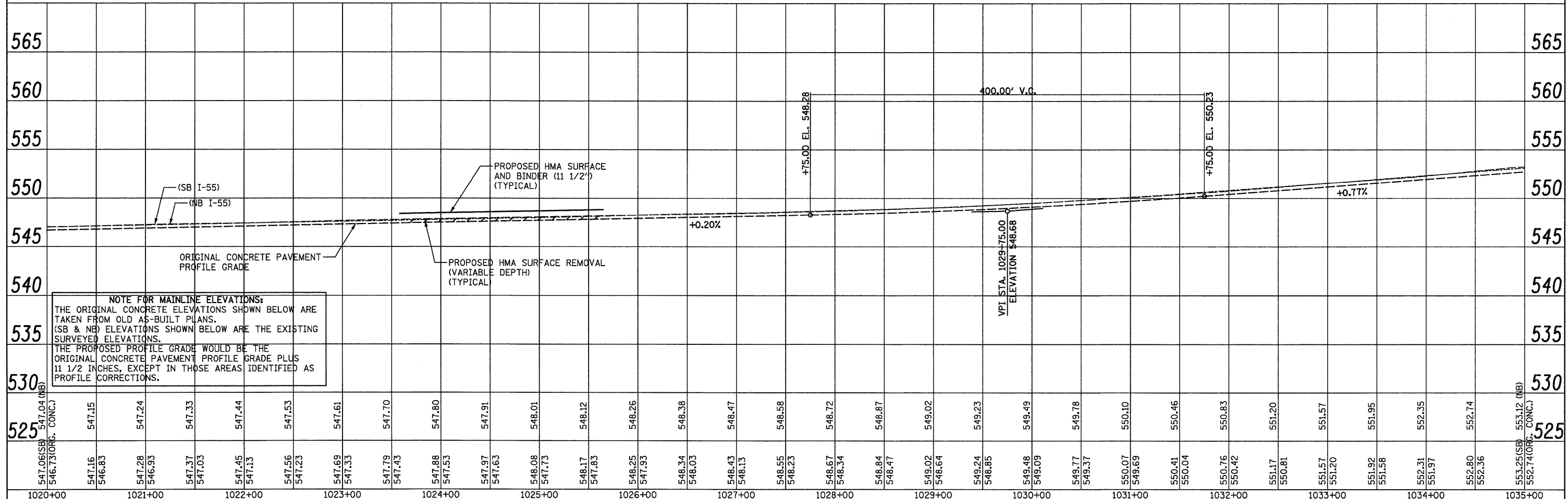

**NOTE FOR MAINLINE ELEVATIONS:**  
THE ORIGINAL CONCRETE ELEVATIONS SHOWN BELOW ARE TAKEN FROM OLD AS-BUILT PLANS.  
(SB & NB) ELEVATIONS SHOWN BELOW ARE THE EXISTING SURVEYED ELEVATIONS.  
THE PROPOSED PROFILE GRADE WOULD BE THE ORIGINAL CONCRETE PAVEMENT PROFILE GRADE PLUS 1 1/2 INCHES, EXCEPT IN THOSE AREAS IDENTIFIED AS PROFILE CORRECTIONS.

525	525	530	535	540	545	550	555	560	565																					
547.06(SB) 546.73(ORG. CONC.)	547.15 546.83	547.24 546.93	547.33 547.03	547.44 547.13	547.53 547.23	547.61 547.33	547.70 547.43	547.80 547.53	547.91 547.63	548.01 547.73	548.12 547.83	548.26 547.93	548.38 548.03	548.47 548.13	548.58 548.23	548.72 548.34	548.87 548.47	549.02 548.64	549.23 548.85	549.49 549.09	549.78 549.37	550.10 549.69	550.46 550.04	550.83 550.42	551.20 550.81	551.57 551.20	551.95 551.58	552.35 551.97	552.74 552.36	553.12 (NB) 552.74 (ORG. CONC.)
1020+00	1021+00	1022+00	1023+00	1024+00	1025+00	1026+00	1027+00	1028+00	1029+00	1030+00	1031+00	1032+00	1033+00	1034+00	1035+00															

STATE OF ILLINOIS  
DEPARTMENT OF TRANSPORTATION

FAI ROUTE 55 (I-55)

FILE NAME = ...oad\0878093-shr-plnpr1.dgn  
**Johnson, Dapp & Quisenberry**  
CONSULTING ENGINEERS  
Springfield, Illinois

USER NAME = SJS	DESIGNED -	REVISED -
DRAWN -	REVISOR -	REVISION -
CHECKED -	DATE -	REVISION -
PLOT SCALE = 50.0000' / IN.		
PLOT DATE = 06/23/2010 15:33:18		

SCALE: 1"=50' SHEET NO. OF SHEETS STA. 1020+00 TO STA. 1035+00

F.A.I. RTE. 55	SECTION 60-1,2)RS-2	COUNTY MADISON	TOTAL SHEETS 156	SHEET NO. 61
CONTRACT NO. 76C93			ILLINOIS FED. AID PROJECT	