

PLAN
 SURVEYED
 NOTE BOOK
 NO.

PROFILE
 SURVEYED
 NOTE BOOK
 NO.

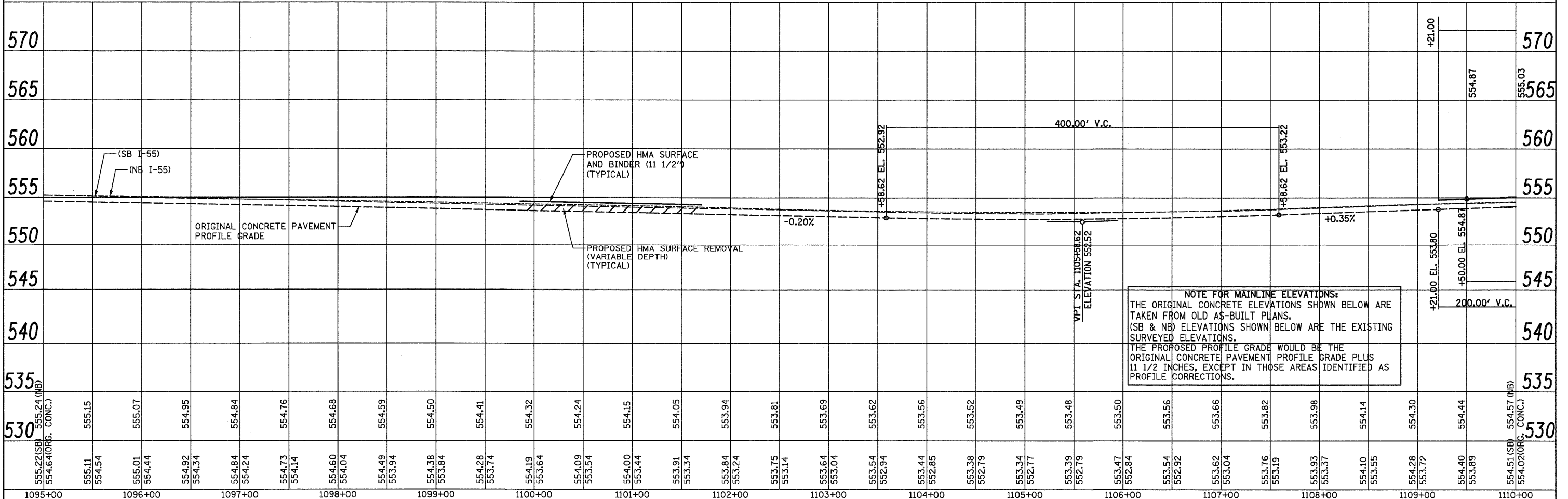
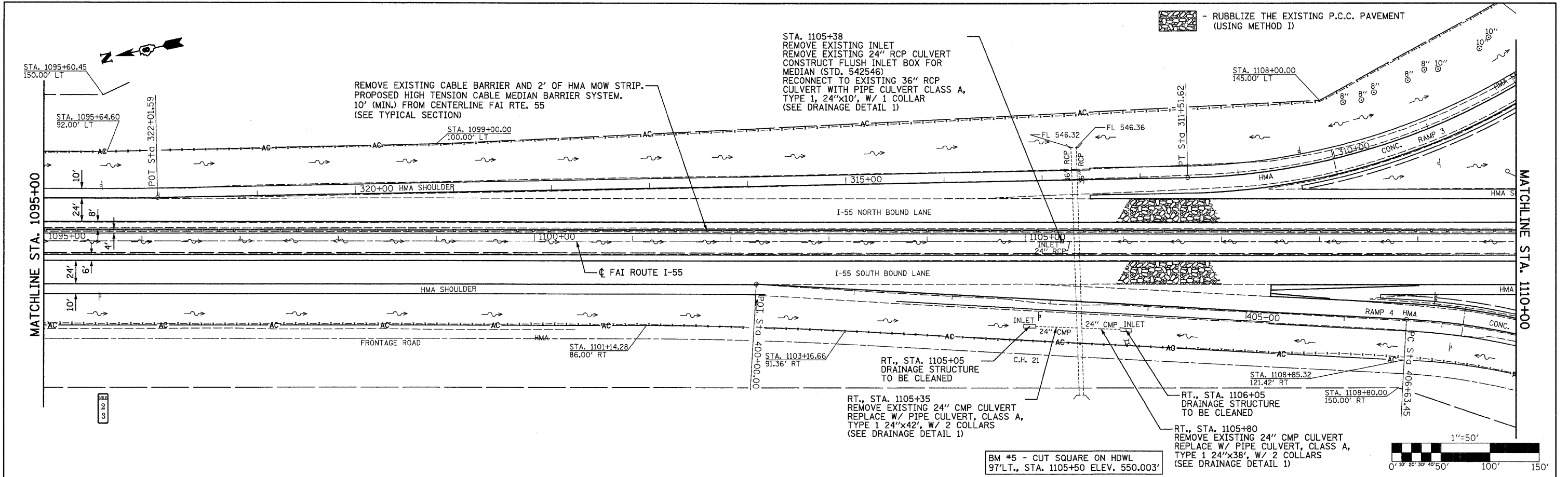

NOTE FOR MAINLINE ELEVATIONS:
 THE ORIGINAL CONCRETE ELEVATIONS SHOWN BELOW ARE TAKEN FROM OLD AS-BUILT PLANS. (SB & NB) ELEVATIONS SHOWN BELOW ARE THE EXISTING SURVEYED ELEVATIONS. THE PROPOSED PROFILE GRADE WOULD BE THE ORIGINAL CONCRETE PAVEMENT PROFILE GRADE PLUS 11 1/2 INCHES, EXCEPT IN THOSE AREAS IDENTIFIED AS PROFILE CORRECTIONS.

FILE NAME =	USER NAME = SJS	DESIGNED -	REVISED -	STATE OF ILLINOIS DEPARTMENT OF TRANSPORTATION	FAI ROUTE 55 (I-55)	F.A.I. RTE.	SECTION	COUNTY	TOTAL SHEET NO.	
...\\cedd\0876C93-sht-plnprf1.dgn		DRAWN -	REVISED -			55	60-1,2,1R5-2	MADISON	156	66
PLLOT SCALE = 50.0000' / IN.		CHECKED -	REVISED -			CONTRACT NO. 76C93				
PLLOT DATE = 06/23/2010 15:33:22		DATE -	REVISED -			ILLINOIS FED. AID PROJECT				