 - RUBBLIZE THE EXISTING P.C.C. PAVEMENT (USING METHOD 1)

LT. STA. 1244+90  
REMOVE CONCRETE HEADWALL AND 12' OF 24" RCP CULVERT. REPLACE WITH PIPE CULVERT, CLASS A, TYPE 1 24"x12" W/ RC END SECTION (STD. 542201) SKEWED 30° LT. AHD. W/ 1 COLLAR

DATE	
BY	
PLAN	
SURVEYED	
ALIGNED	
CHECKED	
NO. OF W.A. CHECKED	
ROAD FILE NAME	
NO.	

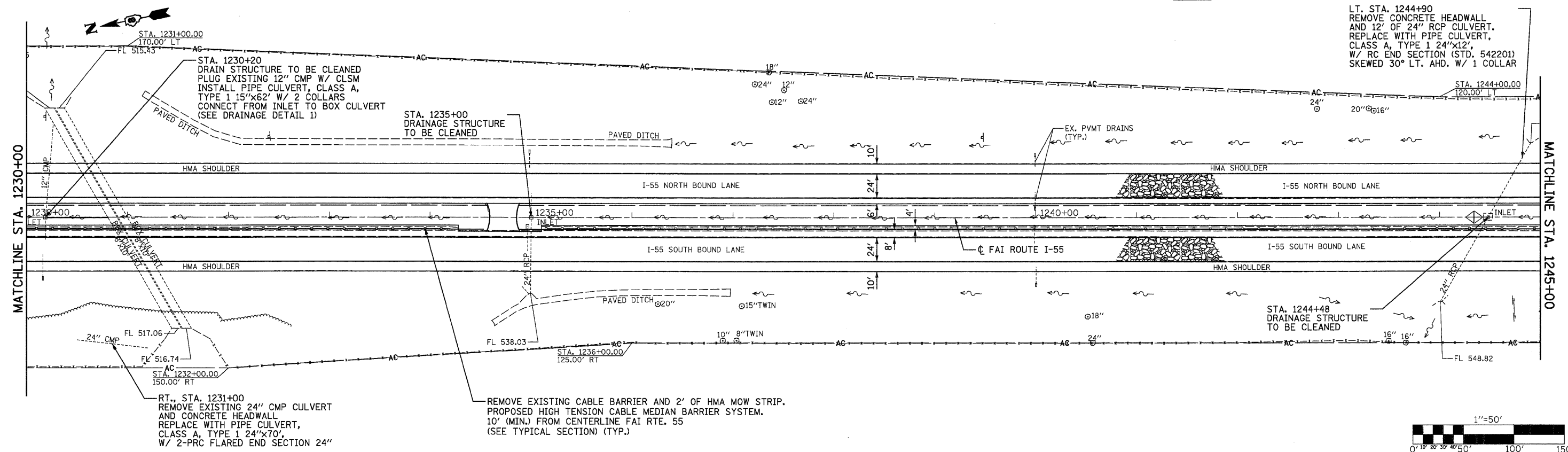

DATE	
BY	
PROFILE	
SURVEYED	
GRADES CHECKED	
ILL. NOTED	
STRUCTURE NOTATIONS OK'D	
NO.	

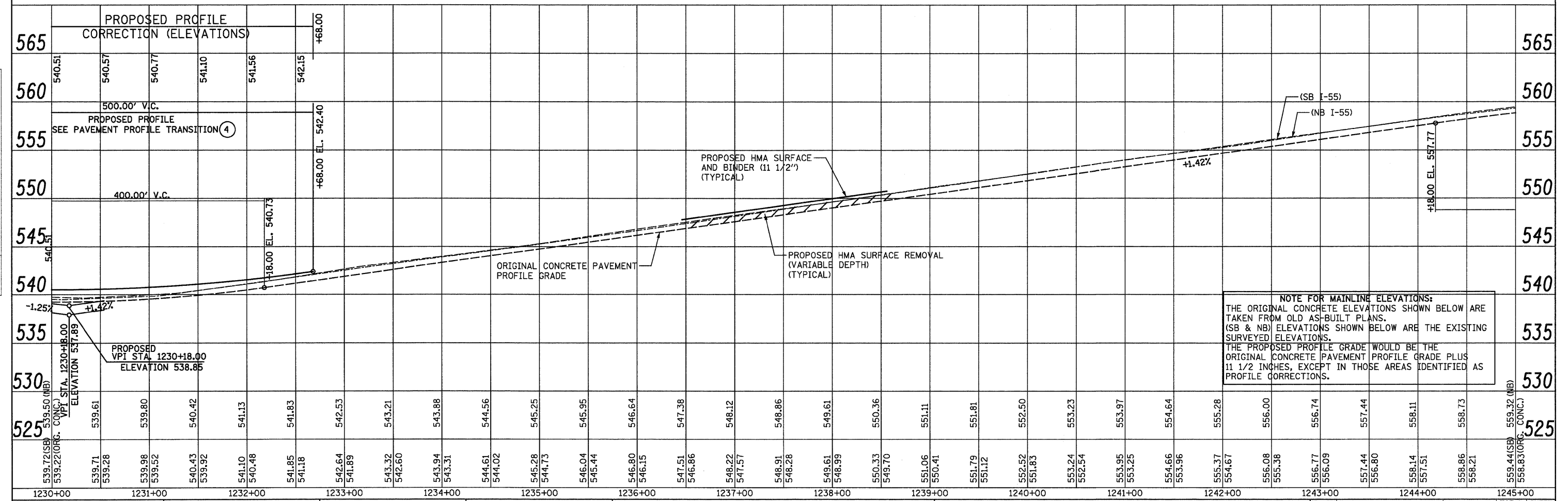

FILE NAME =	USER NAME = SJS	DESIGNED -	REVISED -	<p align="center"><b>STATE OF ILLINOIS</b> <b>DEPARTMENT OF TRANSPORTATION</b></p> <p align="center"><b>FAI ROUTE 55 (I-55)</b></p>	<p align="center">SECTION</p> <p align="center">60-(1,2)RS-2</p> <p align="center">COUNTY</p> <p align="center">MADISON</p> <p align="center">CONTRACT NO. 76C93</p>
...oad\4\0876C93-ah-p1nprf1.dgn		DRAWN -	REVISED -		
PLOT SCALE = 50.0000' / IN.		CHECKED -	REVISED -		
PLOT DATE = 06/23/2010 15:33:30		DATE	REVISED -		
<p>SCALE: 1"=50'</p> <p>SHEET NO. OF SHEETS STA. 1230+00 TO STA. 1245+00</p>				<p>TOTAL SHEETS 156</p> <p>SHEET NO. 75</p> <p>ILLINOIS FED. AID PROJECT</p>	