

DATE	
BY	
SURVEYED	
ALIGNED	
CHECKED	
RT. OF WAY	
CHECKED	
NO.	
PLAN	
NOTE BOOK	
NO.	
DATE	
BY	
SURVEYED	
ALIGNED	
CHECKED	
RT. OF WAY	
CHECKED	
NO.	

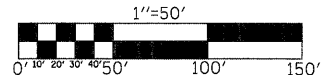

DATE	
BY	
SURVEYED	
GRADES	
CHECKED	
NO.	
PROFILE	
NOTE BOOK	
NO.	
DATE	
BY	
SURVEYED	
GRADES	
CHECKED	
NO.	

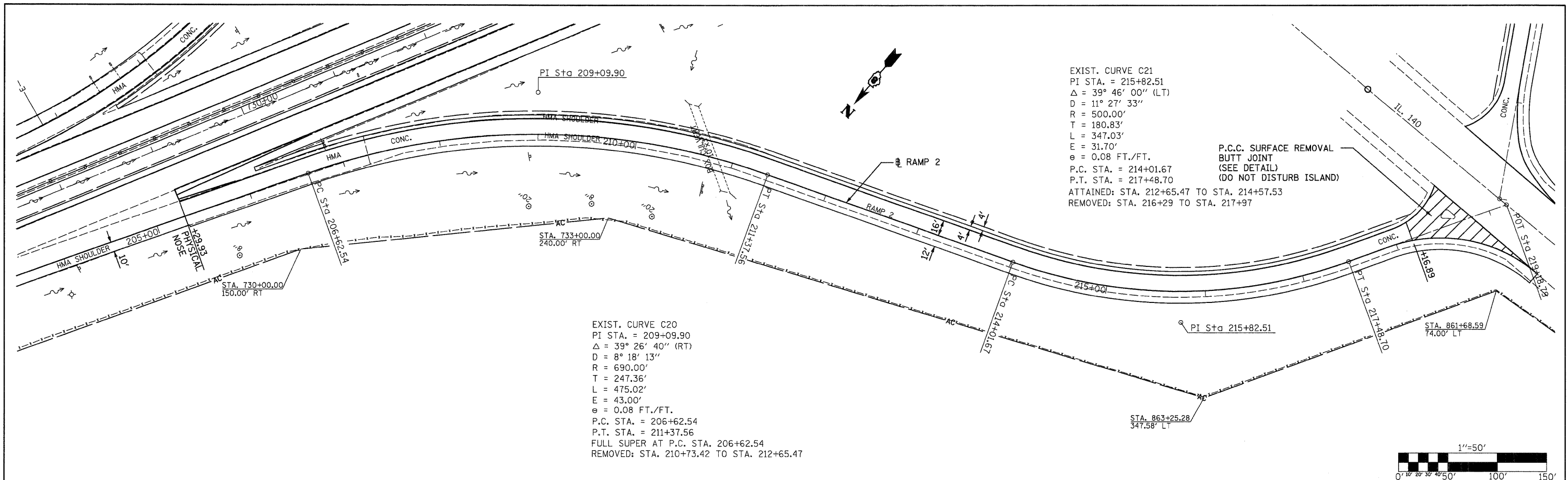
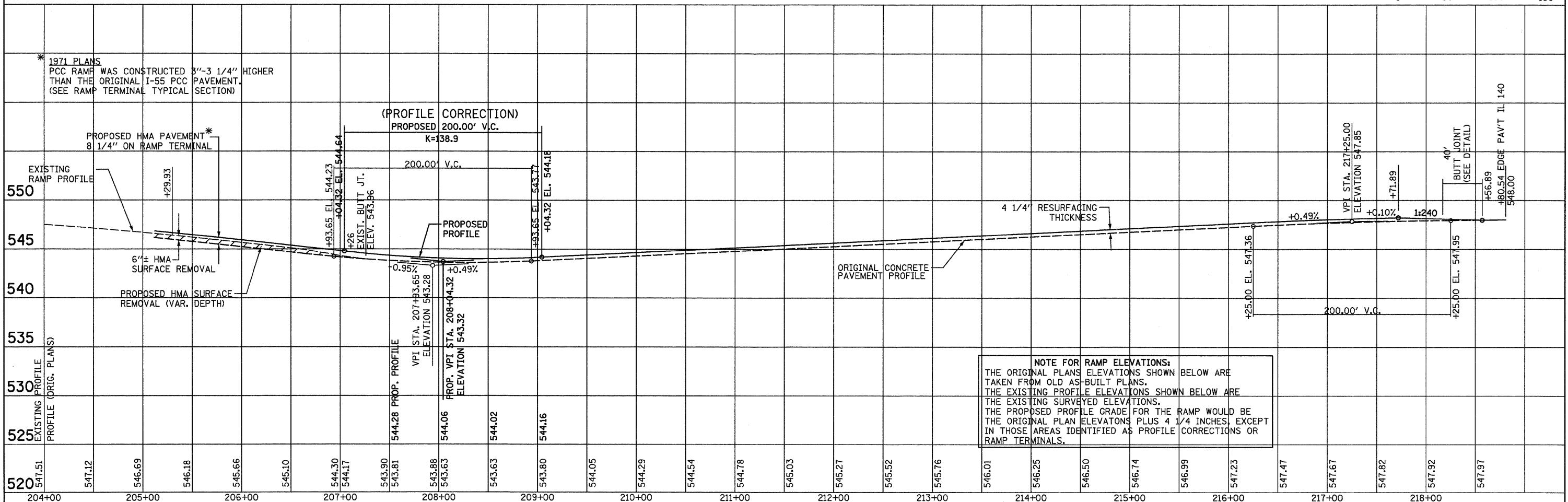

NOTE FOR RAMP ELEVATIONS:
 THE ORIGINAL PLANS ELEVATIONS SHOWN BELOW ARE TAKEN FROM OLD AS-BUILT PLANS. THE EXISTING PROFILE ELEVATIONS SHOWN BELOW ARE THE EXISTING SURVEYED ELEVATIONS. THE PROPOSED PROFILE GRADE FOR THE RAMP WOULD BE THE ORIGINAL PLAN ELEVATIONS PLUS 4 1/4 INCHES, EXCEPT IN THOSE AREAS IDENTIFIED AS PROFILE CORRECTIONS OR RAMP TERMINALS.

FILE NAME =	USER NAME = SJS	DESIGNED -	REVISED -	STATE OF ILLINOIS DEPARTMENT OF TRANSPORTATION	SB EXIT RAMP 2 (IL 140)		F.A.I. RTE.	SECTION	COUNTY	TOTAL SHEETS	SHEET NO.
...oad\0878C93-shr-plnprf2.dgn		DRAWN -	REVISED -		55	60-1,2RS-2	MADISON	156	79		
PLOT SCALE = 50.0000' / IN.		CHECKED -	REVISED -		CONTRACT NO. 76C93			ILLINOIS FED. AID PROJECT			
PLOT DATE = 06/23/2010 15:33:48		DATE	REVISED -		SCALE:	SHEET NO.	OF SHEETS	STA.	TO STA.		