

DATE	
BY	
PLAN	SURVEYED
	ALIGNED
	CHECKED
	RT. OF WAY CHECKED
	NO. _____
	FILE NAME

DATE	
BY	
PROFILE	SURVEYED
	GRADES CHECKED
	BLM. NOTED
	STRUCTURE NOTATIONS CHECKED
	NO. _____

1993 PLANS
 PCC RAMP WAS CONSTRUCTED 3"± HIGHER
 THAN THE ORIGINAL I-55 PCC PAVEMENT.
 (SEE RAMP TERMINAL TYPICAL SECTION)

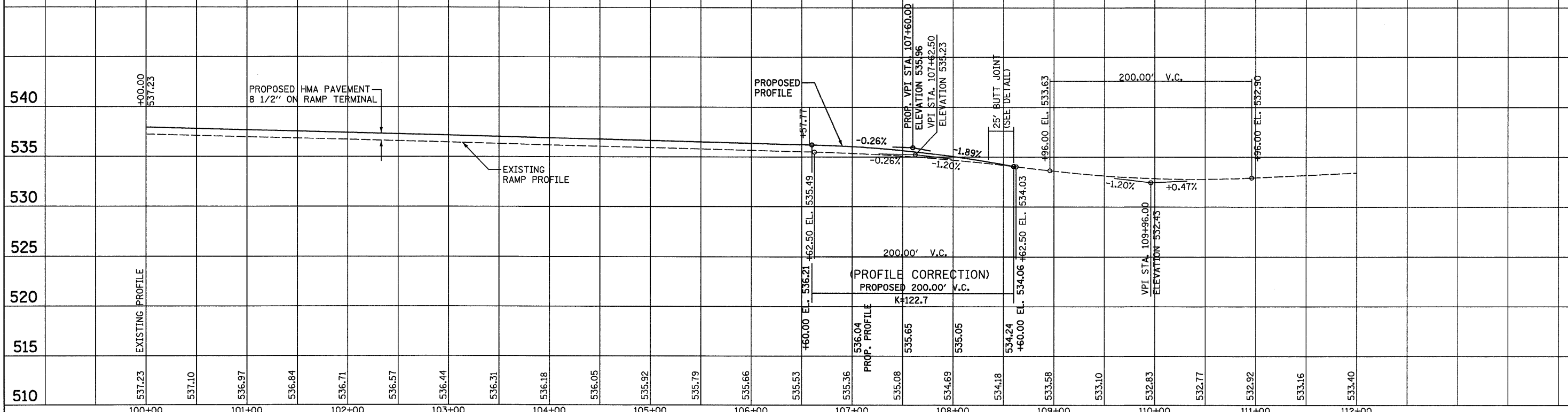

FILE NAME =	USER NAME = SJS	DESIGNED -	REVISED -	STATE OF ILLINOIS DEPARTMENT OF TRANSPORTATION	SB EXIT RAMP @ REST AREA	F.A.I. RTE.	SECTION	COUNTY	TOTAL SHEETS	SHEET NO.	
...\\oad\0876C93-sht-plnprf2.dgn		DRAWN -	REVISED -			55	60-1,2,1R5-2	MADISON	156	82	
		CHECKED -	REVISED -			CONTRACT NO. 76C93					
		DATE -	REVISED -			ILLINOIS FED. AID PROJECT					

Johnson, Depp & Quisenberry
 CONSULTING ENGINEERS
 Springfield, Illinois