

EXIST. CURVE C50
 PI STA. = 102+33.95
 $\Delta = 25^\circ 12' 37''$ (LT)
 $D = 17^\circ 34' 31''$
 $R = 326.00'$
 $T = 72.90'$
 $L = 143.44'$
 $E = 8.05'$
 $e = 0.06$ FT./FT.
 P.C. STA. = 101+61.05
 P.T. STA. = 103+04.49
 ATTAINED: STA. 100+89.24 TO STA. 101+97.24
 REMOVED: STA. 102+68.68 TO STA. 103+76.68

EXIST. CURVE C51
 PI STA. = 108+71.06
 $\Delta = 50^\circ 34' 08''$ (RT)
 $D = 8^\circ 18' 13''$
 $R = 690.00'$
 $T = 325.93'$
 $L = 608.99'$
 $E = 73.11'$
 $e = 0.08$ FT./FT.
 P.C. STA. = 105+45.13
 P.T. STA. = 111+54.12
 ATTAINED: STA. 104+17.32 TO STA. 106+09.32
 REMOVED: STA. 110+18.81 TO 1/2 S.E.
 AT P.T. STA. 111+54.12

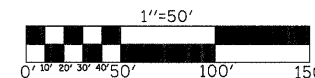

PLAN	SURVEYED	BY	DATE
	NOTE BOOK		
	NO.		
	NO.		
	NO.		

PROFILE	SURVEYED	BY	DATE
	GRADES CHECKED		
	BLM. NOTED		
	STRUCTURE		
	NOTATIONS		
	CR'D		

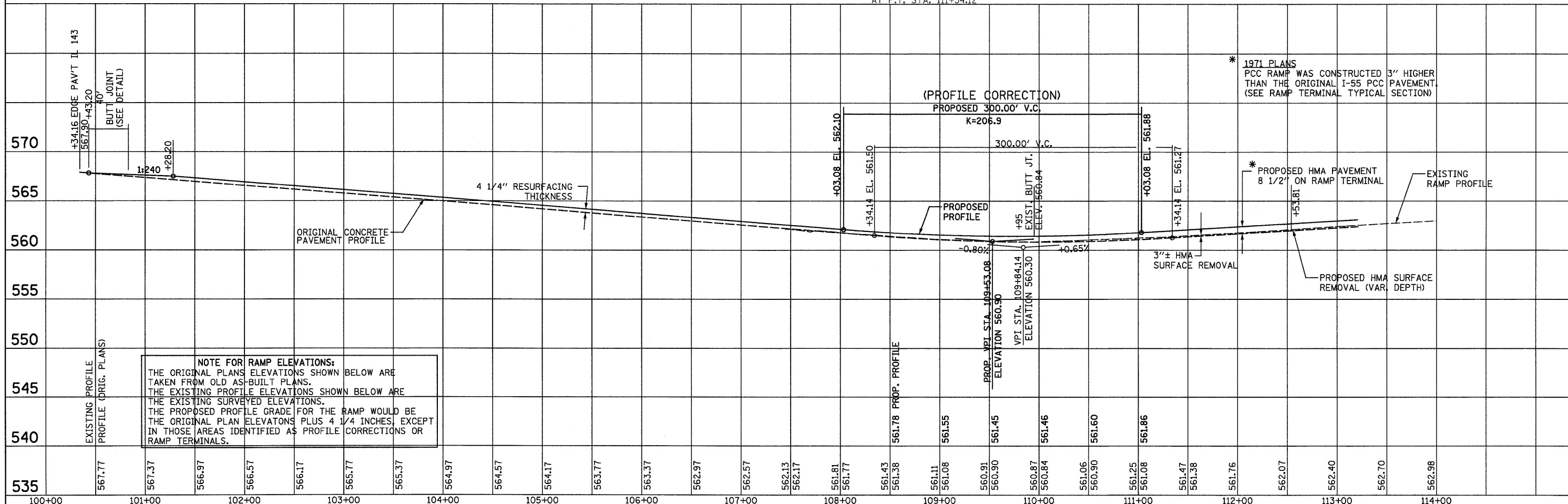

NOTE FOR RAMP ELEVATIONS:
 THE ORIGINAL PLANS ELEVATIONS SHOWN BELOW ARE TAKEN FROM OLD AS-BUILT PLANS.
 THE EXISTING PROFILE ELEVATIONS SHOWN BELOW ARE THE EXISTING SURVEYED ELEVATIONS.
 THE PROPOSED PROFILE GRADE FOR THE RAMP WOULD BE THE ORIGINAL PLAN ELEVATIONS PLUS 4 1/4 INCHES, EXCEPT IN THOSE AREAS IDENTIFIED AS PROFILE CORRECTIONS OR RAMP TERMINALS.

FILE NAME =	USER NAME = SJS	DESIGNED -	REVISED -	STATE OF ILLINOIS DEPARTMENT OF TRANSPORTATION	SB ENTRANCE RAMP 1 (IL 143)			F.A.I. RTE.	SECTION	COUNTY	TOTAL SHEETS	SHEET NO.
...\\add\10876C93-ah-1\p1nr\F2.dgn		DRAWN -	REVISED -		55	60-1,2,1R5-2	MADISON	156	86			
	PLOT SCALE = 50.0000 // IN.	CHECKED -	REVISED -		CONTRACT NO. 76C93							
	PLOT DATE = 06/23/2010 15:33:52	DATE	REVISED -		SCALE:	SHEET NO.	OF	SHEETS	STA.	TO STA.	ILLINOIS FED. AID PROJECT	