

POT STA 10+00.00
(ALLEY @ STA 156+02.00)
(MAG NAIL)

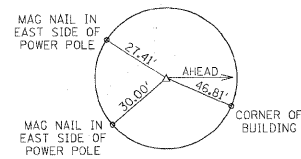

POT STA 12+00.00
(ALLEY @ STA 156+02.00) =
ML STA 156+02.00
(MAG NAIL)

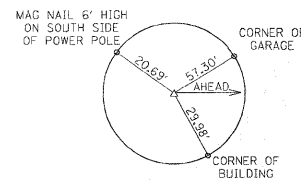

POT STA 14+00.00
(ALLEY @ STA 156+02.00)
(MAG NAIL)

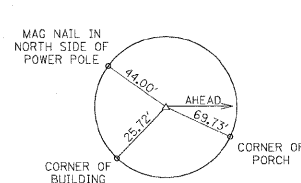

PT STA 156+97.64
(P.K. NAIL)

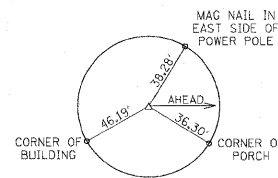

PC STA 157+33.68
(P.K. NAIL)

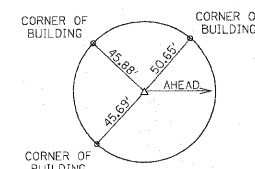

POT STA 35+81.00
(MAIN ST)
(P.K. NAIL)

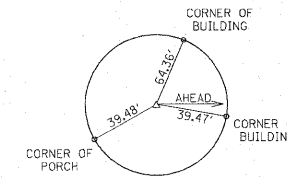

POT STA 40+00.00
(MAIN ST) =
ML STA 158+00.69
(MAG NAIL)

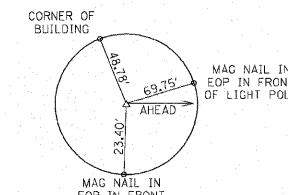

POT STA 42+75.00
(MAIN ST)
(P.K. NAIL)

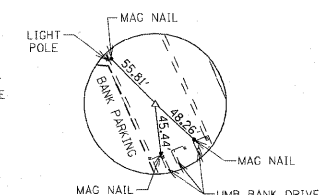

PT STA 160+80.34 (AHEAD) =
PT STA 160+78.39 (BACK)
(MAG NAIL)

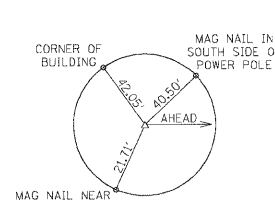

POT STA 47+50.00
(CLAY ST)
(MAG NAIL)

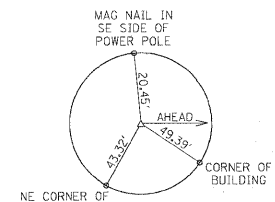

POT STA 50+00.00
(CLAY ST) =
ML STA 162+37.50
(MAG NAIL)

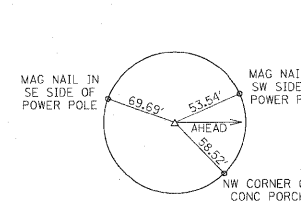

POT STA 52+50.00
(CLAY ST)
(MAG NAIL)

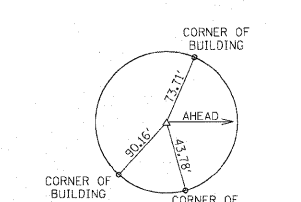

PC STA 164+43.24
(MAG NAIL)

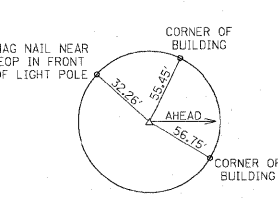

PT STA 165+57.66
(MAG NAIL)

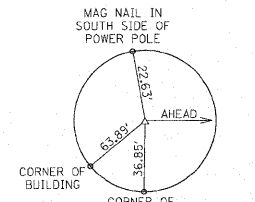

POT STA 10+44.21
(JOHNSON ST)
(MAG NAIL)

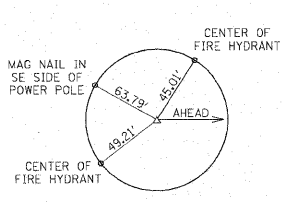

POT STA 12+00.00
(JOHNSON ST) =
ML STA 167+00.52
(MAG NAIL)

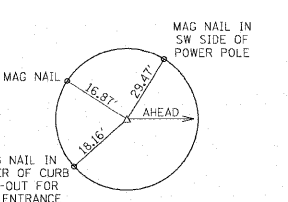

POT STA 13+56.66
(JOHNSON ST)
(MAG NAIL)

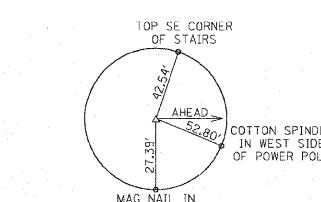

PC STA 175+56.85
(MAG NAIL)

CENTERLINE CONTROL COORDINATES

REFERENCE POINTS	NORTHING	EASTING
P.O.C. STA. 156+02.00	729534.7401	348756.0586
P.T. STA. 156+97.64	729625.3474	348725.4755
P.C. STA. 157+33.68	729659.7653	348714.7677
P.O.C. STA. 158+00.69	729724.5078	348697.5631
P.T. STA. 160+78.39 BK = STA. 160+80.54 AH	730000.5464	348685.3285
P.O.T. STA. 162+37.50	730156.1934	348705.5620
P.C. STA. 164+43.24	730360.2190	348732.0844
P.T. STA. 165+57.66	730474.2855	348740.3181
P.O.T. STA. 167+00.52	730617.1218	348742.4387
P.O.T. STA. 10+00.00 (ALLEY @ M.L. STA. 156+02.00)	729457.6920	348571.4954
P.O.T. STA. 14+00.00 (ALLEY @ M.L. STA. 156+02.00)	729610.3323	348941.2229
P.O.T. STA. 35+81.00 (MAIN ST.)	729565.9415	348309.7258
P.O.T. STA. 42+75.00 (MAIN ST.)	729828.5788	348952.1102
P.O.T. STA. 47+50.00 (CLAY ST.)	730061.5747	348474.1591
P.O.T. STA. 52+50.00 (CLAY ST.)	730250.8122	348936.9649
P.O.T. STA. 10+44.21 (JOHNSON ST.)	730618.7423	348586.6620
P.O.T. STA. 13.56.66 (JOHNSON ST.)	730615.4922	348899.0861

BENCHMARKS:

BENCHMARK: BM #112
CHISELED "X" ON TOP NE FLANGE BOLT ON FIRE
HYDRANT LOCATED ON THE SE QUADRANT OF CLAY
ST. & IL RT. 159 ON N. SIDE OF OFFICE BUILDING
ADDRESSED #126.
STA. 162+47±, 57' RT, ELEV. 562.954

BENCHMARK: BM #112A

CHISELED "X" ON TOP NE FLANGE BOLT ON FIRE
HYDRANT LOCATED ON THE SE QUADRANT OF CLAY
ST. & N. MORRISON NEAR NW CORNER OF "UMB BANK"
PARKING LOT ACROSS STREET FROM HERBERTS
OPTOMETRIST OFFICE BUILDING.
STA. 160+53±, 92' LT, ELEV. 562.648