

	LOCATION	STATION	OFFSET	ELEVATION		LOCATION	STATION	OFFSET	ELEVATION		LOCATION	STATION	OFFSET	ELEVATION
1	N MORRISON	13+43.96	17.5' RT	559.30	16	N MORRISON	12+11.80	49.4' RT	562.35	31	N MORRISON	13+11.05	40.1' RT	560.20
2	N MORRISON	13+36.19	24.4' RT	559.48	17	N MORRISON	12+07.81	38.2' RT	562.10	32	N MORRISON	13+00.18	54.3' RT	560.85
3	N MORRISON	13+36.18	25.7' RT	559.50 HP	18	N MORRISON	11+93.67	28.3' RT	562.30	33	N MORRISON	12+95.67	55.6' RT	561.00
4	N MORRISON	13+39.18	28.7' RT	559.45	19	N MORRISON	11+63.26	28.3' RT	562.60	34	N MORRISON	12+84.17	54.3' RT	561.25
5	N MORRISON	13+53.13	28.7' RT	559.20	20	N MORRISON	11+60.25	25.3' RT	562.65	35	N MORRISON	12+81.04	52.5' RT	561.30
6	N MORRISON	13+55.13	30.7' RT	559.15	21	N MORRISON	11+60.24	9.4' RT	562.11	36	N MORRISON	12+81.22	50.7' RT	561.32
7	N MORRISON	13+54.86	62.7' RT	559.35	22	N MORRISON	11+60.23	14.0' LT	561.65	37	N MORRISON	13+00.01	44.5' RT	561.52
8	N MORRISON	13+52.84	64.7' RT	559.39	23	N MORRISON	11+63.24	17.0' LT	561.56	38	N MORRISON	13+00.20	42.7' RT	561.54
9	N MORRISON	13+44.48	64.6' RT	559.55	24	N MORRISON	11+80.40	17.5' LT	561.31	39	N MORRISON	12+70.65	26.4' RT	561.90
10	N MORRISON	13+30.31	66.5' RT	560.15	25	N MORRISON	11+83.16	20.1' LT	561.37	40	N MORRISON	12+69.10	26.3' RT	561.88
11	N MORRISON	13+03.59	74.2' RT	561.30	26	N MORRISON	12+10.16	20.1' LT	561.05	41	N MORRISON	12+47.87	33.2' RT	561.68
12	N MORRISON	13+00.26	80.7' RT	561.37	27	N MORRISON	12+13.95	17.5' LT	560.94	42	N MORRISON	12+41.96	31.0' RT	561.75
13	N MORRISON	13+05.92	96.5' RT	561.54	28	N MORRISON	12+49.78	17.5' RT	560.88	43	N MORRISON	13+55.07	37.7' RT	559.00 LP
14	N MORRISON	13+03.40	99.1' RT	561.56	29	N MORRISON	12+96.12	17.5' RT	560.25					
15	N MORRISON	12+13.86	51.7' RT	562.40	30	N MORRISON	13+11.12	32.6' RT	560.00					

NOTE:  
SEE SHEET 117 FOR CONCRETE PARKING BLOCK DETAILS

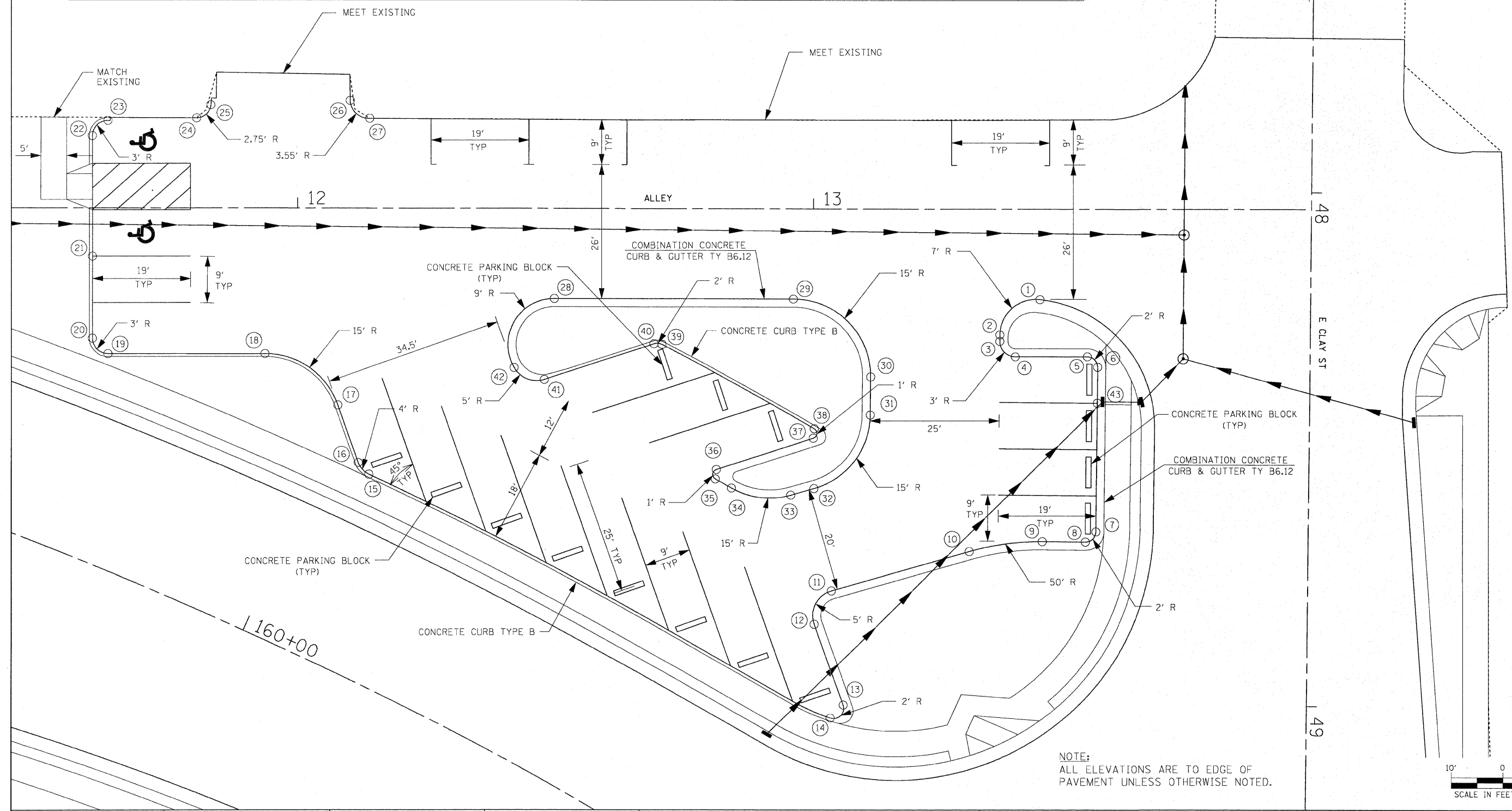

NOTE:  
ALL ELEVATIONS ARE TO EDGE OF PAVEMENT UNLESS OTHERWISE NOTED.

FILE NAME =	USER NAME = default	DESIGNED -	REVISED -
pt\projects\513801\cadd\dgn\3876054-ah\parking-detail-2.dgn		DRAWN -	REVISED -
PLOT SCALE = 10.0000' / IN.		CHECKED -	REVISED -
PLOT DATE = 6/15/2010		DATE -	REVISED -

**STATE OF ILLINOIS**  
**DEPARTMENT OF TRANSPORTATION**

**PARKING LOT DETAIL 2**  
SCALE: 1" = 10' SHEET NO. 2 OF 3 SHEETS STA. N/A TO STA. N/A

F.A.P. RTE.	SECTION	COUNTY	TOTAL SHEETS	SHEET NO.
600	60-(30,31,128)-N-1	MADISON	152	45
CONTRACT NO. 76D54				
ILLINOIS FED. AID PROJECT				