

PLAN	SURVEYED	BY	DATE
NOTE BOOK	ALIGNED		
NO.	PLAN CHECKED		
	BY		
	DATE		

PROFILE	SURVEYED	BY	DATE
NOTE BOOK	GRADES CHECKED		
NO.	BY		
	DATE		

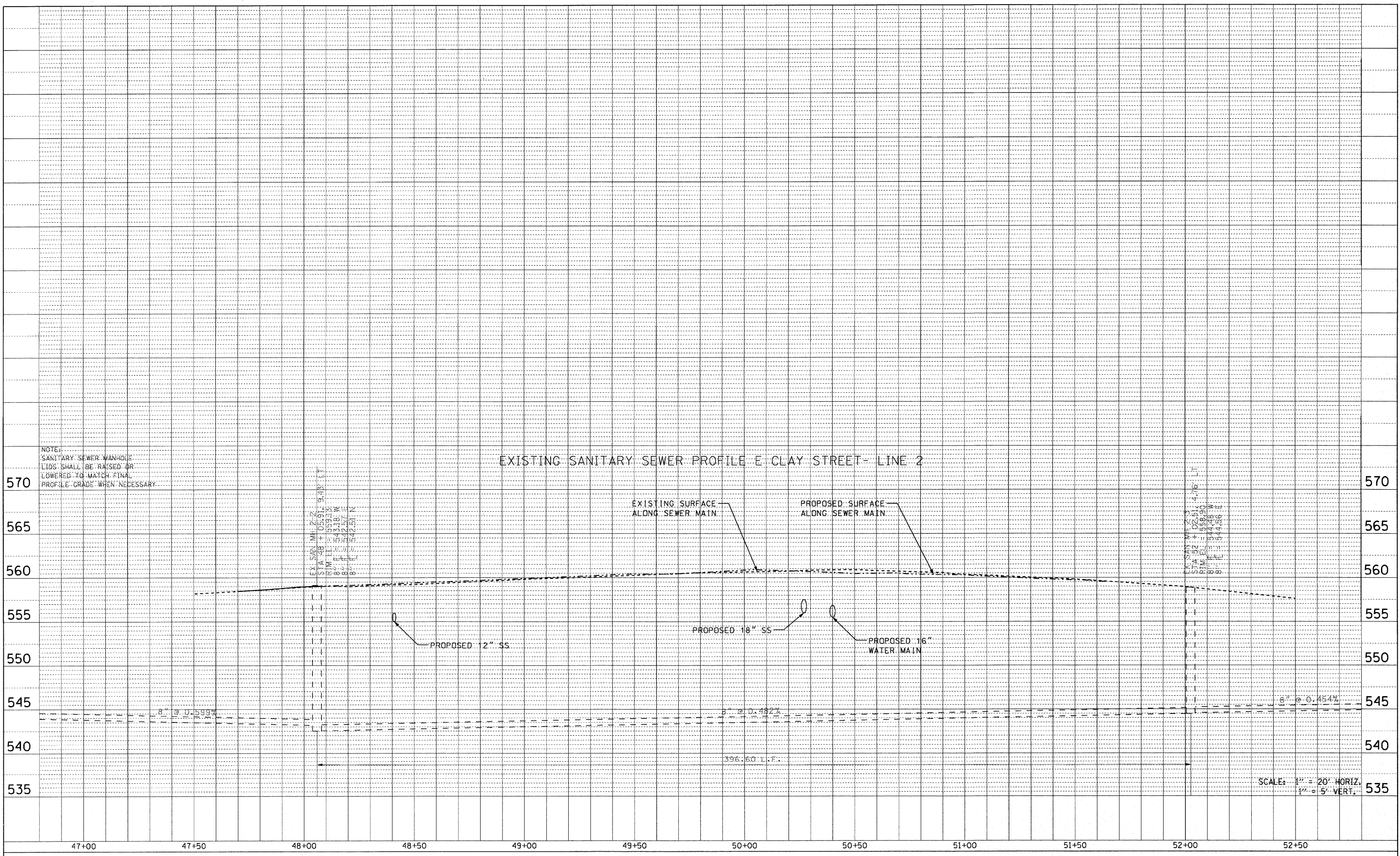

NOTE:
SANITARY SEWER MANHOLE
LIDS SHALL BE RAISED OR
LOWERED TO MATCH FINAL
PROFILE GRADE WHEN NECESSARY.

EX. SAN. MH. 12-2
STA. 48+05.91, 9.43' LT.
R.M. LL = 559.15
8' L.F. 543.18 W
8' L.F. 543.67 E
8' L.F. 543.61 N

EX. SAN. MH. 12-2
STA. 52+05.91, 9.43' LT.
R.M. LL = 559.15
8' L.F. 543.18 W
8' L.F. 543.67 E
8' L.F. 543.61 N

SCALE: 1" = 20' HORIZ.
1" = 5' VERT.

FILE NAME =	USER NAME = default	DESIGNED -	REVISED -
P:\Projects\51352\1\CA00\DN\0876054-sht-drain.dgn		DRAWN -	REVISED -
PLOT SCALE = 20.0000' / IN.		CHECKED -	REVISED -
PLOT DATE = 6/16/2010		DATE -	REVISED -

**STATE OF ILLINOIS
DEPARTMENT OF TRANSPORTATION**

**DRAINAGE AND UTILITY PROFILE
IL ROUTE 159**

SCALE: N/A SHEET NO. 10 OF 16 SHEETS STA. N/A TO STA. N/A

F.A.P. RTE.	SECTION	COUNTY	TOTAL SHEETS	SHEET NO.
600	60-(30,31,128)-N-1	MADISON	152	59
CONTRACT NO. 76D54				
ILLINOIS FED. AID PROJECT				