

MATCH LINE 164+50.00

MATCH LINE 169+50.00

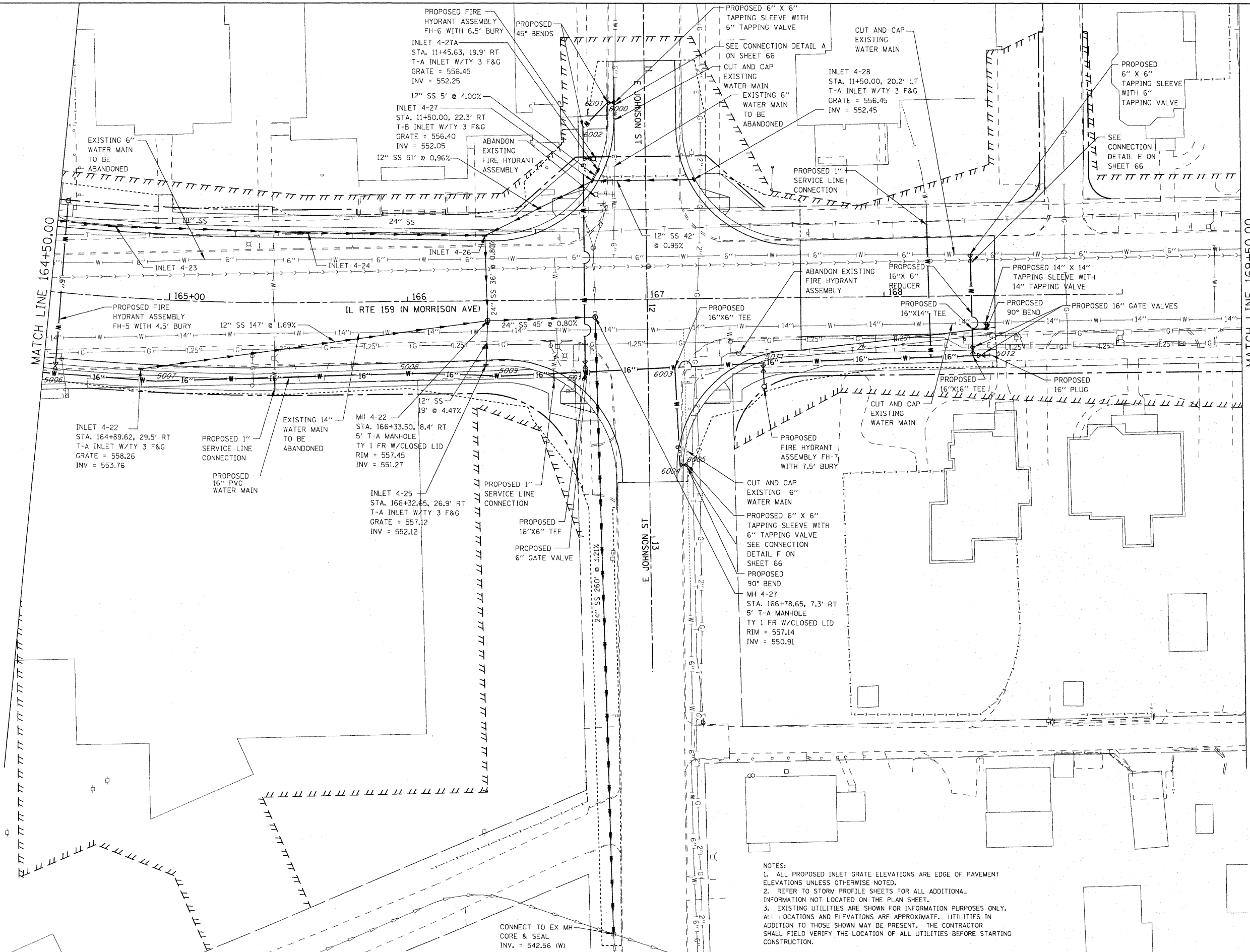

NOTES:
 1. ALL PROPOSED INLET GRATE ELEVATIONS ARE EDGE OF PAVEMENT ELEVATIONS UNLESS OTHERWISE NOTED.
 2. REFER TO STORM PROFILE SHEETS FOR ALL ADDITIONAL INFORMATION NOT LOCATED ON THE PLAN SHEET.
 3. EXISTING UTILITIES ARE SHOWN FOR INFORMATION PURPOSES ONLY. ALL LOCATIONS AND ELEVATIONS ARE APPROXIMATE. UTILITIES IN ADDITION TO THOSE SHOWN MAY BE PRESENT. THE CONTRACTOR SHALL FIELD VERIFY THE LOCATION OF ALL UTILITIES BEFORE STARTING CONSTRUCTION.



FILE NAME =	P:\Projects\513501\CADD\DN\0876054-shd\drain.dgn
USER NAME =	default
PLOT SCALE =	20.0000' / IN.
PLOT DATE =	6/16/2010

DESIGNED -	REVISD -
DRAWN -	REVISD -
CHECKED -	REVISD -
DATE -	REVISD -

**STATE OF ILLINOIS
DEPARTMENT OF TRANSPORTATION**

**DRAINAGE AND UTILITY PLAN
IL ROUTE 159**

SCALE: 1" = 20' SHEET NO. 11 OF 16 SHEETS STA. 164+50.00 TO STA. 169+50.00

F.A.P. RTE.	SECTION	COUNTY	TOTAL SHEETS	SHEET NO.
600	60-(30,31,128)-N-1	MADISON	152	60
CONTRACT NO. 76054				
ILLINOIS FED. AID PROJECT				