



STAGE II - PHASE 1 CONSTRUCTION

- 1) SHIFT IL RTE 159 TRAFFIC TO RT SIDE OF ROADWAY ON E CLAY ST, E MAIN ST, S MORRISON AND VANDALIA ST BETWEEN E CLAY ST AND E MAIN ST
- 2) RECONSTRUCT SOUTH SIDE OF ALLEY 156+02, SOUTH OF E MAIN ST
- 3) REMOVE EXISTING CURB AND GUTTERS ON SOUTH SIDE OF E CLAY ST, NORTH SIDE OF E MAIN ST, EAST SIDE OF S MORRISON, AND WEST SIDE OF VANDALIA ST BETWEEN E CLAY ST AND E MAIN ST AS NEEDED
- 4) CONSTRUCT UTILITIES AS REQUIRED, INCLUDING STORM AND SANITARY SEWERS
- 5) CONSTRUCT NEW CURB AND GUTTER AND DRAINAGE STRUCTURES
- 6) CONSTRUCT SUB-BASE AND PLACE HMA BINDER FOR NEW ALIGNMENT BETWEEN E MAIN ST AND E CLAY ST, NORTH SIDE OF E MAIN ST, AND SOUTH SIDE OF E CLAY ST
- 7) ONE LANE OF ONE WAY TRAFFIC IS TO BE MAINTAINED ON ALL FOUR SIDES OF THE CENTER BLOCK AT ALL TIMES
- 8) STOP SIGNS AND STREET SIGNS INCLUDING NO LEFT/RIGHT TURN SIGNS AT SIDEROADS SHALL BE ADJUSTED AND MAINTAINED BY THE CONTRACTOR
- 9) PROPER DRAINAGE SHALL BE MAINTAINED BY THE CONTRACTOR
- 10) REMOVE ISLAND AT INTERSECTION OF E CLAY ST AND VANDALIA ST

LEGEND

DIRECTION OF TRAFFIC →

CONSTRUCTION

TEMPORARY HMA PAVEMENT

TRAFFIC DRUM WITH STEADY BURNING LIGHT ○

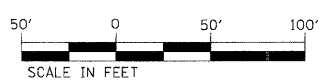
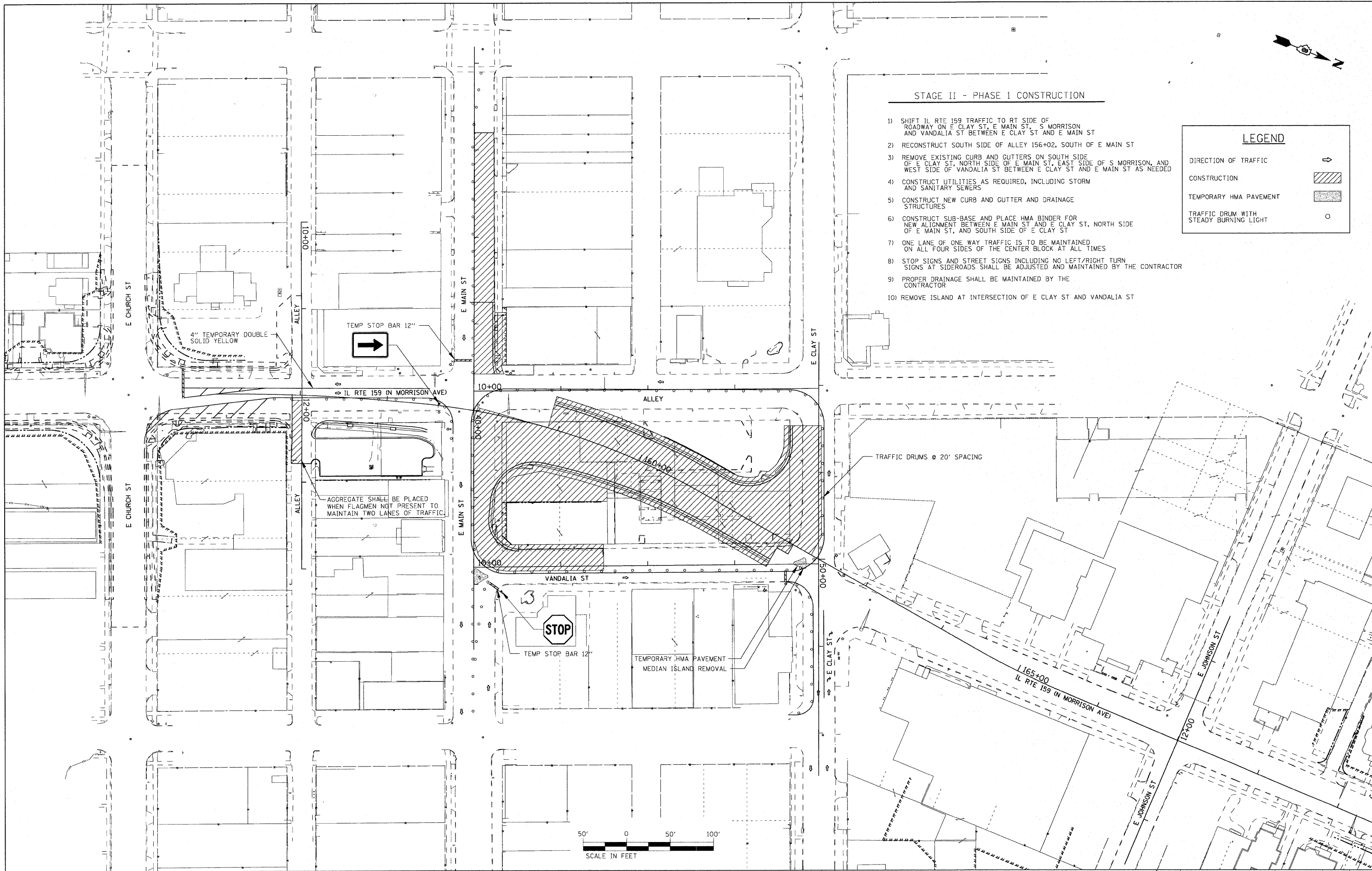

FILE NAME =	USER NAME = default	DESIGNED -	REVISED -
P:\Projects\513501\CA00\N0876054-sht	staging.dgn	DRAWN -	REVISED -
	PLOT SCALE = 50.0000' / IN.	CHECKED -	REVISED -
	PLOT DATE = 6/16/2012	DATE -	REVISED -

**STATE OF ILLINOIS
DEPARTMENT OF TRANSPORTATION**

**SUGGESTED STAGES OF CONSTRUCTION AND TRAFFIC CONTROL
STAGE 2 - PHASE 1**

SCALE: 1" = 50' SHEET NO. 4 OF 9 SHEETS STA. N/A TO STA. N/A

F.A.P. RTE.	SECTION	COUNTY	TOTAL SHEETS	SHEET NO.
600	60-(30,31,128)-N-1	MADISON	152	79
				CONTRACT NO. 76D54
ILLINOIS FED. AID PROJECT				