



**STAGE II - PHASE 2 CONSTRUCTION**

- 1) SIDE ROAD DETOUR- WESTBOUND E MAIN ST (EAST OF VANDALIA) ONTO N CHESTNUT ST-TO WESTBOUND E CLAY ST-BACK TO IL RTE 159
- 2) SHIFT NB IL RTE 159 TRAFFIC TO SOUTH SIDE OF E MAIN ST
- 3) REMOVE EXISTING CURB AND GUTTERS AND SIDEWALKS AS REQUIRED
- 4) CONSTRUCT UTILITIES AS REQUIRED (INCLUDING STORM AND SANITARY SEWERS)
- 5) CONSTRUCT NEW CURB AND GUTTER AND DRAINAGE STRUCTURES ON SOUTH SIDE OF E MAIN ST
- 6) CONSTRUCT PAVEMENT SUB-BASE AND HMA BINDER
- 7) CONTRACTOR SHALL MAINTAIN PEDESTRAIN ACCESS TO BUSINESSES ON E MAIN ST AT ALL TIMES
- 8) MAINTAIN AT LEAST ONE LANE OF TRAFFIC ON E MAIN ST EAST OF VANDALIA) ON TO N CHESTNUT ST
- 9) REMOVE CURB AND GUTTER AND SIDEWALKS ON EAST SIDE IL RTE 159 NEAR E JOHNSON ST FOR CONSTRUCTION OF TEMPORARY PAVEMENT
- 10) CONSTRUCT TEMPORARY HMA BINDER AND SURFACE ON EAST SIDE OF IL RTE 159 NECESSARY TO ACCOMMODATE NORTHBOUND IL RTE 159 TRAFFIC DURING STAGE III CONSTRUCTION

**LEGEND**

DIRECTION OF TRAFFIC

CONSTRUCTION

TEMPORARY HMA PAVEMENT

TRAFFIC DRUM WITH STEADY BURNING LIGHT

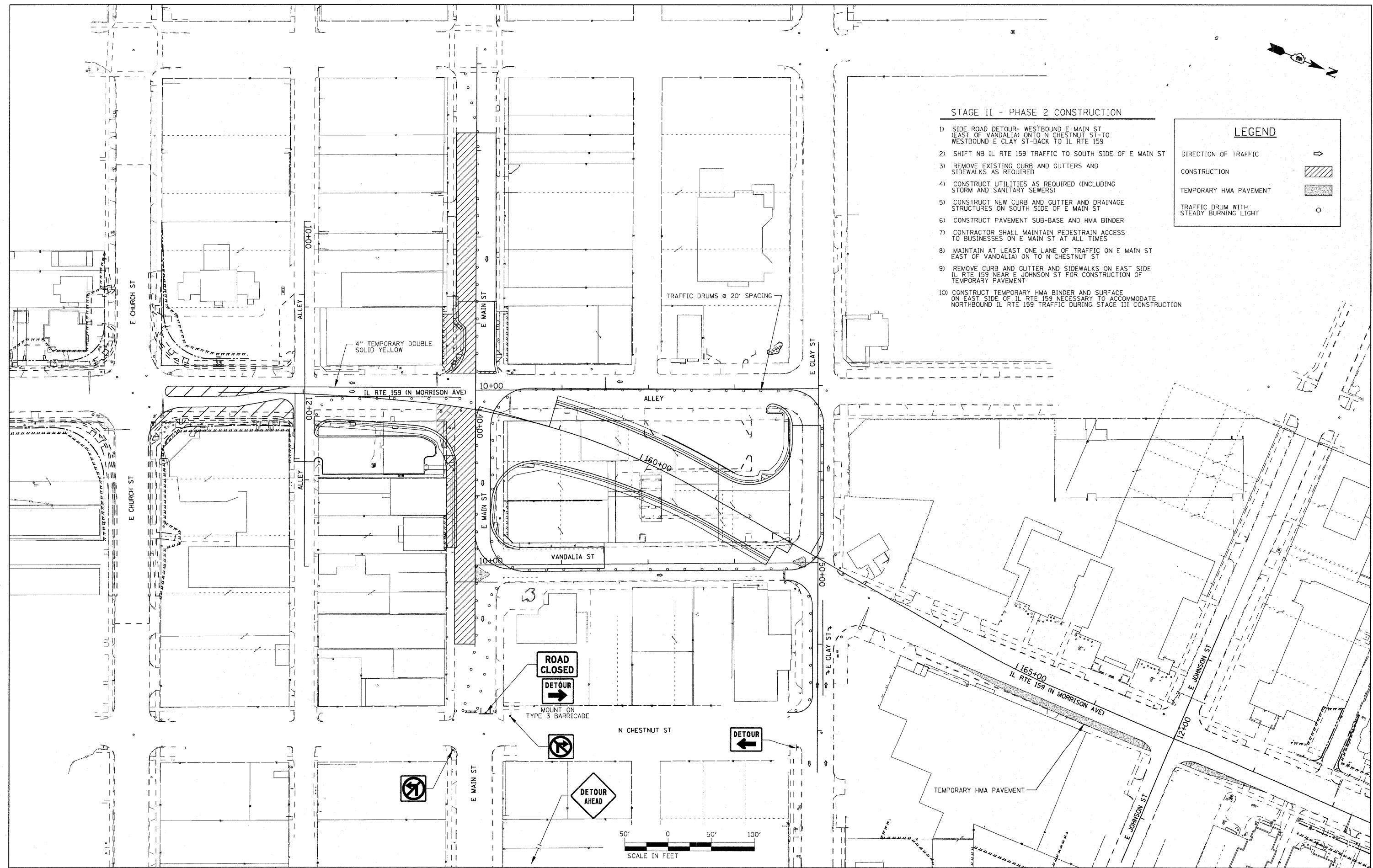

**ROAD CLOSED**  
  
 DETOUR

MOUNT ON TYPE 3 BARRICADE

**DETOUR**

**DETOUR AHEAD**



FILE NAME =	USER NAME = default	DESIGNED -	REVISED -
P:\Projects\513501\CADD\DN\0876D54-sht	teging.dgn	DRAWN -	REVISED -
		CHECKED -	REVISED -
		DATE = 6/16/2010	REVISED -

**STATE OF ILLINOIS  
 DEPARTMENT OF TRANSPORTATION**

**SUGGESTED STAGES OF CONSTRUCTION AND TRAFFIC CONTROL  
 STAGE 2 - PHASE 2**

SCALE: 1" = 50' SHEET NO. 5 OF 9 SHEETS STA. N/A TO STA. N/A

F.A.P. RTE.	SECTION	COUNTY	TOTAL SHEETS	SHEET NO.
600	60-(30,31,128)-N-1	MADISON	152	80
CONTRACT NO. 76D54				
ILLINOIS FED. AID PROJECT				